

# SCHEDULE OF PLANT MATERIAL

CODE	BOTANICAL NAME	COMMON NAME	QUANTITY	MATURE HEIGHT	CONTAINER SIZE	STAKES
AAm	<i>Acmena smithii</i> 'Allyn Magic'	Dwarf Lilly Pilli	6	1m	200mm	-
AO	<i>Agapanthus orientalis</i>	Lily of the Nile	10	0.6m	140mm	-
LA	<i>Livistona australis</i>	Cabbage Tree Palm	1	10m	25 litre	2
MP	<i>Murraya paniculata</i>	Orange Jasmine	4	2m	200mm	-
PTbb	<i>Phormium tenax</i> 'Bronze Baby'	Dwarf NZ Flax	3	1m	140mm	-
TJ	<i>Trachelospermum jasminoides</i>	Star Jasmine	9	0.4m	140mm	-

## LEGEND

- + 55.08 EXISTING LEVELS
- EXISTING TREES TO BE RETAINED
- EXISTING TREES TO BE REMOVED
- EXISTING GARDEN AREAS TO BE RETAINED

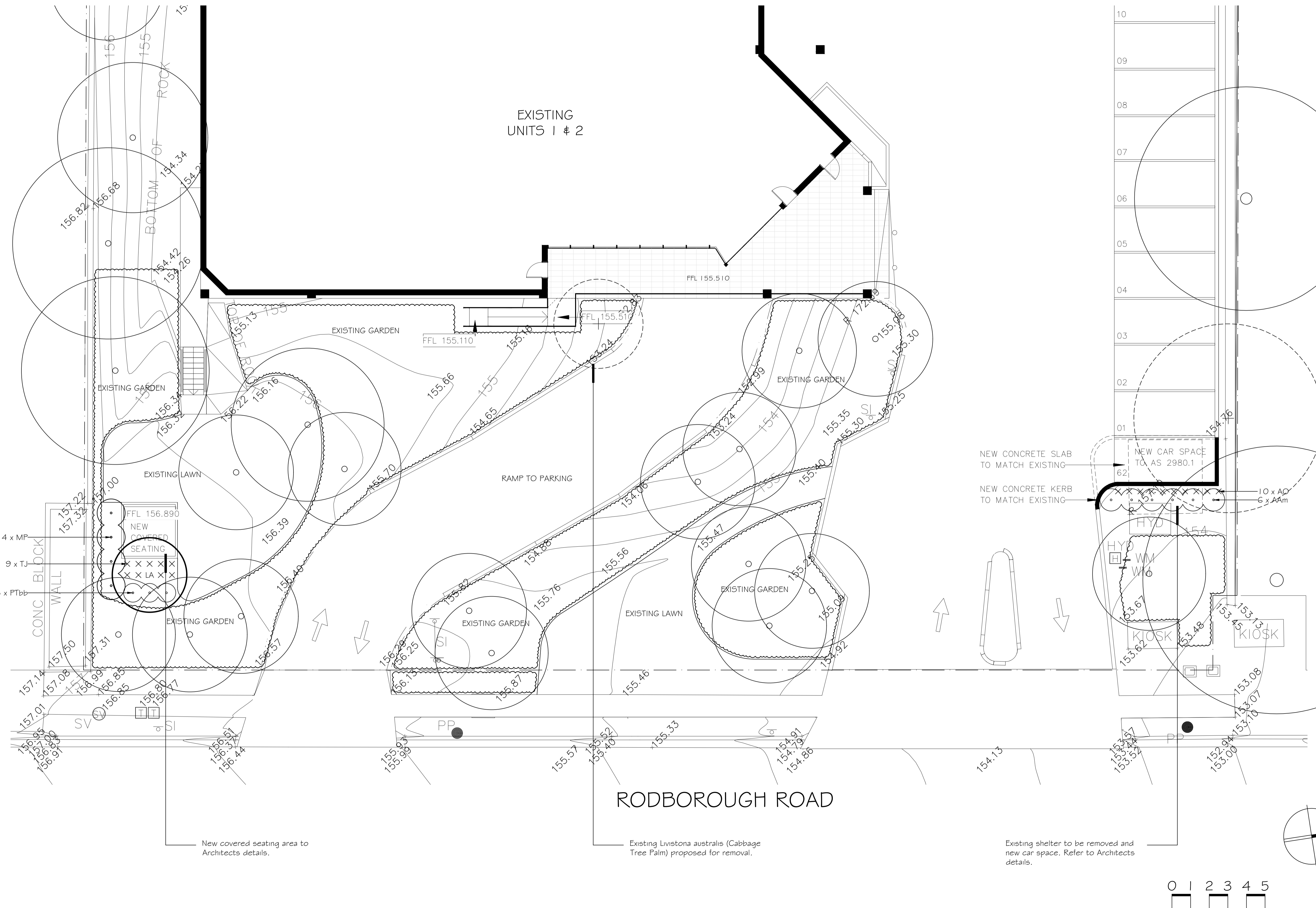

Verify all dimensions on site before commencing construction or ordering materials. Verify the dimensions of all manufactured products before installation. Use figured dimensions in preference to scaled dimensions. Report any discrepancies to the Landscape Architect for a decision before work commences.

### NOTES

This plan is to be read in conjunction with all documentation prepared by **McCullum Ashby Architects**.



office: 16/303 pacific highway lindfield nsw 2070

ph 9416 4290  
A.C.N 097 328 580  
email [ija@netspace.net.au](mailto:ija@netspace.net.au)

**project**  
Commercial  
12A Rodborough Road, Frenchs Forest

**drawing**  
Landscape Plan

**client**  
Mr. J. Roth

**date** June 2024  
**scale** 1:100 @ A1  
1:200 @ A3  
**job.dwg no.** 57.24/131  
**no. in set** ONE/ONE  
**designed by** IJ  
**drawn by** AM

