

129 RIVERVIEW RD

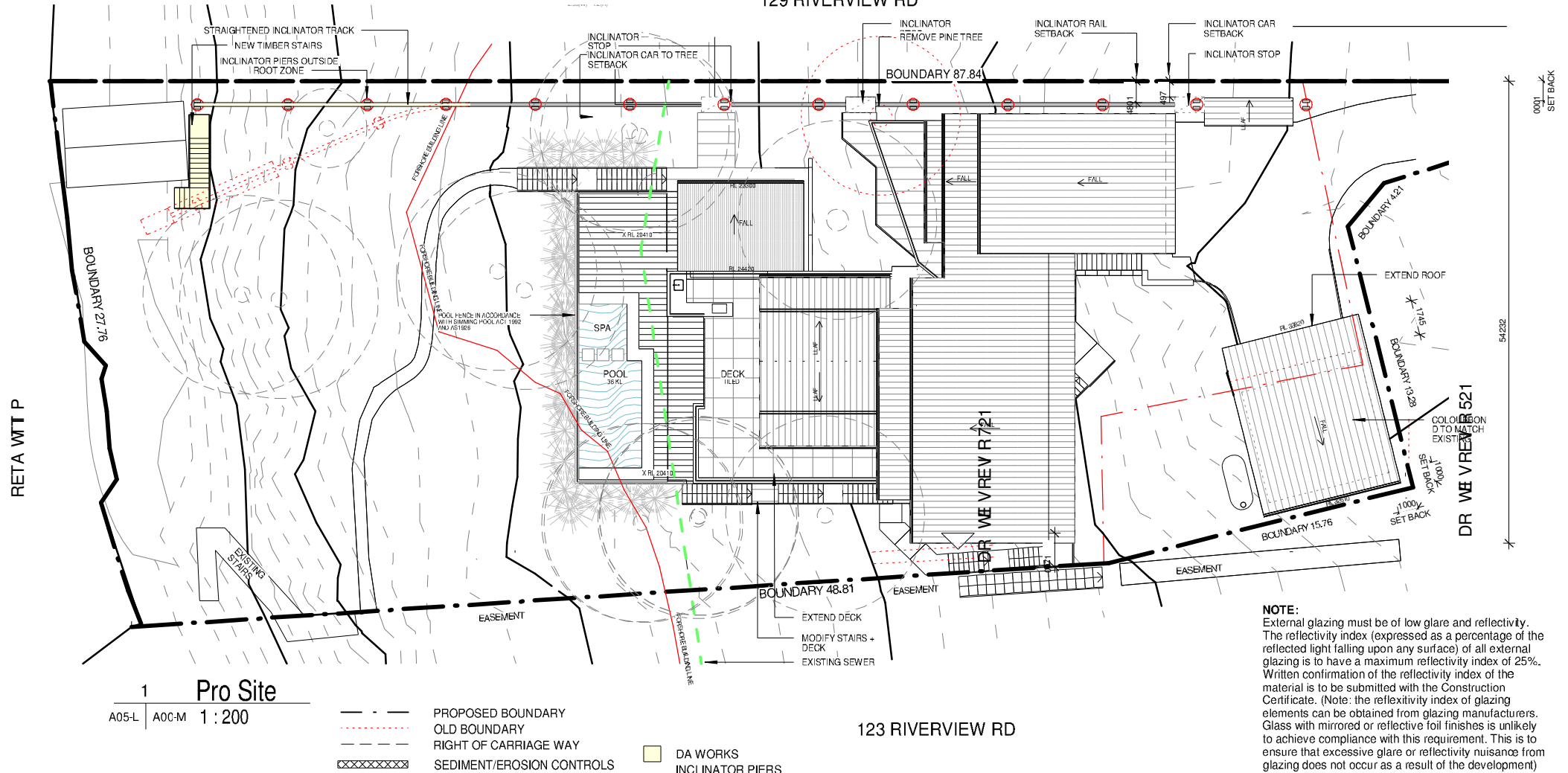

NOTE:
 External glazing must be of low glare and reflectivity. The reflectivity index (expressed as a percentage of the reflected light falling upon any surface) of all external glazing is to have a maximum reflectivity index of 25%. Written confirmation of the reflectivity index of the material is to be submitted with the Construction Certificate. (Note: the reflectivity index of glazing elements can be obtained from glazing manufacturers. Glass with mirrored or reflective foil finishes is unlikely to achieve compliance with this requirement. This is to ensure that excessive glare or reflectivity nuisance from glazing does not occur as a result of the development)

BASIX NOTES:

- MINIMUM 40% OF NEW OR ALTERED LIGHT FIXTURES ARE FITTED WITH FLUORESCENT, COMPACT FLUORESCENT OR LIGHT EMITTING DIODE LAMPS.
- ALL PLUMBING FIXTURES HAVE A 3 STAR RATING

INSULATION REQUIREMENTS

CONSTRUCTION

SUSPENDED FLOOR WITH ENCLOSED SUB FLOOR
EXTERNAL WALL: CONCRETE BLOCK/PLASTERBOARD
FLAT CEILING, FLAT ROOF : CONCRETE/ BARE INTERNAL

ADDITIONAL INSULATION REQUIRED

R0.70 (DOWN) (OR R1.30 INCLUDING CONSTRUCTION)
R1.18 (OR R1.70 INCLUDING CONSTRUCTION)
CEILING: R3.00 (UP), ROOF:NONE. LIGHT (SOLAR
ABSORPTANCE <0.475)

GLAZING REQUIREMENTS

WINDOW/DOOR NO.

ALL WINDOWS
D.2 D.3 & D.9
D.4
S1

FRAME AND GLASS TYPE

STANDARD ALUMINIUM, SINGLE CLEAR, (OR U-VALUE:7.63,
SHGC:0.75)
STANDARD ALUMINIUM, SINGLE CLEAR, (OR U-VALUE:7.63,
SHGC:0.75)
STANDARD ALUMINIUM, SINGLE PYROLYTIC LOW -E, (U-VALUE:5.7,
SHGC:0.47)

ALUMINIUM, MOULDED PLASTIC SINGLE CLEAR, (OR U-VALUE: 7.63,
SHGC: 0.75)



ARCHITECT



ph. 02 9918 5085
e. tim@thw.net.au
m. Suite 1 - Level 1, 60 Old Barrenjoey rd,
AVALON NSW 2107
reg# NSW 7417 Tim West. Nominated Architect

BASIX
Sustainable Thermal
Solutions
0420312721

STRUCTURAL
John Bagnall & Associates
99 65 8523
jbagnall.au@gmail.com

CIVIL
Nitma Consulting
0434 285585
admin@nitma.com.au

GEO
Jack Hodgson
PO Box 389
Mona Vale
NSW 1660
9979 6733

COASTAL
Coastal Environment
PO Box 353 NEWCASTLE
NSW 2300
+614 1962 8158

LANDSCAPE
Lone Pine
PO Box 5115
Elanora Heights
NSW 2101
Ed: 0422 942 264

SURVEY
Daw + Walton
PO Box 3222, Redfern
NSW 2016
(02) 8065 1156

ARBORIST
Naturally Trees
PO Box 5085,
Elanora Heights
NSW 2101
0417 250 420

PROJECT
ALTERATIONS AND ADDITIONS TO
127 RIVERVIEW RD,
AVALON NSW 2107

CLIENT
Matt and Katherine Watt
125 RIVERVIEW RD
AVALON NSW 2107
E: Matthew_watt1@bigpond.com

M	07-12-18	Rev Inclinator Piers
L	11-09-18	INCLINATOR DA
K	10-05-18	2018 SEC 96
J	06-04-18	INCLINATOR SKETCH
I	23-02-18	Section 96
H	20-10-16	REVISED CC
G	28-07-16	CC
F	20-05-16	Arborist Update
IS	Date	COMMENTS

SCALE 1:200	DRAWN BY L.J	PAGE SIZE A3
----------------	-----------------	-----------------

PROJECT NAME	JOB NUMBER
127 RIVERVIEW	067

DRAWING NAME Site Plan	DRAWING NUMBER A00-
---------------------------	------------------------