



C&A SURVEYORS

Rapid Plans,
106 Old Pittwater Road,
BROOKVALE NSW 2100.

**RE: IDENTIFICATION SURVEY PURPOSES ONLY
LOT 111 IN DEPOSITED PLAN 11936
No. 16 BANGAROO STREET, NORTH BALGOWLAH**

We have surveyed the land comprised in Certificate of Title Folio Identifier 111/11936 being Lot 111 in Deposited Plan 11936 located at North Balgowlah in the Local Government Area of Northern Beaches Parish of Manly Cove and County of Cumberland.

Upon the abovementioned property stands a one and two storey clad house with a metal roof and a clad shed with a metal roof known as No. 16 Bangaroo Street, North Balgowlah.

The positions of the house, shed and fencing in relation to the boundaries are as shown on the attached sketch.

Please note that edge of the roof attached to the fibro shed erected on Lot 1 in D.P. 1030311 to the south encroaches by up to 0.03 metre onto the subject land as shown on the sketch.

No Covenants have been investigated for the purposes of this survey. You should convince yourself that the terms of any Covenants do not adversely affect your proposed use of the property.

This report should be read in conjunction with the attached sketch prepared by us dated 6 November, 2020 which forms part of this report.

The survey shown on the attached sketch is for identification survey purposes only. Should further additions or improvements be proposed upon the subject property after this date the boundaries must be marked on the ground prior to construction.

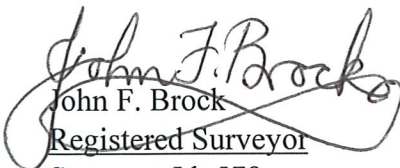
John F. Brock
Registered Surveyor
Surveyor Id. 578

Ref: 15765/20 ID
Date: 6 November, 2020



SKETCH - NOT TO SCALE

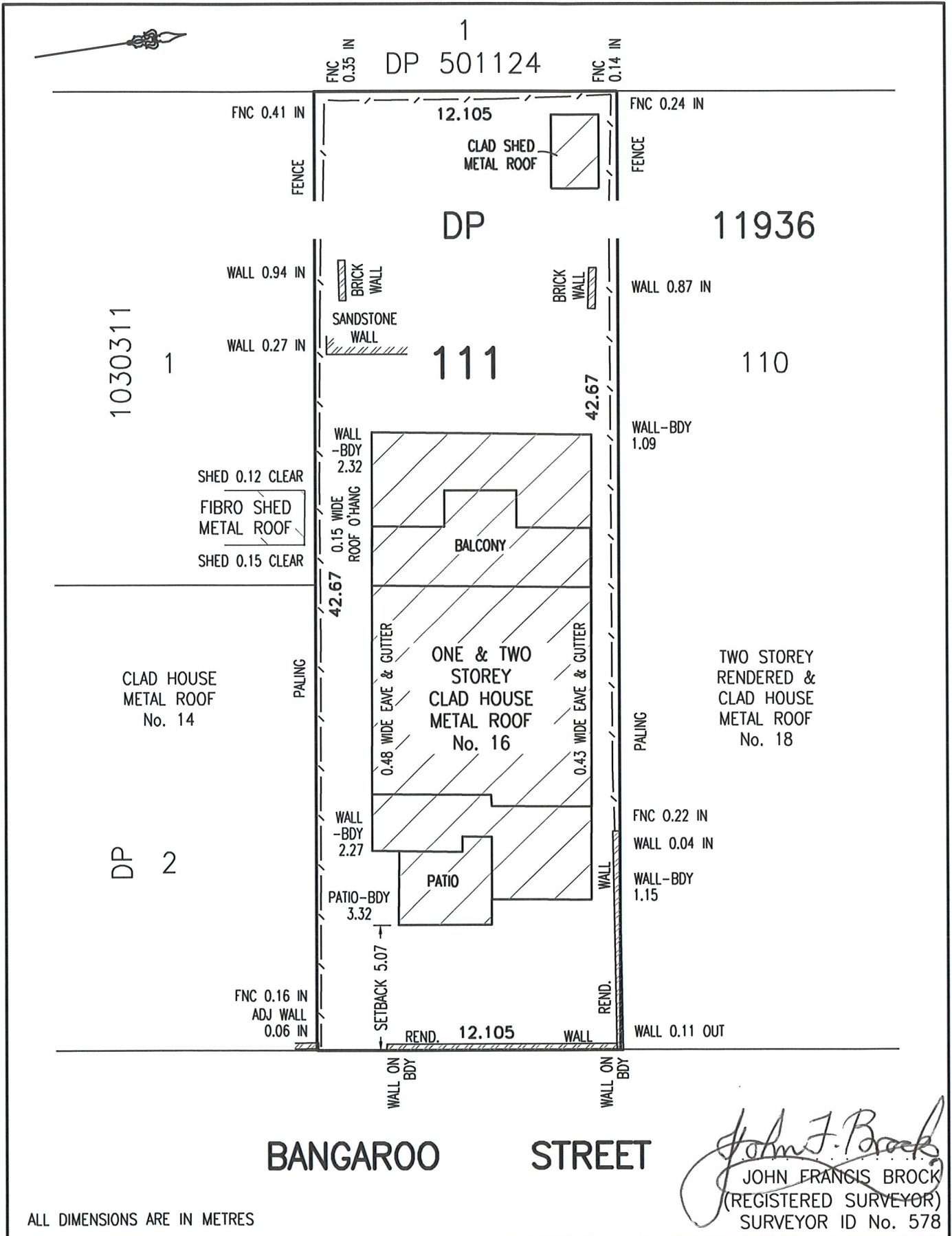

ALL DIMENSIONS ARE IN METRES