

SITE LOCATION

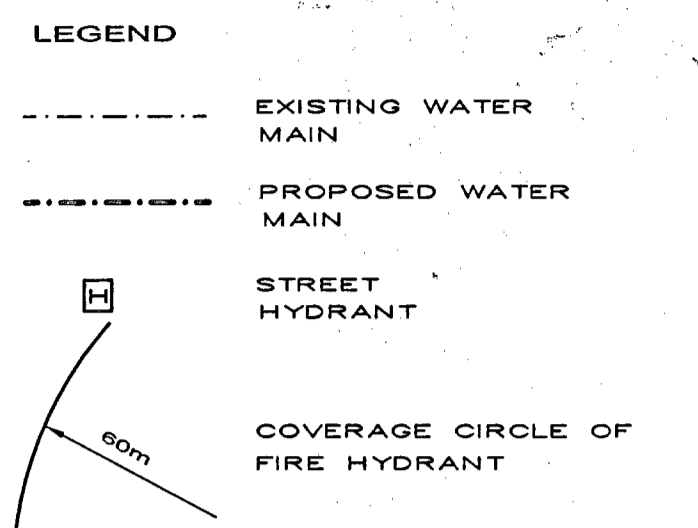

REV	ISSUE	BY	CHKD	DATE
A	PRELIMINARY ISSUE	AM	AT	07.06.06

DISCIPLINE	DRG NO.	REV	REASON FOR ISSUE
ARCHITECTURAL	21.04.06		PRELIMINARY AUTHORIZATION
STRUCTURAL			BY:
LANDSCAPE			BY:
ELECTRICAL			VERIFICATION OF LATEST AMENDMENT
CIVIL	26.05.06		BY:

HYDRAULIC ENGINEERS:
thomsonkane
 Consulting Hydraulic and Fire Engineers
 281 Pacific Highway, North Sydney NSW 2060
 Phone: (02) 9955 0788 Fax: (02) 9954 5532
 Email: h@thomsonkane.com.au
 WWW.THOMSONKANE.COM.AU
 ACN 109 803 849
 THIS DRAWING IS COPYRIGHT ©

ARCHITECTS:
Denis Leech Associates P/L
 350 George Street, Sydney NSW 2000
 Tel: (02) 9997 7288 Fax: (02) 9997 316

MASTER PLANNING:
Wolski, Lycenko & Brechnock
 115 Military Road, Neutral Bay NSW 2089
 Tel: (02) 9953 8477 Fax: (02) 9953 855

ELECTRICAL:
WEBB AUSTRALIA
 37 Ryde Road, Pymble NSW 2073
 Tel: (02) 9418 1444 Fax: (02) 9418 1191

ENVIRONMENTAL:
WP Brown & Partners Pty Ltd
 Level 2, 82 Waterloo Road
 Mosquero Park NSW 2113
 Tel: (02) 9900 1000 Fax: (02) 9900 1091

LANDSCAPE:
Place Planning & Design P/L
 Suite 10, Norberry Terrace, 177 Pacific Hwy
 North Sydney NSW 2060
 Tel: (02) 9959 5021 Fax: (02) 9959 580

PROJECT:
PROPOSED RESIDENTIAL SUBDIVISION - 5 WARRIEWOOD VALLEY, WARRIEWOOD NSW

TITLE: HYDRAULIC SERVICES
SITE PLAN FIRE SERVICE

SCALE:	1:500	PROJECT NO:	4733-2H	CAD REF:	T:TKNEW/
DATE:	MAY '06	DRAWING NUMBER:	H-04	REVISION:	A
DRAWN BY:	AT	CHKD BY:	AT		

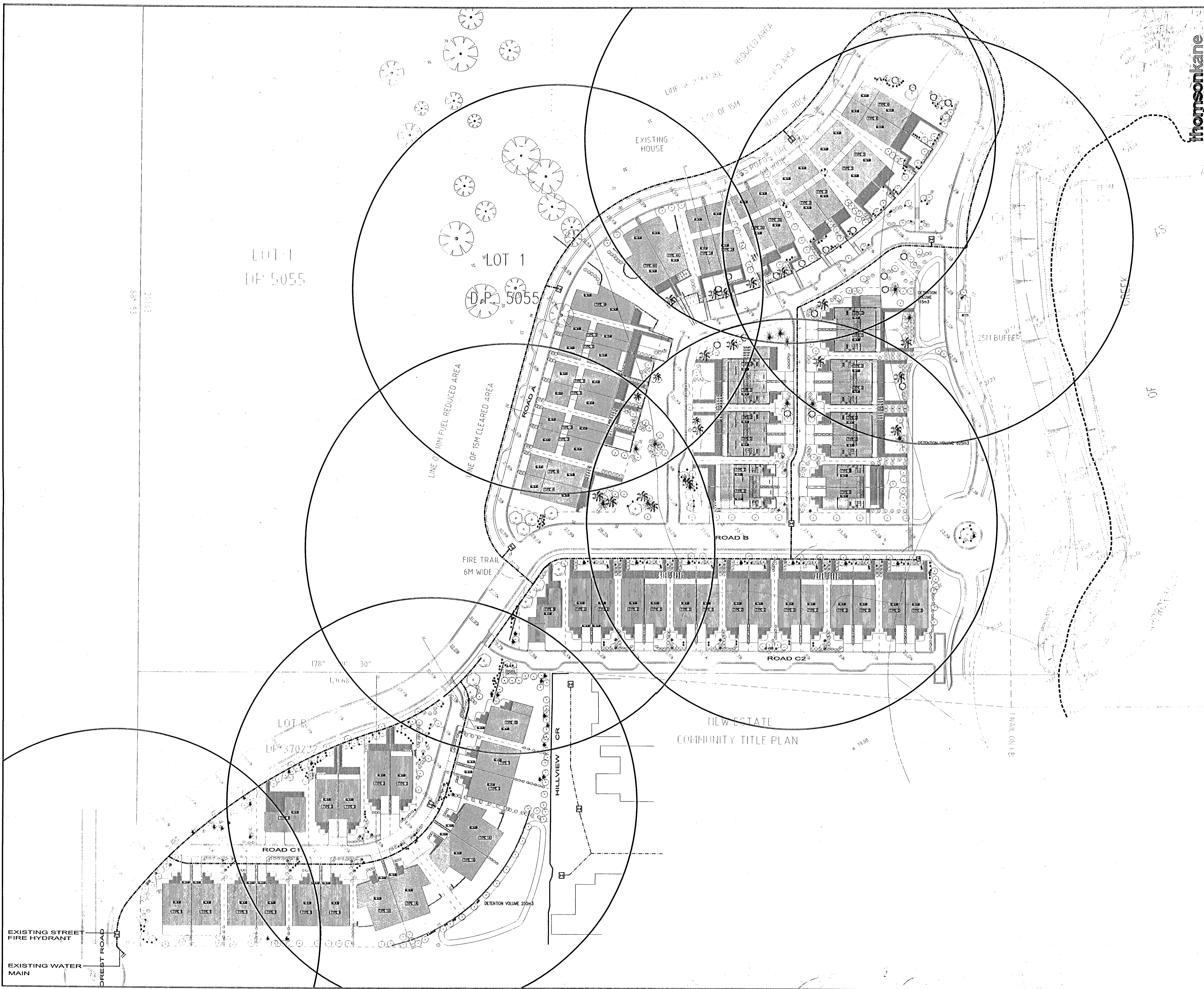

thomsonkane

EXISTING STREET FIRE HYDRANT
 DREST ROAD
 EXISTING WATER MAIN