

Contact Us	
The General Manager, 725 Pittwater Road, Dee Why NSW 2099 or Customer Service Centre, Northern Beaches Council DX9118 Dee Why	
Email	council@warringah.nsw.gov.au
Fax	9942 2606
If you need help lodging your application call Customer Service on (02) 9942 2111 or come in and talk to us at the Civic Centre, Dee Why.	

Office Use Only											

### Part 1: Declaration

1. DECLARATION	
I hereby certify that the shadow diagrams submitted with the proposal at	
Address	
For the erection of <i>Description of development</i>	
<ul style="list-style-type: none"> <li>In accordance with the survey (prepared by a registered surveyor) which is required to be submitted with the application</li> <li>Drawn to true north</li> <li>Indicate shadow cast by the proposal at 9am, noon, 3pm, 21 June</li> <li>To indicate the shadow cast by existing buildings and structures on the site and in the surrounding area</li> </ul>	





### Part 2: Certification

2. CERTIFIER			
Title	Mr	Mrs	Ms
	Other		
Full family name <i>(no initials) (or Company)</i>			
Full given names <i>(no initials) (or A.C.N)</i>			
Phone		Alternate	
Mobile		Fax	
Qualification <i>(i.e. Architect, Planner, Computer Technician, Surveyor)</i>			

### Part 3: Signature

3. APPLICANT(S) SIGNATURE	
Signature	
Date	

# SHADOWS 21 JUNE 9AM

-  Shadows Existing
-  Shadows Proposed
-  Existing Building #25 Loch St
-  DA Approved Building #23 Loch St

Loch Street

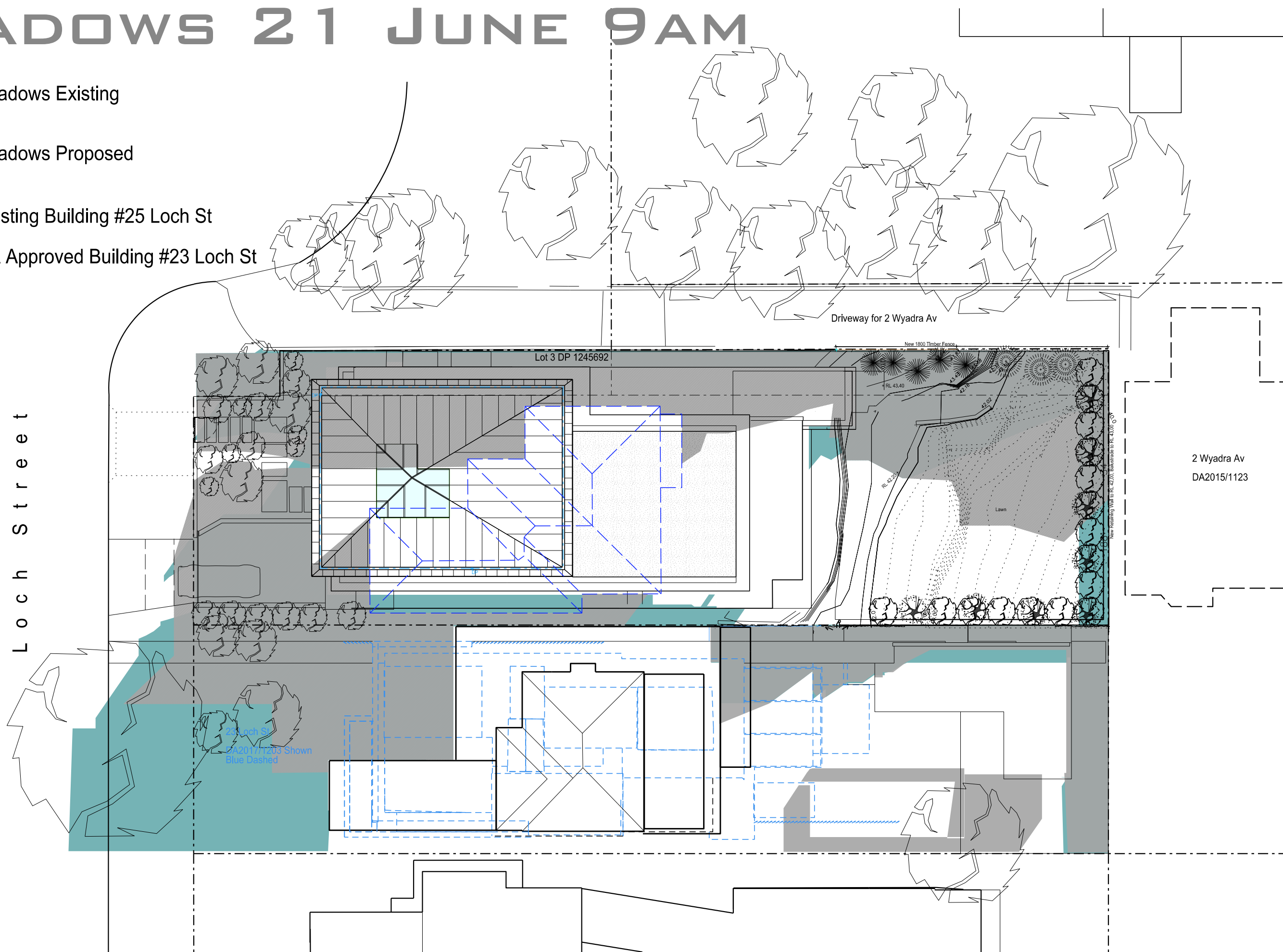

0 2 4 10 20 m

For Development Application



No	Revision	Title
S.09 d1		Shadow Diagram 21st June 9am
	Scale	1:200 on A3
	Date	April 2019
	Drawn	ro

**S.09 d1**





**Project**  
New Residence  
25 Loch St, Freshwater  
for  
Johanna and Andrew Smith  
Lot 3 DP 1245692, Lot 8 DP 14040, Lot 2 DP 1213087

**Architect**  
**ROLF OCKERT. ARCHITECT.**  
71-73 Australia Street Camperdown NSW 2050 Australia  
p 0 400 661858 e: architects@rodesign.com.au  
www.ro-ar.com.au

DO NOT SCALE OFF DRAWINGS. USE FIGURED DIMENSIONS ONLY. ALL DIMENSIONS TO BE CHECKED AND VERIFIED ON SITE. THIS DRAWING IS COPYRIGHT AND MAY NOT BE REPRODUCED WITHOUT WRITTEN CONSENT

© Rolf Ockert, Architect, Pty Ltd 2018-

# SHADOWS 21 JUNE 12PM

-  Shadows Existing
-  Shadows Proposed
-  Existing Building #25 Loch St
-  DA Approved Building #23 Loch St

Loch Street

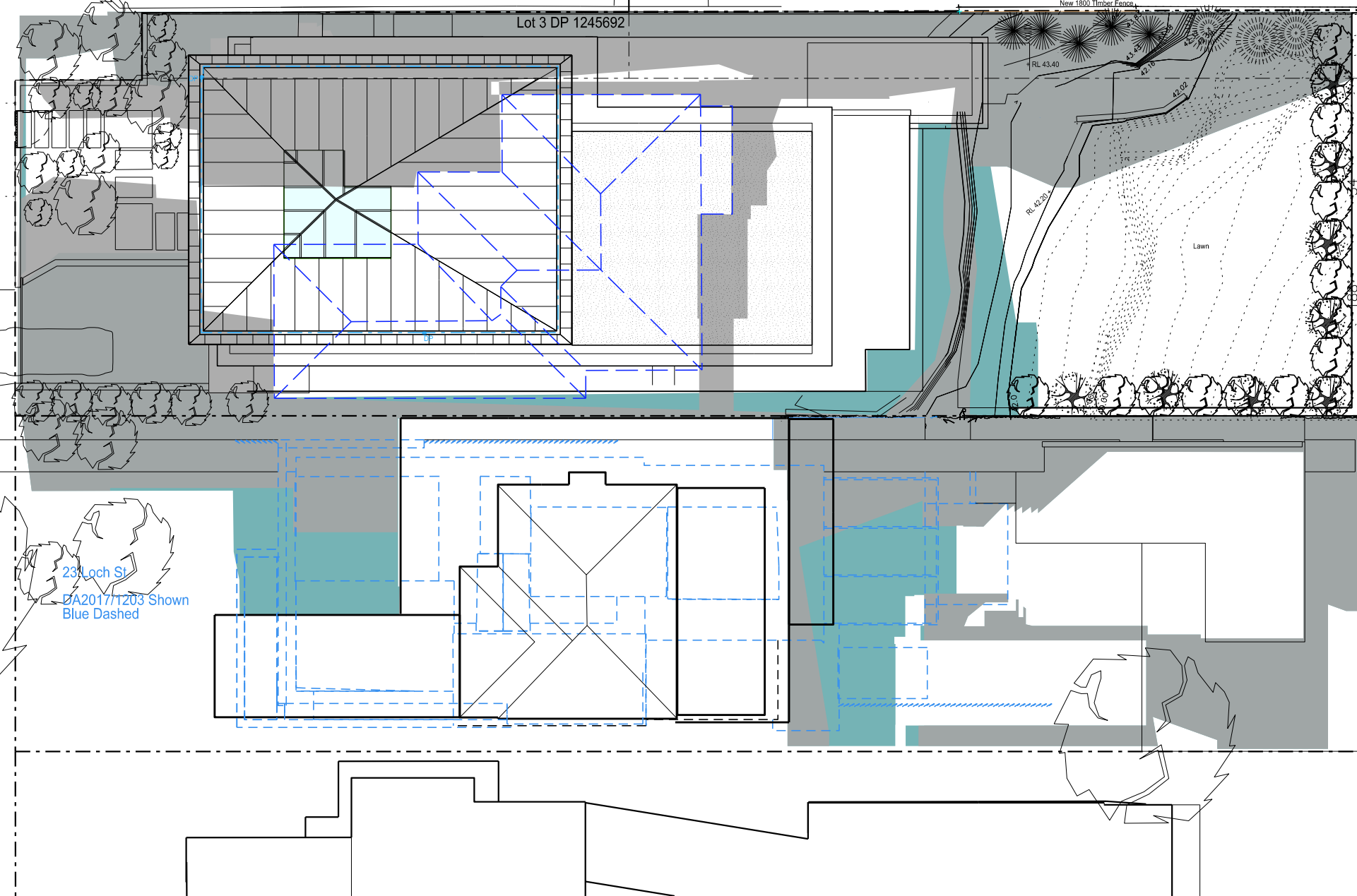

2 Wyadra Av  
DA2015/1123

0 2 4 10 20 m

For Development Application



No	Revision	Title
S.12 d1		Shadow Diagram 21st June 12pm
		Scale 1:200 on A3
		Date April 2019
		Drawn ro

**S.12 d1**





**Project**  
New Residence  
25 Loch St, Freshwater  
for  
Johanna and Andrew Smith  
Lot 3 DP 1245692, Lot 8 DP 14040, Lot 2 DP 1213087

**Architect**  
**ROLF OCKERT. ARCHITECT.**  
71-73 Australia Street Camperdown NSW 2050 Australia  
p 0 400 661858 e: architects@rodesign.com.au  
www.ro-ar.com.au

DO NOT SCALE OFF DRAWINGS. USE FIGURED DIMENSIONS ONLY. ALL DIMENSIONS TO BE CHECKED AND VERIFIED ON SITE. THIS DRAWING IS COPYRIGHT AND MAY NOT BE REPRODUCED WITHOUT WRITTEN CONSENT

© Rolf Ockert, Architect, Pty Ltd 2018-

# SHADOWS 21 JUNE 3PM

-  Shadows Existing
-  Shadows Proposed
-  Existing Building #25 Loch St
-  DA Approved Building #23 Loch St

Loch Street

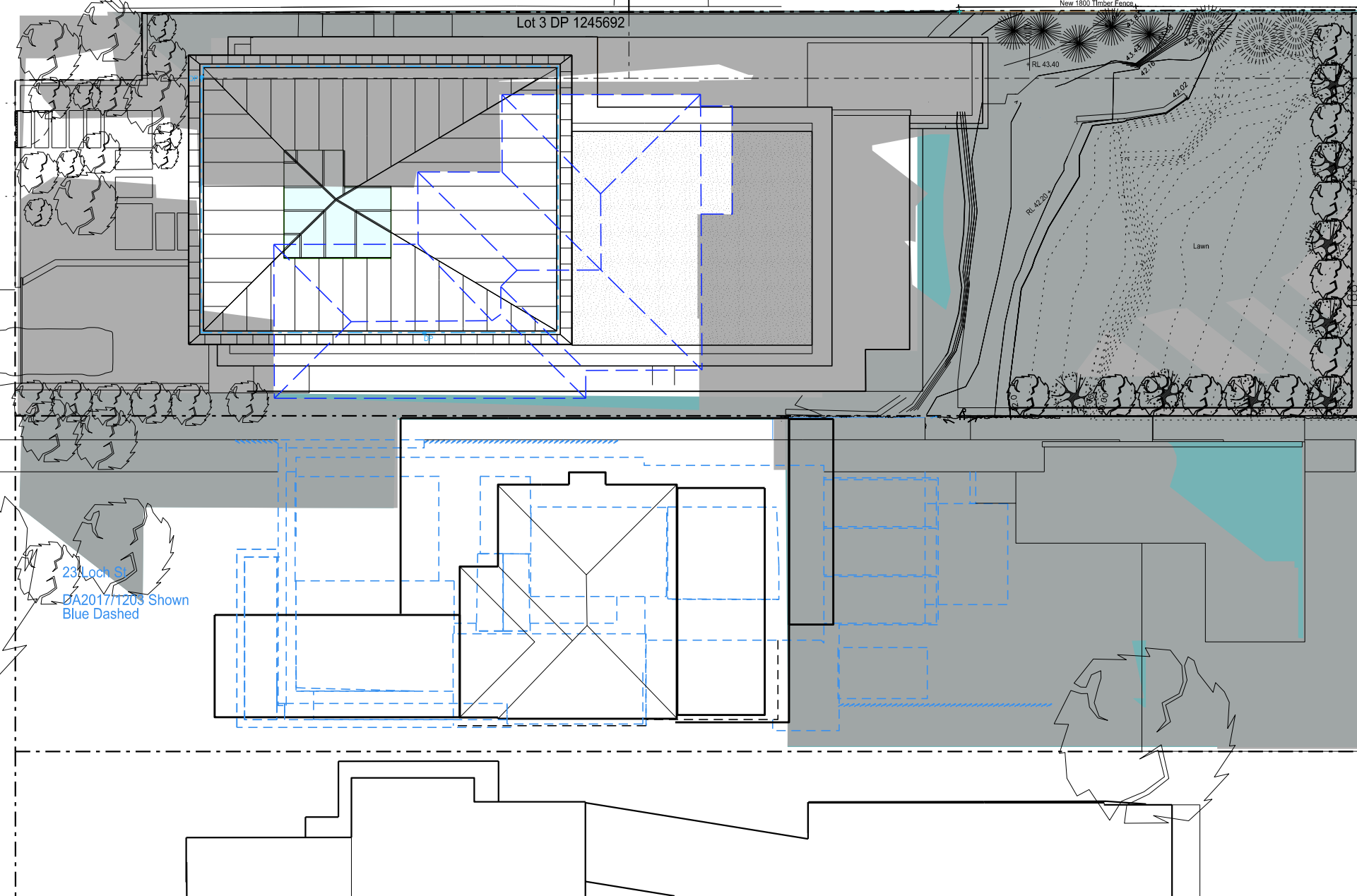

2 Wyadra Av  
DA2015/1123

23 Loch St  
DA2017/1203 Shown  
Blue Dashed

0 2 4 10 20 m

For Development Application



No	Revision	Title
S.15 d1		Shadow Diagram 21st June 3pm
		Scale 1:200 on A3
		Date April 2019
		Drawn ro

**S.15 d1**

**Project**  
New Residence  
25 Loch St, Freshwater  
for  
Johanna and Andrew Smith  
Lot 3 DP 1245692, Lot 8 DP 14040, Lot 2 DP 1213087

**Architect**  
**ROLF OCKERT. ARCHITECT.**  
71-73 Australia Street Camperdown NSW 2050 Australia  
p 0 400 661858 e: architects@rodesign.com.au  
www.ro-ar.com.au

DO NOT SCALE OFF DRAWINGS. USE FIGURED DIMENSIONS ONLY. ALL DIMENSIONS TO BE CHECKED AND VERIFIED ON SITE. THIS DRAWING IS COPYRIGHT AND MAY NOT BE REPRODUCED WITHOUT WRITTEN CONSENT

© Rolf Ockert, Architect, Pty Ltd 2018-