

DRIVEWAY GRADIENT DIAGRAM 1:200

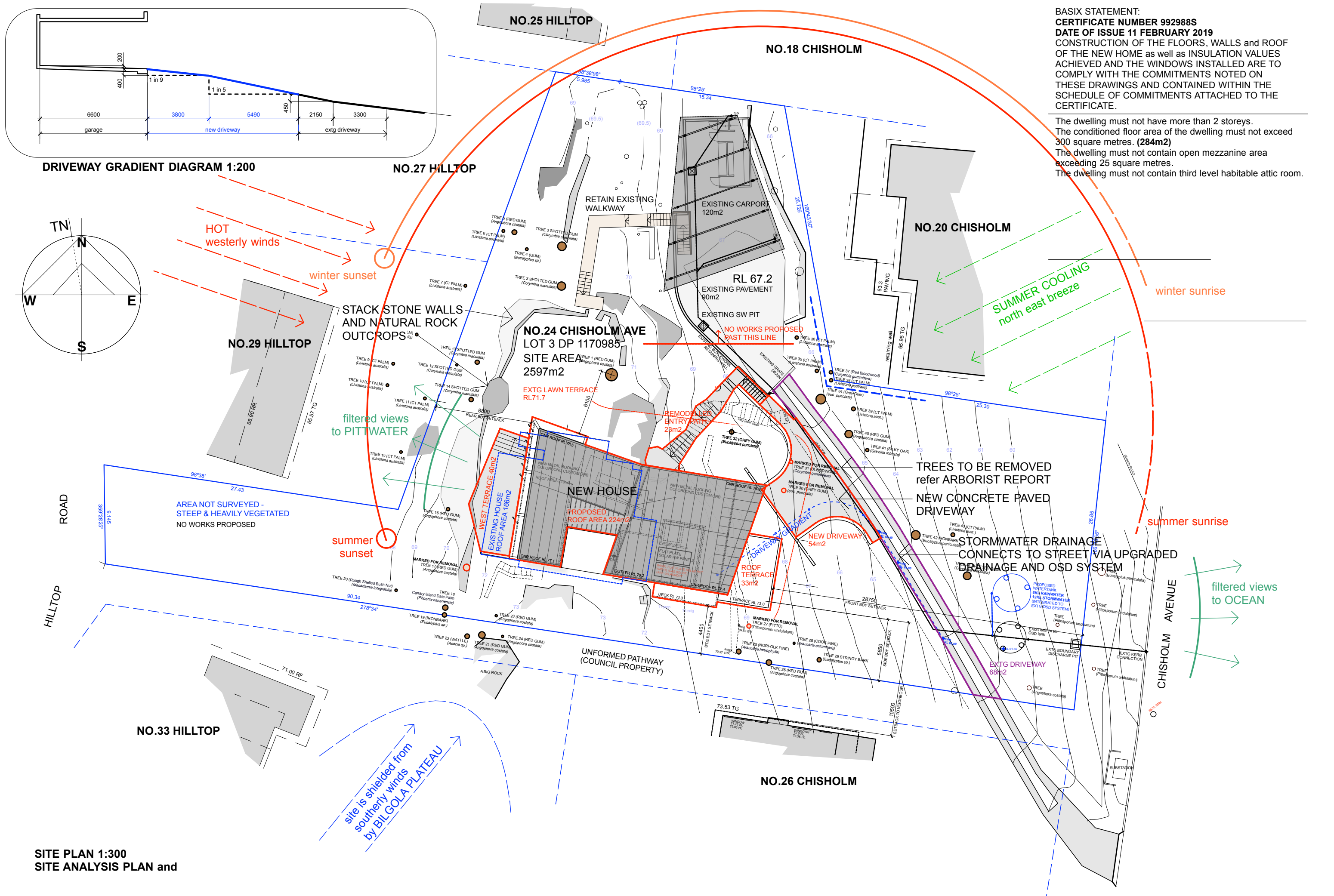
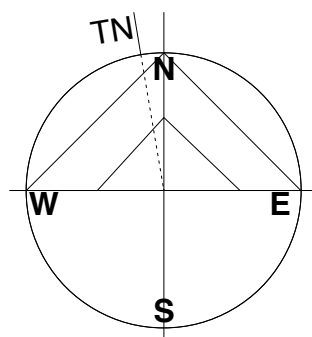

BASIX STATEMENT:
CERTIFICATE NUMBER 992988S
DATE OF ISSUE 11 FEBRUARY 2019
CONSTRUCTION OF THE FLOORS, WALLS and ROOF
OF THE NEW HOME as well as INSULATION VALUES
ACHIEVED AND THE WINDOWS INSTALLED ARE TO
COMPLY WITH THE COMMITMENTS NOTED ON
THESE DRAWINGS AND CONTAINED WITHIN THE
SCHEDULE OF COMMITMENTS ATTACHED TO THE
CERTIFICATE.

The dwelling must not have more than 2 storeys.
The conditioned floor area of the dwelling must not exceed
300 square metres. (284m2)
The dwelling must not contain open mezzanine area
exceeding 25 square metres.
The dwelling must not contain third level habitable attic room.

SITE PLAN 1:300
SITE ANALYSIS PLAN and

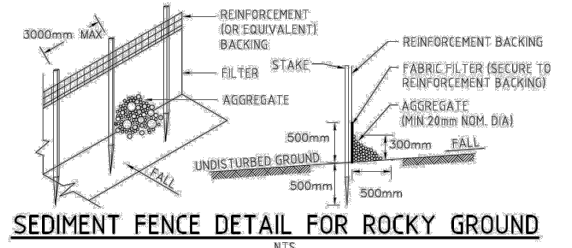
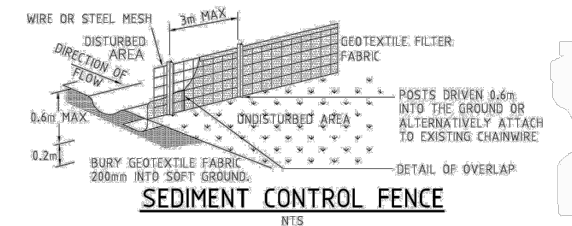

- SEDIMENT FENCE NOTES:**
1. CONSTRUCT SEDIMENT FENCE AS CLOSE AS POSSIBLE TO PARALLEL TO THE CONTOURS OF THE SITE OR AT THE TOE OF A SLOPE.
 2. DRIVE 1.5 METRE LONG STAR PICKETS INTO GROUND SUFFICIENT TO PROVIDE RIGID SUPPORT, 3 METRES APART. WHERE THERE IS INSUFFICIENT SOIL DEPTH OVER ROCK, HOLES ARE TO BE DRILLED INTO ROCK TO ACCEPT THE STAR PICKETS.
 3. ON SOFT GROUND MATERIALS, DIG A 150mm DEEP TRENCH ALONG THE UPSLOPE LINE OF THE FENCE FOR THE BOTTOM OF THE FABRIC TO BE ENTRENCHED.
 4. BACKFILL TRENCH OVER BASE OF FABRIC & COMPACT.
 5. FIX SELF-SUPPORTING GEOTEXTILE TO UPSLOPE SIDE OF POSTS WITH WIRE TIES OR AS RECOMMENDED BY THE GEOTEXTILE MANUFACTURER. USE A REINFORCEMENT BACKING WITH NON SELF-SUPPORTING GEOTEXTILE FABRIC.
 6. JOIN SECTIONS OF FABRIC AT A SUPPORT POST WITH A 150mm OVERLAP.
 7. ON HARD OR ROCKY GROUND, SMOOTH A 500mm WIDE STRIP UPSLOPE OF THE FENCE LINE. TURN THE BOTTOM 500mm OF THE FABRIC UPSLOPE AND ANCHOR IN PLACE WITH SUITABLE AGGREGATE.
 8. WHERE A SEDIMENT FENCE IS CONSTRUCTED DOWN SLOPE FROM A DISTURBED BATTER THE FENCE SHOULD BE LOCATED 1.5 TO 2.0 METERS DOWN SLOPE FROM THE TOE OF THE BATTER.

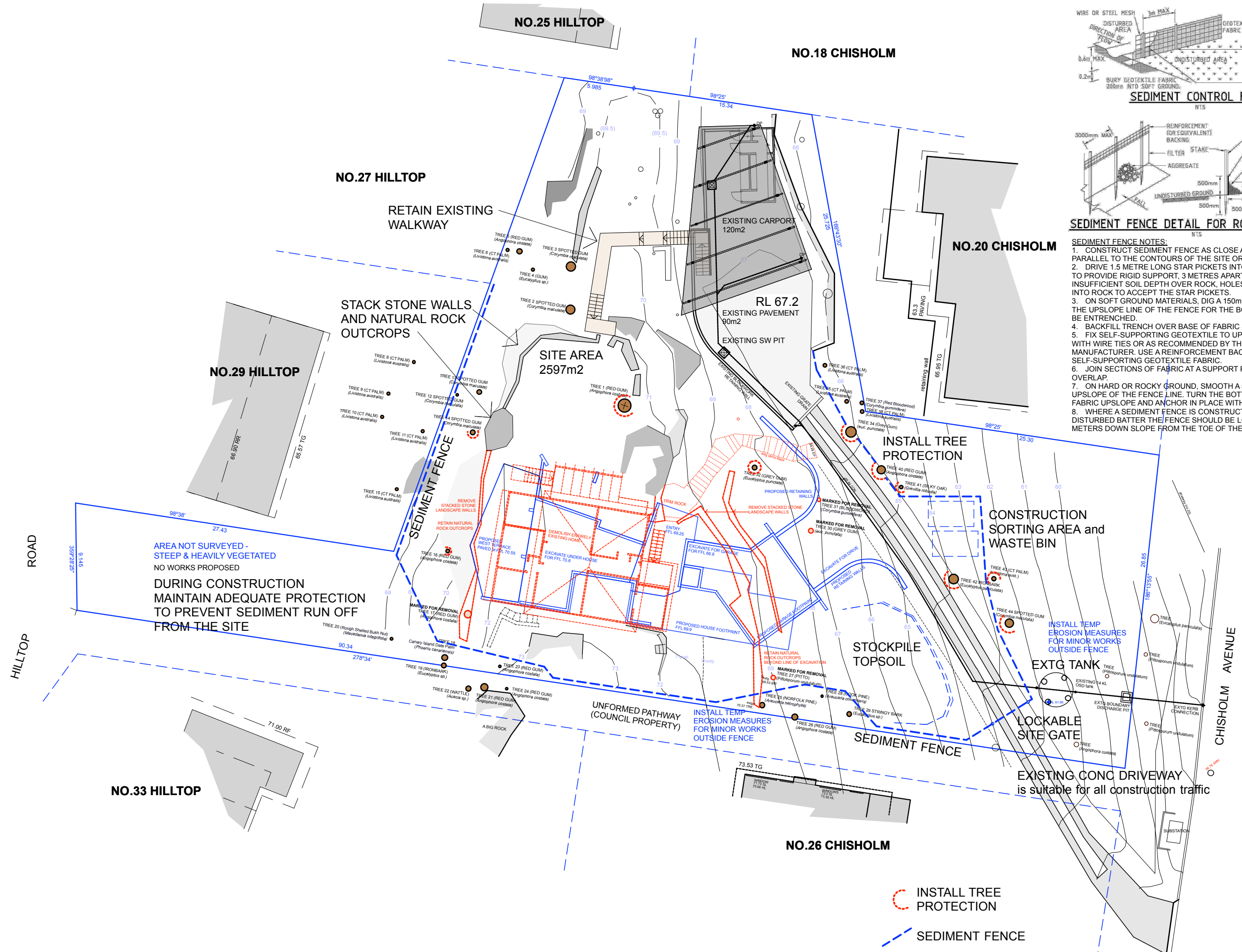

BASIX STATEMENT:
CERTIFICATE NUMBER 992988S
DATE OF ISSUE 11 FEBRUARY 2019
CONSTRUCTION OF THE FLOORS, WALLS and ROOF
OF THE NEW HOME as well as INSULATION VALUES
ACHIEVED AND THE WINDOWS INSTALLED ARE TO
COMPLY WITH THE COMMITMENTS NOTED ON
THESE DRAWINGS AND CONTAINED WITHIN THE
SCHEDULE OF COMMITMENTS ATTACHED TO THE
CERTIFICATE.

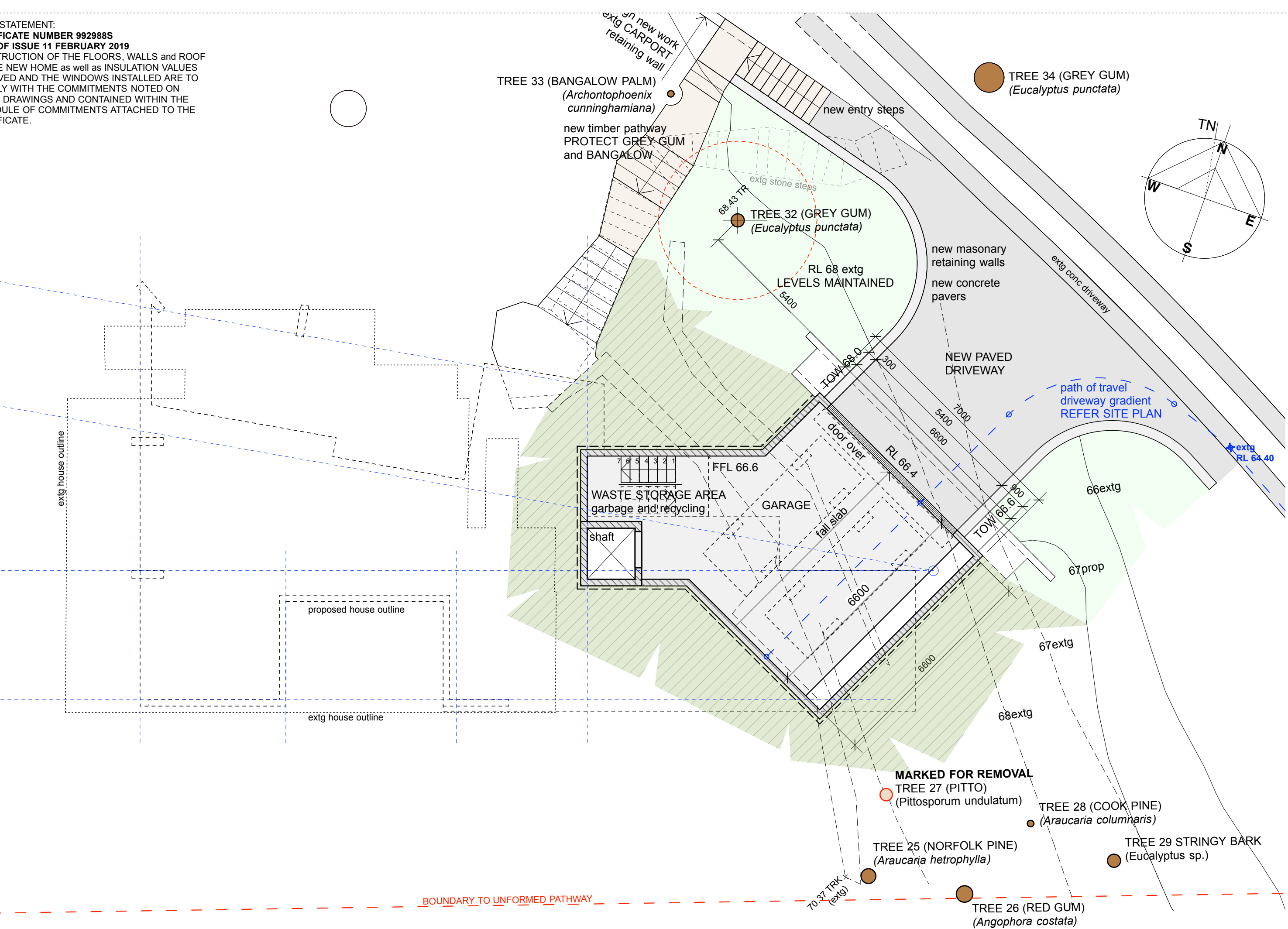

BASIS STATEMENT:
CERTIFICATE NUMBER 992988S
DATE OF ISSUE 11 FEBRUARY 2019
 CONSTRUCTION OF THE FLOORS, WALLS and ROOF
 OF THE NEW HOME as well as INSULATION VALUES
 ACHIEVED and THE WINDOWS INSTALLED ARE TO
 COMPLY WITH THE COMMITMENTS NOTED ON
 THESE DRAWINGS AND CONTAINED WITHIN THE
 SCHEDULE OF COMMITMENTS ATTACHED TO THE
 CERTIFICATE.

BASIS INSULATION SCHEDULE CONSTRUCTION	INSULATION (R-Value)
FLOOR	
- concrete slab on ground, (100 sqm)	R1 (slab edge) (in-slab heating system)
- suspended floor above open subfloor (35 sqm), framed.	R0.8 (or 1.5 including construction) (down)
- above habitable rooms or mezzanine (122 sqm), framed.	nil
- suspended floor above garage, concrete	nil (in-slab heating system)
EXTERNAL WALL	
- reverse brick veneer	R2.86 (or R3.40 including construction)
- cavity brick	R0.5 (or 1.17 including construction)
- framed (weatherboard, metalclad)	R3.00 (or 3.40 including construction)
CEILING AND ROOF (framed)	
flat ceiling	R4.5 (up)
flat roof	foil backed blanket (55 mm)
ROOFING	medium colour (solar absorptance 0.475-0.70)

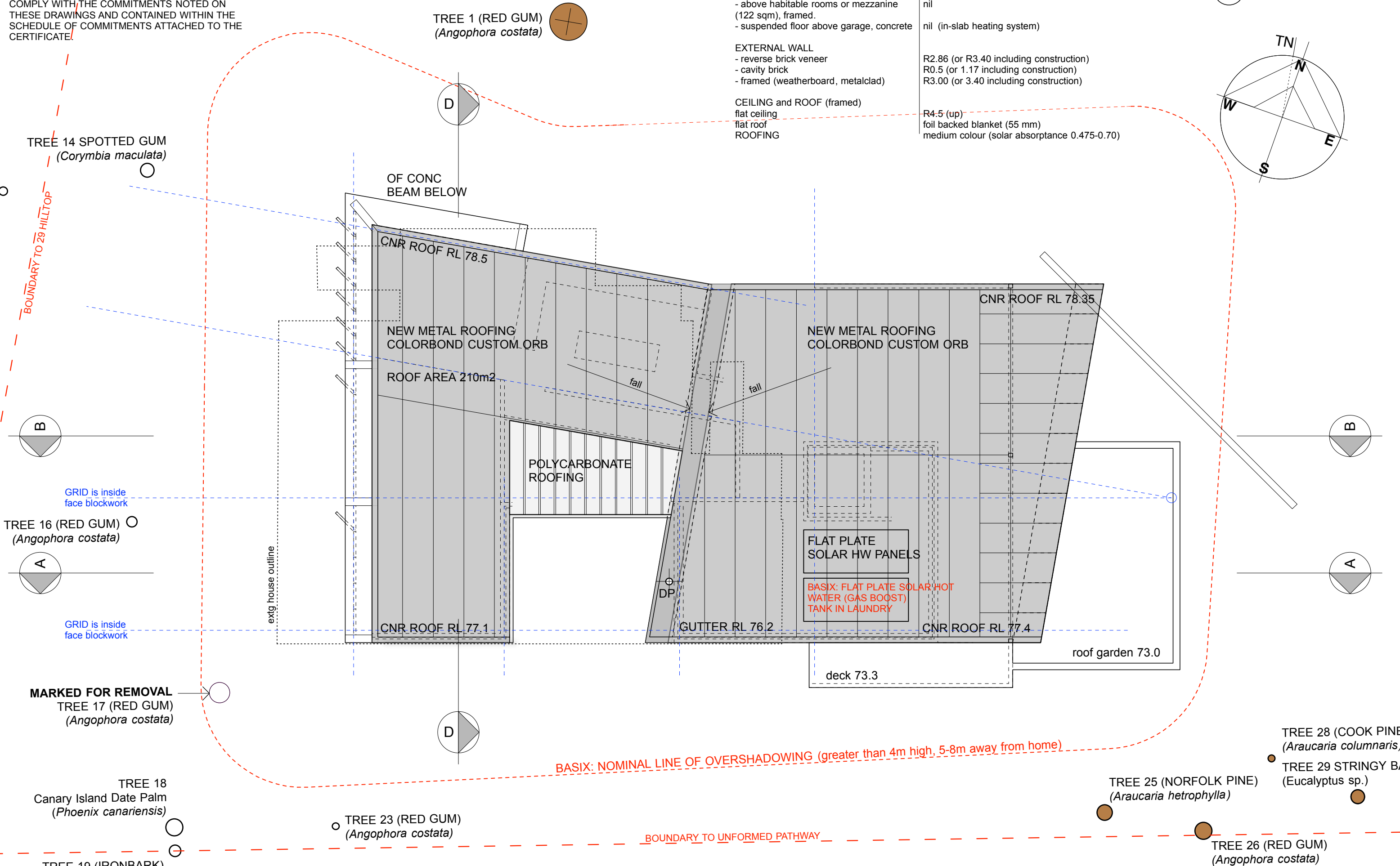
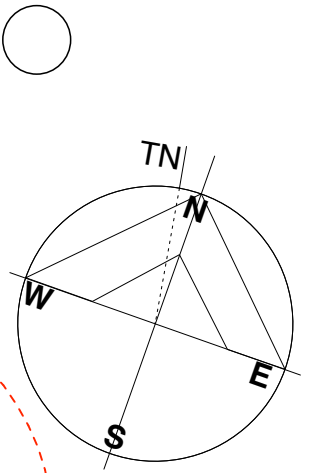

BASIX STATEMENT:
CERTIFICATE NUMBER 992988S
DATE OF ISSUE 11 FEBRUARY 2019
CONSTRUCTION OF THE FLOORS, WALLS and ROOF
OF THE NEW HOME as well as INSULATION VALUES
ACHIEVED AND THE WINDOWS INSTALLED ARE TO
COMPLY WITH THE COMMITMENTS NOTED ON
THESE DRAWINGS AND CONTAINED WITHIN THE
SCHEDULE OF COMMITMENTS ATTACHED TO THE
CERTIFICATE.

