



Warringah Council

DA 30 / 2012 CLAUSE 9

23 April 2012

Mitchell
Drake

Application for Street Levels

Made under the Roads Act 1993 (Section 138)

Address the application to:

- ☐ The General Manager
Warringah Council
Civic Centre, 725 Pittwater Road
Dee Why NSW 2099

Or

- ☐ Customer Service Centre
Warringah Council
DX 9118 Dee Why

If you need help lodging your application:

- ☐ Phone our Customer Service Centre
on (02) 9942 2111

Or

- ☐ Come in and talk to us

Office Use Only

SL 2012 / 0127

RA # 100160131
December 11

For applicable fees and charges, please refer to Council's website: www.warringah.nsw.gov.au or contact our Customer Service Centre

Privacy and Personal Information Protection Notice

The personal information requested in this form is required by or under the Roads Act 1993 (Section 138) and will only be used by Warringah Council in connection with the requirements of that Act and any other relevantly applicable legislation relating to the subject-matter of this application. The information is being collected for the following purposes, namely, to enable us to (1) process and determine your application; (2) contact you in relation to your application should that be necessary; and (3) keep the public informed by making the application publicly accessible. If you do not provide the information, Council will not be able to process your application, and Council may even have the right to reject your application.

Your application will be available to Councillors and Council Officers. Members of the public have certain rights of access to information and documents held by Council under the Government Information (Public Access) Act 2009 (GIPA), and under the Privacy Information Protection Act 1998 (NSW) to the extent permitted by those Acts

Warringah Council is to be regarded as the agency that holds the information, which will be stored on Council's records management system or in archives and may be displayed on eServices (except as regards to personal particulars). You have a right to access information within the meaning of the Privacy and Personal Information Protection Act 1998 (NSW) on application to Council, and to have that information updated or corrected as necessary. Please contact Warringah Council if the information you have provided is incorrect or changes or if access is otherwise sought to the information. In addition, a person may request that any material that is available (or is to be made available) for public inspection by or under the Local Government Act 1993 (NSW) be prepared or amended so as to omit or remove any matter that would disclose or discloses the person's place of living if the person considers that the disclosure would place or places the personal safety of the person or of members of the person's family at risk. Any such request must be made to Council's General Manager: see s.739 of the Local Government Act 1993 (NSW).

PART 1 Subject Land

Subject land

Residential



Industrial



Multi-residential



Please tick a box

Address

32 BADCORE RD

CPOMER

Postcode 2099

Development application number (if applicable)

DA 30 / 2012

Part 6 - Inspection Report

6.1 Work required

Please tick where applicable

Remove

☐ Kerb ___ m ☐ Gutter ___ m ☐ Gutter Crossing ___ m

☐ Foot paving ___ m x ___ m wide

☐ Other

6.2 Construct

Please tick where applicable

Construct

☐ Kerb ___ m ☐ Gutter ___ m ☐ Gutter Crossing ___ m

☐ Foot paving ___ m x ___ m wide

☐ Footpath Crossing Slab ___ m long x ___ m wide x ___ m wide

☐ Other

General remarks

Inspected by

--

Date ___ / ___ / ___

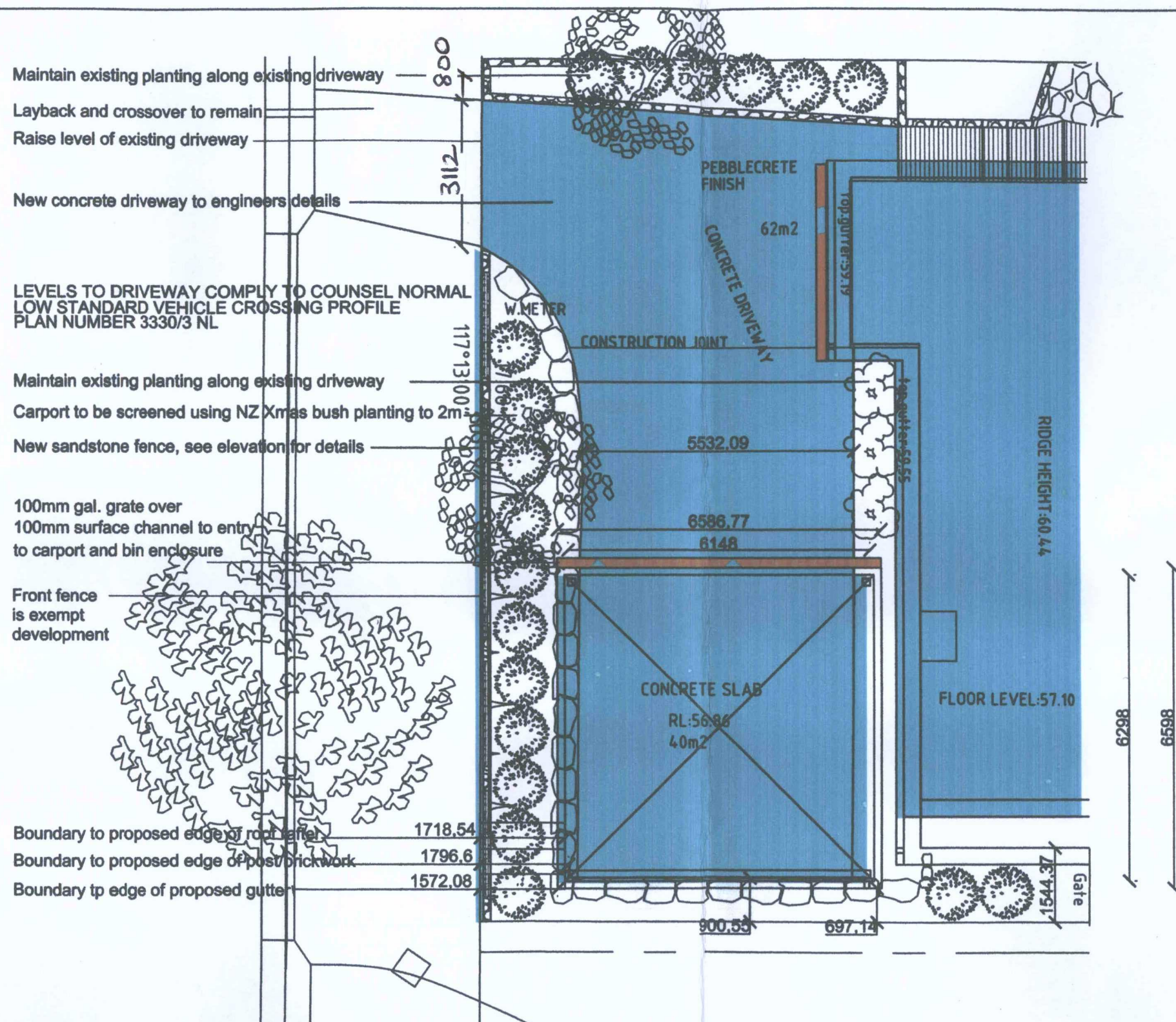

10

GROUND FLOOR ENTRY PLAN 1:100

CONSTRUCTION ONLY



ART OF CONSTRUCTION AUSTRALIA
RESIDENTIAL BUILDING

AOCA P/L www.aoca.com.au
PO Box 342 Glebe NSW 2037
Suite 505 Tenth Rd Glebe NSW 2037
Fax: 9571 6241
Mobile: 0412 404 242
Telephone: 9571 6240
enquiries@aoca.com.au



Member of
Building Designers
Association of NSW Inc.

Project North

© Copyright
Art Of Construction
Australia

AOCA reserves all rights to this drawing, this drawing remains the property of AOCA and may not be copied without written consent, all content including intellectual property of AOCA, all copies of this drawing will be returned upon request.

The builder shall check and verify all dimensions and verify all errors and corrections to the Architect. Do not scale the drawings. Drawings shall not be used for construction purposes until issued by the architect for construction.

Client:
CLIENTNAME?

Project Name:



41DP237862

Drawing title:

NAME?
TYPE?

Scale: 1 : 100

Status: C/C

Project No.

03

8/5/12

Date: DATE?

Checked By: A.R.

Drawing No.

DWG No.

10