

NUMBER	BEARING	DISTANCE
1	277°18'15"	4.425
2	355°54'15"	4.685
3	285°56'15"	6.85
4	253°19'15"	6.85
5	220°42'15"	6.85
6	198°46'15"	8.91
7	159°01'15"	3.915
8	108°58'15"	2.5
9	53°30'15"	12.02
10	98°30'25"	13.225
11	98°30'15"	6.37
12	8°34'15"	5
13	98°36'15"	4
14	8°19"	8.58
15	278°19'15"	1.795
16	143°20'15"	5.175
17	199°03'05"	10.17
18	176°11'45"	4.58
19	356°11'50"	20.245

- (A) - DENOTES EASEMENT FOR DRAINAGE VIDE 0.915 WIDE. VIDE L138868, R516192, R666437
- (B) - DENOTES EASEMENT FOR SEWERAGE AND SUBMAIN 9.145 & 9.94 WIDE VIDE G626357, H159920, H918589, AND GOV. GAZ 21/11/1958.
- (C) - DENOTES EASEMENT TO DRAIN WATER VIDE L995589.
- (D) - DENOTES EASEMENT TO DRAIN WATER 2.44 WIDE VIDE DP536160
- (E) - DENOTES EASEMENT TO DRAIN WATER 0.915 WIDE VIDE M669981
- (F) - DENOTES EASEMENT FOR SUPPORT VARIABLE WIDTH. VIDE L359204

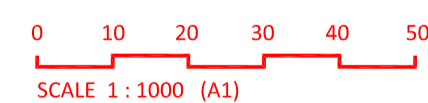

IMPORTANT NOTE

1. This plan was prepared for the sole purposes of the client for the specific purpose of producing a detail plan. This plan is strictly limited to the purpose and does not apply directly or indirectly and will not be used for any other application, purpose, use or matter. The plan is presented without the assumption of a duty of care to any other person (other than the Client) ("Third Party") and may not be relied on by Third Party.

2. RPS Australia East Pty Ltd will not be liable (in negligence or otherwise) for any direct or indirect loss, damage, liability or claim arising out of or incidental to:

- A. Third Party publishing, using or relying on the plan;
- B. RPS Australia East Pty Ltd relying on information provided to it by the Client or a Third Party where the information is incorrect, incomplete, inaccurate, out-of-date or unreasonable;
- C. Any inaccuracies or other faults with information or data sourced from a Third Party;
- D. RPS Australia East Pty Ltd relying on surface indicators that are incorrect or inaccurate;
- E. The Client or any Third Party not verifying information in this plan where recommended by RPS Australia East Pty Ltd;
- F. Lodgement of this plan with any local authority against the recommendation of RPS Australia East Pty Ltd.

3. The accuracy, reliability, suitability or completeness of any approximations or estimates made or referred to by RPS Australia East Pty Ltd in this plan.

4. Without limiting paragraph 1 or 2 above, this plan may not be copied, distributed, or reproduced by any process unless this note is clearly displayed on the plan.

5. Scale shown is correct for the original plan and any copies of this plan should be verified by checking against the bar scale.

6. The title boundaries as shown hereon were not marked at the time of survey and have been determined by plan dimensions only and not by field survey.

7. Service line contained are a combination of scaled plots from the records of relevant authorities and field location by CARNO AUSTRALIA. Prior to any demolition, excavation or construction on the site, the relevant authority should be contacted for possible location of further underground services and detailed locations of all service.

8. Service location is accurate to ±200mm for height, ±100mm horizontal. The RL of the points in the service layers are ground / existing surface levels. Approximate depths to the service are shown where recorded.

Where the location of services that are critical to design should be physically potholed on site prior to design and construction.

TITLE: PLAN SHOWING TOPOGRAPHIC DETAIL & LEVELS AT WESTFIELD WARRINGAH MALL BEING LOT 100 IN D.P.1015283

CLIENT MANAGER: CPM
SURVEYED: AG/WD/DR
CAD OPERATOR: CPM/BN

LEVEL DATUM: A.H.D
ORIGIN OF LEVELS:
REDUCED LEVEL:

MERIDIAN: MGA
ORIGIN OF COORDINATES: PM5983
E 339 405.767, N 6 261 968.729

DATE: 16/08/2013
SCALE: 1:1000 @ A1
SHEET SIZE: A1

SHEET 1
OF SHEETS 11

AUTOCAD REF: 13-12-20 SITE DETAIL (ADJ.MGA) [H].dwg
CIVILCAD REF: PR116997-MULTIPLE FILES.CCX
REVISION: H

CLIENT: WESTFIELD
JOB REF: PR116997

RPS AUSTRALIA EAST PTY LTD (ABN 44 140 292 762)
SUITE 404, 29-31 LEXINGTON DRIVE PO BOX 6843 BAULKHAM HILLS NSW 2153
T: 02 8884 6900 F: 02 8884 6999 www.rpsgroup.com.au

Copyright
This document and the information show shall remain the property of RPS Australia East Pty Ltd. The document may only be used for the purpose for which it was supplied and in accordance with the terms of engagement for the commission. Unauthorised use of this document in any way is prohibited.

creativepeople
making a difference

RPS

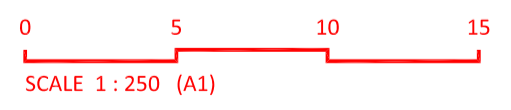
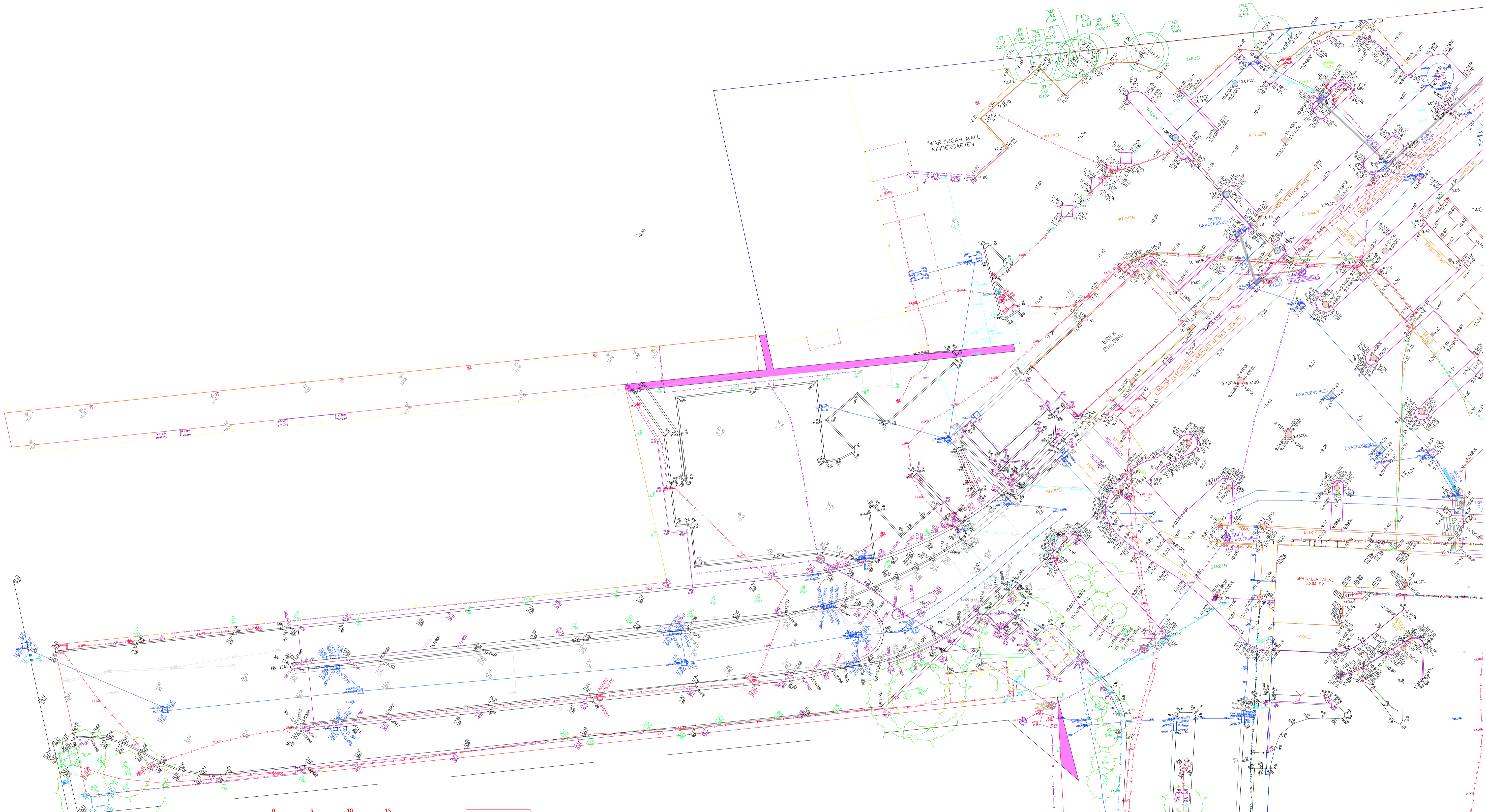

IMPORTANT NOTE

- This plan was prepared for the sole purposes of the client for the specific purpose of producing a detail plan. This plan is strictly limited to the purpose and does not apply directly or indirectly and will not be used for any other application, purpose, use or matter. The plan is presented without the assumption of a duty of care to any other person (other than the Client) ("Third Party") and may not be relied on by Third Party.
- RPS Australia East Pty Ltd will not be liable (in negligence or otherwise) for any direct or indirect loss, damage, liability or claim arising out of or incidental to:
 - Third Party publishing, using or relying on the plan;
 - RPS Australia East Pty Ltd relying on information provided to it by the Client or a Third Party where the information is incorrect, incomplete, inaccurate, out-of-date or unreasonably;
 - Any inaccuracies or other faults with information or data sourced from a Third Party;
 - RPS Australia East Pty Ltd relying on surface indicators that are incorrect or inaccurate;
 - The Client or any Third Party not verifying information in this plan where recommended by RPS Australia East Pty Ltd;
 - Lodgement of this plan with any local authority against the recommendation of RPS Australia East Pty Ltd.
- The accuracy, reliability, suitability or completeness of any approximations or estimates made or referred to by RPS Australia East Pty Ltd in this plan.
- Without limiting paragraph 1 or 2 above, this plan may not be copied, distributed, or reproduced by any process unless this note is clearly displayed on the plan.
- Scale shown is correct for the original plan and any copies of this plan should be verified by checking against the bar scale.
- The title boundaries as shown hereon were not marked at the time of survey and have been determined by plan dimensions only and not by field survey.
- Service line contained are a combination of scaled plots from the records of relevant authorities and field location by CARONNO AUS. Prior to any demolition, excavation or construction on the site, the relevant authority should be contacted for possible location of further underground services and detailed locations of all service.
- Service location is accurate to ±200mm for height, ±1000mm horizontal. The RL of the points in the service layers are ground / existing surface levels. Approximate depths to the service are shown where recorded. Where the location of services that are critical to design should be physically potholed on site prior to design and construction.

TITLE: PLAN SHOWING TOPOGRAPHIC DETAIL & LEVELS AT WESTFIELD WARRINGAH MALL BEING LOT 100 IN D.P.1015283

CLIENT MANAGER: CPM
SURVEYED: AG/WD/DR
CAD OPERATOR: CPM/BN

LEVEL DATUM: A.H.D
ORIGIN OF LEVELS: PM5983
REDUCED LEVEL:

MERIDIAN: MGA
ORIGIN OF COORDINATES: PM5983
 E 339 405.767, N 6 261 968.729

DATE: 16/08/2013
SCALE: 1:250 @ A1
SHEET SIZE: A1

SHEET 2
OF
SHEETS 11

AUTOCAD REF: 13-12-20 SITE DETAIL (ADJ.MGA) [H].dwg
CIVILCAD REF: PR116997-MULTIPLE FILES.CCX
REVISION: H

CLIENT: WESTFIELD
JOB REF: PR116997

RPS AUSTRALIA EAST PTY LTD (ABN 44 140 292 762)
 SUITE 404, 29-31 LEXINGTON DRIVE PO BOX 6843 BAULKHAM HILLS NSW 2153
 T: 02 8884 6900 F: 02 8884 6999 www.rpsgroup.com.au

Copyright
 This document and the information show shall remain the property of RPS Australia East Pty Ltd. The document may only be used for the purpose for which it was supplied and in accordance with the terms of engagement for the commission. Unauthorised use of this document in any way is prohibited.



100
D.P.1015283

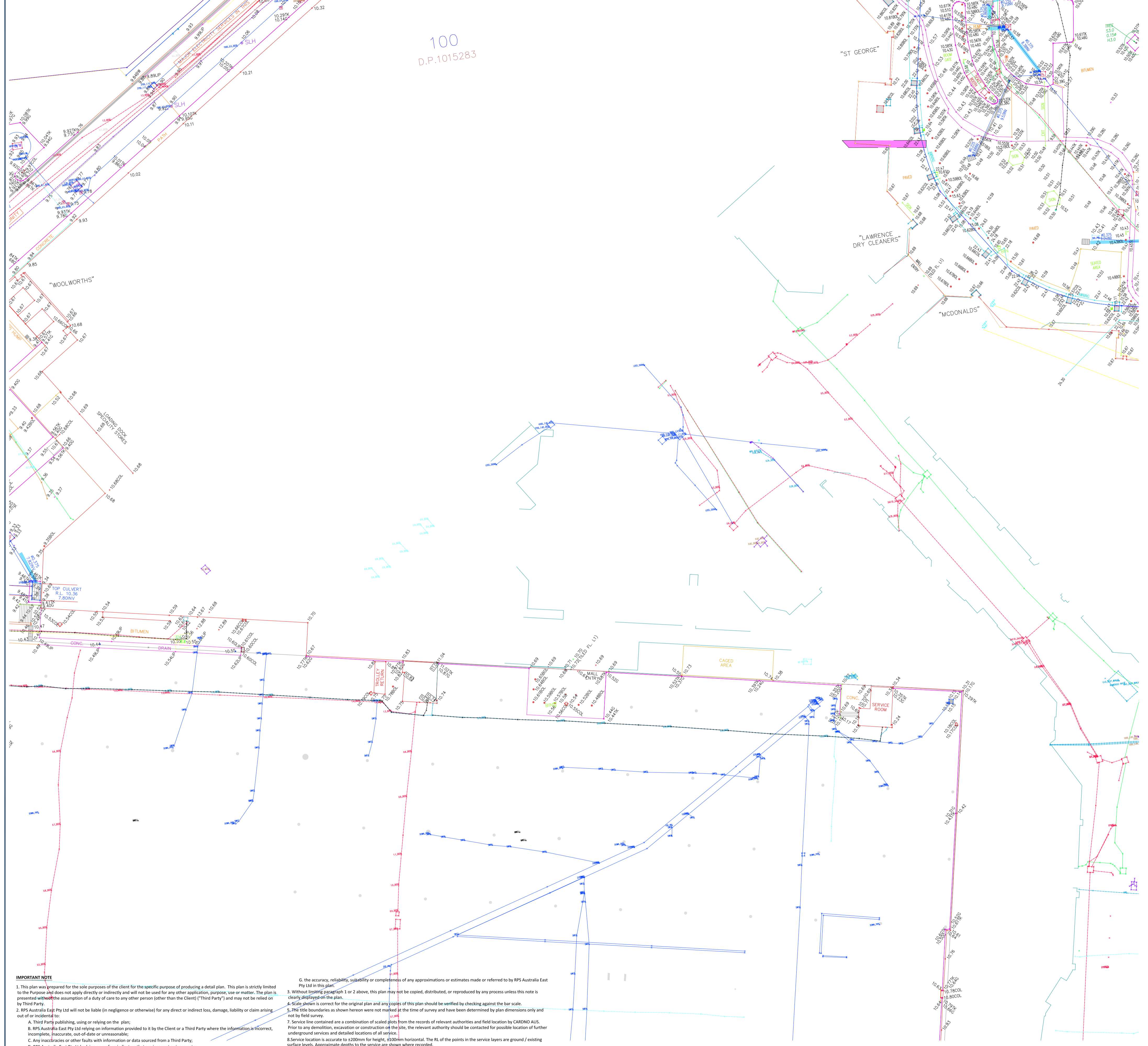

IMPORTANT NOTE

- This plan was prepared for the sole purposes of the client for the specific purpose of producing a detail plan. This plan is strictly limited to the purpose and does not apply directly or indirectly and will not be used for any other application, purpose, use or matter. The plan is presented without the assumption of a duty of care to any other person (other than the Client) ("Third Party") and may not be relied on by Third Party.
- RPS Australia East Pty Ltd will not be liable (in negligence or otherwise) for any direct or indirect loss, damage, liability or claim arising out of or incidental to:
 - Third Party publishing, using or relying on the plan;
 - RPS Australia East Pty Ltd relying on information provided to it by the Client or a Third Party where the information is incorrect, incomplete, inaccurate, out-of-date or unseasonable;
 - Any inaccuracies or other faults with information or data sourced from a Third Party;
 - RPS Australia East Pty Ltd relying on surface indicators that are incorrect or inaccurate;
 - The Client or any Third Party not verifying information in this plan where recommended by RPS Australia East Pty Ltd;
 - Lodgement of this plan with any local authority against the recommendation of RPS Australia East Pty Ltd;

- Without limiting paragraph 1 or 2 above, this plan may not be copied, distributed, or reproduced by any process unless this note is clearly displayed on the plan.
- Scale shown is correct for the original plan and any copies of this plan should be verified by checking against the bar scale.
- The site boundaries as shown hereon were not marked at the time of survey and have been determined by plan dimensions only and not by field survey.
- Service line contained are a combination of scaled plots from the records of relevant authorities and field location by CAMDND AUS. Prior to any demolition, excavation or construction of the site, the relevant authority should be contacted for possible location of further underground services and detailed locations of all service.
- Service location is accurate to ±200mm for height, ±100mm horizontal. The RL of the points in the service layers are ground / existing surface levels. Approximate depths to the services are shown where recorded.
- Where the location of services that are critical to design should be physically potholed on site prior to design and construction.

13-12-20 SITE DETAIL (ADJ.MGA) [H].dwg

TITLE: PLAN SHOWING TOPOGRAPHIC DETAIL & LEVELS AT WESTFIELD WARRINGAH MALL BEING LOT 100 IN D.P.1015283

CLIENT MANAGER: CPM
SURVEYED: AG/WD/DR
CAD OPERATOR: CPM/BN

LEVEL DATUM: A.H.D
ORIGIN OF LEVELS: PM5983
REDUCED LEVEL:

MERIDIAN: MGA
ORIGIN OF COORDINATES: PM5983
E 339 405 767, N 6 261 968 729

DATE: 16/08/2013
SCALE: 1:250 @ A1
SHEET SIZE: A1

SHEET 3
OF 11 SHEETS

AUTOCAD REF: PR116997-MULTIPLE FILES.CCX
CIVILCAD REF: H
REVISION: H

CLIENT: WESTFIELD
JOB REF: PR116997



RPS AUSTRALIA EAST PTY LTD (ABN 44 140 292 762)
142 SUNNYHOLT ROAD BLACKTOWN PO BOX 6745 BLACKTOWN NSW 2148
T: 02 9853 0299 F: 02 9831 3274 www.rpsgroup.com.au

Copyright
This document and the information shown shall remain the property of RPS Australia East Pty Ltd. The document may only be used for the purpose for which it was supplied and in accordance with the terms of engagement for the commission. Unauthorised use of this document in any way is prohibited.



I:\Projects\11697\PR116997\Westfield Warringah Mall\05_Briefing\01_Drawn\13-12-20 SITE DETAIL (ADJ.MGA) [H].dwg

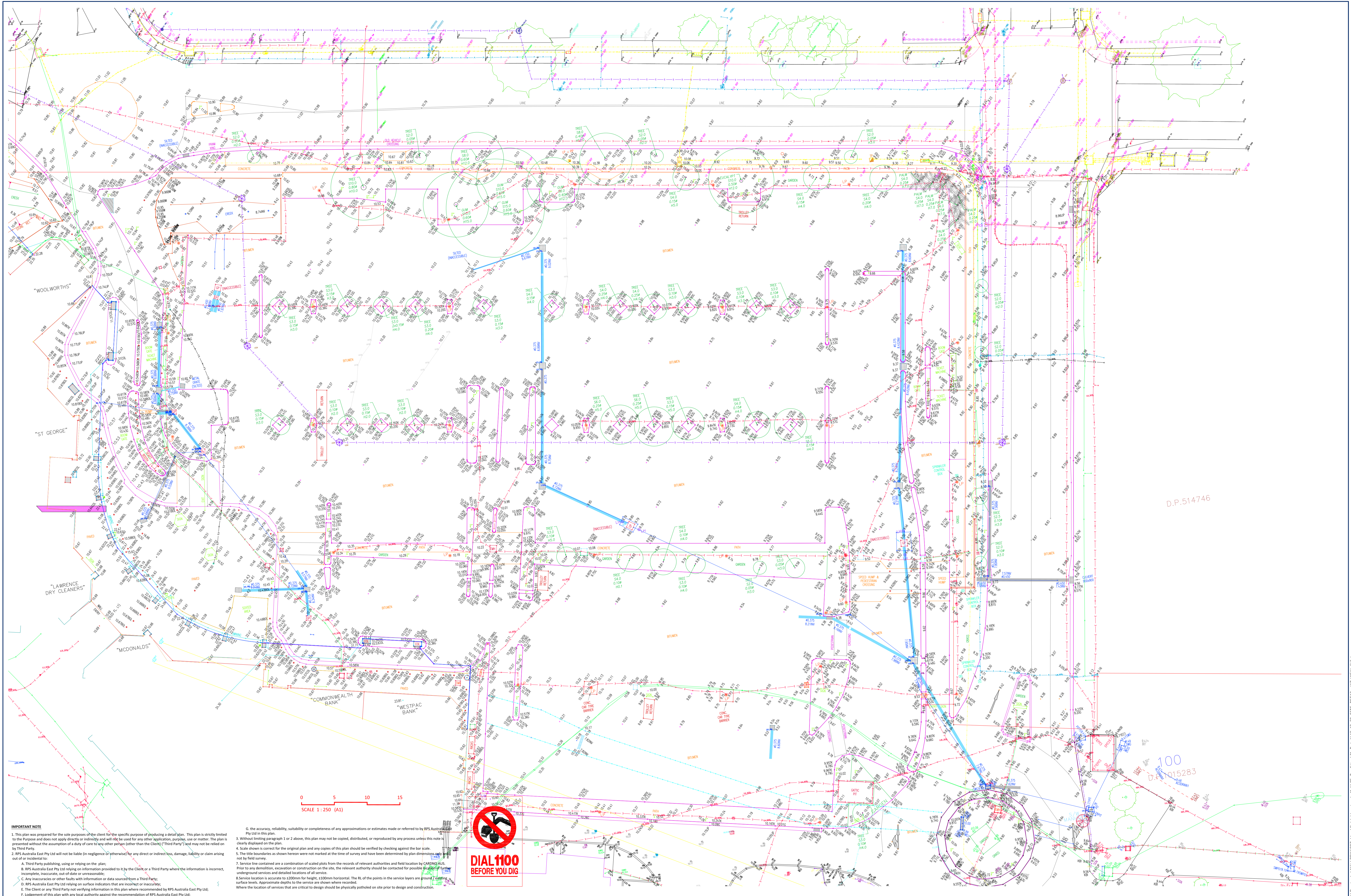

D.P.514746

100
D.P. 1015283

IMPORTANT NOTE
 1. This plan was prepared for the sole purpose of the client for the specific purpose of producing a detail plan. This plan is strictly limited to the purpose and does not apply directly or indirectly and will not be used for any other application, purpose, use or matter. The plan is presented without the assumption of a duty of care to any other person (other than the Client ("Third Party")) and may not be relied on by Third Party.
 2. RPS Australia East Pty Ltd will not be liable (in negligence or otherwise) for any direct or indirect loss, damage, liability or claim arising out of or incidental to:
 A. Third Party publishing, using or relying on the plan;
 B. RPS Australia East Pty Ltd relying on information provided to it by the Client or a Third Party where the information is incorrect, incomplete, inaccurate, out-of-date or unreasonable;
 C. Any inaccuracies or other faults with information or data sourced from a Third Party;
 D. RPS Australia East Pty Ltd relying on surface indicators that are incorrect or inaccurate;
 E. The Client or any Third Party not verifying information in this plan where recommended by RPS Australia East Pty Ltd;
 F. Lodgement of this plan with any local authority against the recommendation of RPS Australia East Pty Ltd.

G. the accuracy, reliability, suitability or completeness of any approximations or estimates made or referred to by RPS Australia East Pty Ltd in this plan.
 3. Without limiting paragraph 1 or 2 above, this plan may not be copied, distributed, or reproduced by any process unless this note is clearly displayed on the plan.
 4. Scale shown is correct for the original plan and any copies of this plan should be verified by checking against the bar scale.
 5. The title boundaries as shown hereon were not marked at the time of survey and have been determined by plan dimensions only, not by field survey.
 7. Service line contained are a combination of scaled plots from the records of relevant authorities and field location by CARBONDALES. Prior to any demolition, excavation or construction on the site, the relevant authority should be contacted for possible location of underground services and detailed locations of all service.
 8. Service location is accurate to ±200mm for height, ±100mm horizontal. The RL of the points in the service layers are ground level surface levels. Approximate depths to the service are shown where recorded.
 Where the location of services that are critical to design should be physically potholed on site prior to design and construction.



TITLE: PLAN SHOWING TOPOGRAPHIC DETAIL & LEVELS AT WESTFIELD WARRINGAH MALL BEING LOT 100 IN D.P.1015283
 CLIENT: WESTFIELD
 JOB REF: PR116997

CLIENT MANAGER: CPM
 SURVEYED: AG/WD/DR
 CAD OPERATOR: CPM/BN

LEVEL DATUM: A.H.D
 ORIGIN OF LEVELS: PM5983
 REDUCED LEVEL:

MERIDIAN: MGA
 COORDINATES: PM5983
 E 339 405.767, N 6 261 968.729

DATE: 16/08/2013
 SCALE: 1:250 @ A1
 SHEET SIZE: A1

SHEET 4
 OF SHEETS 11

AUTOCAD REF: 13-12-20 SITE DETAIL (ADJ.MGA) [H].dwg
 CIVILCAD REF: PR116997-MULTIPLE FILES.CCX
 REVISION: H

Copyright
 This document and the information show shall remain the property of RPS Australia East Pty Ltd. The document may only be used for the purpose for which it was supplied and in accordance with the terms of engagement for the commission. Unauthorised use of this document in any way is prohibited.
 creativepeople
 making a difference
 RPS

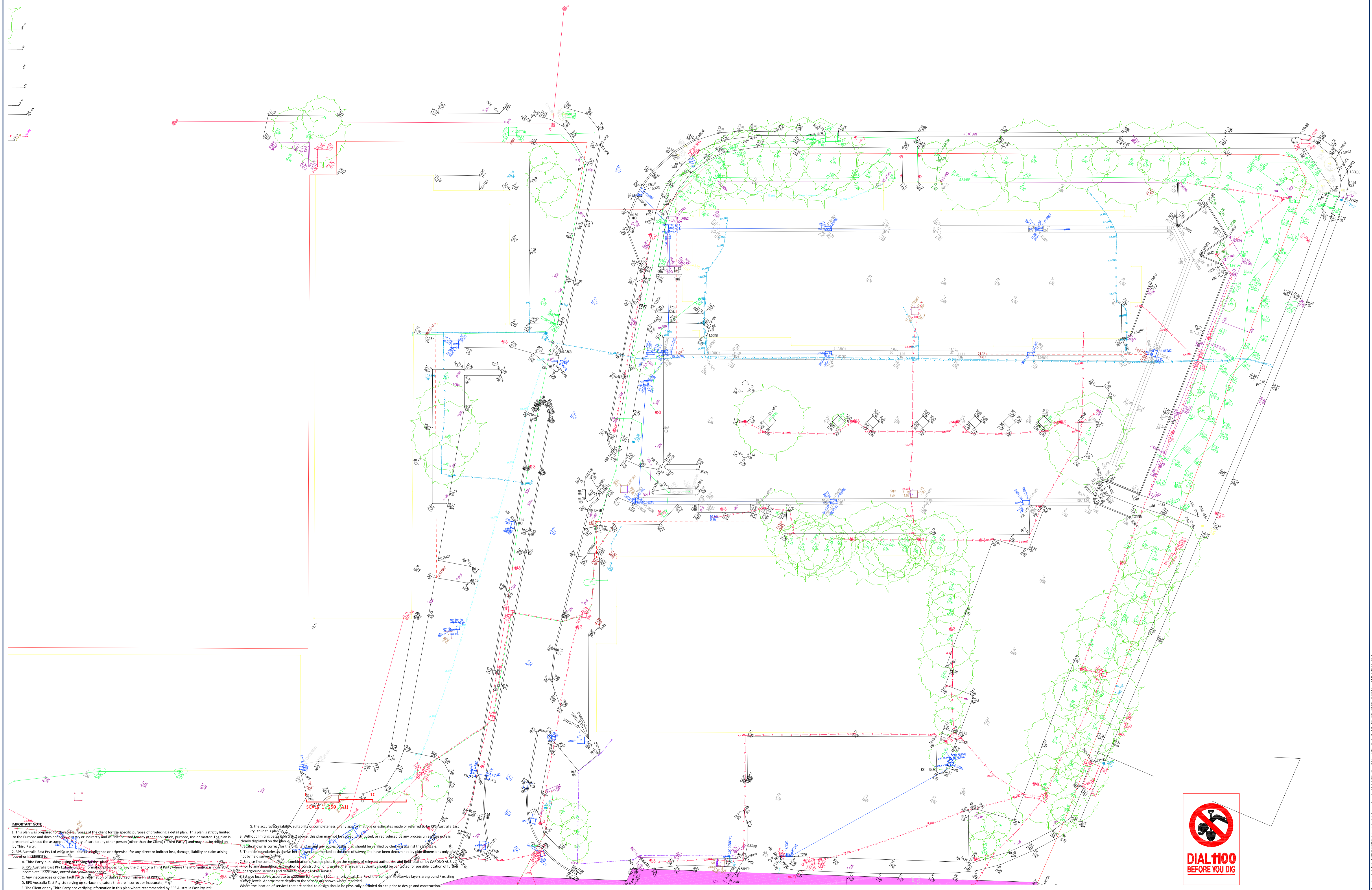

IMPORTANT NOTE

1. This plan was prepared for the sole purpose of the client for the specific purpose of producing a detail plan. This plan is strictly limited to the purpose and does not constitute a warranty or guarantee of any kind and will not be used for any other application, purpose, use or matter. The plan is presented without the assumption of any duty of care to any other person (other than the Client) ("Third Party") and may not be relied on by Third Party.
2. RPS Australia East Pty Ltd will not be liable (in negligence or otherwise) for any direct or indirect loss, damage, liability or claim arising out of or in connection with this plan.
3. Without limiting paragraph 2 above, this plan may not be copied, distributed, or reproduced by any process unless the note is clearly displayed on the plan.
4. This plan is correct for the purposes of the plan and any other plan should be verified by checking against the field notes.
5. The title boundaries shown hereon were not marked at the time of survey and have been determined by plan dimensions only and not by field survey.
6. The accuracy, reliability, suitability or completeness of any annotations or estimates made or referred to by RPS Australia East Pty Ltd in this plan.
7. Service line connections, a combination of scaled plots from the records of relevant authorities and the location of CANOMO AUS. Prior to any demolition, excavation or construction on the site, the relevant authority should be contacted for possible location of further underground services and detailed location of all services.
8. Service locations, accurate to 200mm in the horizontal and 500mm in the vertical. The RL of the points in the service layers are ground / existing surface levels. Approximate depths to the service are shown where recorded. Where the location of services that are critical to design should be physically potholed on site prior to design and construction.

A. Third Party publishing, copying or otherwise making this plan available to the Client or a Third Party where the information is incomplete, inaccurate, out of date or otherwise incorrect.
 B. RPS Australia East Pty Ltd will not be liable (in negligence or otherwise) for any direct or indirect loss, damage, liability or claim arising out of or in connection with this plan.
 C. Any inaccuracies or other faults in this plan or data derived from a third party.
 D. RPS Australia East Pty Ltd relying on surface indicators that are incorrect or inaccurate.
 E. The Client or any Third Party not verifying information in this plan where recommended by RPS Australia East Pty Ltd.
 F. Lodgement of this plan with any local authority against the recommendation of RPS Australia East Pty Ltd.

TITLE: PLAN SHOWING TOPOGRAPHIC DETAIL & LEVELS AT WESTFIELD WARRINGAH MALL BEING LOT 100 IN D.P.1015283

CLIENT MANAGER: CPM
SURVEYED: AG/WD/DR
CAD OPERATOR: CPM/BN

LEVEL DATUM: A.H.D
ORIGIN OF LEVELS: TBA
REDUCED LEVEL: TBA

MERIDIAN: MGA
ORIGIN OF COORDINATES: PM5983
 E 339 405 767, N 6 261 968 729

DATE: 05/04/2013
SCALE: 1:250 @ A1
SHEET SIZE: A1

SHEET 5
OF
SHEETS 11

AUTOCAD REF: 13-12-20 SITE DETAIL (ADJ.MGA) [H].dwg
CIVILCAD REF: PR116997-MULTIPLE FILES.CCX
REVISION: H



CLIENT: WESTFIELD
JOB REF: PR116997

RPS AUSTRALIA EAST PTY LTD (ABN 44 140 292 762)
 SUITE 404, 29-31 LEXINGTON DRIVE PO BOX 6843 BAULKHAM HILLS NSW 2153
 T: 02 8884 6900 F: 02 8884 6999 www.rpsgroup.com.au

Copyright
 This document and the information show shall remain the property of RPS Australia East Pty Ltd. The document may only be used for the purpose for which it was supplied and in accordance with the terms of engagement for the commission. Unauthorised use of this document in any way is prohibited.

creativepeople
 making a difference

RPS

N:\Projects\116997\Westfield Warringah Mall\13-12-20 SITE DETAIL (ADJ.MGA) [H].dwg

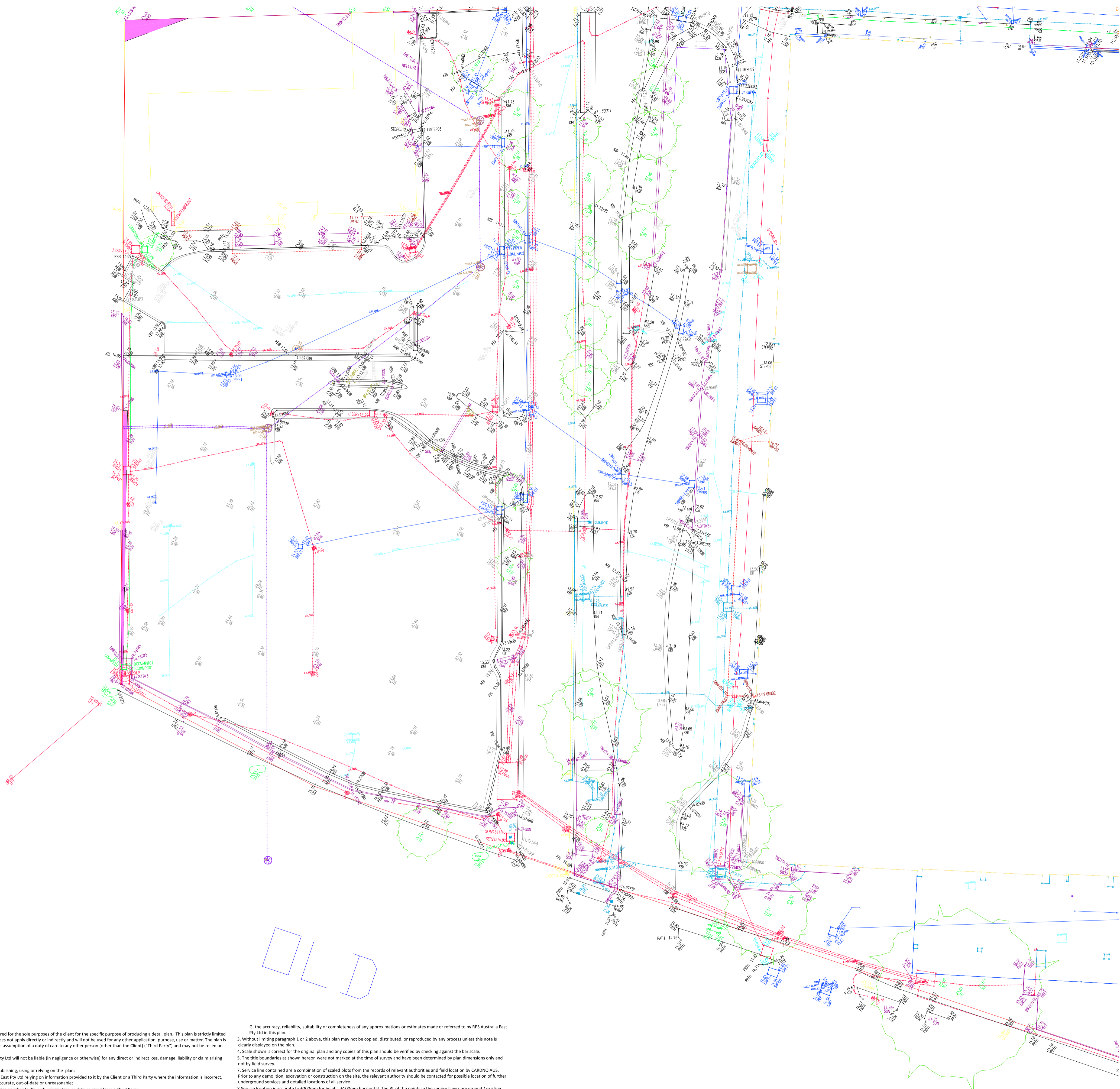

IMPORTANT NOTE

1. This plan was prepared for the sole purposes of the client for the specific purpose of producing a detail plan. This plan is strictly limited to the Purpose and does not apply directly or indirectly and will not be used for any other application, purpose, use or matter. The plan is presented without the assumption of a duty of care to any other person (other than the Client) ("Third Party") and may not be relied on by Third Party.
2. RPS Australia East Pty Ltd will not be liable (in negligence or otherwise) for any direct or indirect loss, damage, liability or claim arising out of or incidental to:
 - A. Third Party publishing, using or relying on the plan;
 - B. RPS Australia East Pty Ltd relying on information provided to it by the Client or a Third Party where the information is incorrect, incomplete, inaccurate, out-of-date or unreasonable;
 - C. Any inaccuracies or other faults with information or data sourced from a Third Party;
 - D. RPS Australia East Pty Ltd relying on surface indicators that are incorrect or inaccurate;
 - E. The Client or any Third Party not verifying information in this plan where recommended by RPS Australia East Pty Ltd;
 - F. Lodgement of this plan with any local authority against the recommendation of RPS Australia East Pty Ltd;

- G. the accuracy, reliability, suitability or completeness of any approximations or estimates made or referred to by RPS Australia East Pty Ltd in this plan.
3. Without limiting paragraph 1 or 2 above, this plan may not be copied, distributed, or reproduced by any process unless this note is clearly displayed on the plan.
4. Scale shown is correct for the original plan and any copies of this plan should be verified by checking against the bar scale.
5. The title boundaries as shown hereon were not marked at the time of survey and have been determined by plan dimensions only and not by field survey.
6. Service line contained are a combination of scaled plots from the records of relevant authorities and field location by CARDNO AUS. Prior to any demolition, excavation or construction on the site, the relevant authority should be contacted for possible location of further underground services and detailed locations of all services.
7. Service location is accurate to ±200mm for height, ±100mm horizontal. The RL of the points in the service layers are ground / existing surface levels. Approximate depths to the services are shown where recorded. Where the location of services that are critical to design should be physically potholed on site prior to design and construction.

13-12-20 SITE DETAIL (ADJ.MGA) [H].dwg

TITLE: PLAN SHOWING TOPOGRAPHIC DETAIL & LEVELS AT WESTFIELD WARRINGAH MALL BEING LOT 100 IN D.P.1015283		CLIENT MANAGER: CPM SURVEYED: AG/WD/DR CAD OPERATOR: CPM/BN	LEVEL DATUM: A.H.D ORIGIN OF LEVELS: PM5983 REDUCED LEVEL:	MERIDIAN: MGA ORIGIN OF COORDINATES: PM5983 E 339 405.767, N 6 261 968.729	DATE: 16/08/2013 SCALE: 1:250 @ A1 SHEET SIZE: A1	SHEET 6 OF SHEETS 11	AUTOCAD REF: PR116997-MULTIPLE FILES.CCX CIVILCAD REF: H REVISION:
---------------------------------------------------------------------------------------------------------------------	--	----------------------------------------------------------------------------------------	---------------------------------------------------------------------------------------	------------------------------------------------------------------------------------------------	------------------------------------------------------------------------------	---------------------------------------	-----------------------------------------------------------------------------------------------

I:\Projects\1169\PR116997\Westfield Warringah Mall\05_Briefing\01_Detailed\13-12-20 SITE DETAIL (ADJ.MGA) [H].dwg

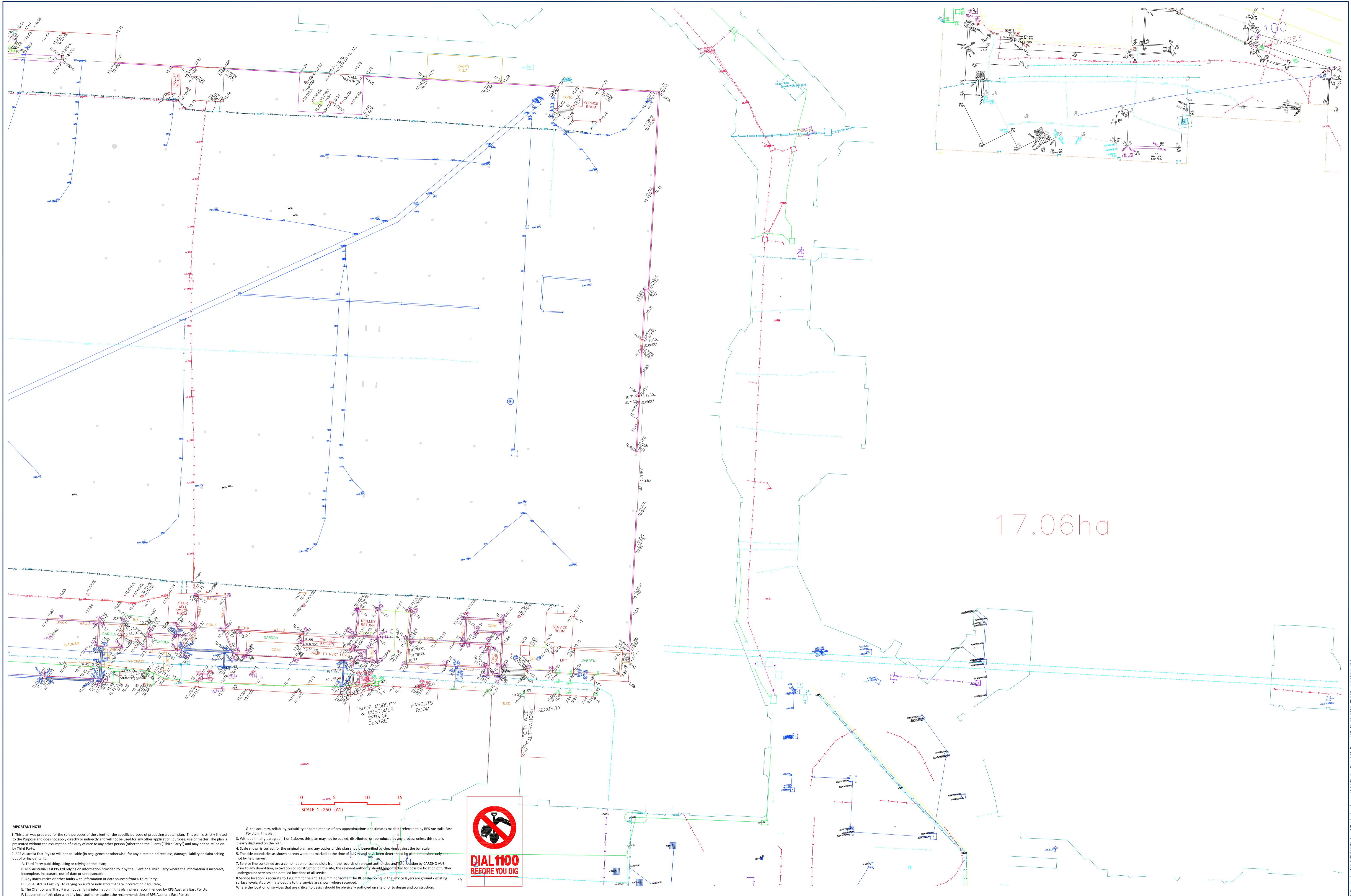

IMPORTANT NOTE

- This plan was prepared for the sole purposes of the client for the specific purpose of producing a detail plan. This plan is strictly limited to the Purpose and does not apply directly or indirectly and will not be used for any other application, purpose, use or matter. The plan is presented without the assumption of a duty of care to any other person (other than the Client) ("Third Party") and may not be relied on by Third Party.
- RPS Australia East Pty Ltd will not be liable (in negligence or otherwise) for any direct or indirect loss, damage, liability or claim arising out of or incidental to:
 - Third Party publishing, using or relying on the plan;
 - RPS Australia East Pty Ltd relying on information provided to it by the Client or a Third Party where the information is incorrect, incomplete, inaccurate, out-of-date or unreasonable;
 - Any inaccuracies or other faults with information or data sourced from a Third Party;
 - RPS Australia East Pty Ltd relying on surface indicators that are incorrect or inaccurate;
 - The Client or any Third Party not verifying information in this plan where recommended by RPS Australia East Pty Ltd;
 - Lodgement of this plan with any local authority against the recommendation of RPS Australia East Pty Ltd.
- Without limiting paragraph 1 or 2 above, this plan may not be copied, distributed, or reproduced by any process unless this note is clearly displayed on the plan.
- Scale shown is correct for the original plan and any copies of this plan should be verified by checking against the bar scale.
- The title boundaries as shown hereon were not marked at the time of survey and have been determined by plan dimensions only and not by field survey.
- Service line contained are a combination of scaled plots from the records of relevant authorities and information by CARONNO AUS. Prior to any demolition, excavation or construction on the site, the relevant authority should be contacted for possible location of further underground services and detailed locations of all service.
- Service location is accurate to ±200mm for height, ±1000mm horizontal. The RL of the points in the service layers are ground / existing surface levels. Approximate depths to the service are shown where recorded. Where the location of services that are critical to design should be physically profiled on site prior to design and construction.

TITLE: PLAN SHOWING TOPOGRAPHIC DETAIL & LEVELS AT WESTFIELD WARRINGAH MALL BEING LOT 100 IN D.P.1015283

CLIENT MANAGER: CPM
SURVEYED: AG/WD/DR
CAD OPERATOR: CPM/BN

LEVEL DATUM: A.H.D
ORIGIN OF LEVELS: PM5983
REDUCED LEVEL:



MERIDIAN: MGA
ORIGIN OF COORDINATES: PM5983
 E 339 405.767, N 6 261 968.729

DATE: 16/08/2013
SCALE: 1:250 @ A1
SHEET SIZE: A1

SHEET 7
OF SHEETS 11

AUTOCAD REF: 13-12-20 SITE DETAIL (ADJ.MGA) [H].dwg
CIVILCAD REF: PR116997-MULTIPLE FILES.CCX
REVISION: H

Copyright
 This document and the information show shall remain the property of RPS Australia East Pty Ltd. The document may only be used for the purpose for which it was supplied and in accordance with the terms of engagement for the commission. Unauthorised use of this document in any way is prohibited.

CLIENT: WESTFIELD
JOB REF: PR116997

RPS AUSTRALIA EAST PTY LTD (ABN 44 140 292 762)
 SUITE 404, 29-31 LEXINGTON DRIVE PO BOX 6843 BAULKHAM HILLS NSW 2153
 T: 02 8884 6900 F: 02 8884 6999 www.rpsgroup.com.au

creativepeople
 making a difference

RPS

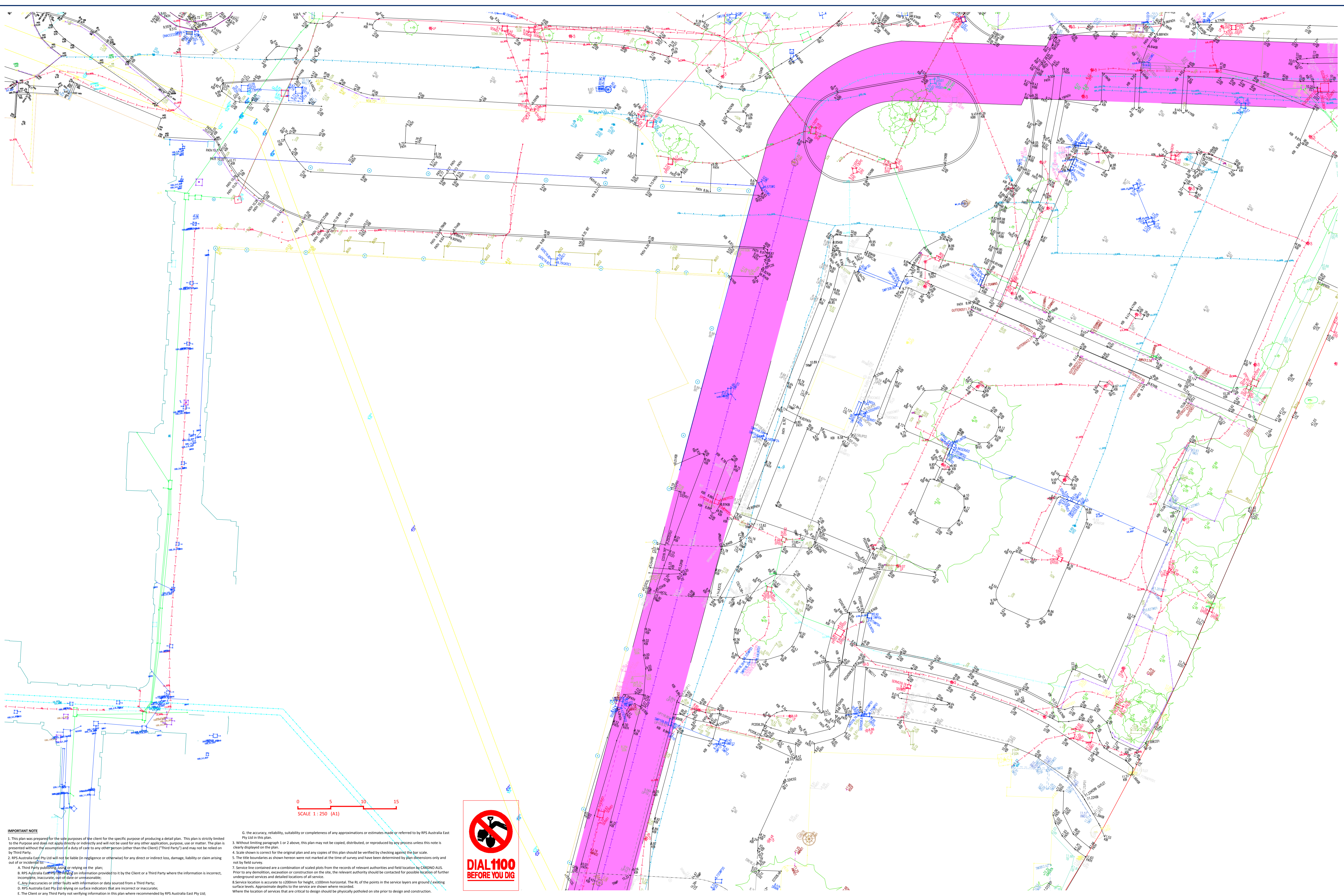

IMPORTANT NOTE

1. This plan was prepared for the sole purposes of the client for the specific purpose of producing a detail plan. This plan is strictly limited to the Purpose and does not apply directly or indirectly and will not be used for any other application, purpose, use or matter. The plan is presented without the assumption of a duty of care to any other person (other than the Client) ("Third Party") and may not be relied on by Third Party.

2. RPS Australia East Pty Ltd will not be liable (in negligence or otherwise) for any direct or indirect loss, damage, liability or claim arising out of or in connection with:

- A. Third Party publishing, using or relying on the plan;
- B. RPS Australia East Pty Ltd relying on information provided to it by the Client or a Third Party where the information is incorrect, incomplete, inaccurate, out of date or unreasonable;
- C. Any inaccuracies or other faults with information or data sourced from a Third Party;
- D. RPS Australia East Pty Ltd relying on surface indicators that are incorrect or inaccurate;
- E. The Client or any Third Party not verifying information in this plan where recommended by RPS Australia East Pty Ltd;
- F. Judgement of this plan with any local authority against the recommendation of RPS Australia East Pty Ltd.

G. the accuracy, reliability, suitability or completeness of any approximations or estimates made or referred to by RPS Australia East Pty Ltd in this plan.

3. Without limiting paragraph 1 or 2 above, this plan may not be copied, distributed, or reproduced by any process unless this note is clearly displayed on the plan.

4. Scale shown is correct for the original plan and any copies of this plan should be verified by checking against the bar scale.

5. The title boundaries as shown hereon were not marked at the time of survey and have been determined by plan dimensions only and not by field survey.

6. Service line contained are a combination of scaled plots from the records of relevant authorities and field location by CARNO AUJ. Prior to any demolition, excavation or construction on the site, the relevant authority should be contacted for possible location of further underground services and detailed locations of all service.

7. Service location is accurate to ±200mm for height, ±100mm horizontal. The RL of the points in the service layers are ground / existing surface levels. Approximate depths to the service are shown where recorded.

8. Where the location of services that are critical to design should be physically potholed on site prior to design and construction.



TITLE: PLAN SHOWING TOPOGRAPHIC DETAIL & LEVELS AT WESTFIELD WARRINGAH MALL BEING LOT 100 IN D.P.1015283

CLIENT MANAGER: CPM
SURVEYED: AG/WD/DR
CAD OPERATOR: CPM/BN

LEVEL DATUM: A.H.D
ORIGIN OF LEVELS: PM5983
REDUCED LEVEL:

MERIDIAN: MGA
ORIGIN OF COORDINATES: PM5983
 E 339 405.767, N 6 261 968.729

DATE: 16/08/2013
SCALE: 1:250 @ A1
SHEET SIZE: A1

SHEET 8
OF SHEETS 11

AUTOCAD REF: 15-08-07 SITE DETAIL (ADJ.MGA) [K].dwg
CIVILCAD REF: PR116997-MULTIPLE FILES.CCX
REVISION: K

CLIENT: WESTFIELD
JOB REF: PR116997

RPS AUSTRALIA EAST PTY LTD (ABN 44 140 292 762)
 SUITE 404, 29-31 LEXINGTON DRIVE PO BOX 6843 BAULKHAM HILLS NSW 2153
 T: 02 8884 6900 F: 02 8884 6999 www.rpsgroup.com.au

creativepeople
 making a difference

RPS

This document and the information show shall remain the property of RPS Australia East Pty Ltd. The document may only be used for the purpose for which it was supplied and in accordance with the terms of engagement for the commission. Unauthorised use of this document in any way is prohibited.

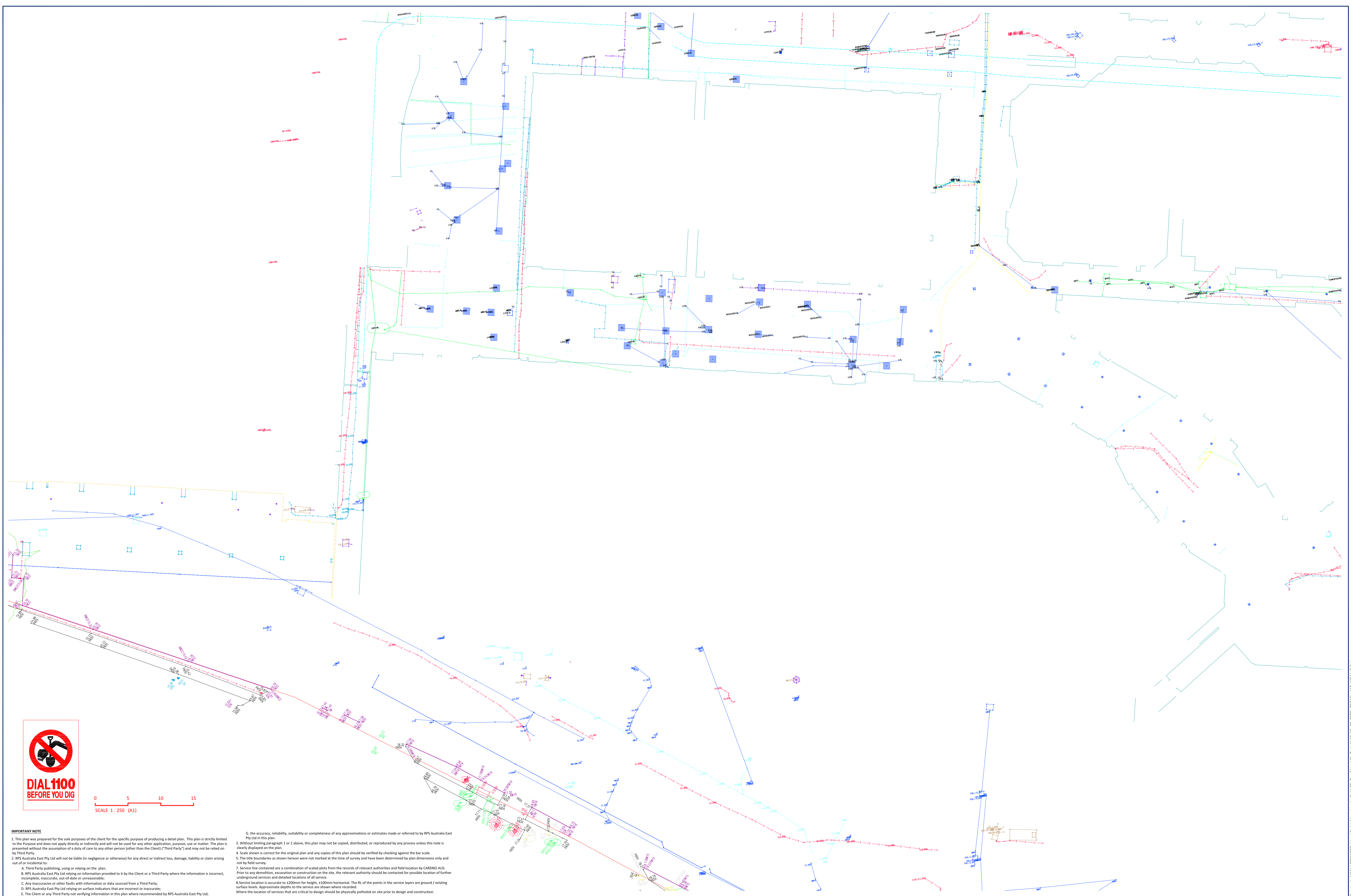

0 5 10 15
SCALE 1:250 (A1)

IMPORTANT NOTE
 1. This plan was prepared for the sole purposes of the client for the specific purpose of producing a detail plan. This plan is strictly limited to the Purpose and does not apply directly or indirectly and will not be used for any other application, purpose, use or matter. The plan is presented without the assumption of a duty of care to any other person (other than the Client) ("Third Party") and may not be relied on by Third Party.
 2. RPS Australia East Pty Ltd will not be liable (in negligence or otherwise) for any direct or indirect loss, damage, liability or claim arising out of or incidental to:
 A. Third Party publishing, using or relying on the plan;
 B. RPS Australia East Pty Ltd relying on information provided to it by the Client or a Third Party where the information is incorrect, incomplete, inaccurate, out-of-date or unreasonably;
 C. Any inaccuracies or other faults with information or data sourced from a Third Party;
 D. RPS Australia East Pty Ltd relying on surface indicators that are incorrect or inaccurate;
 E. The Client or any Third Party not verifying information in this plan where recommended by RPS Australia East Pty Ltd;
 F. Lodgement of this plan with any local authority against the recommendation of RPS Australia East Pty Ltd.

G. the accuracy, reliability, suitability or completeness of any approximations or estimates made or referred to by RPS Australia East Pty Ltd in this plan.
 3. Without limiting paragraph 1 or 2 above, this plan may not be copied, distributed, or reproduced by any process unless this note is clearly displayed on the plan.
 4. Scale shown is correct for the original plan and any copies of this plan should be verified by checking against the bar scale.
 5. The title boundaries as shown hereon were not marked at the time of survey and have been determined by plan dimensions only and not by field survey.
 7. Service line contained are a combination of scaled plots from the records of relevant authorities and field location by CARCNO AUS. Prior to any demolition, excavation or construction on the site, the relevant authority should be contacted for possible location of further underground services and detailed locations of all service.
 8. Service location is accurate to ±200mm for height, ±100mm horizontal. The RL of the points in the service layers are ground / existing surface levels. Approximate depths to the service are shown where recorded.
 Where the location of services that are critical to design should be physically potholed on site prior to design and construction.

TITLE: PLAN SHOWING TOPOGRAPHIC DETAIL & LEVELS AT WESTFIELD WARRINGAH MALL BEING LOT 100 IN D.P.1015283
 CLIENT: WESTFIELD
 JOB REF: PR116997

CLIENT MANAGER: CPM
 SURVEYED: AG/WD/DR
 CAD OPERATOR: CPM/BN

LEVEL DATUM: A.H.D
 ORIGIN OF LEVELS: PM5983
 REDUCED LEVEL:

MERIDIAN: MGA
 ORIGIN OF COORDINATES: PM5983
 E 339 405 767, N 6 261 968 729

DATE: 16/08/2013
 SCALE: 1:250 @ A1
 SHEET SIZE: A1

SHEET 9
 OF 11
 SHEETS 11

AUTOCAD REF: 13-12-20 SITE DETAIL (ADJ.MGA) [H].dwg
 CIVILCAD REF: PR116997-MULTIPLE FILES.CCX
 REVISION: H

Copyright
 This document and the information show shall remain the property of RPS Australia East Pty Ltd. The document may only be used for the purpose for which it was supplied and in accordance with the terms of engagement for the commission. Unauthorised use of this document in any way is prohibited.

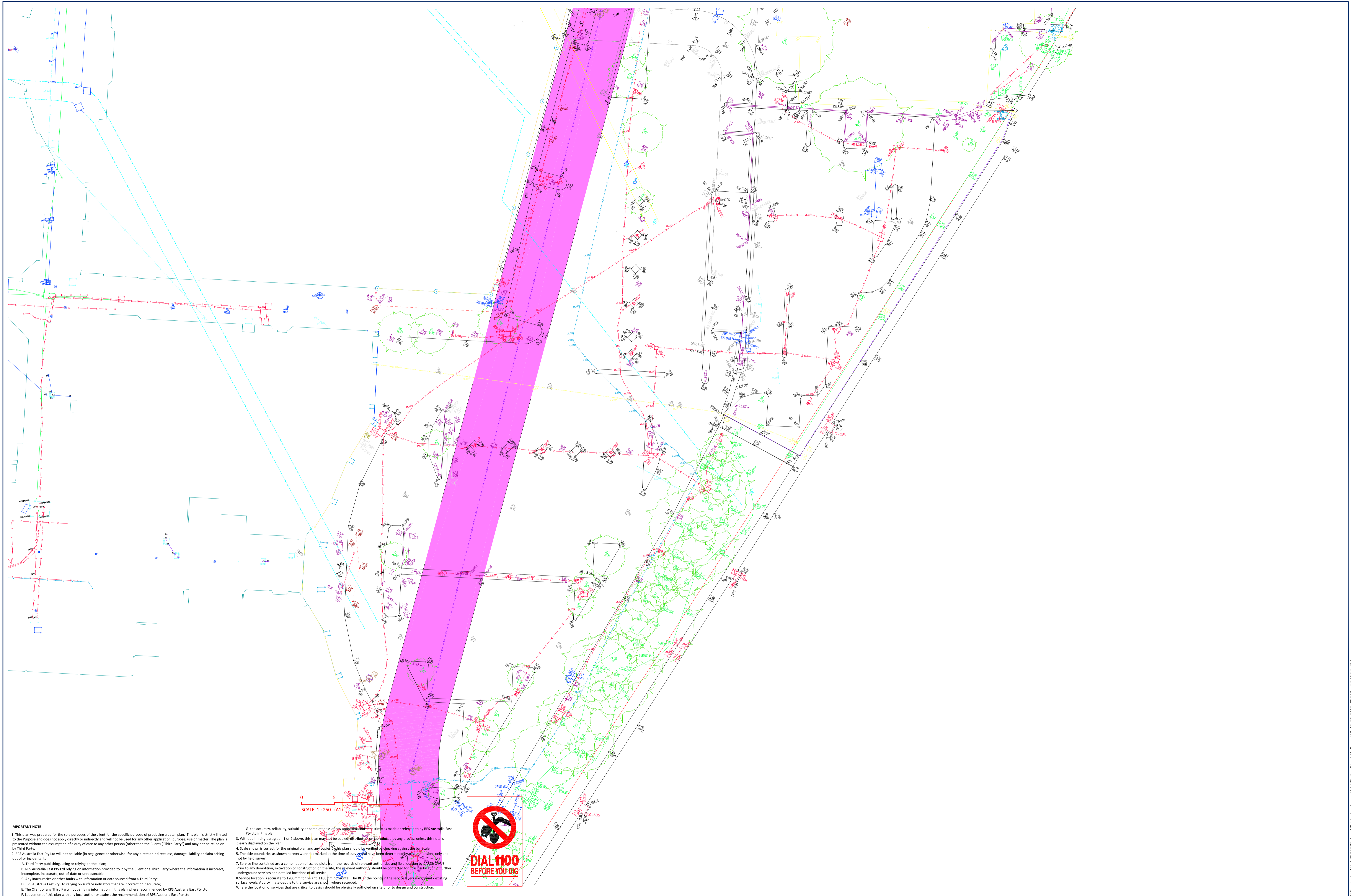

IMPORTANT NOTE

- This plan was prepared for the sole purposes of the client for the specific purpose of producing a detail plan. This plan is strictly limited to the purpose and does not apply directly or indirectly and will not be used for any other application, purpose, use or matter. The plan is presented without the assumption of a duty of care to any other person (other than the Client) ("Third Party") and may not be relied on by Third Party.
- RPS Australia East Pty Ltd will not be liable (in negligence or otherwise) for any direct or indirect loss, damage, liability or claim arising out of or incidental to:
 - Third Party publishing, using or relying on the plan;
 - RPS Australia East Pty Ltd relying on information provided to it by the Client or a Third Party where the information is incorrect, incomplete, inaccurate, out-of-date or unreasonable;
 - Any inaccuracies or other faults with information or data sourced from a Third Party;
 - RPS Australia East Pty Ltd relying on surface indicators that are incorrect or inaccurate;
 - The Client or any Third Party not verifying information in this plan where recommended by RPS Australia East Pty Ltd;
 - Lodgement of this plan with any local authority against the recommendation of RPS Australia East Pty Ltd.
- Without limiting paragraph 1 or 2 above, this plan may not be copied, distributed, or published by any process unless this notice is clearly displayed on the plan.
- Scale shown is correct for the original plan and any zones of this plan should be verified by checking against the bar scale.
- The title boundaries as shown hereon were not marked at the time of survey and have been determined by aerial dimensions only and not by field survey.
- Service lines contained are a combination of scaled plots from the records of relevant authorities and field location by CATBOYS/SES. Prior to any demolition, excavation or construction on the site, the relevant authority should be contacted for possible location of further underground services and detailed locations of all service.
- Service location is accurate to ±200mm for height, ±1000mm horizontally. The RL of the points in the section were are based on existing surface levels. Approximate depths to the service are shown where recorded. Where the location of services that are critical to design should be physically potholed on site prior to design and construction.

0 5 15
SCALE 1:250 (A1)



TITLE: PLAN SHOWING TOPOGRAPHIC DETAIL & LEVELS AT WESTFIELD WARRINGAH MALL BEING LOT 100 IN D.P.1015283

CLIENT MANAGER: CPM
SURVEYED: AG/WD/DR
CAD OPERATOR: CPM/BN

LEVEL DATUM: A.H.D
ORIGIN OF LEVELS: PM5983
REDUCED LEVEL:

MERIDIAN: MGA
ORIGIN OF COORDINATES: PM5983
E 339 405.767, N 6 261 968.729

DATE: 16/08/2013
SCALE: 1:250 @ A1
SHEET SIZE: A1

SHEET 10
OF
SHEETS 11

AUTOCAD REF: 13-12-20 SITE DETAIL (ADJ.MGA) [H].dwg
CIVILCAD REF: PR116997-MULTIPLE FILES.CCX
REVISION: H

CLIENT: WESTFIELD
JOB REF: PR116997

RPS AUSTRALIA EAST PTY LTD (ABN 44 140 292 762)
SUITE 404, 29-31 LEXINGTON DRIVE PO BOX 6843 BAULKHAM HILLS NSW 2153
T: 02 8884 6900 F: 02 8884 6999 www.rpsgroup.com.au

Copyright
This document and the information show shall remain the property of RPS Australia East Pty Ltd. The document may only be used for the purpose for which it was supplied and in accordance with the terms of engagement for the commission. Unauthorised use of this document in any way is prohibited.



N:\P\13-12-20\13-12-20 SITE DETAIL (ADJ.MGA) [H].dwg

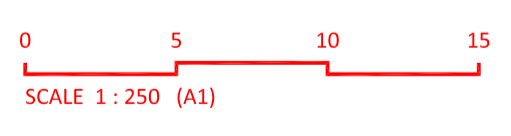
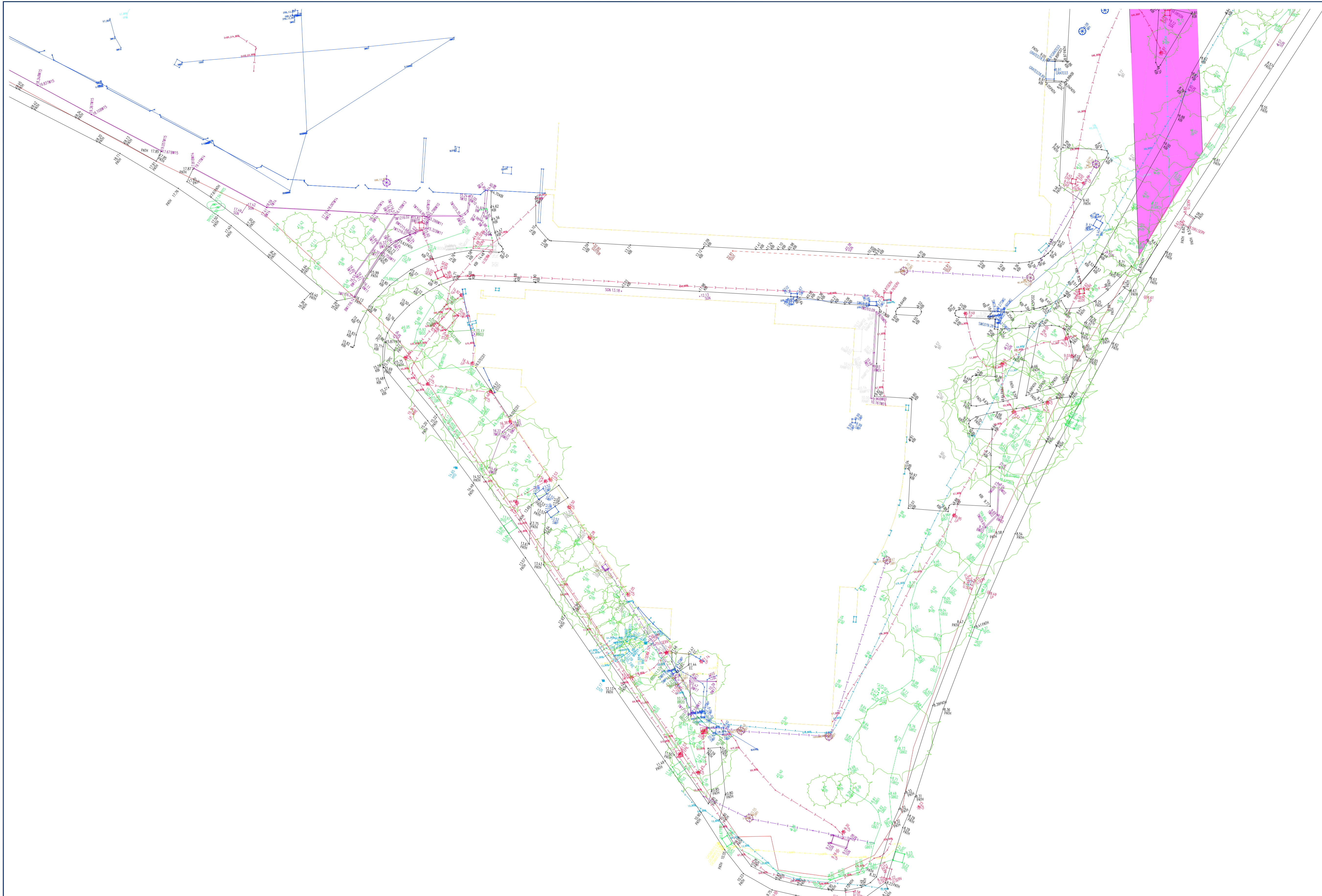

IMPORTANT NOTE

1. This plan was prepared for the sole purposes of the client for the specific purpose of producing a detail plan. This plan is strictly limited to the purpose and does not apply directly or indirectly and will not be used for any other application, purpose, use or matter. The plan is presented without the assumption of a duty of care to any other person (other than the Client) ("Third Party") and may not be relied on by Third Party.

2. RPS Australia East Pty Ltd will not be liable (in negligence or otherwise) for any direct or indirect loss, damage, liability or claim arising out of or incidental to:

A. Third Party publishing, using or relying on the plan;
 B. RPS Australia East Pty Ltd relying on information provided to it by the Client or a Third Party where the information is incorrect, incomplete, inaccurate, out-of-date or unreasonable;
 C. Any inaccuracies or other faults with information or data sourced from a Third Party;
 D. RPS Australia East Pty Ltd relying on surface indicators that are incorrect or inaccurate;
 E. The Client or any Third Party not verifying information in this plan where recommended by RPS Australia East Pty Ltd;
 F. Lodgement of this plan with any local authority against the recommendation of RPS Australia East Pty Ltd.

G. the accuracy, reliability, suitability or completeness of any approximations or estimates made or referred to by RPS Australia East Pty Ltd in this plan.

3. Without limiting paragraph 1 or 2 above, this plan may not be copied, distributed, or reproduced by any process unless this note is clearly displayed on the plan.

4. Scale shown is correct for the original plan and any copies of this plan should be verified by checking against the bar scale.

5. The title boundaries as shown hereon were not marked at the time of survey and have been determined by plan dimensions only and not by field survey.

7. Service line contained are a combination of scaled plots from the records of relevant authorities and field location by CARCNO AUS. Prior to any demolition, excavation or construction on the site, the relevant authority should be contacted for possible location of further underground services and detailed locations of all service.

8. Service location is accurate to ±200mm for height, ±100mm horizontal. The RL of the points in the service layers are ground / existing surface levels. Approximate depths to the service are shown where recorded.

Where the location of services that are critical to design should be physically potholed on site prior to design and construction.

TITLE: PLAN SHOWING TOPOGRAPHIC DETAIL & LEVELS AT WESTFIELD WARRINGAH MALL BEING LOT 100 IN D.P.1015283

CLIENT MANAGER: CPM
SURVEYED: AG/WD/DR
CAD OPERATOR: CPM/BN

LEVEL DATUM: A.H.D
ORIGIN OF LEVELS: PM5983
REDUCED LEVEL:

MERIDIAN: MGA
ORIGIN OF COORDINATES: PM5983
 E 339 405.767, N 6 261 968.729

DATE: 16/08/2013
SCALE: 1:250 @ A1
SHEET SIZE: A1

SHEET 11
OF
SHEETS 11

AUTOCAD REF: 13-12-20 SITE DETAIL (ADJ.MGA) [H].dwg
CIVILCAD REF: PR116997-MULTIPLE FILES.CCX
REVISION: H

CLIENT: WESTFIELD
JOB REF: PR116997

RPS AUSTRALIA EAST PTY LTD (ABN 44 140 292 762)
 SUITE 404, 29-31 LEXINGTON DRIVE PO BOX 6843 BAULKHAM HILLS NSW 2153
 T: 02 8884 6900 F: 02 8884 6999 www.rpsgroup.com.au

creativepeople
 making a difference

RPS

Copyright
 This document and the information show shall remain the property of RPS Australia East Pty Ltd.
 The document may only be used for the purpose for which it was supplied and in accordance with the
 terms of engagement for the commission. Unauthorised use of this document in any way is prohibited.

N:\Projects\116997\Westfield Warringah Mall\13-12-20 SITE DETAIL (ADJ.MGA) [H].dwg