

h (PL)

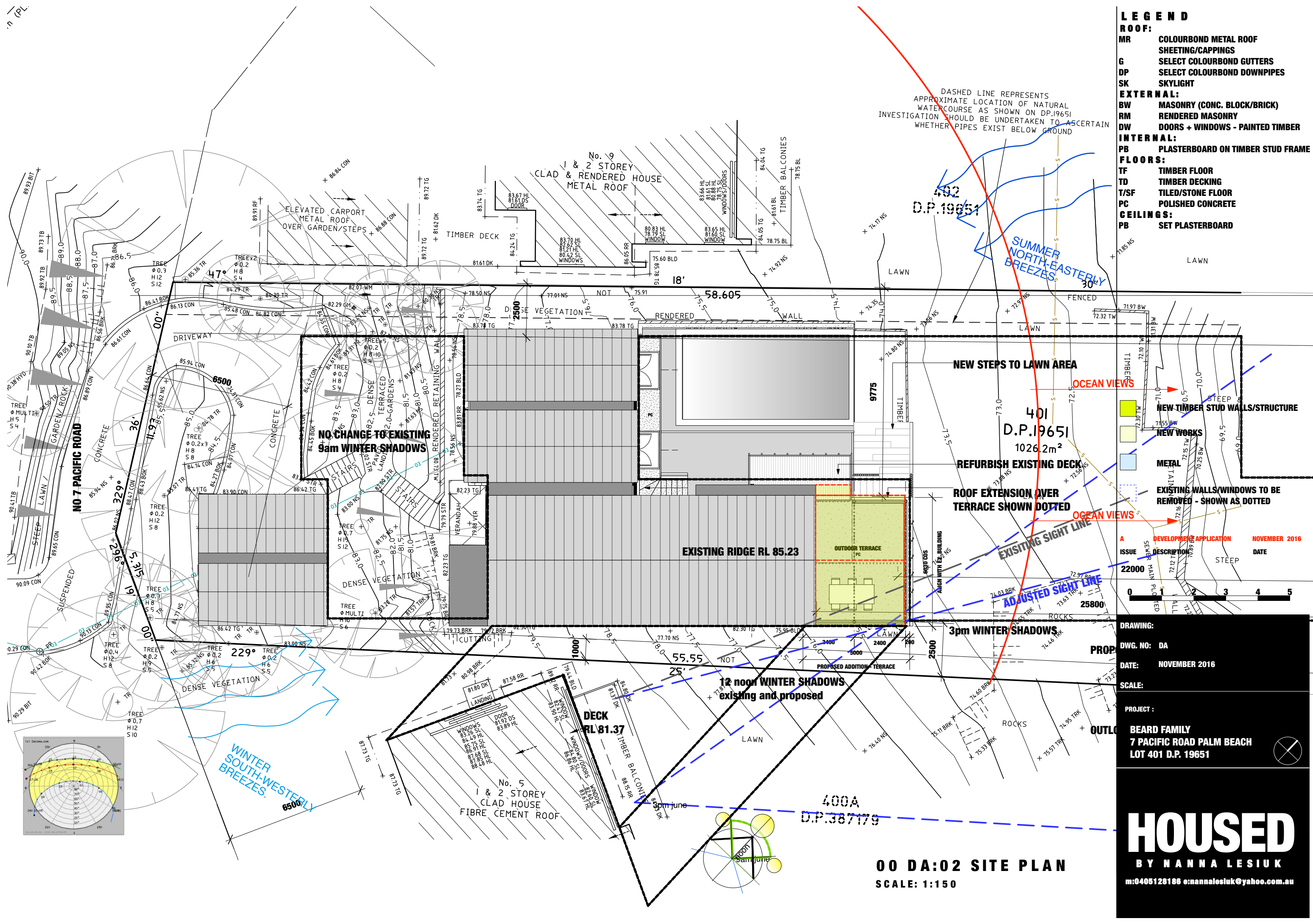

- LEGEND**
- ROOF:**
- MR COLOURBOND METAL ROOF SHEETING/CAPPINGS
 - G SELECT COLOURBOND GUTTERS
 - DP SELECT COLOURBOND DOWNPIPES
 - SK SKYLIGHT
- EXTERNAL:**
- BW MASONRY (CONC. BLOCK/BRICK)
 - RM RENDERED MASONRY
 - DW DOORS + WINDOWS - PAINTED TIMBER
- INTERNAL:**
- PB PLASTERBOARD ON TIMBER STUD FRAME
- FLOORS:**
- TF TIMBER FLOOR
 - TD TIMBER DECKING
 - T/SF TILED/STONE FLOOR
 - PC POLISHED CONCRETE
- CEILING:**
- PB SET PLASTERBOARD

DASHED LINE REPRESENTS APPROXIMATE LOCATION OF NATURAL WATERCOURSE AS SHOWN ON DP.19651 INVESTIGATION SHOULD BE UNDERTAKEN TO ASCERTAIN WHETHER PIPES EXIST BELOW GROUND

402
D.P.19651

SUMMER NORTH-EASTERLY BREEZES

NO CHANGE TO EXISTING 9am WINTER SHADOWS

NEW STEPS TO LAWN AREA

REFURBISH EXISTING DECK

ROOF EXTENSION OVER TERRACE SHOWN DOTTED

EXISTING RIDGE RL 85.23

OUTDOOR TERRACE

3pm WINTER SHADOWS

12 noon WINTER SHADOWS existing and proposed

DECK RL 81.37

No. 5
1 & 2 STOREY CLAD HOUSE
FIBRE CEMENT ROOF

400A
D.P.387179

00 DA:02 SITE PLAN
SCALE: 1:150

ISSUE	DESCRIPTION	DATE
22000	DEVELOPMENT APPLICATION	NOVEMBER 2016

DRAWING:
DWG. NO: DA
DATE: NOVEMBER 2016
SCALE:

PROJECT:
BEARD FAMILY
7 PACIFIC ROAD PALM BEACH
LOT 401 D.P. 19651

HOUSED
BY NANNA LESIUK
m:0405128186 e:nannalesiuk@yahoo.com.au

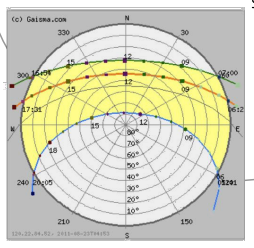

WINTER SOUTH-WESTERLY BREEZES