

## Drawing List

| Sheet No. | Sheet Name                       | Sheet Size | Rev. No.                                   | Rev. Date | Project No. |
|-----------|----------------------------------|------------|--|-----------|-------------|
| L-01      | SITE PLAN                        | A3         | A  | 13/12/24  | SDS_1010    |
| L-02      | PERGOLA PLAN                     | A3         | A  | 13/12/24  | SDS_1010    |
| L-03      | LANDSCAPE AREA CALCULATION       | A3         | A  | 13/12/24  | SDS_1010    |
| L-04      | SEDIMENT & WASTE MANAGEMENT PLAN | A3         | A  | 13/12/24  | SDS_1010    |
| L-05      | WESTERN ELEVATION A              | A3         | A  | 13/12/24  | SDS_1010    |
| L-06      | EASTERN ELEVATION B              | A3         | A </td <td>13/12/24</td> <td>SDS_1010</td> | 13/12/24  | SDS_1010    |
| L-07      | SOUTHERN ELEVATION C             | A3         | A  | 13/12/24  | SDS_1010    |
| L-08      | SECTION D                        | A3         | A  | 13/12/24  | SDS_1010    |
| L-09      | PERGOLA IMAGERIES                | A3         | A  | 13/12/24  | SDS_1010    |



## LEGEND

### LANDSCAPE AREAS

All building work must be carried out in compliance with the National Construction Code (NCC)

Building Work - Compliance with the Building Code of Australia  
All building work must be carried out in compliance with the provisions of the Building Code of Australia.

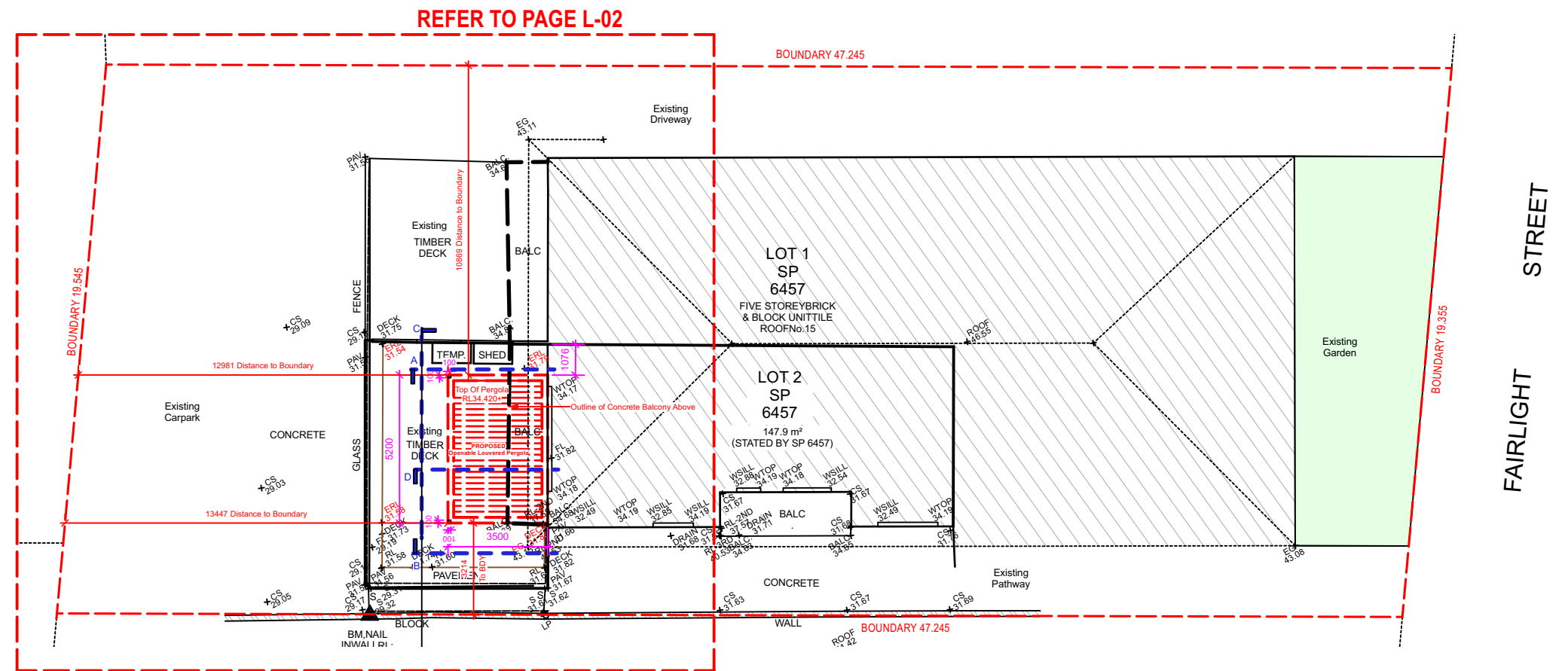
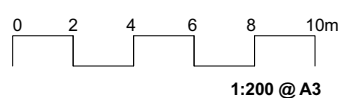

| ISSUE | DATE     | COMMENT    |
|-------|----------|------------|
| A     | 13/12/24 | FOR REVIEW |

**GENERAL NOTES**  
All work to be carried out in accordance with the Building Code of Australia, all Local and State Government Ordinances, relevant Australian Standards, Local Authorities Regulations and all other relevant Authorities concerned.  
All structural work and site drainage to be subject to Engineer's details or certification where required by Council. This shall include r.c. slabs and footings, r.c. and steel beams & columns, wind bracing to AS 1170 and AS4055, anchor rods or bolts, tie downs, fixings etc., driveway slabs and drainage to Council's satisfaction. All timbers to be in accordance with SAA Timber Structure Code AS1720 and SAA Timber Framing Code AS 1684. All work to be carried out in a professional and workman- shiplike manner according to the plans and specification.  
**NOTE**  
Do not scale off the drawings unless otherwise stated and use figured dimensions in preference.  
All dimensions are to be checked and verified on site before the commencement of any work, all dimensions and levels are subject to final survey and set-out. No responsibility will be accepted by Sitedesign for any variations in design, builder's method of construction or materials used, deviation from specification without permission or accepted work practices resulting in inferior construction. Locate and protect all services prior to construction.  
**COPYRIGHT CLAUSE**  
This drawing and design is the property of Sitedesign and should not be reproduced either in part or whole without the written consent of this firm.

**SITEDESIGN + STUDIOS**  
creating places to live in and enjoy

**SYDNEY NORTH STUDIO**  
PO Box 265  
SEAFORTH NSW 2092  
0417685846  
p 1300 22 44 55  
info@sdstudios.com.au  
www.sdstudios.com.au

Project **Proposed Swimming Pool**  
Address **NO.2/15 Fairlight Street MANLY NSW 2095**  
Drawing Title **SITE PLAN**

Date **13/12/24**

Scale **1:200@A3**

Drawing No. **SDS\_1010**

Page **L-01**

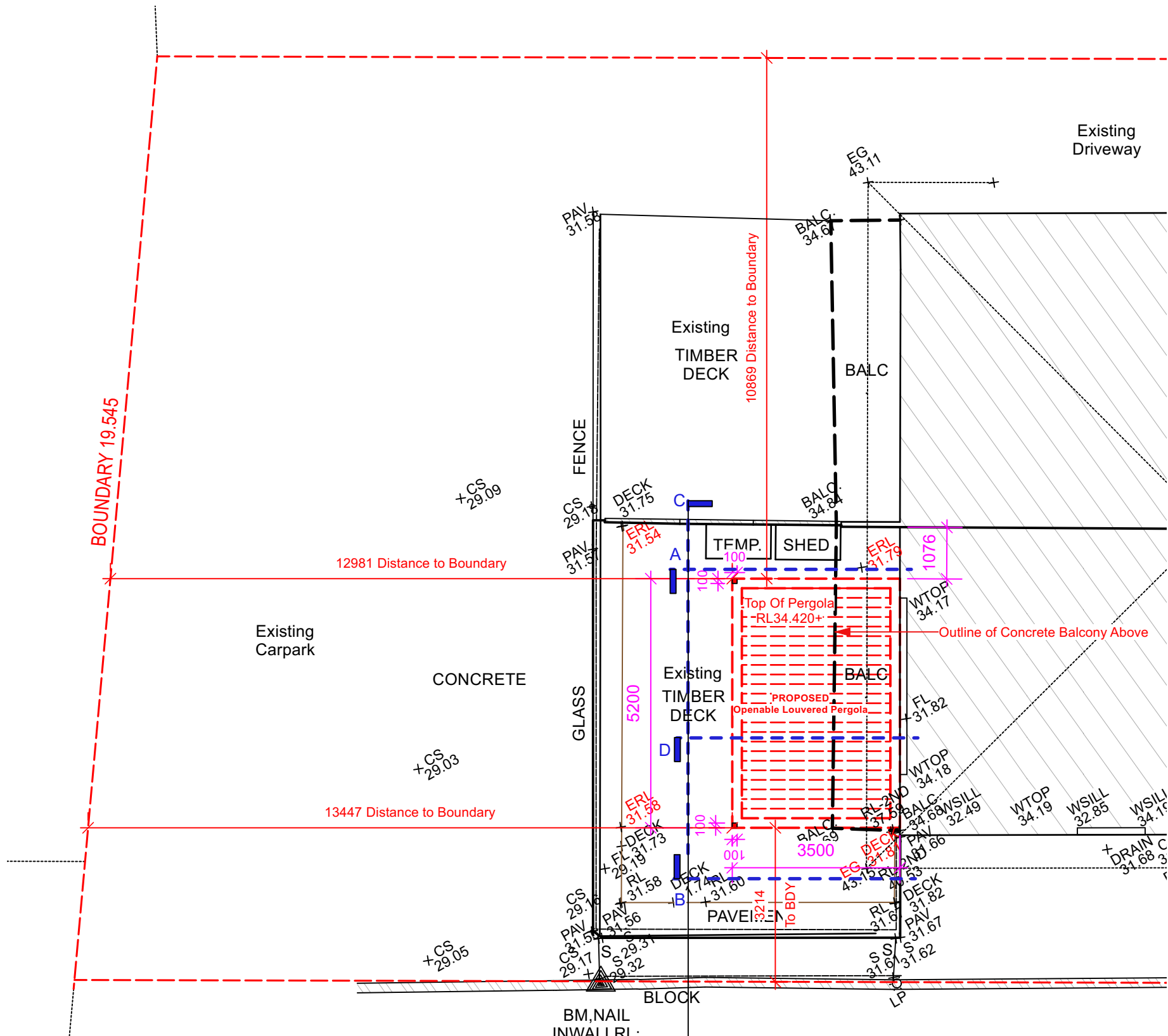

- EXISTING TREES TO BE RETAINED
- EXISTING TREES TO BE REMOVED

**LEGEND**

LANDSCAPE AREAS

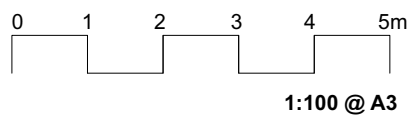

| AMENDMENTS | ISSUE DATE | COMMENT    |
|------------|------------|------------|
| A          | 13/12/24   | FOR REVIEW |

**GENERAL NOTES**  
 All work to be carried out in accordance with the Building Code of Australia, all Local and State Government Ordinances, relevant Australian Standards, Local Authorities Regulations and all other relevant Authorities concerned.  
 All structural work and site drainage to be subject to Engineer's details or certification where required by Council. This shall include r.c. slabs and footings, r.c. and steel beams & columns, wind bracing to AS 1170 and AS4055, anchor rods or bolts, tie downs, fixings etc., driveway slabs and drainage to Council's satisfaction. All timbers to be in accordance with SAA Timber Structure Code AS1720 and SAA Timber Framing Code AS 1684. All work to be carried out in a professional and workman- shiplike manner according to the plans and specification.  
 NOTE  
 Do not scale off the drawings unless otherwise stated and use figured dimensions in preference.  
 All dimensions are to be checked and verified on site before the commencement of any work, all dimensions and levels are subject to final survey and set-out. No responsibility will be accepted by Sitedesign for any variations in design, builder's method of construction or materials used, deviation from specification without permission or accepted work practices resulting in inferior construction. Locate and protect all services prior to construction.  
 COPYRIGHT CLAUSE  
 This drawing and design is the property of Sitedesign and should not be reproduced either in part or whole without the written consent of this firm.

**SITEDESIGN + STUDIOS**  
 creating places to live in and enjoy

**SYDNEY NORTH STUDIO**  
 PO Box 265  
 SEAFORTH NSW 2092  
 0417685846  
 p 1300 22 44 55  
 info@sdstudios.com.au  
 www.sdstudios.com.au

|               |   |
|---------------|---|
| Project       | Proposed Swimming Pool                  |
| Address       | NO.2/15 Fairlight Street MANLY NSW 2095 |
| Drawing Title | PERGOLA PLAN                            |
| Date          | 13/12/24                                |
| Scale         | 1:200@A3                                |

Drawing No. SDS\_1010

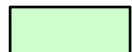
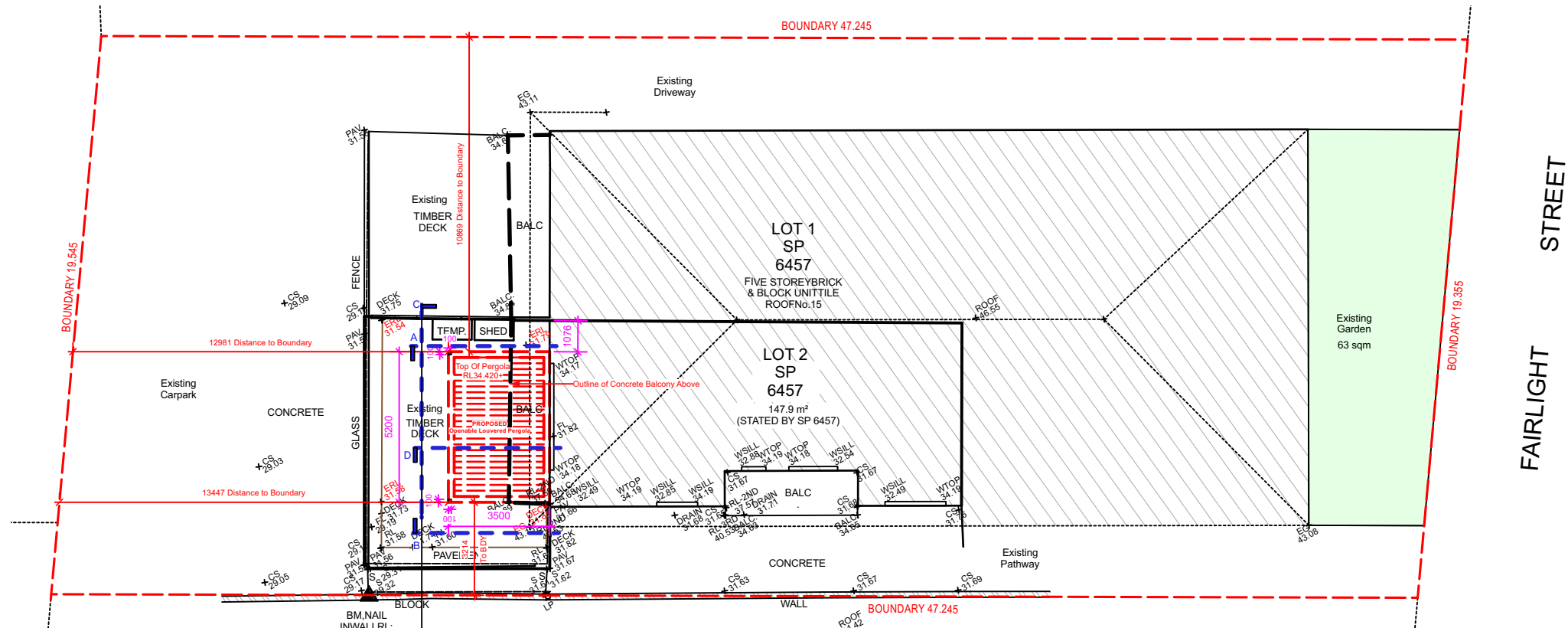

**SITE CALCULATION**

SITE AREA OF BLOCK = 904.2 sqm

Total Existing Landscape Area  
=63 sqm = 6.97 % of Site Area

Open Space Area will remain unchanged from existing.

Landscape Area will remain unchanged from existing.

**LEGEND**

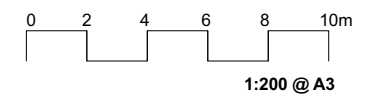
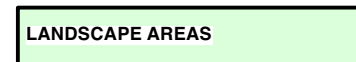

**A 13/12/24 FOR REVIEW**  
**ISSUE DATE COMMENT**  
**AMENDMENTS**

**GENERAL NOTES**  
 All work to be carried out in accordance with the Building Code of Australia, all Local and State Government Ordinances, relevant Australian Standards, Local Authorities Regulations and all other relevant Authorities concerned.  
 All structural work and site drainage to be subject to Engineer's details or certification where required by Council. This shall include r.c. slabs and footings, r.c. and steel beams & columns, wind bracing to AS 1170 and AS4055, anchor rods or bolts, tie downs, fixings etc., driveway slabs and drainage to Council's satisfaction. All timbers to be in accordance with SAA Timber Structure Code AS1720 and SAA Timber Framing Code AS 1684. All work to be carried out in a professional and workman- shiplike manner according to the plans and specification.  
 NOTE  
 Do not scale off the drawings unless otherwise stated and use figured dimensions in preference.  
 All dimensions are to be checked and verified on site before the commencement of any work, all dimensions and levels are subject to final survey and set-out. No responsibility will be accepted by Sitedesign for any variations in design, builder's method of construction or materials used, deviation from specification without permission or accepted work practices resulting in inferior construction. Locate and protect all services prior to construction.  
 COPYRIGHT CLAUSE  
 This drawing and design is the property of Sitedesign and should not be reproduced either in part or whole without the written consent of this firm.



**SYDNEY NORTH STUDIO**  
 PO Box 265  
 SEAFORTH NSW 2092  
 0417685846  
 p 1300 22 44 55  
 info@sdstudios.com.au  
 www.sdstudios.com.au

Project **Proposed Swimming Pool**  
 Address **NO.2/15 Fairlight Street MANLY NSW 2095** Date **13/12/24**  
 Drawing Title **LANDSCAPE AREA CALCULATION** Scale **1:200@A3**

Drawing No. **SDS\_1010**

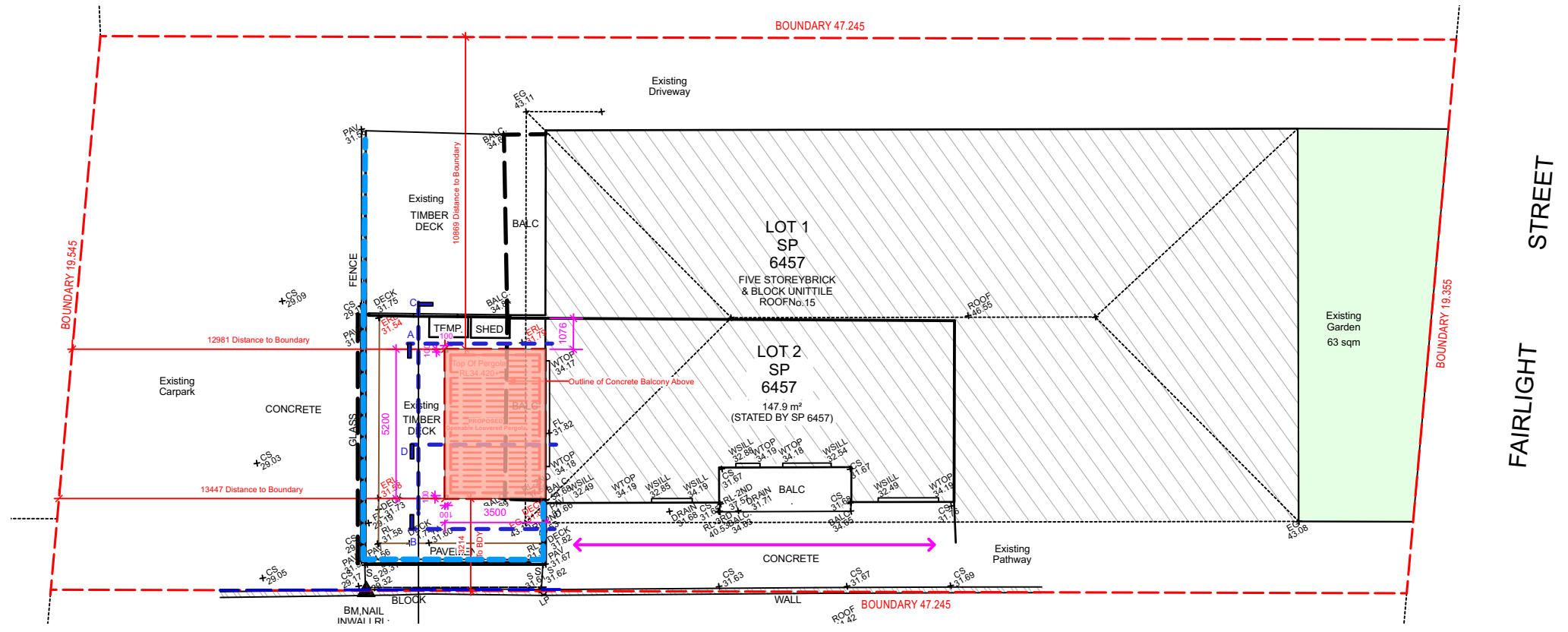

**CONSTRUCTION MANAGEMENT NOTES**

1. NO VEGETATION OR GRASS COVER IS TO BE REMOVED EXCEPT WITHIN AREAS OF NEW CONSTRUCTION.
2. INSTALL HAY BALES OR SEDIMENT CONTROL FENCING AS NECESSARY TO ENSURE THAT SILT FROM ANY DISTURBED AREAS IS TRAPPED ON-SITE.
3. PROVIDE BARRIERS AROUND ALL CONSTRUCTION WORK ON THE FOOTPATH AREA TO PROVIDE SAFE ALTERNATIVE ACCESS FOR PEDESTRIANS.
4. ALL WASTE MATERIALS ARE TO BE REMOVED FROM SITE OR STOCKPILED WITHIN THE SITE PRIOR TO REMOVAL.
5. ALL CONSTRUCTION MATERIALS & SITE SHEDS ARE TO BE KEPT WITHIN THE SITE AT ALL TIMES.

- AREA OF WORKS
- GLASS FENCE
- SILT FENCE LOCATION
- SITE ACCESS
- SEDIMENT FENCE

**SOIL & WATER MANAGEMENT NOTES**

1. WHEREVER POSSIBLE, EXISTING VEGETATION & GRASS COVER IS TO BE LEFT UNDISTURBED.
2. REMOVAL OR DISTURBANCE OF VEGETATION & TOP SOIL SHALL BE CONFINED TO WITHIN 3m OF THE APPROVED BUILDING AREA.
3. TEMPORARY SILT FENCE ( AS SHOWN ) TO BE INSTALLED PRIOR TO THE COMMENCEMENT OF ANY EARTHWORKS.
4. AND MAINTAINED THROUGHOUT THE CONSTRUCTION PERIOD, AND PARTICULAR AFTER STORM EVENTS.

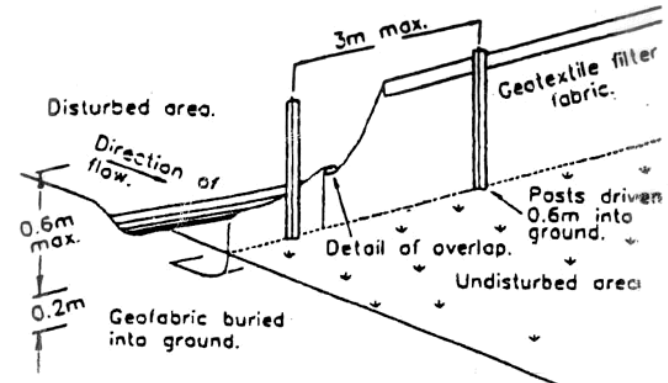

**Sediment Fence**

**LEGEND**

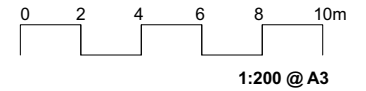

| ISSUE | DATE     | COMMENT    |
|-------|----------|------------|
| A     | 13/12/24 | FOR REVIEW |

**GENERAL NOTES**  
 All work to be carried out in accordance with the Building Code of Australia, all Local and State Government Ordinances, relevant Australian Standards, Local Authorities Regulations and all other relevant Authorities concerned.  
 All structural work and site drainage to be subject to Engineer's details or certification where required by Council. This shall include r.c. slabs and footings, r.c. and steel beams & columns, wind bracing to AS 1170 and AS4055, anchor rods or bolts, tie downs, fixings etc., driveway slabs and drainage to Council's satisfaction. All timbers to be in accordance with SAA Timber Structure Code AS1720 and SAA Timber Framing Code AS 1684. All work to be carried out in a professional and workman- shiplike manner according to the plans and specification.  
 NOTE  
 Do not scale off the drawings unless otherwise stated and use figured dimensions in preference.  
 All dimensions are to be checked and verified on site before the commencement of any work, all dimensions and levels are subject to final survey and set-out. No responsibility will be accepted by Sitedesign for any variations in design, builder's method of construction or materials used, deviation from specification without permission or accepted work practices resulting in inferior construction. Locate and protect all services prior to construction.  
 COPYRIGHT CLAUSE  
 This drawing and design is the property of Sitedesign and should not be reproduced either in part or whole without the written consent of this firm.



**SYDNEY NORTH STUDIO**  
 PO Box 265  
 SEAFORTH NSW 2092  
 0417685846  
 p 1300 22 44 55  
 info@sdstudios.com.au  
 www.sdstudios.com.au

|               |   |                |
|---------------|---|----------------|
| Project       | Proposed Swimming Pool                  |                |
| Address       | NO.2/15 Fairlight Street MANLY NSW 2095 |                |
| Drawing Title | SEDIMENT & WASTE MANAGEMENT             | Date 13/12/24  |
|               | PLAN                                    | Scale 1:200@A3 |



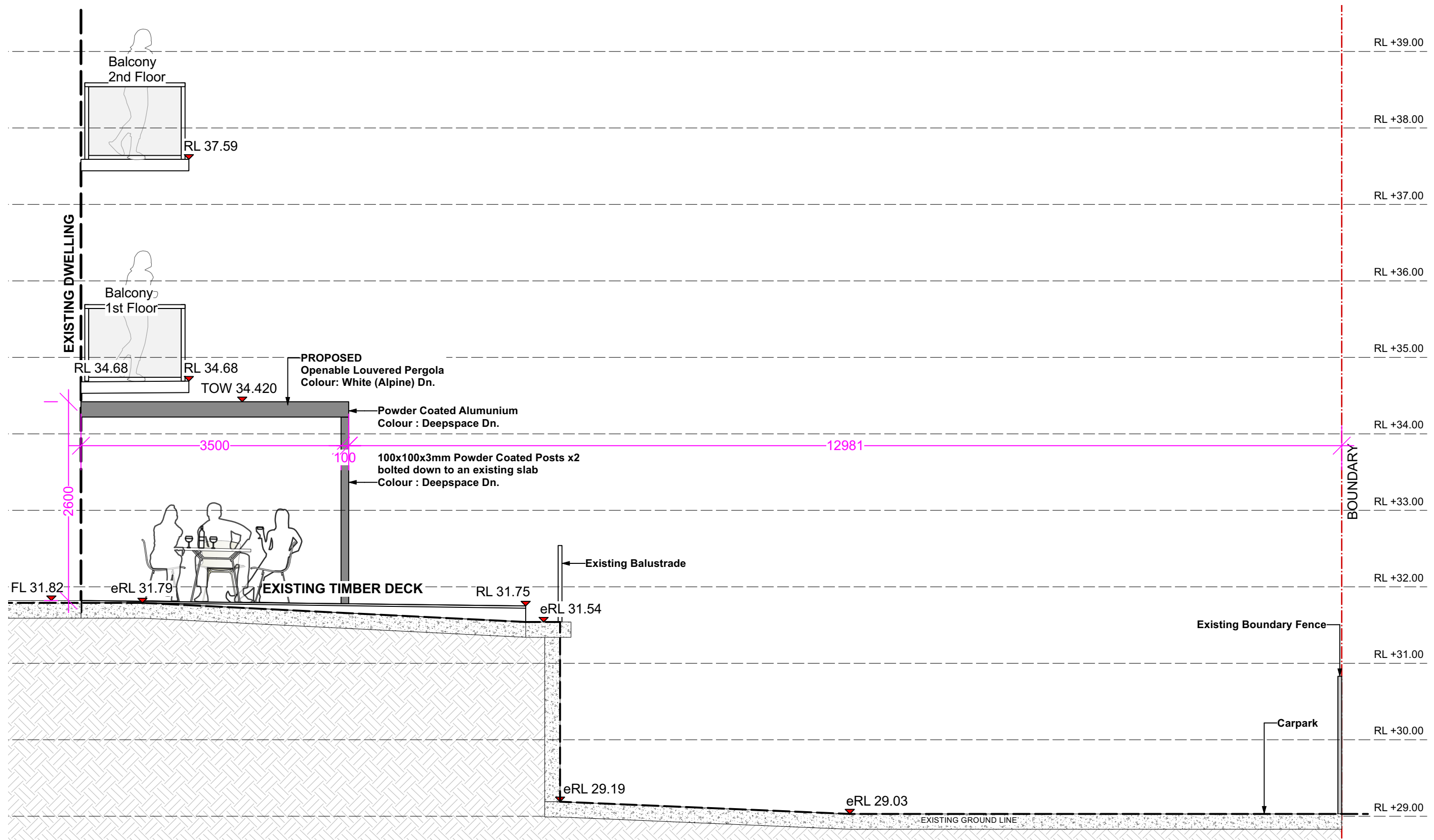

**1 WESTERN ELEVATION A**  
Scale: 1:50

**A 13/12/24 FOR REVIEW**  
ISSUE DATE COMMENT  
AMENDMENTS

**GENERAL NOTES**  
All work to be carried out in accordance with the Building Code of Australia, all Local and State Government Ordinances, relevant Australian Standards, Local Authorities Regulations and all other relevant Authorities concerned.  
All structural work and site drainage to be subject to Engineer's details or certification where required by Council. This shall include r.c. slabs and footings, r.c. and steel beams & columns, wind bracing to AS 1170 and AS4055, anchor rods or bolts, tie downs, fixings etc., driveway slabs and drainage to Council's satisfaction. All timbers to be in accordance with SAA Timber Structure Code AS1720 and SAA Timber Framing Code AS 1684. All work to be carried out in a professional and workman- shiplike manner according to the plans and specification.  
NOTE  
Do not scale off the drawings unless otherwise stated and use figured dimensions in preference.  
All dimensions are to be checked and verified on site before the commencement of any work, all dimensions and levels are subject to final survey and set-out. No responsibility will be accepted by Sitedesign for any variations in design, builder's method of construction or materials used, deviation from specification without permission or accepted work practices resulting in inferior construction. Locate and protect all services prior to construction.  
COPYRIGHT CLAUSE  
This drawing and design is the property of Sitedesign and should not be reproduced either in part or whole without the written consent of this firm.

**SITEDESIGN + STUDIOS**  
creating places to live in and enjoy

**SYDNEY NORTH STUDIO**  
PO Box 265  
SEAFORTH NSW 2092  
0417685846  
p 1300 22 44 55  
info@sdstudios.com.au  
www.sdstudios.com.au

|               |   |
|---------------|---|
| Project       | Proposed Swimming Pool                  |
| Address       | NO.2/15 Fairlight Street MANLY NSW 2095 |
| Drawing Title | WESTERN ELEVATION A                     |
| Date          | 13/12/24                                |
| Scale         | 1:50@A3                                 |

Drawing No. SDS\_1010

Page  
**L-05**

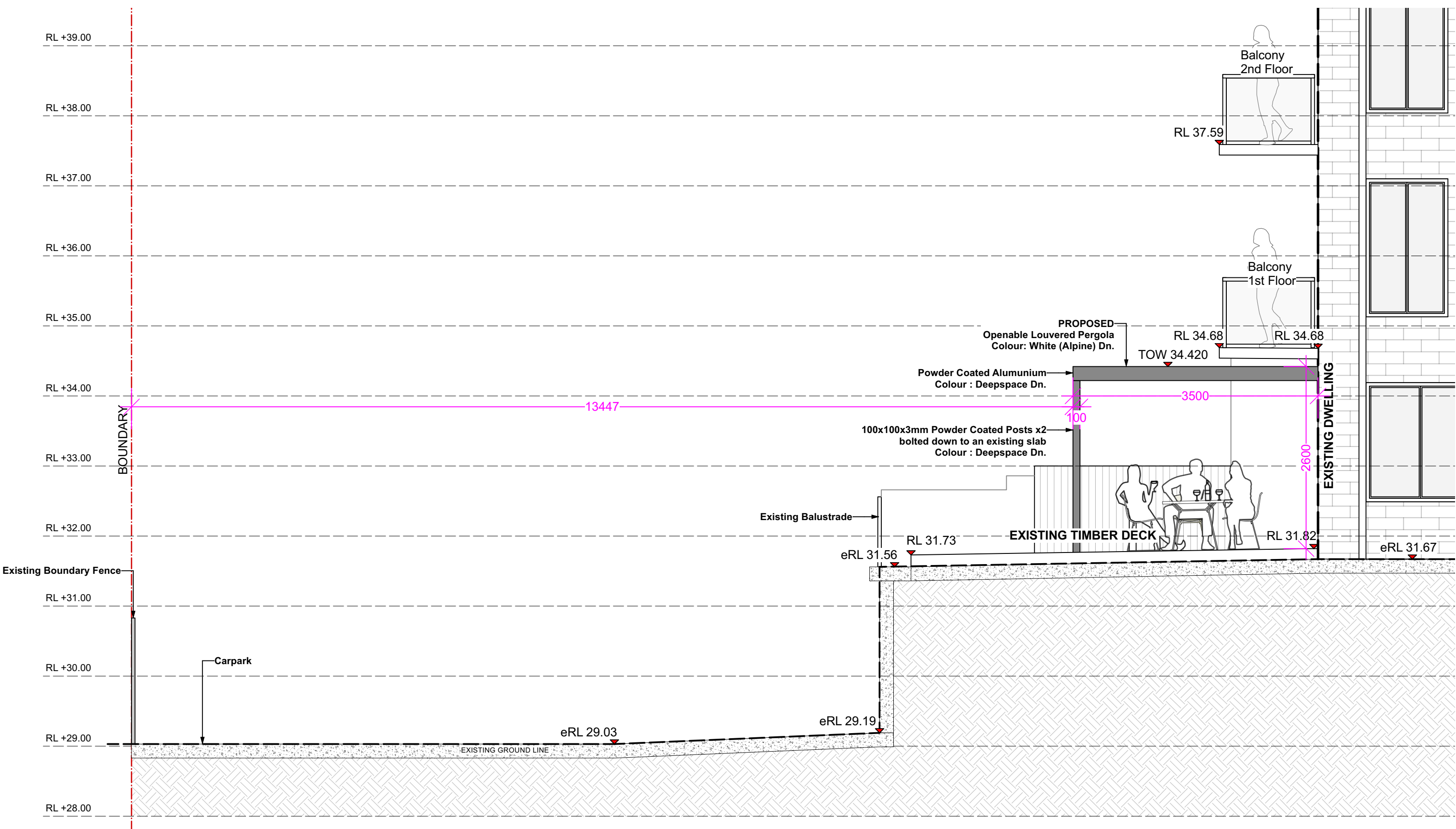

2

**EASTERN ELEVATION B**  
Scale: 1:50

| ISSUE | DATE     | COMMENT    |
|-------|----------|------------|
| A     | 13/12/24 | FOR REVIEW |

**GENERAL NOTES**  
 All work to be carried out in accordance with the Building Code of Australia, all Local and State Government Ordinances, relevant Australian Standards, Local Authorities Regulations and all other relevant Authorities concerned.  
 All structural work and site drainage to be subject to Engineer's details or certification where required by Council. This shall include r.c. slabs and footings, r.c. and steel beams & columns, wind bracing to AS 1170 and AS4055, anchor rods or bolts, tie downs, fixings etc., driveway slabs and drainage to Council's satisfaction. All timbers to be in accordance with SAA Timber Structure Code AS1720 and SAA Timber Framing Code AS 1684. All work to be carried out in a professional and workman-like manner according to the plans and specification.  
 NOTE  
 Do not scale off the drawings unless otherwise stated and use figured dimensions in preference.  
 All dimensions are to be checked and verified on site before the commencement of any work, all dimensions and levels are subject to final survey and set-out. No responsibility will be accepted by Sitedesign for any variations in design, builder's method of construction or materials used, deviation from specification without permission or accepted work practices resulting in inferior construction. Locate and protect all services prior to construction.  
 COPYRIGHT CLAUSE  
 This drawing and design is the property of Sitedesign and should not be reproduced either in part or whole without the written consent of this firm.

**SITEDESIGN  
+STUDIOS**  
creating places to live in and enjoy

**SYDNEY NORTH STUDIO**  
 PO Box 265  
 SEAFORTH NSW 2092  
 0417685846  
 p 1300 22 44 55  
 info@sdstudios.com.au  
 www.sdstudios.com.au

|               |   |
|---------------|---|
| Project       | Proposed Swimming Pool                  |
| Address       | NO.2/15 Fairlight Street MANLY NSW 2095 |
| Drawing Title | EASTERN ELEVATION B                     |
| Date          | 13/12/24                                |
| Scale         | 1:50@A3                                 |

Drawing No. SDS\_1010

Page  
**L-06**

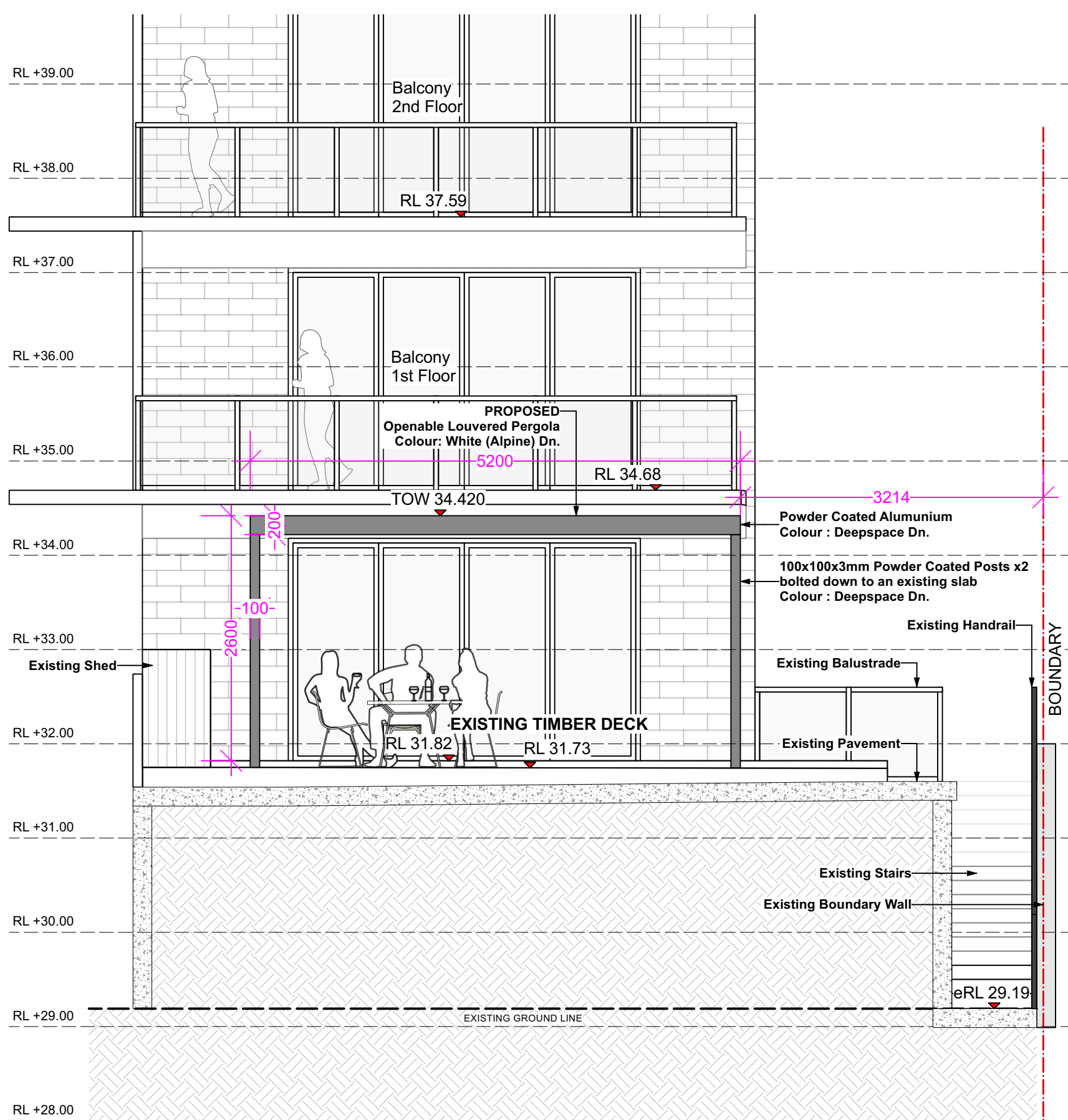

3

**SOUTHERN ELEVATION C**  
Scale: 1:50

**A** 13/12/24 FOR REVIEW  
ISSUE DATE COMMENT  
AMENDMENTS

**GENERAL NOTES**  
All work to be carried out in accordance with the Building Code of Australia, all Local and State Government Ordinances, relevant Australian Standards, Local Authorities Regulations and all other relevant Authorities concerned.  
All structural work and site drainage to be subject to Engineer's details or certification where required by Council. This shall include r.c. slabs and footings, r.c. and steel beams & columns, wind bracing to AS 1170 and AS4055, anchor rods or bolts, tie downs, fixings etc., driveway slabs and drainage to Council's satisfaction. All timbers to be in accordance with SAA Timber Structure Code AS1720 and SAA Timber Framing Code AS 1684. All work to be carried out in a professional and workman- shiplike manner according to the plans and specification.  
**NOTE**  
Do not scale off the drawings unless otherwise stated and use figured dimensions in preference.  
All dimensions are to be checked and verified on site before the commencement of any work, all dimensions and levels are subject to final survey and set-out. No responsibility will be accepted by Sitedesign for any variations in design, builder's method of construction or materials used, deviation from specification without permission or accepted work practices resulting in inferior construction. Locate and protect all services prior to construction.  
**COPYRIGHT CLAUSE**  
This drawing and design is the property of Sitedesign and should not be reproduced either in part or whole without the written consent of this firm.

**SITEDESIGN + STUDIOS**  
creating places to live in and enjoy

**SYDNEY NORTH STUDIO**  
PO Box 265  
SEAFORTH NSW 2092  
0417685846  
p 1300 22 44 55  
info@sdstudios.com.au  
www.sdstudios.com.au

Project **Proposed Swimming Pool**  
Address **NO.2/15 Fairlight Street MANLY NSW 2095**  
Drawing Title **SOUTHERN ELEVATION C**

Date **13/12/24**  
Scale **1:50@A3**

Page  
**L-07**

Drawing No. **SDS\_1010**

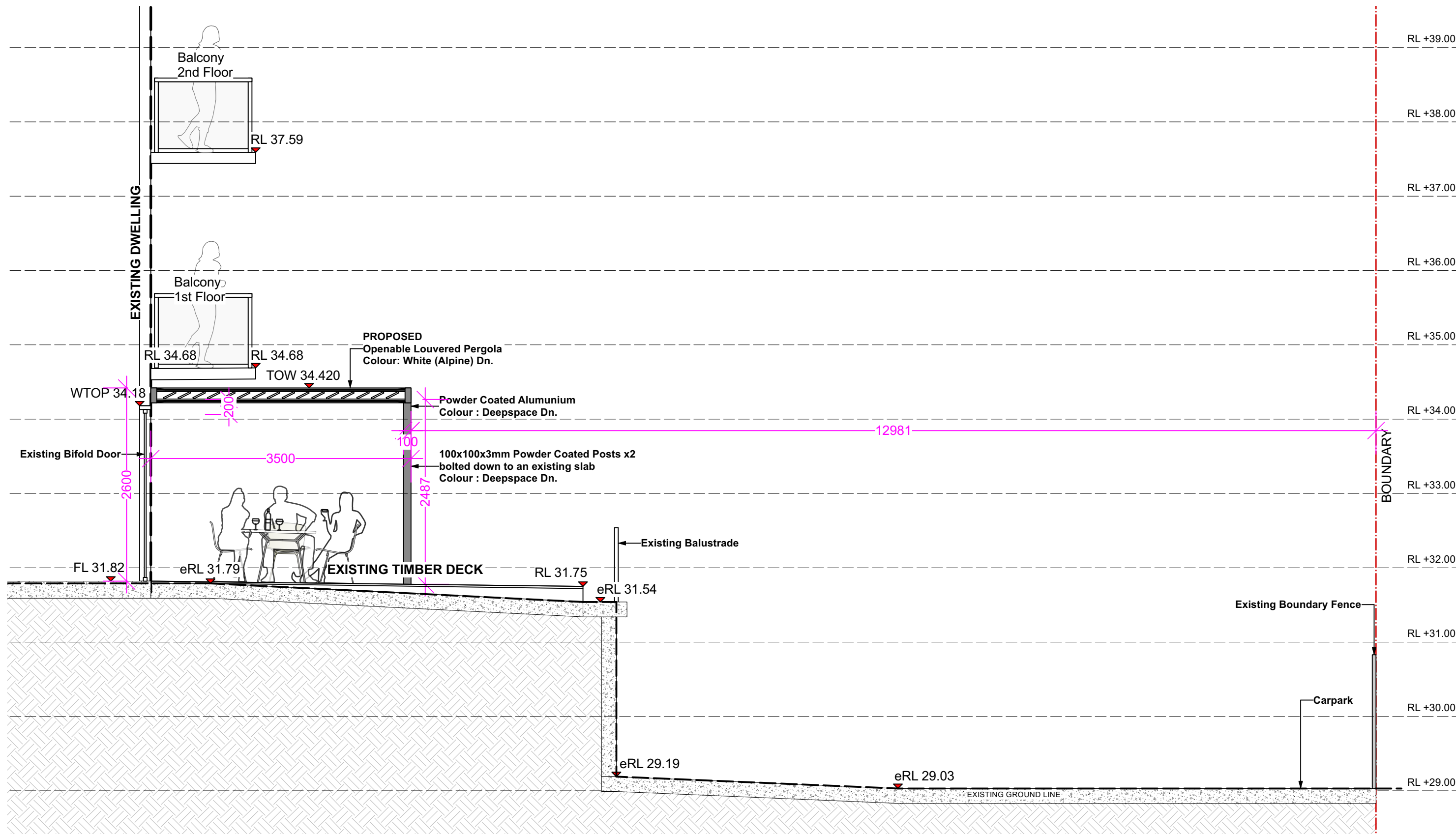

**4 SECTION D**  
Scale: 1:50

| ISSUE | DATE     | COMMENT    |
|-------|----------|------------|
| A     | 13/12/24 | FOR REVIEW |

**GENERAL NOTES**  
 All work to be carried out in accordance with the Building Code of Australia, all Local and State Government Ordinances, relevant Australian Standards, Local Authorities Regulations and all other relevant Authorities concerned.  
 All structural work and site drainage to be subject to Engineer's details or certification where required by Council. This shall include r.c. slabs and footings, r.c. and steel beams & columns, wind bracing to AS 1170 and AS4055, anchor rods or bolts, tie downs, fixings etc., driveway slabs and drainage to Council's satisfaction. All timbers to be in accordance with SAA Timber Structure Code AS1720 and SAA Timber Framing Code AS 1684. All work to be carried out in a professional and workman- shiplike manner according to the plans and specification.  
 NOTE  
 Do not scale off the drawings unless otherwise stated and use figured dimensions in preference.  
 All dimensions are to be checked and verified on site before the commencement of any work, all dimensions and levels are subject to final survey and set-out. No responsibility will be accepted by Sitedesign for any variations in design, builder's method of construction or materials used, deviation from specification without permission or accepted work practices resulting in inferior construction. Locate and protect all services prior to construction.  
 COPYRIGHT CLAUSE  
 This drawing and design is the property of Sitedesign and should not be reproduced either in part or whole without the written consent of this firm.

**SITEDESIGN + STUDIOS**  
 creating places to live in and enjoy

**SYDNEY NORTH STUDIO**  
 PO Box 265  
 SEAFORTH NSW 2092  
 0417685846  
 p 1300 22 44 55  
 info@sdstudios.com.au  
 www.sdstudios.com.au

|               |   |
|---------------|---|
| Project       | Proposed Swimming Pool                  |
| Address       | NO.2/15 Fairlight Street MANLY NSW 2095 |
| Drawing Title | SECTION D                               |
| Date          | 13/12/24                                |
| Scale         | 1:50@A3                                 |

Drawing No. SDS\_1010



# STRATCO PAVILION ALLURE PERGOLA

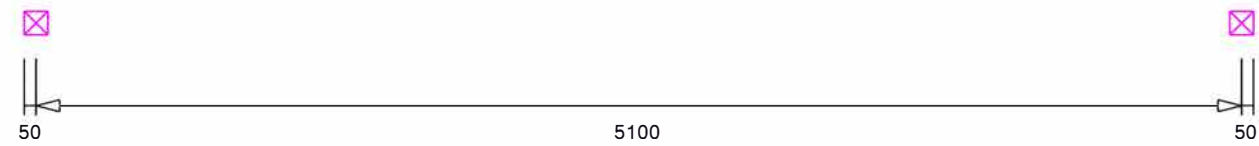
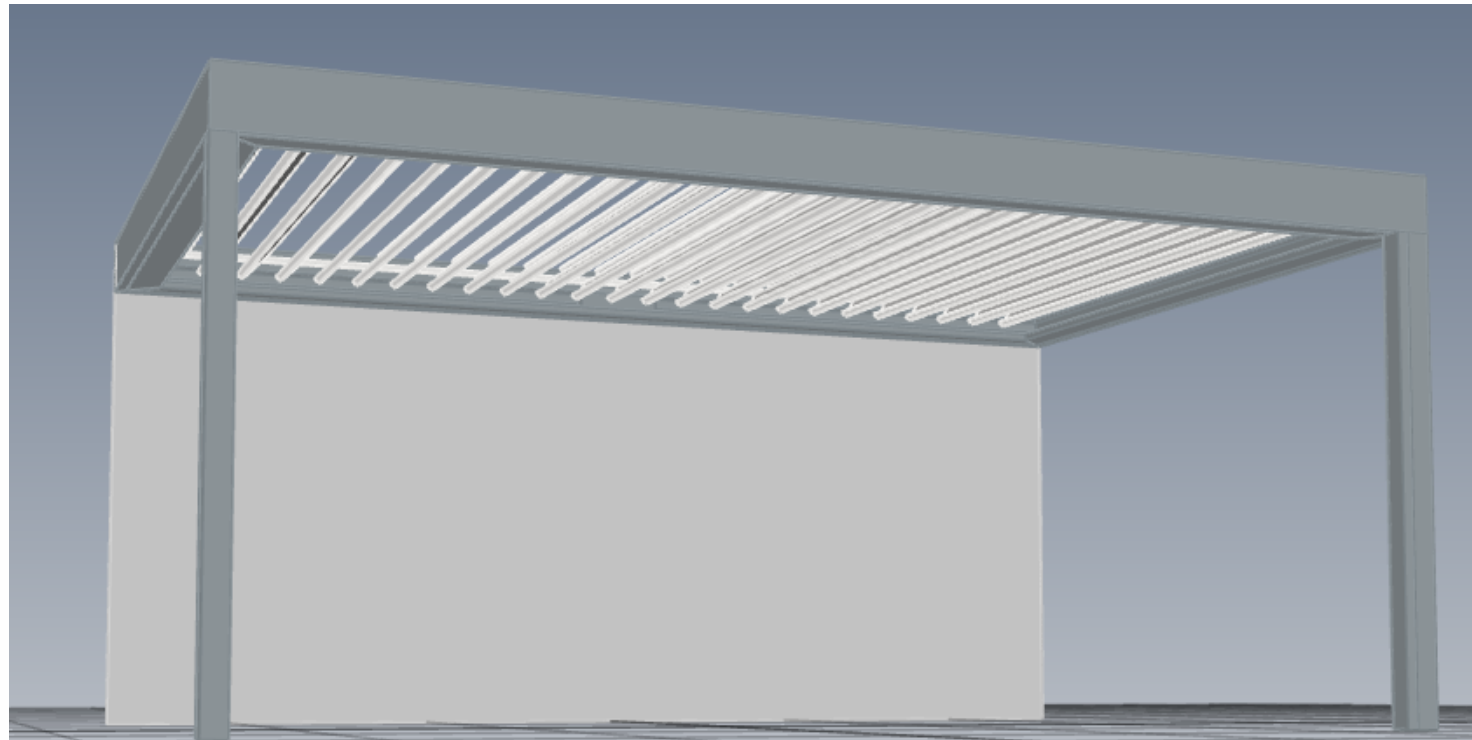

Front View

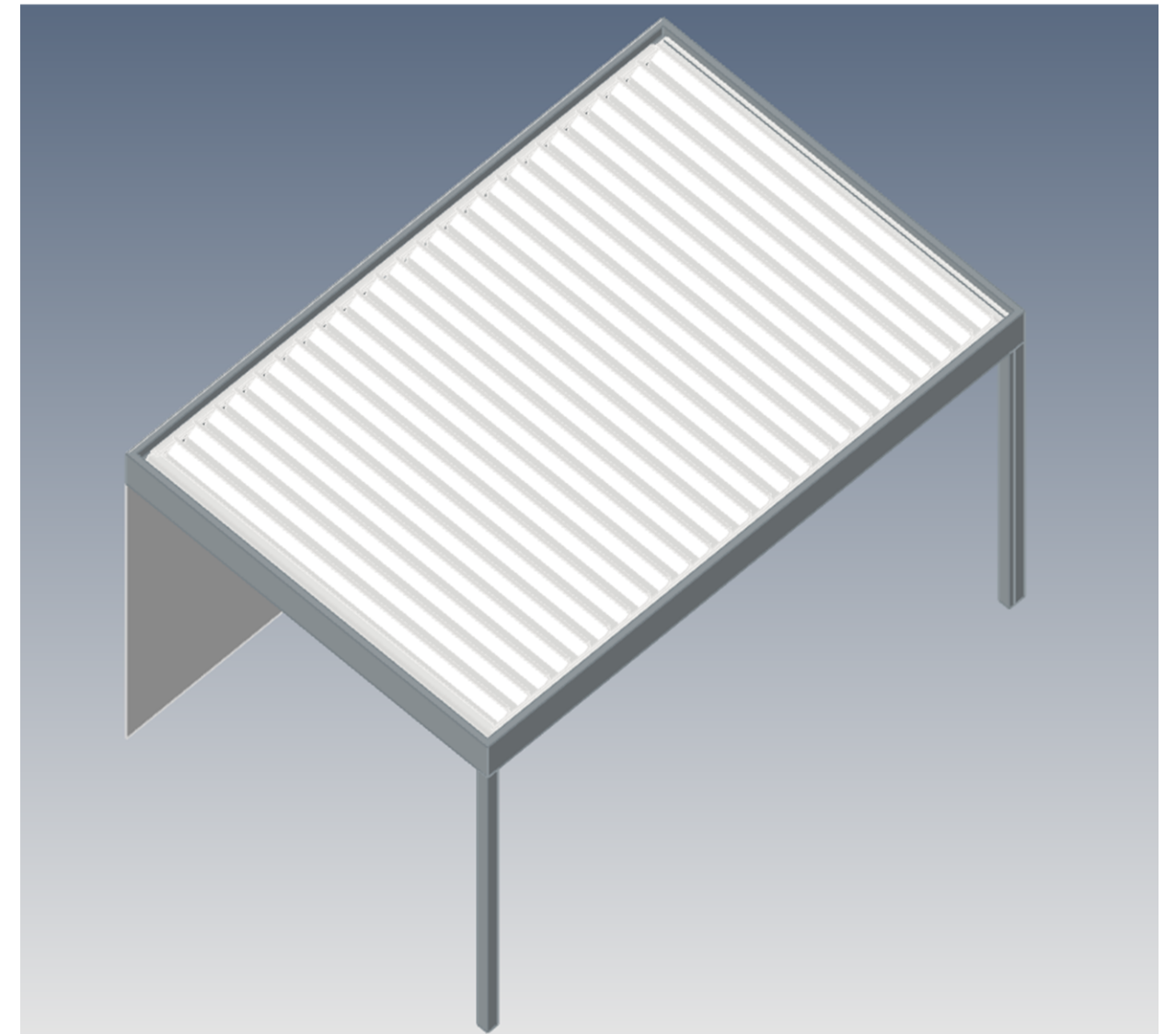

Isometric View

| ISSUE | DATE     | COMMENT    |
|-------|----------|------------|
| A     | 13/12/24 | FOR REVIEW |

**GENERAL NOTES**  
 All work to be carried out in accordance with the Building Code of Australia, all Local and State Government Ordinances, relevant Australian Standards, Local Authorities Regulations and all other relevant Authorities concerned.  
 All structural work and site drainage to be subject to Engineer's details or certification where required by Council. This shall include r.c. slabs and footings, r.c. and steel beams & columns, wind bracing to AS 1170 and AS4055, anchor rods or bolts, tie downs, fixings etc., driveway slabs and drainage to Council's satisfaction. All timbers to be in accordance with SAA Timber Structure Code AS1720 and SAA Timber Framing Code AS 1684. All work to be carried out in a professional and workman- shiplike manner according to the plans and specification.  
**NOTE**  
 Do not scale off the drawings unless otherwise stated and use figured dimensions in preference.  
 All dimensions are to be checked and verified on site before the commencement of any work, all dimensions and levels are subject to final survey and set-out. No responsibility will be accepted by Sitedesign for any variations in design, builder's method of construction or materials used, deviation from specification without permission or accepted work practices resulting in inferior construction. Locate and protect all services prior to construction.  
**COPYRIGHT CLAUSE**  
 This drawing and design is the property of Sitedesign and should not be reproduced either in part or whole without the written consent of this firm.

**SITEDESIGN  
 +STUDIOS**  
 creating places to live in and enjoy

**SYDNEY NORTH STUDIO**  
 PO Box 265  
 SEAFORTH NSW 2092  
 0417685846  
 p 1300 22 44 55  
 info@sdstudios.com.au  
 www.sdstudios.com.au

|               |   |                      |
|---------------|---|----------------------|
| Project       | Proposed Swimming Pool                  |                      |
| Address       | NO.2/15 Fairlight Street MANLY NSW 2095 |                      |
| Drawing Title | PERGOLA IMAGERIES                       | Date 13/12/24        |
|               |   | Scale N.T.S@A3       |
|               |   | Drawing No. SDS_1010 |

Page  
**L-09**