



# PITTWATER COUNCIL

RECEIVED MONA VALE  
7 FEB 2013  
CUSTOMER SERVICE

## Application to Remove/Prune Trees – Private & Public Land

**Applicant**

Applicants Name: STEPHEN VESCIO.

Postal Address: 119 Barronjoey Rd

Suburb: Mona Vale Postcode: 2103.

Phone ( ) \_\_\_\_\_ Daytime Contact No ( ) 0404 050811.

Mobile ( ) 0404 050811. Fax ( ) \_\_\_\_\_

Email: steve-vescio@iinet-net.au

Signature of Applicant: [Signature]

Signature of Owner of Property: [Signature] (Fiona Vesio)

*Applications on private property will not be processed until fees are paid in full.*

**Indemnity**

*This indemnity form must be completed and signed before approval can be issued.*

We the undersigned, (referred to hereafter as the Permit Holder) holds Pittwater Council (referred to hereafter as the Council) harmless, and releases and indemnifies and keeps released and indemnified, from and against all actions, suits, claims, demands, costs, charges and expenses for which Council, its servants, agents or employees may be held liable in respect of any loss damage, accident or injury of whatsoever nature or kind and however sustained or occasioned and whether to property or persons in connection with the use of this public area and any work connected therewith pursuant to this permit but excluding such liability arising from any negligent act, default or omission, on the part of Council, its servants, agents or employees either solely or in contribution thereto.

Signature of Applicant: [Signature] Date 6/2/13.

Signature of Owner of Property: [Signature] (Fiona Vesio) Date 6/2/13

**Trees/Information**

*Please read all information carefully Fees apply to applications for private land.*

<b>Are the trees/ located on:</b>	<b>Property information</b>
<input checked="" type="checkbox"/> Private Property	<input type="checkbox"/> Dog on Property
<input type="checkbox"/> Public land or road reserve	<input type="checkbox"/> Development proposed on property
<input type="checkbox"/> Public and private land	<input type="checkbox"/> Development application been lodged

The Privacy and Personal Information Protection Act 1998 (PPIPA) was introduced by the NSW government to provide for the protection of personal information and the protection of privacy of individuals generally. The Act applies to information collected, used and stored by public sector agencies such as local councils. Under the Act, "personal information" is any information that identifies a person, such as their name, address and contact details. Pittwater Council requires this type of information to carry out even their most primary core services. Council is committed to handle this information in accordance with PPIPA and other State and Federal legislation. In the year 2000, Pittwater Council adopted a Privacy Management Plan based on the Act's 12 Information Protection Principles. Fundamental to Council's implementation of the Act is the premise that personal information is to be used only for the purpose for which it is collected.

Site Plan

Please provide sufficient details to locate tree/s. Label tree/s numerically on the plan. To assist in the identification please tie a marker to tree/s.

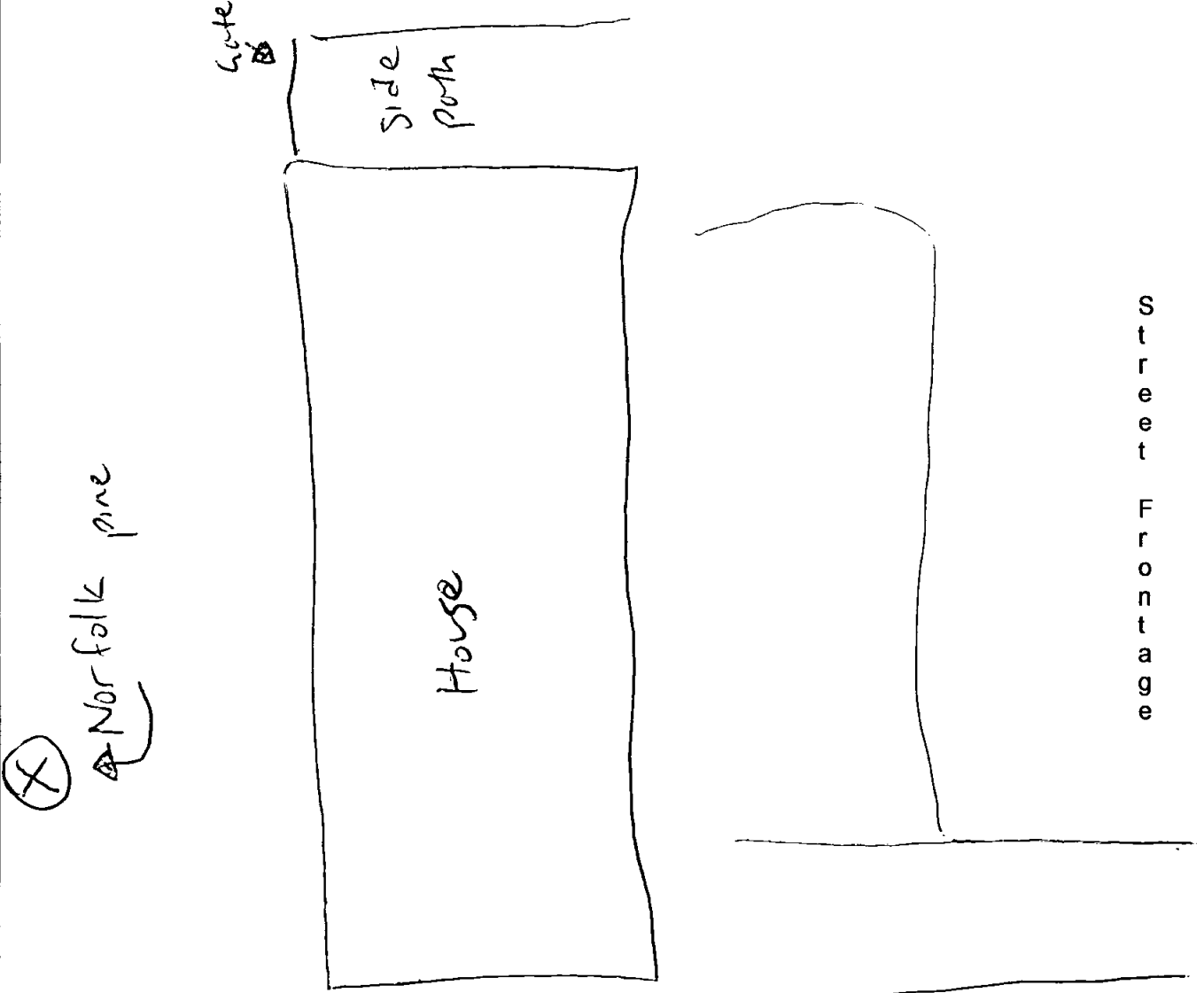

**Land on Which Tree/s are growing**

Address of Private Property: 119 Barrowby Rd, Mona Vale  
2103

Address Public Property (e.g. Reserve name or road reserve outside which property address):  
\_\_\_\_\_  
\_\_\_\_\_

Reasons for application and outline of work to be carried out. Refer to tree/s in numerical order:  
Tree has broken existing retaining wall. retaining wall has been rebuilt. and drainage put in all around our property. this drainage is vital to our property. when it rains we get all the run off water from hoses behind us, ~~the~~ down pipes aren't plumbed to storm water, just to ~~the~~ backyard and it flows into our property and under our house & back room we have taken videos of the run of water in our backyard. If needed

**Neighbours Consent**

Consent is required by the adjoining owner where tree/s to be removed are on that property or there are overhanging branches to be pruned back further than your boundary.

Signature: \_\_\_\_\_ Date: \_\_\_\_\_

Contact Phone Number: \_\_\_\_\_

**Arborist Report**

Applications for removal of significant trees will require an arborist's report by an independent qualified arborist to accompany your application. Further information can be obtained by viewing the "guidelines for arborist report" on Councils website or by contacting Council Tree Management Officers.

**Council Contact Details**

Rob Clarke  
Tree Management Officer  
Telephone: (02) 9970 1362

Andrew Thor  
Tree Management Officer  
Telephone: (02) 9970 1361

Mailing Address: P.O. Box, 882 MONA VALE NSW 1660

**Office Use Only**

Receipt No.: 336121 Date: 7/2/13

Amount Paid: \$63.00

Fees to TTRE Appointment Fee to TTRE