

Engineering Referral Response

Application Number:	DA2025/0115
Proposed Development:	Alterations and additions to a dwelling house
Date:	14/04/2025
To:	Olivia Ramage
Land to be developed (Address):	Lot 371 DP 531048 , 77 Bungan Head Road NEWPORT NSW 2106

Reasons for referral

This application seeks consent for the following:

- New Dwellings or
- Applications that require OSD where additional impervious area exceeds 50m² or
- Alterations to existing or new driveways or
- Where proposals affect or are adjacent to Council drainage infrastructure incl. watercourses and drainage channels or
- Torrens, Stratum and Community Title Subdivisions or
- All new Commercial and Industrial and RFB Development with the exception of signage or
- Works/uses in flood affected areas

And as such, Council's development engineers are required to consider the likely impacts on drainage regimes.

Officer comments

14/04/2025

Council's Development Engineer 2nd referral comments.

- The proposed retaining wall is unlikely to adversely impact Council's drainage infrastructures. Conditions have been applied to make sure no damage to Council's drainage system.

21/02/2025

Council's Development Engineer requests additional information regarding Structures Located Adjacent to Council's Drainage Infrastructures and Site Access & Parking.

This proposal is for alterations and additions to an existing dwelling.

Structures Located Adjacent to Council's Drainage Infrastructures

Council's Development Engineer requests additional information regarding Structures Located

Adjacent to Council's Drainage Infrastructures as detailed below.

- Council's drainage infrastructures adjacent to the proposed works shall be investigated by a service locator/licensed plumber on site. The location and size of Council's drainage infrastructures shall be shown on the plans to ensure the proposed works are away from Council's drainage infrastructures. Please see the below **indicative** location of Council's drainage system along the southern property boundary.

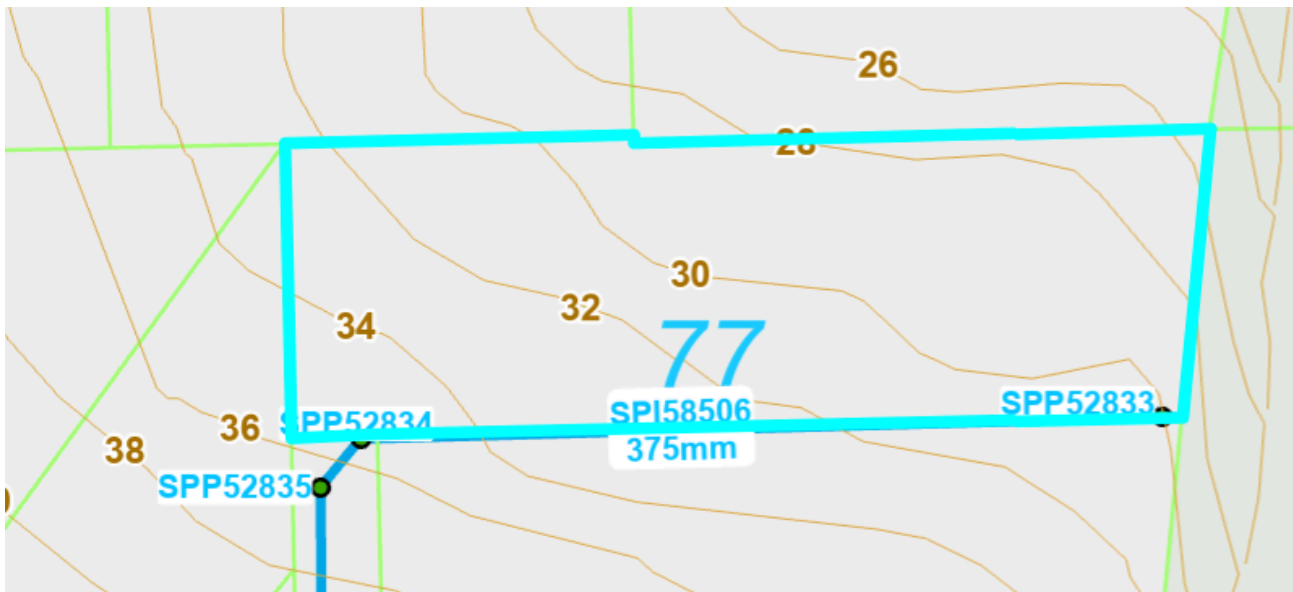

Stormwater

This proposal seeks to discharge to the existing stormwater outlet to the cliff, which is generally satisfactory. An OSD system is not required as a decrease in the existing impervious area is proposed.

Site Access and Parking

Council's Development Engineer requests additional information regarding the Site Access & Parking as detailed below.

- It shall be confirmed on the plans whether the existing garage parking slab level is to be retained in the same location but only extended for a slightly larger garage.

Geotechnical Investigation

A geotechnical report is provided with completed forms 1 and 1(a).

The proposal is therefore supported.

Note: Should you have any concerns with the referral comments above, please discuss these with the Responsible Officer.

Recommended Engineering Conditions:

FEES / CHARGES / CONTRIBUTIONS

Construction, Excavation and Associated Works Security Bond(s)

The applicant is to lodge a bond with Council for the following:

Drainage Works

As security against any damage to Council's drainage infrastructures as part of this consent a bond of \$5,000.

Details confirming payment of the bond(s) are to be submitted to the Principal Certifier prior to the issue of the Construction Certificate.

Reason: Protection of Council's infrastructure.

CONDITIONS TO BE SATISFIED PRIOR TO THE ISSUE OF THE CONSTRUCTION CERTIFICATE

Stormwater Disposal

The applicant is to demonstrate how stormwater from the new development within this consent is disposed of to an existing approved system or in accordance with Northern Beaches Council's Water Management for Development Policy. Details by an appropriately qualified and practicing Civil or Hydraulic Engineer demonstrating that the existing approved stormwater system can accommodate the post-development flows, or compliance with Council's policy are to be submitted to the Certifier for approval prior to the issue of the Construction Certificate.

Details demonstrating compliance are to be submitted to the Certifier for approval prior to the issue of the Construction Certificate.

Reason: To ensure appropriate provision for disposal of stormwater management arising from the development.

Geotechnical Report Recommendations have been Incorporated into Designs and Structural Plans

The recommendations of the risk assessment required to manage the hazards as identified in the Geotechnical Report prepared by AscentGeo, dated 26/11/2024 are to be incorporated into the construction plans. Prior to issue of the Construction Certificate, Form 2 of the Geotechnical Risk Management Policy for Pittwater (Appendix 5 of P21 DCP) is to be completed and submitted to the Accredited Certifier. Details demonstrating compliance are to be submitted to the Certifier prior to the issue of the Construction Certificate.

Reason: To ensure geotechnical risk is mitigated appropriately.

Structures Located Adjacent to Council Pipeline or Council Easement

All structures are to be located clear of any Council pipeline or easement. Footings of any structure adjacent to an easement or pipeline are to be designed in accordance with Council's Water Management Policy; (in particular Section 6 - Building Over or Adjacent to Constructed Council Drainage Systems and Easements Technical Specification). Structural details prepared by a suitably qualified Civil Engineer, who has National Engineers Register (NER) or Professionals Australia (RPENG) demonstrating compliance are to be submitted to the Certifier for approval prior to the issue of the Construction Certificate.

Reason: Protection of Council's infrastructure.

Pre-Construction Stormwater Assets Dilapidation Report

The Applicant is to submit a pre-construction / demolition Dilapidation Survey of Council's Stormwater Assets prepared by a suitably qualified person in accordance with Council's Guidelines for Preparing a Dilapidation Survey of Council Stormwater Asset, to record the existing condition of the asset prior to the commencement of works. Council's Guidelines are available at: <https://www.northernbeaches.nsw.gov.au/media/60355?1730767288>

The pre-construction / demolition Dilapidation Report must be submitted to Council for approval and the Principal Certifier prior to the issue of the Construction Certificate.

Reason: Protection of Council's infrastructure.

CONDITIONS TO BE COMPLIED WITH DURING DEMOLITION AND BUILDING WORK

Road Reserve

The applicant shall ensure the public footways and roadways adjacent to the site are maintained in a safe condition at all times during the course of the work.

Reason: Public safety.

CONDITIONS WHICH MUST BE COMPLIED WITH PRIOR TO THE ISSUE OF THE OCCUPATION CERTIFICATE

Post- Construction Stormwater Assets Dilapidation Report (Council stormwater assets)

The Applicant shall submit a post-construction Dilapidation Survey of Council's Stormwater Assets is to be prepared by a suitably qualified person in accordance with Council's Guidelines for Preparing a Dilapidation Survey of Council Stormwater Asset in order to determine if the asset has been damaged by the works. Council's Guidelines are available at: <https://www.northernbeaches.nsw.gov.au/media/60355?1730767288>

The post-construction / demolition dilapidation report must be submitted to Council for review and approval. Any damage to Council's stormwater infrastructure is to be rectified prior to the release of any Drainage security bonds. Council's acceptance of the Dilapidation Survey is to be submitted to the Principal Certifier prior to the issue of the Occupation Certificate.

Reason: Protection of Council's infrastructure.

Stormwater Disposal

The stormwater drainage works shall be certified as compliant with all relevant Australian Standards and Codes by a suitably qualified civil/hydraulic engineer. Details demonstrating compliance are to be submitted to the Principal Certifier prior to the issue of the Occupation Certificate.

Reason: To ensure appropriate provision for the disposal of stormwater arising from the development.

Certification of Structures Located Adjacent to Council Pipeline or Council Easement

The Applicant shall submit a suitably qualified Structural Engineer's certification that the completed footing works have been constructed in accordance with this consent, Northern Beaches Council's Water Management for Development Policy and the approved Construction Certificate plans. Details demonstrating compliance are to be submitted to the Principal Certifier prior to the issue of the Occupation Certificate.

Reason: Protection of Council's infrastructure

Geotechnical Certification Prior to Occupation Certificate

The Applicant is to submit the completed Form 3 of the Geotechnical Risk Management Policy (Appendix 5 of P21 DCP) to the Principal Certifier prior to issue of the Occupation Certificate.

Reason: To ensure geotechnical risk is mitigated appropriately.