

SITE CALCULATIONS			%	m2
Site Total Area by DP	-	100%		908.7
Total Landscape Area	-	45.47%		413.2
Pool	-	5.64%		51.2
Hard Landscape	-	26.07%		236.9
Existing Dwelling	-	22.82%		207.4
Landscape Area (+ 2m Dims)	-	31.40%		192.95
Pool	-	6.18%		38.0
Landscape Open Space	-	37.58%		230.95

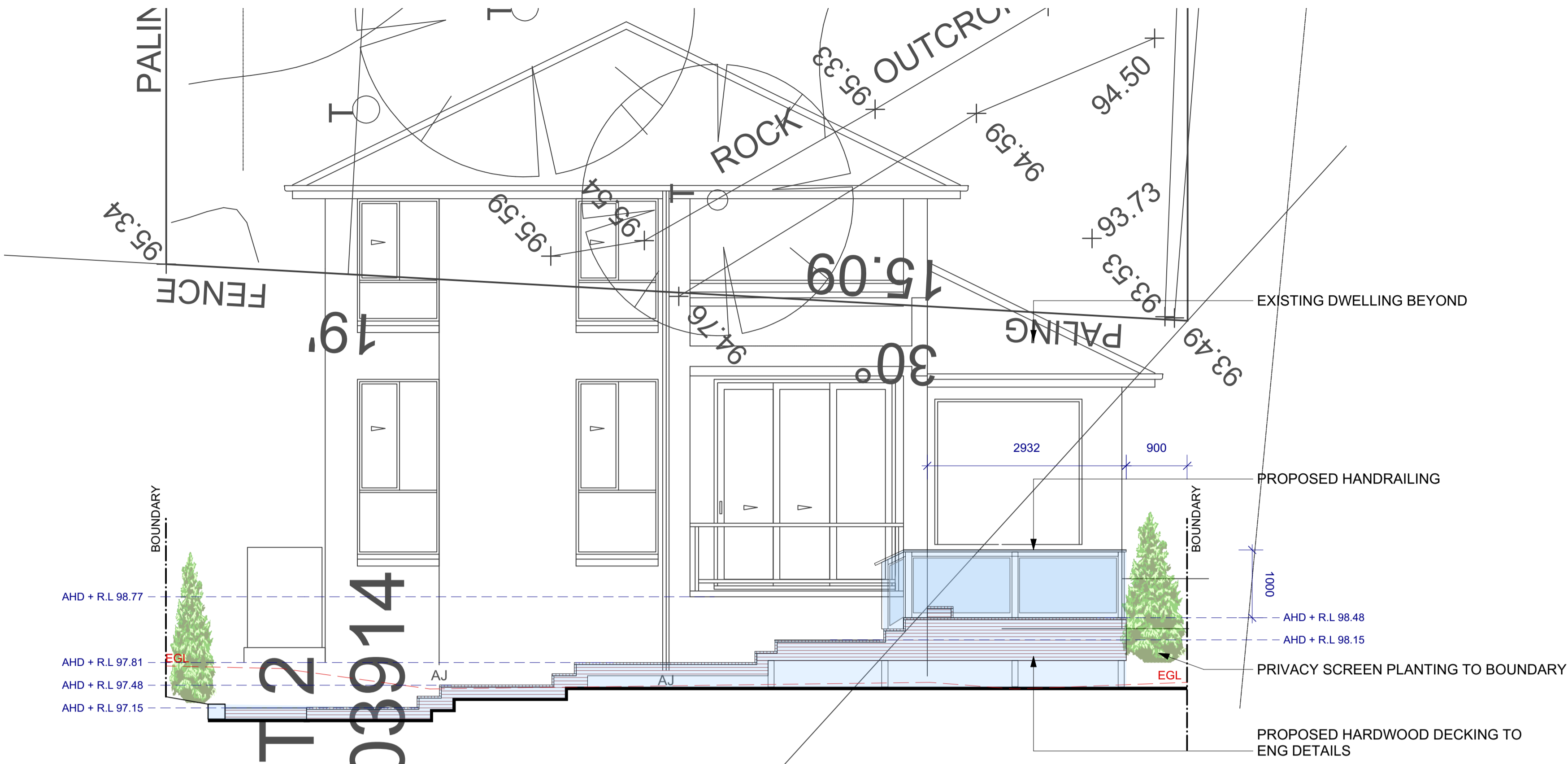

1 EAST ELEVATION A-A
Scale 1:50

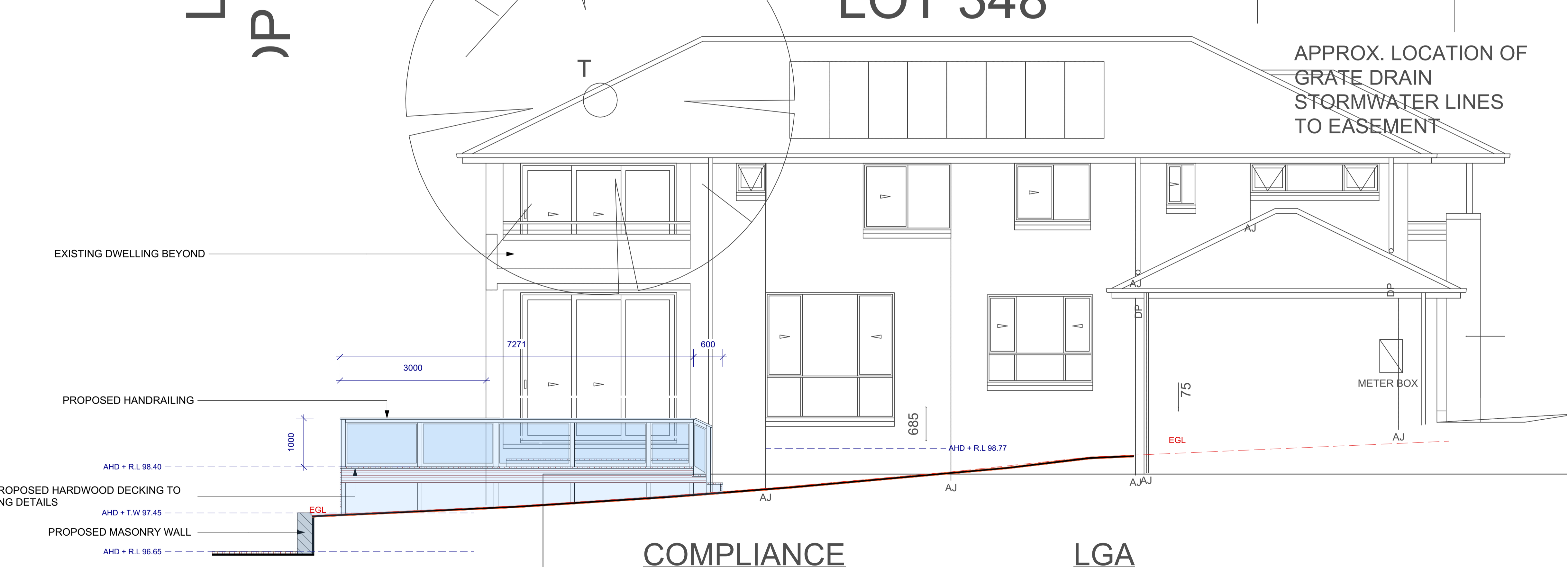

2 NORTH ELEVATION B-B
Scale: 1:50

Notes:

- All dimensions and levels shall be verified by Contractor on site prior to commencement of work.
- Do not scale from drawings.
- If in doubt contact Landscape Architect.
- This design is copyright and shall not be copied, utilised or reproduced in any way without prior written permission of Grant Clement Landscape Architect.
- This plan has been prepared for Concept purposes only.
- All Building Works shall be installed to Structural Engineers detail.

Legend:

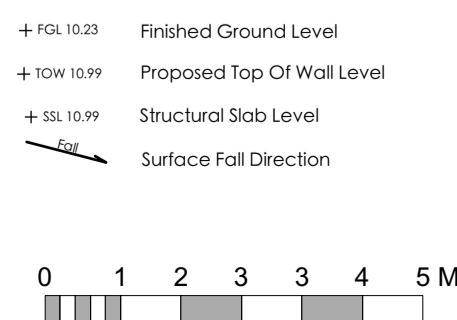

Drawing: ELEVATIONS - DECKING

Address: 17 Waterview Cres, Seaforth

Project: Fell Residence

Client: Mr & Mrs Chris & Paige Fell



Status

SCALE - 1:100 @ A1

Drawn By: GC, Dwg Date: 30.01.18, Checked By: JS, Plot Date: 20.01.18, CAD File Name: Fell DA v2018.vwx



Project No.

100

Drawing No. Rev #

DA 500 A OF 1

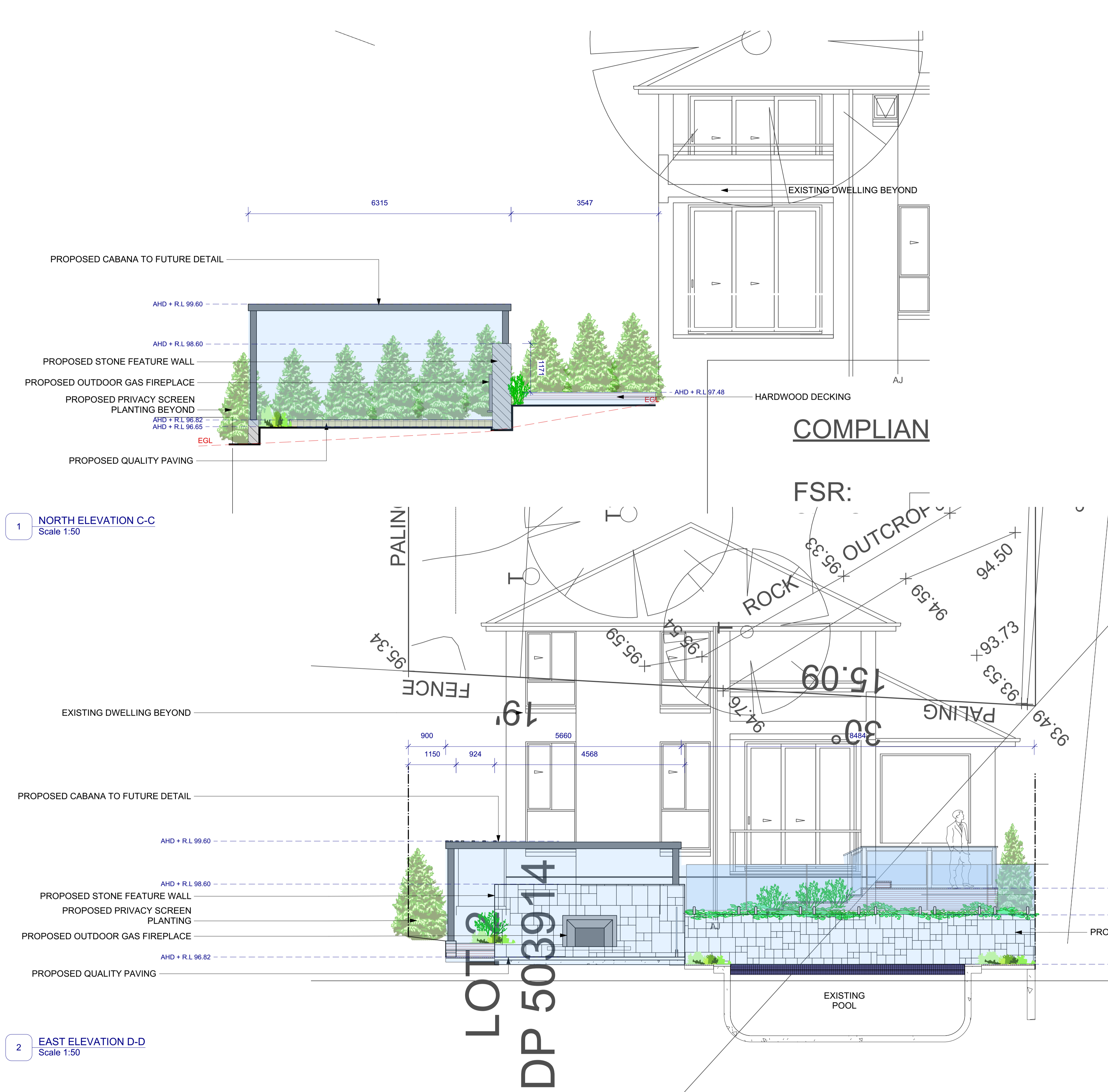

1 NORTH ELEVATION C-C
Scale 1:50

2 EAST ELEVATION D-D
Scale 1:50

Notes:

1. All dimensions and levels shall be verified by Contractor on site prior to commencement of work
2. Do not scale from drawings.
3. If in doubt contact Landscape Architect.
4. This design is copyright and shall not be copied, utilised or reproduced in any way without prior written permission of Grant Clement Landscape Architect.
5. This plan has been prepared for Concept purposes only.
6. All Building Works shall be installed to Structural Engineers detail

Legend:

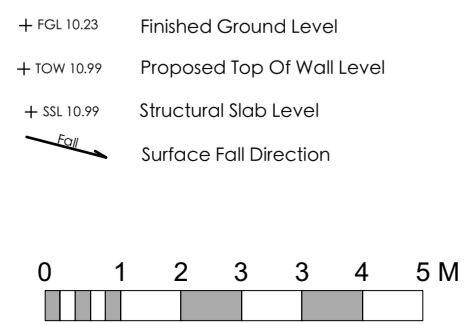
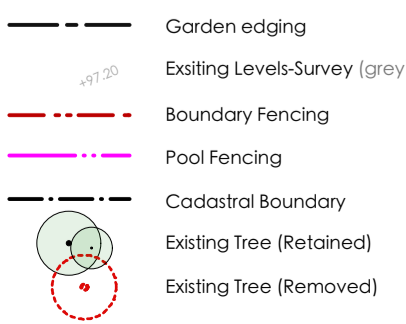
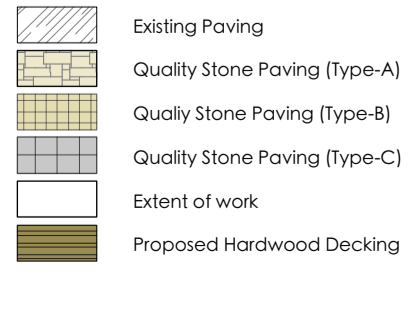

Drawing:

ELEVATIONS - CABANA

Address:

17 Waterview Cres, Seaforth

Project:

Fell Residence

Client:

Mr & Mrs Chris & Paige Fell

Status

SCALE - 1:100 @ A1

Drawn By

GC

Dwg Date

30.01.18

Checked By

JS

Plot Date

20.01.18

CAD File Name

Fell DA v2018.vwx



Project No.

100

Drawing No.

Rev #

DA 501 A

OF 1



SITE CALCULATIONS		
	%	m2
Site Total Area by DP	- 100%	908.7
Total Landscape Area	- 45.47%	413.2
Pool	- 5.64%	51.2
Hard Landscape	- 26.07%	236.9
Existing Dwelling	- 22.82%	207.4
Landscape Area (+ 2m Dims)	- 31.40%	192.95
Pool	- 6.18%	38.0
Landscape Open Space	- 37.58%	230.95



northern beaches

council

THIS PLAN IS TO BE READ IN CONJUNCTION WITH THE CONDITIONS OF DEVELOPMENT CONSENT

DA2018/1814

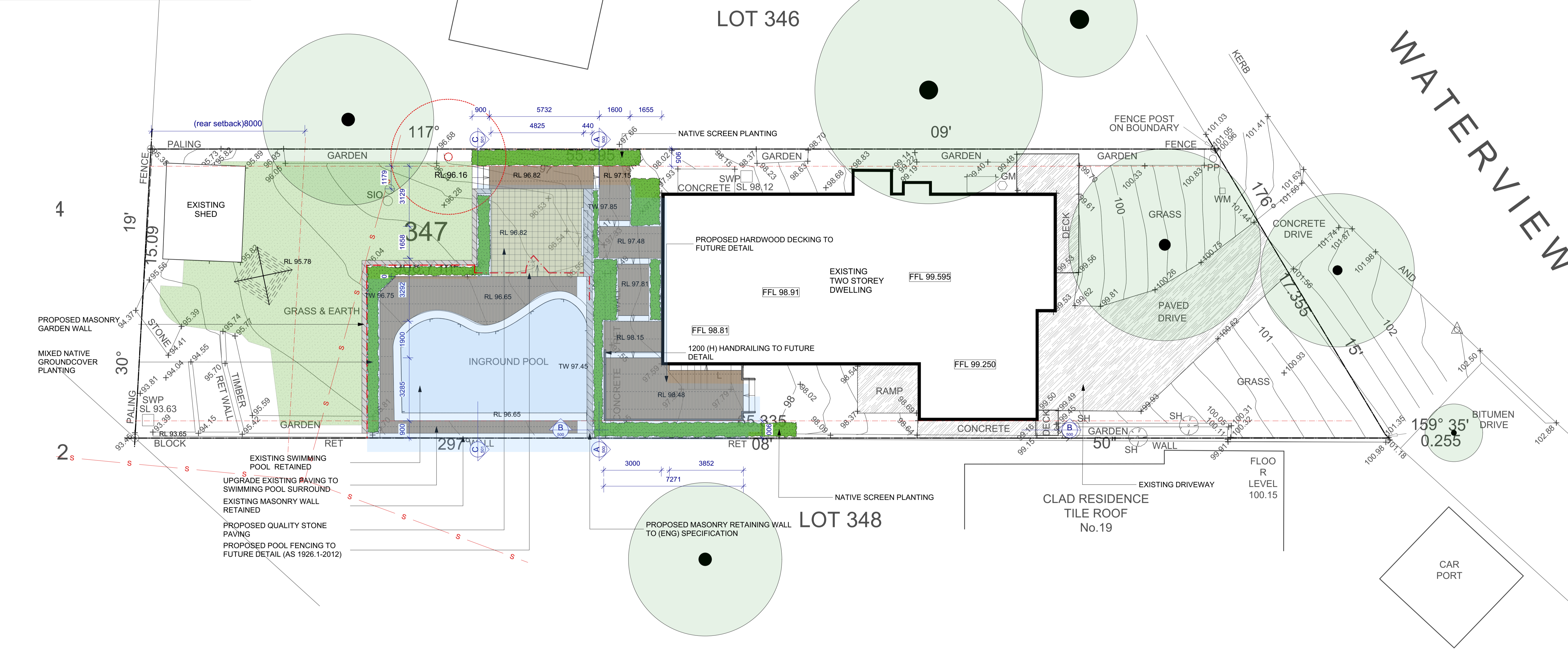

1

LANDSCAPE PLAN
Scale 1:100

2

MATERIALS SCHEDULE
NOT TO SCALE

- DESIGN NOTES:**
- All works to the Swimming Pool will be an upgrade of existing and do not form part of this development application.
 - The proposed development will be completed in accordance with the requirements of volume 2 of the national construction code series- Building code of Australia (NCCS-BCA)
 - The proposed development will be constructed as per the design and specification of a suitably qualified structural engineer.
 - Pool safety fencing to meet the requirements of the Swimming pools Act 1992. and AS 1926-2012
 - The recirculation system and skimmer box will meet the requirements of both parts 3.9.3 of (NCCS-BSA) and AS 1926.3-2010

Legend:

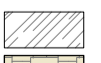
- 

Existing Paving
- 

Quality Stone Paving (Type-A)
- 

Quality Stone Paving (Type-B)
- 

Quality Stone Paving (Type-C)
- 

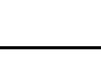
Extent of work
- 

Proposed Hardwood Decking



Proposed Masonry Wall



Proposed Timber Wall



Existing Wall (Retained)



Slot/Channel Drain



Lawn Area



Proposed Planting



Proposed Tree



Garden edging



Existing Levels-Survey (grey)



Boundary Fencing



Pool Fencing



Cadastral Boundary



Existing Tree (Retained)



Existing Tree (Removed)

0

1

2

3

4

5

M

+

101.10.03

Finished Ground Level

+

100.10.99

Proposed Top Of Wall Level

+

SL 10.99

Structural Slab Level

↑

101.10.99

Surface Fall Direction

Drawing: LANDSCAPE PLAN

Address: 17 Waterview Cres, Seaforth

Project: Fell Residence

Client: Mr & Mrs Chris & Paige Fell



Grant Clement

Landscape Architect & Pool Designers

153 McCams Creek Rd, Church Point NSW 2105

T: 0451 545 769 E: grant.clement@outlook.com

Status

SCALE - 1:100 @ A1

Drawn By	JS	Dwg Date:	30.01.18
Checked By	JS	Plot Date:	20.01.18
CAD File Name	Fell DA v2018.vwx		



Project No.

100

Drawing No. Rev #

DA 400 A



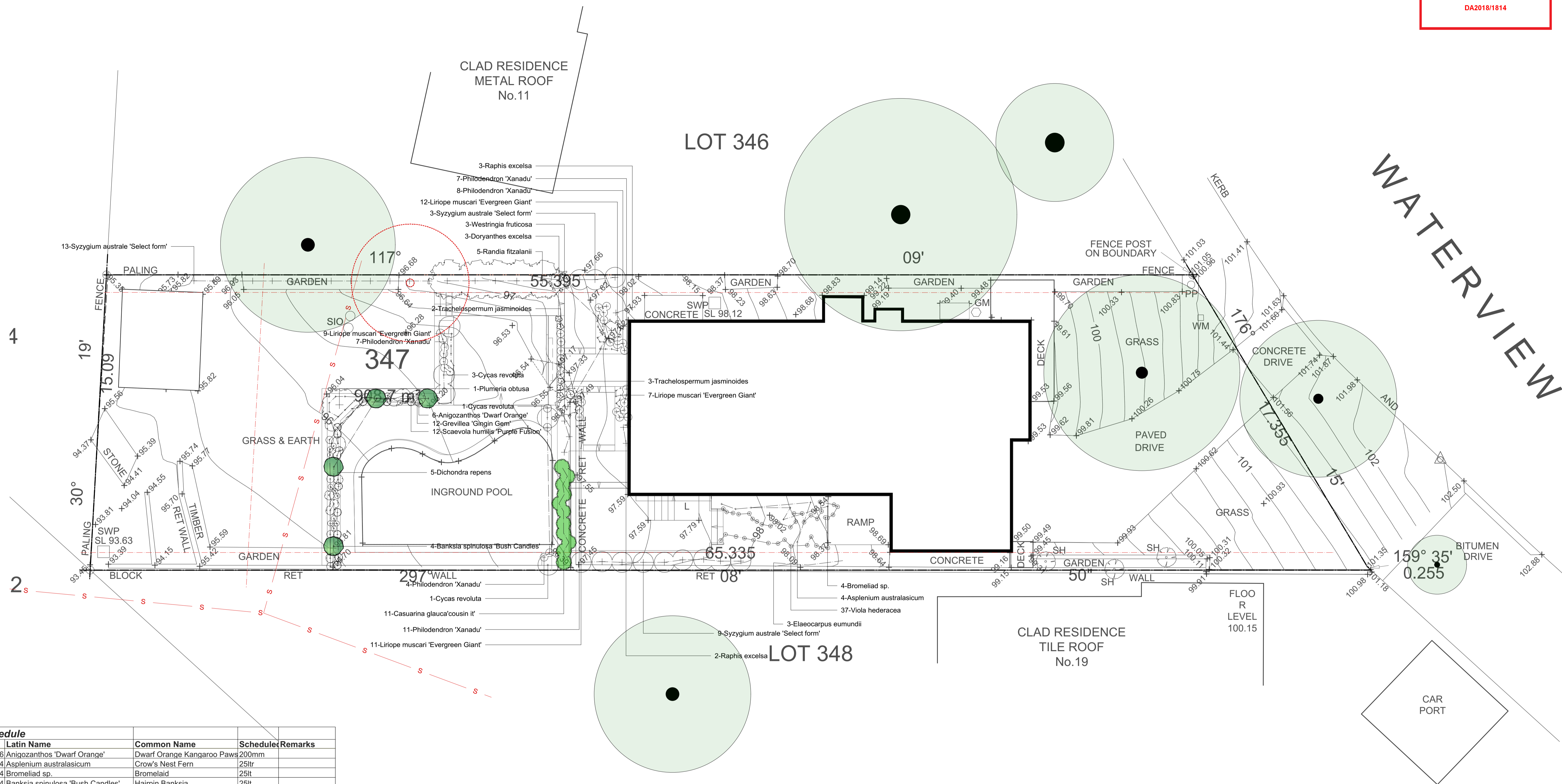





















OF 1



Plant Schedule				
ID	Qty	Latin Name	Common Name	Schedule/Remarks
Ang-org	6	Anigozanthos 'Dwarf Orange'	Dwarf Orange Kangaroo Paw	200mm
Asp-aus	4	Asplenium australasicum	Crow's Nest Fern	25ltr
Brom	4	Bromeliad sp.	Bromeliad	25ltr
BS	4	Banksia spinulosa 'Bush Candles'	Hairpin Banksia	25ltr
Cg	11	Casuarina glauca 'cousin it'	Cousin It	150mm
Cyc-rev	5	Cycas revoluta	Sago Palm	25ltr
Dor-exc	3	Doryanthes excelsa	Gymea Lily, Giant Lily	25ltr
Ela-eum	3	Elaeocarpus eumundii	Quondong	25ltr
Grevillea	12	Grevillea 'Gingin Gem'	Grevillea 'Gingin Gem'	150mm
Lir-mus	39	Liriope muscari 'Evergreen Giant'	Evergreen Giant Lilyturf	150mm
Phi-xan	37	Philodendron 'Xanadu'	Xanadu	150mm
Plu-obt	1	Plumeria obtusa	Frangipani	75 ltr
Poa-poi	14	Poa poiformis 'Kingsdale'	Coastal poa	150mm
Ran fit-1	5	Randia fitzalanii	Native gardenia	25ltr
Rha-exc	5	Raphis excelsa	Lady Palm	25ltr
Sca-hum	12	Scaevola humilis 'Purple Fusion'	Blue Fanflower	150mm
Syz-aus	25	Syzygium australe 'Select form'	Brush Cherry, Scrub Cherry	25ltr
Tra-jas	5	Trachelospermum jasminoides	Star Jasmine	200mm
Untitled	5	Dichondra repens	Kidney Weed	150mm
Uio-hed	37	Viola hederacea	Native Violet	tubestock
Wes-fru	3	Westringia fruticosa	Coastal Rosemary	200mm

			Notes: <ol style="list-style-type: none"> 1. All dimensions and levels shall be verified by Contractor on site prior to commencement of work 2. Do not scale from drawings. 3. If in doubt contact Landscape Architect. 4. This design is copyright and shall not be copied, utilised or reproduced in any way without prior written permission of Grant Client Landscape Architect. 5. This plan has been prepared for Concept purposes only. 6. All Building Works shall be installed to Structural Engineers detail 	Legend
12/9/18	DA Submission	GC		
Date	REVISION	By		

Legend:

	Existing Paving		Proposed Masonry Wall		Garden edging		+ FGL 10.23	Finished Ground Level
	Quality Stone Paving (Type-A)		Proposed Timber Wall		Existing Levels-Survey (grey)		+ TOW 10.99	Proposed Top Of Wall Level
	Quality Stone Paving (Type-B)		Existing Wall (Retained)		Boundary Fencing		+ SSL 10.99	Structural Slab Level
	Quality Stone Paving (Type-C)		Slot/Channel Drain		Pool Fencing			Surface Fall Direction
	Extent of work		Lawn Area		Cadastral Boundary			
	Proposed Hardwood Decking		Proposed Planting		Existing Tree (Retained)			
			Proposed Tree		Existing Tree (Removed)			

0 1 2 3 3 4 5 M

Drawing:	PLANTING PLAN
Address:	17 Waterview Cres, Seaforth
Project:	Fell Residence
Client:	Mr & Mrs Chris & Paige Fell



Grant Clements
Landscape Architect & Pool Designers
153 McCarrs Creek Rd, Church Point NSW 2105
T: 0451 545 769 E: grant.clements@outlook.com

Status			
SCALE - 1:100 @ A1			
Drawn By	GC	Dwg Date:	30.01.18
Checked By	JS	Plot Date:	20.01.18
CAD File Name	Fell DA v2019.vwx		

Project No.
100

Drawing No. Rev #

DA 600 A

OF 1