

A1

SEE SHEET 2

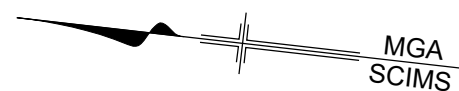

**UNDERGROUND SERVICES LEGEND**  
QUALITY LEVEL D (AS 5488.1:2019)

W POTABLE WATER MAIN  
S SEWER MAIN  
C COMMUNICATIONS CABLES  
E ELECTRICITY CABLES  
G GAS MAIN

**CAUTION: FIBRE OPTIC CABLES ARE PRESENT IN THIS AREA**

APPROXIMATE POSITION ONLY VIDE 'DIAL-BEFORE-YOU-DIG' PLANS JOB No. 20702823 SEARCH DATE 30/11/2020. WHERE CRITICAL TO DESIGN UNDERGROUND SERVICES SHOULD BE LOCATED BY MORE ACCURATE METHODS.

**SERVICES NOTES:-**

1. ONLY THOSE SERVICES VISIBLE AT THE TIME OF SURVEY HAVE BEEN LOCATED AND IF SHOWN AS 'DIAL-BEFORE-YOU-DIG' ARE QUALITY LEVEL A AS DEFINED BY AS 5488.1:2019. LEVELS SHOWN ARE SURFACE LEVELS UNLESS NOTED OTHERWISE.

2. UNDERGROUND SERVICES HAVE BEEN PLOTTED FROM 'DIAL-BEFORE-YOU-DIG' PLANS. ARE QUALITY LEVEL D AS DEFINED BY AS 5488.1:2019 AND ARE ONLY CURRENT FOR 3 MONTHS FROM THE SEARCH DATE NOTED ABOVE. ALL RELEVANT AUTHORITIES MUST BE CONTACTED TO DETERMINE THE FULL EXTENT OF SERVICES PRIOR TO ANY PLANNING OR WORKS NEAR THE SITE.

GENERAL NOTES

ONLY TREES GREATER THAN 3.5 METRES IN HEIGHT ARE SHOWN ON THIS PLAN AND THEIR POSITIONS ARE DIAGRAMMATIC ONLY AND MAY REQUIRE ADDITIONAL SURVEY WHERE CRITICAL TO DESIGN.

CONTOURS ARE INDICATIVE AT GROUND FORM ONLY. SPOT LEVELS ONLY SHOULD BE USED FOR CALCULATIONS OF QUANTITIES WITH CAUTION.

LEVELS ARE ON AUSTRALIAN HEIGHT DATUM (AHD).

ALL SETOUT LEVELS MUST BE REFERRED TO THE BENCH MARK SHOWN ON THIS PLAN.

BOUNDARY NOTES

A BASIC BOUNDARY SURVEY HAS BEEN DONE SUITABLE FOR DA LODGEMENT PURPOSES.

BOUNDARIES HAVE NOT BEEN MARKED.

SURVEY INFORMATION NOTES

THE ORIGIN OF COORDINATES COMES FROM PM60581 E:342874.783 N:626586.554 CLASS B POSITIONAL UNCERTAINTY (PU) N/A (MGA2020) ADOPTED FROM SCIMS DATED 25/01/2021.

THE ORIGIN OF LEVELS COMES FROM PM60581 RL1.823 CLASS LC POSITIONAL UNCERTAINTY (PU) 0.09 ADOPTED FROM SCIMS DATED 25/01/2021.

THE ORIENTATION OF THIS PLAN IS MGA NORTH WHICH HAS BEEN DETERMINED BY A COORDINATE JOIN BETWEEN PM60581 AND PM3979.

CERTIFICATE OF TITLE NOTES

THE FOLLOWING INFORMATION RELATES TO THE RESPECTIVE CERTIFICATE OF TITLE OF EACH LOT:

- LOT 2 IN DP314645  
(CT EDITION 12 DATED 21/10/2020 SEARCH DATE 01/02/2021)  
- AFFECTED BY:  
- COVENANT (A632510)  
- BENEFITED BY BY:  
- NIL
- LOT 3 SECTION 1 IN DP6777  
(CT EDITION 20 DATED 18/09/2019 SEARCH DATE 01/02/2021)  
- AFFECTED BY:  
- NIL  
- BENEFITED BY BY:  
- NIL
- LOT 4 SECTION 1 IN DP6777  
(CT EDITION 20 DATED 18/09/2019 SEARCH DATE 01/02/2021)  
- AFFECTED BY:  
- COVENANT (A893607)  
- BENEFITED BY BY:  
- NIL

COVENANTS, RESTRICTIONS AND LEASES NOTED ON THE TITLE HAVE NOT BEEN INVESTIGATED. THESE SHOULD BE INVESTIGATED PRIOR TO DESIGN TO ENSURE ANY FUTURE DEVELOPMENT COMPLES.

SERVICES NOTES

ONLY THOSE SERVICES VISIBLE AT THE TIME OF SURVEY HAVE BEEN LOCATED AND ARE QUALITY LEVEL A AS DEFINED BY AS 5488.1:2019.

UNDERGROUND SERVICES HAVE BEEN PLOTTED FROM 'DIAL-BEFORE-YOU-DIG' PLANS. ARE QUALITY LEVEL D AS DEFINED BY AS 5488.1:2019 AND ARE ONLY CURRENT AT THE DATE OF SEARCH.

ALL RELEVANT AUTHORITIES MUST BE CONTACTED TO DETERMINE THE FULL EXTENT OF SERVICES PRIOR TO ANY PLANNING OR WORKS NEAR THE SITE.

LEGEND

- VC denotes VEHICLE CROSSING  
B denotes BOLLARD  
TK denotes TOP OF KERB  
GUT denotes KERB GUTTER  
LIP denotes LINE  
COM denotes COMMUNICATIONS PIT  
GAS denotes GAS MARKER/LID  
PP denotes POWER POLE  
HYD denotes HYDRANT  
SV denotes STOP VALVE  
SMH denotes SEWER MANHOLE  
SIP denotes SEWER INSPECTION PIT  
FL denotes FLOOR LEVEL  
TW denotes TOP OF WALL  
BW denotes BOTTOM OF WALL  
D:S:H denotes DIAMETER, SPREAD and HEIGHT of TREE

© COPYRIGHT

THIS PLAN IS NOT TO BE USED FOR ANY PURPOSE OTHER THAN ITS ORIGINAL INTENTION AND REMAINS THE PROPERTY OF SDG. THIS PLAN CANNOT BE REPRODUCED, COPIED OR DIGITALLY TRANSFERRED (IN WHOLE OR PART) WITHOUT PRIOR WRITTEN PERMISSION OF SDG.

PROJECT:

DETAIL AND LEVEL SURVEY OF  
LOTS 3 & 4 SEC 1 DP6777 & LOT 2 DP314645

1010-1014 PITTWATER ROAD  
COLLAROY

CLIENT: COLLAROY PROJECTS PTY LTD

FILE: 8351 1010-1014 Pittwater Rd, Collaroy - Detail Rev C

LGA: NORTHERN BEACHES

REF: 8351	CONTOURS: 0.5m
ISSUE: C	DATUM: AHD
SURVEY DATE: 10/04/2024	AZIMUTH: MGA2020
SCALE: 1:150	SHEET 1 OF 2 SHEETS



SDG Pty Ltd  
abn 85 213 523 621  
Suite 1, 3 Railway Street, Baulkham Hills NSW 2153  
t: (02) 9630 7955 w: sdg.net.au  
Liability limited by a scheme approved under Professional Standards Legislation

I certify that the boundaries shown have been surveyed and that title dimensions are available across all street frontages

*M. Plooman*  
MATT PLOWMAN  
Land Surveyor Registered under  
The Surveying and Spatial  
Information Act 2002  
Date: 12/09/2023 8351

PITTWATER

ROAD

ISSUE	DATE	AMENDMENT	SURV	CHK
A	21/01/21	ORIGINAL ISSUE	PB	MP
B	12/09/23	UPDATE ADDING INFORMATION & BOUNDARY CERT.	MP	MP
C	10/04/24	ADDITIONAL SURVEY ALONG OCEAN GROVE & No.24 RL's	BE	MP



*M. Plooman*  
MATTHEW PLOWMAN ID: SU005915  
REGISTERED LAND SURVEYOR



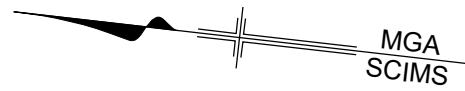

**WARNING**

- THIS SURVEY HAS ADOPTED MGA 2020 COORDINATES WHICH ARE BASED ON THE NEW GDA2020 DATUM.  
- THESE MGA2020 EASTING AND NORTHING COORDINATES ARE APPROXIMATELY 1.8 METRES DIFFERENT TO THE MGA94 COORDINATES BASED ON THE GDA94 DATUM.  
- GDA2020 IS A STATIC DATUM - JUST LIKE GDA94 - THE COORDINATES OF FEATURES DO NOT CHANGE WITH TIME.  
- FROM 2022 MGA94 COORDINATES WILL NO LONGER BE AVAILABLE.  
- HEIGHTS SHOWN ON THIS PLAN ARE STILL RELATED TO THE AUSTRALIAN HEIGHT DATUM (AHD71).

**UNDERGROUND SERVICES LEGEND**  
QUALITY LEVEL D (AS 5488.1:2019)

W POTABLE WATER MAIN  
S SEWER MAIN  
C COMMUNICATIONS CABLES  
E ELECTRICITY CABLES  
G GAS MAIN

CAUTION: FIBRE OPTIC CABLES ARE PRESENT IN THIS AREA

APPROXIMATE POSITION ONLY VIDE 'DIAL-BEFORE-YOU-DIG' PLANS JOB No. 20702623 SEARCH DATE 30/11/2020. WHERE CRITICAL TO DESIGN, UNDERGROUND SERVICES SHOULD BE LOCATED BY MORE ACCURATE METHODS.

**SERVICES NOTES:-**

- ONLY THOSE SERVICES VISIBLE AT THE TIME OF SURVEY HAVE BEEN LOCATED AND IF SHOWN AS "B" ARE QUALITY LEVEL A AS DEFINED BY AS 5488.1:2019. LEVELS SHOWN ARE SURFACE LEVELS UNLESS NOTED OTHERWISE.
- UNDERGROUND SERVICES HAVE BEEN PLOTTED FROM 'DIAL-BEFORE-YOU-DIG' PLANS. ARE QUALITY LEVEL D AS DEFINED BY AS 5488.1:2019 AND ARE ONLY CURRENT FOR 3 MONTHS FROM THE SEARCH DATE NOTED ABOVE. ALL RELEVANT AUTHORITIES MUST BE CONTACTED TO DETERMINE THE FULL EXTENT OF SERVICES PRIOR TO ANY PLANNING OR WORKS NEAR THE SITE.

**GENERAL NOTES**

ONLY TREES GREATER THAN 3.5 METRES IN HEIGHT ARE SHOWN ON THIS PLAN AND THEIR POSITIONS ARE DIAGRAMMATIC ONLY AND MAY REQUIRE ADDITIONAL SURVEY WHERE CRITICAL TO DESIGN.

CONTOURS ARE INDICATIVE AT GROUND FORM ONLY. SPOT LEVELS ONLY SHOULD BE USED FOR CALCULATIONS OF QUANTITIES WITH CAUTION.

LEVELS ARE ON AUSTRALIAN HEIGHT DATUM (AHD).

ALL SETOUT LEVELS MUST BE REFERRED TO THE BENCH MARK SHOWN ON THIS PLAN.

**BOUNDARY NOTES**

A BASIC BOUNDARY SURVEY HAS BEEN DONE SUITABLE FOR DA LODGEMENT PURPOSES.

BOUNDARIES HAVE NOT BEEN MARKED.

**SURVEY INFORMATION NOTES**

THE ORIGIN OF COORDINATES COMES FROM PM60581 E 342874.783 N 626586.554 CLASS B POSITIONAL UNCERTAINTY (PU) N/A (MGA2020) ADOPTED FROM SCIMS DATED 25/01/2021.

THE ORIGIN OF LEVELS COMES FROM PM60581 RL1.823 CLASS LC POSITIONAL UNCERTAINTY (PU) 0.09 ADOPTED FROM SCIMS DATED 25/01/2021.

THE ORIENTATION OF THIS PLAN IS MGA NORTH WHICH HAS BEEN DETERMINED BY A COORDINATE JOIN BETWEEN PM60581 AND PM3979.

**CERTIFICATE OF TITLE NOTES**

THE FOLLOWING INFORMATION RELATES TO THE RESPECTIVE CERTIFICATE OF TITLE OF EACH LOT:

- LOT 2 IN DP314645  
(CT EDITION 12 DATED 21/10/2020 SEARCH DATE 01/02/2021)
  - AFFECTED BY:
    - COVENANT (A632510)
    - BENEFITED BY BY:
      - NIL
- LOT 3 SECTION 1 IN DP6777  
(CT EDITION 20 DATED 18/09/2019 SEARCH DATE 01/02/2021)
  - AFFECTED BY:
    - NIL
  - BENEFITED BY BY:
    - NIL
- LOT 4 SECTION 1 IN DP6777  
(CT EDITION 20 DATED 18/09/2019 SEARCH DATE 01/02/2021)
  - AFFECTED BY:
    - COVENANT (A893607)
  - BENEFITED BY BY:
    - NIL

COVENANTS, RESTRICTIONS AND LEASES NOTED ON THE TITLE HAVE NOT BEEN INVESTIGATED. THESE SHOULD BE INVESTIGATED PRIOR TO DESIGN TO ENSURE ANY FUTURE DEVELOPMENT COMPLIES.

**SERVICES NOTES**

ONLY THOSE SERVICES VISIBLE AT THE TIME OF SURVEY HAVE BEEN LOCATED AND ARE QUALITY LEVEL A AS DEFINED BY AS 5488.1:2019.

UNDERGROUND SERVICES HAVE BEEN PLOTTED FROM 'DIAL-BEFORE-YOU-DIG' PLANS. ARE QUALITY LEVEL D AS DEFINED BY AS 5488.1:2019 AND ARE ONLY CURRENT AT THE DATE OF SEARCH.

ALL RELEVANT AUTHORITIES MUST BE CONTACTED TO DETERMINE THE FULL EXTENT OF SERVICES PRIOR TO ANY PLANNING OR WORKS NEAR THE SITE.

**LEGEND**

VC denotes VEHICLE CROSSING  
B denotes BOLLARD  
TK denotes TOP OF KERB  
GUT denotes KERB GUTTER  
LIP denotes LIP LINE  
COM denotes COMMUNICATIONS PIT  
GAS denotes GAS MARKER/LID  
PP denotes POWER POLE  
HYD denotes HYDRANT  
SV denotes STOP VALVE  
SMH denotes SEWER MANHOLE  
SIP denotes SEWER INSPECTION PIT  
FL denotes FLOOR LEVEL  
TW denotes TOP OF WALL  
BW denotes BOTTOM OF WALL  
D/S/H denotes DIAMETER, SPREAD AND HEIGHT OF TREE

**© COPYRIGHT**

THIS PLAN IS NOT TO BE USED FOR ANY PURPOSE OTHER THAN ITS ORIGINAL INTENTION AND REMAINS THE PROPERTY OF SDG. THIS PLAN CANNOT BE REPRODUCED, COPIED OR DIGITALLY TRANSFERRED (IN WHOLE OR PART) WITHOUT PRIOR WRITTEN PERMISSION OF SDG.

**PROJECT:**

DETAIL AND LEVEL SURVEY OF  
LOTS 3 & 4 SEC 1 DP6777 & LOT 2 DP314645

1010-1014 PITTWATER ROAD  
COLLAROY

CLIENT: COLLAROY PROJECTS PTY LTD

FILE: 8351 1010-1014 Pittwater Rd, Collaroy - Detail Rev C

LGA: NORTHERN BEACHES

REF: 8351	CONTOURS: 0.5m
ISSUE: C	DATUM: AHD
SURVEY DATE: 10/04/2024	AZIMUTH: MGA2020
SCALE: 1:150	SHEET 2 OF 2 SHEETS



SDG Pty Ltd  
abn 85 213 523 621  
Suite 1, 3 Railway Street, Baulkham Hills NSW 2153  
t: (02) 9630 7955 w: sdg.net.au  
Liability limited by a scheme approved under Professional Standards Legislation

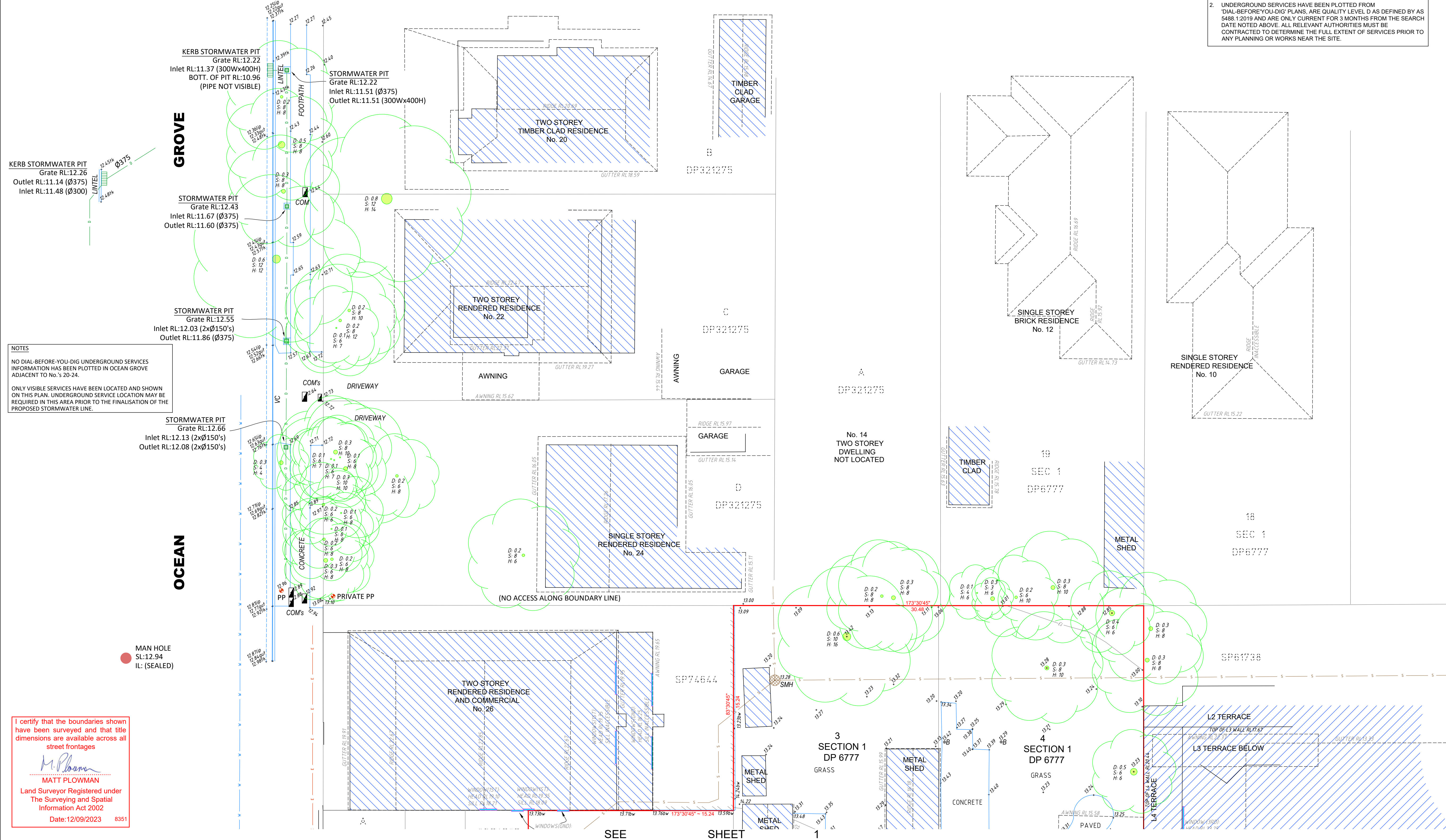

**NOTES**  
NO DIAL-BEFORE-YOU-DIG UNDERGROUND SERVICES INFORMATION HAS BEEN PLOTTED IN OCEAN GROVE ADJACENT TO No.'s 20-24.  
ONLY VISIBLE SERVICES HAVE BEEN LOCATED AND SHOWN ON THIS PLAN. UNDERGROUND SERVICE LOCATION MAY BE REQUIRED IN THIS AREA PRIOR TO THE FINALISATION OF THE PROPOSED STORMWATER LINE.

I certify that the boundaries shown have been surveyed and that title dimensions are available across all street frontages  
  
MATT PLOVMAN  
Land Surveyor Registered under The Surveying and Spatial Information Act 2002  
Date: 12/09/2023 8351

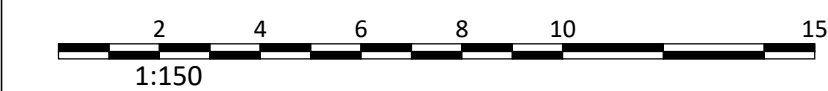

ISSUE	DATE	AMENDMENT	SURV	CHK
A	21/01/21	ORIGINAL ISSUE	PB	MP
B	12/09/23	UPDATE ADJOINING INFORMATION & BOUNDARY CERT.	MP	MP
C	10/04/24	ADDITIONAL SURVEY ALONG OCEAN GROVE & No.24 RL's	BE	MP



MATTHEW PLOVMAN ID: SU005915  
REGISTERED LAND SURVEYOR