

- ACCREDITED CERTIFIERS
- PRINCIPAL CERTIFYING AUTHORITY
- CONSTRUCTION CERTIFICATES
- FIRE SAFETY/BUILDING CONSULTANTS

NSW BUILDING
APPROVALS

23 August 2011

Pittwater Council
PO Box 882
MONA VALE NSW 1660

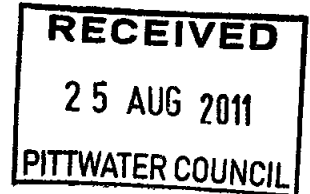

The General Manager
Attention Planning Department

Dear Sir/Madam

Re N0452/08/S96/2 & CC50P09 2 5 Bilgola Terrace, BILGOLA

Please find attached a copy of the Construction Certificate for the proposed development that has been granted by the Accredited Certifier, Mr Patrick Doherty

The CC relates to provision for modification of Development Consent NO452/08/S96/2 for alterations and additions to the existing dwelling – **minor decking increase to front of property**

Together with CC, we have enclosed the following for Council's record

- 1 Construction Certificate Form
- 2 Other documents relied upon

In accordance with Council's policy we have attached a cheque for the registration of this certificate. In forwarding the receipt for this cheque it is requested that reference be made to the address of the premises

If you have any queries regarding the above please do not hesitate to contact the undersigned on 9566 4952 / 0424 699 924 during business hours

Yours faithfully,

A handwritten signature in black ink, appearing to be "Patrick Doherty".

Patrick Doherty
NSW Building Approvals
cc
Mr and Mrs Mitchell
5 Bilgola Terrace
BILGOLA NSW 2107

836 REC: 307130 25/8/11

SUITE 15/2-12 GLEBE POINT ROAD MOBILE 0424 699 924
GLEBE PHONE (02) 9566 4952
NSW 2037 FAX (02) 9518 6310
WWW.NSWBUILDING.COM.AU EMAIL pd@nswbuilding.com.au

- ACCREDITED CERTIFIERS
- PRINCIPAL CERTIFYING AUTHORITY
- CONSTRUCTION CERTIFICATES
- FIRE SAFETY/BUILDING CONSULTANTS



Construction Certificate

Issued under the Environmental Planning and Assessment Act 1979

Certificate No 50P09 2

Applicant Mark and Katrina Mitchell

Owner K Mitchell and M Mitchell

Subject land 5 Bilgola Terrace BILGOLA Lot 8, DP 822263

Proposal Modification of Development Consent
No452/08/S96/2 for Alterations and additions to the existing dwelling, *minor decking increase to front of property*

BCA Classification Class 1a
Cost of building works \$NIL increase
Builder Colmer Constructions Pty Ltd, Li No U 148830C

DA No N0452/08/s96/2
Determination Date 29 November 2010
Consent Authority Pittwater Council

Date of receipt of CC application 11 March 2011
Determination Approved
Date of Determination 23 August 2011

Approved plans ARCHITECTURAL

- Plans prepared by Nick Karahalios Job No 081356-4 081356-5 081356-6 and dated October 2010
- Statement prepared by Colmer Constructions Pty Ltd principal contractors and dated 14 July 2011

Construction Certificate Attachments

Attachments Approved plans
 Specifications (SOUTHspec)

Accredited Certifier Patrick Doherty
Accreditation Level & No Grade A1 – BPB0094
Accreditation Body Building Professionals Board

I certify that

- the work if completed in accordance with documentation accompanying the application for the certificate (with such modifications verified by the certifying authority as may be shown on that documentation) will comply with the requirements of *Environmental Planning & Assessment (EP&A) Regulation 2000* as are referred to in sec 81A (5) of the *EP&A Act 1979*

Signed 
Patrick Doherty
Accredited Certifier

Date 23 August 2011



- ACCREDITED CERTIFIERS
- PRINCIPAL CERTIFYING AUTHORITY
- CONSTRUCTION CERTIFICATES
- FIRE SAFETY/BUILDING CONSULTANTS

NSW BUILDING
APPROVALS

Construction Certificate Application

Under Section 109C (1) (b), 81A (2) and 81A (4) of the Environmental Planning and Assessment Act 1979

1 Details of the applicant

Mr Ms Mrs Other

First name	Family name	Company/ Organisation	
Mark / Katrina	Mitchell		
Flat/street no	Street name		
5	Bilgola Terrace		
Suburb or town	State	Postcode	
BILGOLA	NSW	2107	
Daytime telephone	Fax	Mobile	
9973 1851	9907 1844	0412 259 121	
Email			
mark@urgetfootwear.com.au			

2 Identify the land

Level / Flat no	Street no & Street name		
	5 Bilgola Terrace		
Suburb or town	State		Postcode
BILGOLA			2107
Lot no	DP/ MPS no	Section	
8	822263		
Building Name		Volume/ folio	

3 Estimated cost of the development

\$ *NIL increase* *including GST*

4 Describe the development

What type of work do you propose to carry out?

Building work

Subdivision work

Describe the work

Modification of Development Consent NO452/08/S96/2 for Alterations and additions to the existing dwelling house, minor decking increase to front of property

Building Code of Australia Classification

1a

Certificate Application Form

5 Development Consent

Development Consent Number
452/08/S96/2

Date Consent Determined
29 November 2010

Consent Authority (Local Government)
Pittwater Council

6 Signatures

Applicant's Signature

Signature

[Handwritten Signature]

Date

9/3/11

Owners' Consent

- Every owner of the land must sign this application
- If the owner is a company, this form must be signed by an authorised director of the company
- If the property is a unit under strata title, or a lot in a community title, this form must be signed by the chairperson or the secretary of the Body Corporate or the appointed managing agent
- If you are signing on the owner's behalf as the owner's legal representative, you must state the nature of your legal authority and attach documentary evidence (e.g. power of attorney, executor, trustee, company director, etc)

As the owner(s) of the above property, I/we consent to this application. I also consent for NSW Building Approvals staff to enter the land to carry out inspections relating to this application.

Owners Signature

Signature

[Handwritten Signature]

Name Of Person and/ or Company Name & Address

Mark Mitchell
5 Bilgola Terrace Bilgola

Date

9/3/11

Owners Signature

Signature

[Handwritten Signature]

Name Of Person and/ or Company Name & Address

Katrina Mitchell
5 Bilgola Terrace, Bilgola

Date

9/3/11

7 Details of the principal contractor/builder

Builder's name

COLMER CONSTRUCTIONS

Builder's licence number

1488306

Flat/street no

189

Street name

HUDSON PARADES

Suburb or town

TAYLORS POINT

State

NSW

Postcode

2107

Daytime telephone

0415 464264

Fax

Mobile

0415 464264

OFFICE USE ONLY date received

11/03/2011

SUITE 15/2 12 GLEBE POINT ROAD
GLEBE
NSW 2037
WWW.NSWBUILDING.COM.AU

MOBILE 0424 699 924
PHONE (02) 9566 4952
FAX (02) 9518 6310
EMAIL pd@nswbuilding.com.au

Architectural builders, renovators, design and consultation

Colmer Constructions Pty Ltd

abn 99 065 423 958

Thursday, July 14, 2011

To Whom it may concern

Certification by us for the items as required by P Doherty

**Re 5 Bilgola Terrace
Bilgola NSW 2107**

Item 1

Bush fire Compliance

This is to certify that the construction work completed to the amended terrace area is in accordance with AS 3959-1999 level 1 construction of buildings in a bushfire prone

Item 2

The colours and materials used match the existing

 DETAILS NOTED

Yours sincerely



Michael Colmer
Colmer Constructions P/L



PITTWATER COUNCIL

ABN61340837871
Telephone 02 9970 1111
Facsimile 02 9970 7150
Postal Address
PO Box 882
Mona Vale NSW 1660
DX 9018 Mona Vale

Business Hours
8 00am to 6 00pm, Monday to Thursday
8 00am to 5 00pm, Friday

S96 No N0452/08/S96/2

29 November 2010

MARK & KATRINA MITCHELL
5 BILGOLA TERRACE
BILGOLA NSW 2107

Dear Sir/Madam

N0452/08/S96/2 Modification of Development Consent N0452/08 for Alterations and additions to the existing dwelling house at 5 BILGOLA TERRACE BILGOLA NSW 2107

Your request for modification has been considered by Council and it has been agreed to modify the Consent

Please find attached the consent as modified

If there are any matters that require further clarification, please do not hesitate to contact me

Yours faithfully

Ellie Robertson
PLANNER

 **DETAILS NOTED**

Email pittwater_council@pittwater.nsw.gov.au Web pittwater.nsw.gov.au

Mona Vale Customer Service Centre
Village Park 1 Park Street Mona Vale

Avalon Customer Service Centre
59A Old Barrenjoey Road Avalon

Support Services
Units 11 12 13 + 16/5 Vuko Place Warriewood

Boondah Depot
1 Boondah Road Warriewood

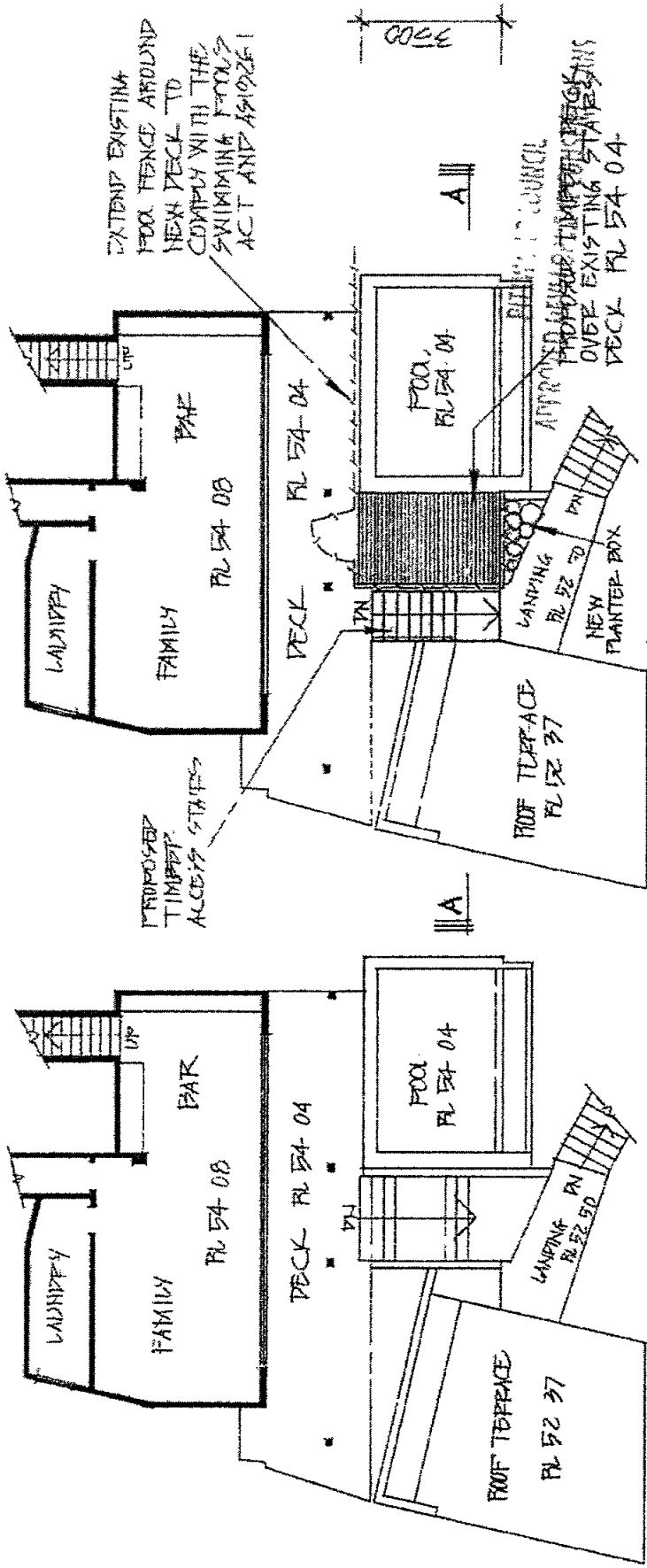

EXISTING PLAN LEVEL - 1
 NSW
 PH 0424 699 924
 SCALE 1:100

PROPOSED PLAN LEVEL - 1
 NSW
 PH 0424 699 924
 SCALE 1:100

The builder must construct the building in accordance with the Building Codes of Australia and the Development Consent conditions
CONSTRUCTION CERTIFICATE

AMENDMENTS	PROPOSED DECK AND ACCESS STAIRS
LOCATION	5 BILGOLA TERRACE, BILGOLA
DATE	OCTOBER 2010
PREPARED BY	NICK K.
DATE	08/10/10
PROJECT NO.	081356-4

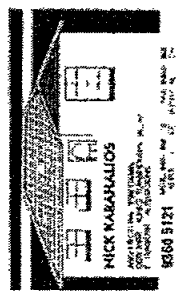

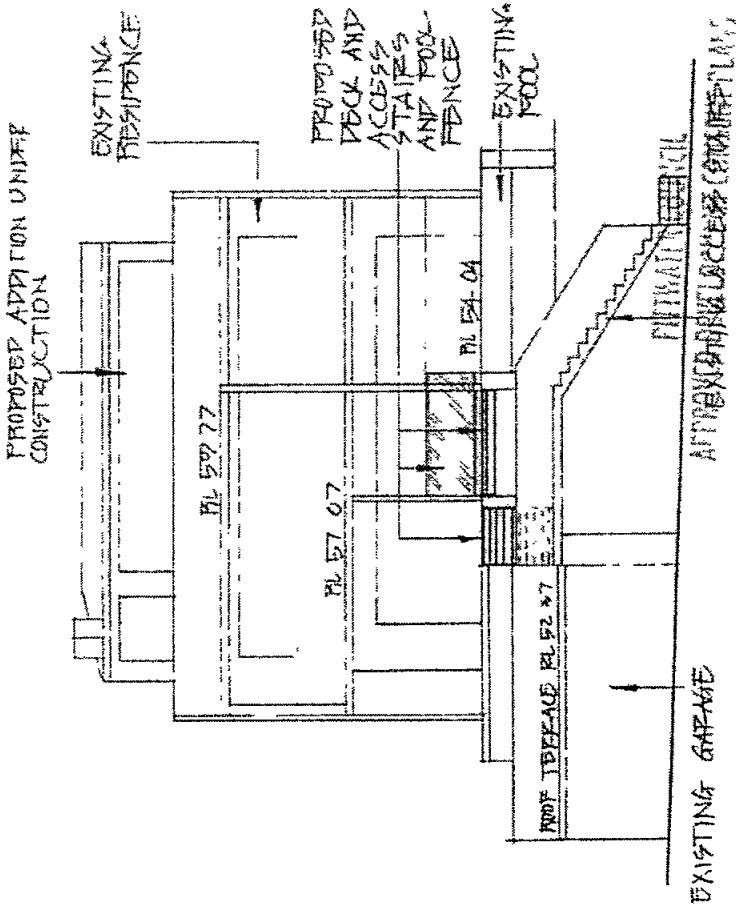

SOUTH-EAST ELEVATION

SCALE 1:100

NOTE THESE ARE APPROXIMATE CONSTRUCTION LEVELS

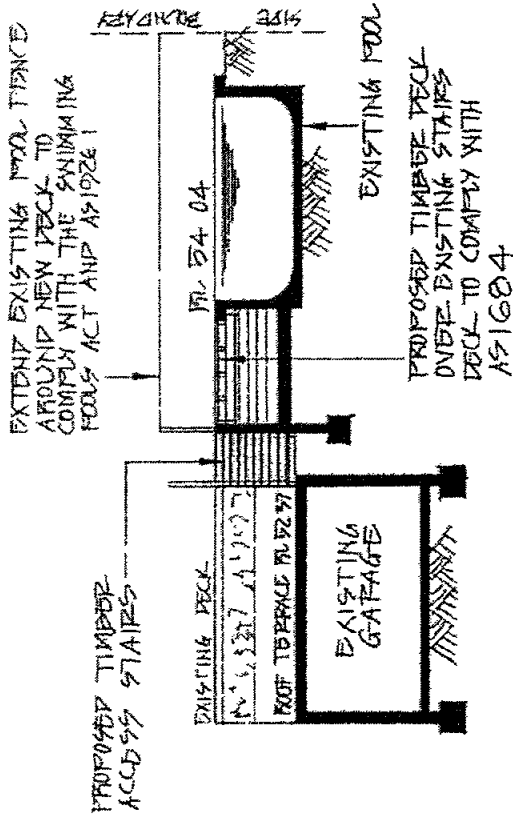

SECTION A-A

SCALE 1:100



NSW

Ph 0424 699 924

The builder must construct the building in accordance with the Building Code of Australia and the Development Consent conditions

CONSTRUCTION CERTIFICATE

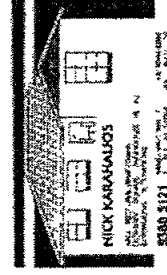

AMENDMENTS	PROPOSED DECK AND ACCESS STAIRS
	LOCATION
	5 BILGOLA TERRACE, BILGOLA
	DATE: 15/10/2010
	DESIGNED BY: NICK K MITCHELL
	SCALE: 1:100
	001956-5

