

**PART B DEMOLITION**

	REUSED	RECYCLED	DISPOSED	
TYPE OF WASTE	ESTIMATE VOLUME	ESTIMATE VOLUME	ESTIMATE VOLUME	METHOD OF REUSE
EXCAVATION MATERIAL	148 CUBIC M			SITE FILL
TIMBER	RECYCLED WHERE POSSIBLE		3.5 CUBIC M	KIMBRIKI RRC
CONCRETE				NIL
BRICK/PAVERS				NIL
TILES			1.0 CUBIC M	KIMBRIKI RRC
METAL (roof sheeting)			2.5 CUBIC M	KIMBRIKI RRC
GLASS			1.5 CUBIC M	KIMBRIKI RRC
FURNITURE		3.5 CUBIC M		KIMBRIKI RRC
FIXTURE AND FITTINGS		5.0 CUBIC M		KIMBRIKI RRC
FLOOR COVERING				NIL
PACKING		3.5 CUBIC M		KIMBRIKI RRC
GARDEN ORGANIC			5.5 CUBIC	RECYCLE / MULCH
CONTAINERS				NIL
PAPER				NIL
RESIDUAL WASTE			10 CUBIC M	COUNCIL HOUSEHOLD PICKUP
HAZARDOUS( asbestos waste)			3.5 CUBIC M	KIMBRIKI ASBESTOS SECTION

**PART D ONGOING WASTE MANAGEMENT**

	RECYCLABLES	COMPOSTABLES	RESIDUAL WASTE	OTHERS
TYPE OF WASTE	ESTIMATE VOLUME	ESTIMATE VOLUME	ESTIMATE VOLUME	METHOD OF REUSE
AMOUNT GENERATED (DAY)	HOUSEHOLD WASTE	HOUSEHOLD WASTE	HOUSEHOLD WASTE	
AMOUNT GENERATED (WEEK)	HOUSEHOLD WASTE	HOUSEHOLD WASTE	HOUSEHOLD WASTE	
COMPACTION REDUCTION	NIL	NIL	NIL	
COLLECTION FREQUENCY	1	1	1	
NUMBER OF BINS, SIZE	2X 140L	1X 240L	1X 80L	
STORAGE AREA	1.5MSQ	1.0MSQ	0.7MSQ	
MANEUVERABLE REQUIRED	1.5MSQ	1.0MSQ	0.7MSQ	
FIXTURE AND FITTINGS				
HEIGHT IF REQUIRED	NIL	NIL	NIL	

**WASTE MANAGEMENT PLAN**

- 1 MINIMISE THE WASTE SENT FOR DISPOSAL.
- 2 MINIMISE THE IMPACT AND DISTURBANCE ON SURROUNDING AMENITY, PUBLIC SAFETY, ROADWAYS AND NATURAL AND BUILT ENVIRONMENT.
- 3 ADHERE TO ANY RELEVANT LEGISLATION NOT LIMITED TO HAZARDOUS WASTE, STORAGE AND TRANSPORTATION REGULATIONS.
- 4 SEND WASTE MATERIALS TO A SUITABLY LICENSED FACILITY.
- 5 IDENTIFY SUITABLE LOCATIONS ON THE SITE FOR SORTING AND STORING OF MATERIALS FOR RE-USE, RECYCLING AND DISPOSAL. FACTORS TO CONSIDER INCLUDE SLOPES, DRAINAGE AND PERSONNEL AND VEHICULAR ACCESS.
- 6 MAINTAIN VALID TIPPING DOCKETS AND RECEIPTS ON SITE FOR INSPECTION.

**SITE PROTECTION**

BUILDING CONTRACTOR WILL INSTALL AROUND THE DEVELOPMENT AREA TEMPORARY STRUCTURES TO PROTECT PERSONS AND PROPERTY AND TO PREVENT UNAUTHORISED ACCESS TO THE SITE

**TREE PROTECTION**

BUILDING CONTRACTOR WILL REFER TO ARBORIST REPORT FOR TREE PROTECTION FENCING, GROUND PROTECTION AND TRUNK PROTECTION

**BASIC REQUIREMENT**

BUILDING CONTRACTOR TO ISSUE CERTIFICATE STATING COMPLIANCE WITH BASIC CERTIFICATE A401407-02 DATED 02 DECEMBER 2021

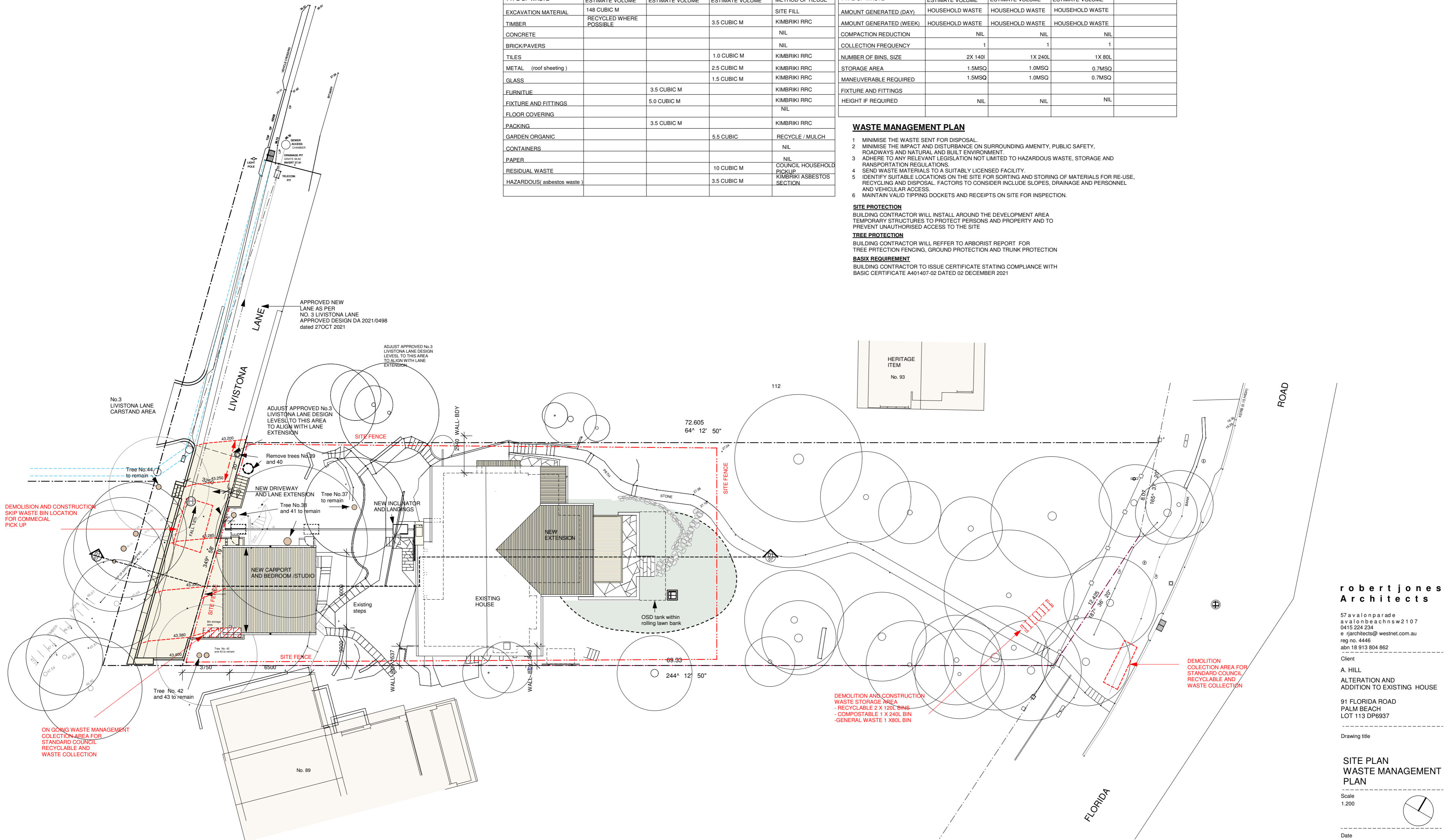

**robert jones Architects**

57 a valon parade  
 avlon beach nsw 2107  
 0415 224 234  
 e rjarchitects@westnet.com.au  
 reg no. 4446  
 abn 18 913 804 862

Client  
 A. HILL  
 ALTERATION AND  
 ADDITION TO EXISTING HOUSE

91 FLORIDA ROAD  
 PALM BEACH  
 LOT 113 DP6937

Drawing title

**SITE PLAN  
 WASTE MANAGEMENT  
 PLAN**

Scale  
 1:200

Date  
 October 2021

**DA01A**

NOTES  
 All Building Construction works to comply with all relevant BCA and AS requirements Building Contractor to verify dimensions on site prior to fabrication