

Applicant and Project Details

Complete this page and the relevant Sections that apply to your proposed development.

Applicants' Details

Name: (must be the same as the DA form)	Collaroy Veterinary Hospital Trust c/o BigCity Design Pty Ltd
Address: (must be the same as the DA form)	PO Box 526 Turramurra NSW 2074
Phone Number:	0417 251 025
Email Address:	dimitra@bigcitydesign.com.au

Property Details

Lot No: Deposited Plan (DP) No: or Strata Plan (SP) No:	Lot 1 DP 528546
Unit No: House No: Street: Suburb: Postcode:	1121 Pittwater Rd Collaroy 2097

Project Details

Description of proposed development:	Change of use and associated fitout, alterations & additions to existing building to create a veterinary hospital.
Structures to be demolished:	Demolition of more recent rear single storey addition to existing two storey building, and non-structural internal fitout.

Applicant Declaration

I declare that:

1. This plan has been completed in accordance with the Waste Management Guidelines
2. To the best of my knowledge, the details on this form are accurate and correct

I understand that:

1. All records demonstrating lawful disposal of waste will be retained and kept readily accessible for inspection by regulatory authorities such as Council, NSW Environment Protection Authority or WorkCover NSW.
2. A bond in accordance with Council's fees and charges may apply to this development and must be paid to Council prior to any works commencing.
3. The bond will only be refunded when Council is satisfied that all waste outlined in this plan has been managed as per the plan, and evidence such as photos, receipts and statutory declarations must be supplied where appropriate.

Signature of Applicant: _____



Date: 18 December 2020

Section 1 – Demolition

This section must be completed in accordance with ‘Chapter 1 – Demolition’ of the Waste Management Guidelines

MATERIALS ON SITE	DESTINATION <i>Evidence such as weighbridge dockets and invoices for waste disposal or recycling must be retained on site for inspection</i>					
	REUSE AND RECYCLING (MOST FAVOURABLE)				DISPOSAL (LEAST FAVOURABLE)	
Types of Waste Material	Estimated Volume (m ³) or Weight (t)	ONSITE RE-USE ✓ Specify how material will be reused on site	OFFSITE RECYCLING ✓ Recycling Outlet (RO) ✓ Waste Transport Contractor (WTC)		OFFSITE DISPOSAL ✓ Specify landfill site (LS) ✓ Specify Waste Transport Contractor (WTC)	
			WTC	RO	WTC	LS
Excavated Material	NIL					
Garden Organics	<0.5m ³		✓			
Bricks	10m ³			✓	OPTION NOT AVAILABLE: These materials must be re-used or separated on or off site and sent for recycling.	
Roof Tiles	7m ³			✓		
Concrete	3m ³			✓		
Timber	8m ³			✓		
Plasterboard	8m ³			✓		
Metals	<1m ³			✓		
Asbestos	NIL					
Other waste Carpet Sinks etc	3m ³			✓		
Estimated Total % Recovered	80%					

Refer to the estimation tables in ‘Chapter 1 – Demolition’ of the Guidelines for assistance in completing this table.

The applicant must submit a Site Plan showing the structures to be demolished and storage areas for waste and construction materials (if the development also includes construction).

WMP Checklist

Have you included the following:	Applicant Tick
<p>A site plan showing:</p> <ul style="list-style-type: none">• The structures to be demolished.• Storage areas for waste to be reused, recycled, or disposed of.• Materials storage (if the development also includes construction)	<input checked="" type="checkbox"/>
<p>The table on the previous page, completed in accordance with 'Chapter 1 – Demolition' in the guidelines.</p>	<input checked="" type="checkbox"/>

Section 2 – Construction

This section must be completed in accordance with ‘Chapter 2 – Construction’ of the Waste Management Guidelines

MATERIALS ON SITE	DESTINATION <i>Evidence such as weighbridge dockets and invoices for waste disposal or recycling must be retained on site for inspection</i>					
	REUSE AND RECYCLING (MOST FAVOURABLE)				DISPOSAL (LEAST FAVOURABLE)	
Types of Waste Material	Estimated Volume (m ³) or Weight (t)	ONSITE RE-USE ✓ Specify how material will be reused on site	OFFSITE RECYCLING ✓ Specify recycling outlet (RO) ✓ Specify Waste Transport Contractor (WTC)		OFFSITE DISPOSAL ✓ Specify landfill site (LS) ✓ Specify Waste Transport Contractor (WTC)	
* Please specify			WTC	RO	WTC	LS
Excavated Material	NIL					
Garden Organics	NIL					
Bricks	<0.5m ³			✓	OPTION NOT AVAILABLE: These materials must be re-used or separated on or off site and sent for recycling.	
Tiles	NIL					
Concrete	<0.5m ³			✓		
Timber*	1m ³			✓		
Plasterboard	<0.5m ³			✓		
Metals*	<1m ³			✓		
Asbestos	NIL					
Other waste* Cardboard packaging	3m ³			✓		
Estimated Total % Recovered	65%					

Refer to the estimation tables in ‘Chapter 2 – Construction’ of the Guidelines for assistance in completing this table.

The applicant must submit a Site Plan showing the structures to be demolished and storage areas for waste and construction materials (if the development also includes construction).

WMP Checklist

Have you included the following:	Applicant Tick
<p>A site plan showing:</p> <ul style="list-style-type: none"> • The structures to be demolished. • Potential storage areas for waste to be reused, recycled, or disposed of. • Materials storage 	<input checked="" type="checkbox"/>
<p>The table on the previous page, completed in accordance with 'Chapter 2 – Construction' in the guidelines.</p>	<input checked="" type="checkbox"/>

Section 5 – On-going waste management for non-residential and mixed use developments

This section is to be completed in accordance with 'Chapter 5 – On-going waste management for non-residential developments' and 'Chapter 6 – On-going waste management for mixed use developments' of the Waste Management Guidelines.

Type of development: Veterinary Hospital

Number of commercial premises: 1

Number of Waste Storage Areas: 1

WMP Checklist

Do your architectural/landscape plans include the following:	Applicant Tick	N/A
Waste Storage Area design requirements (Chapter 5.2.)	✓	-
Waste Storage Area location requirements (Chapter 5.3.)	✓	-

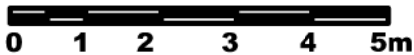
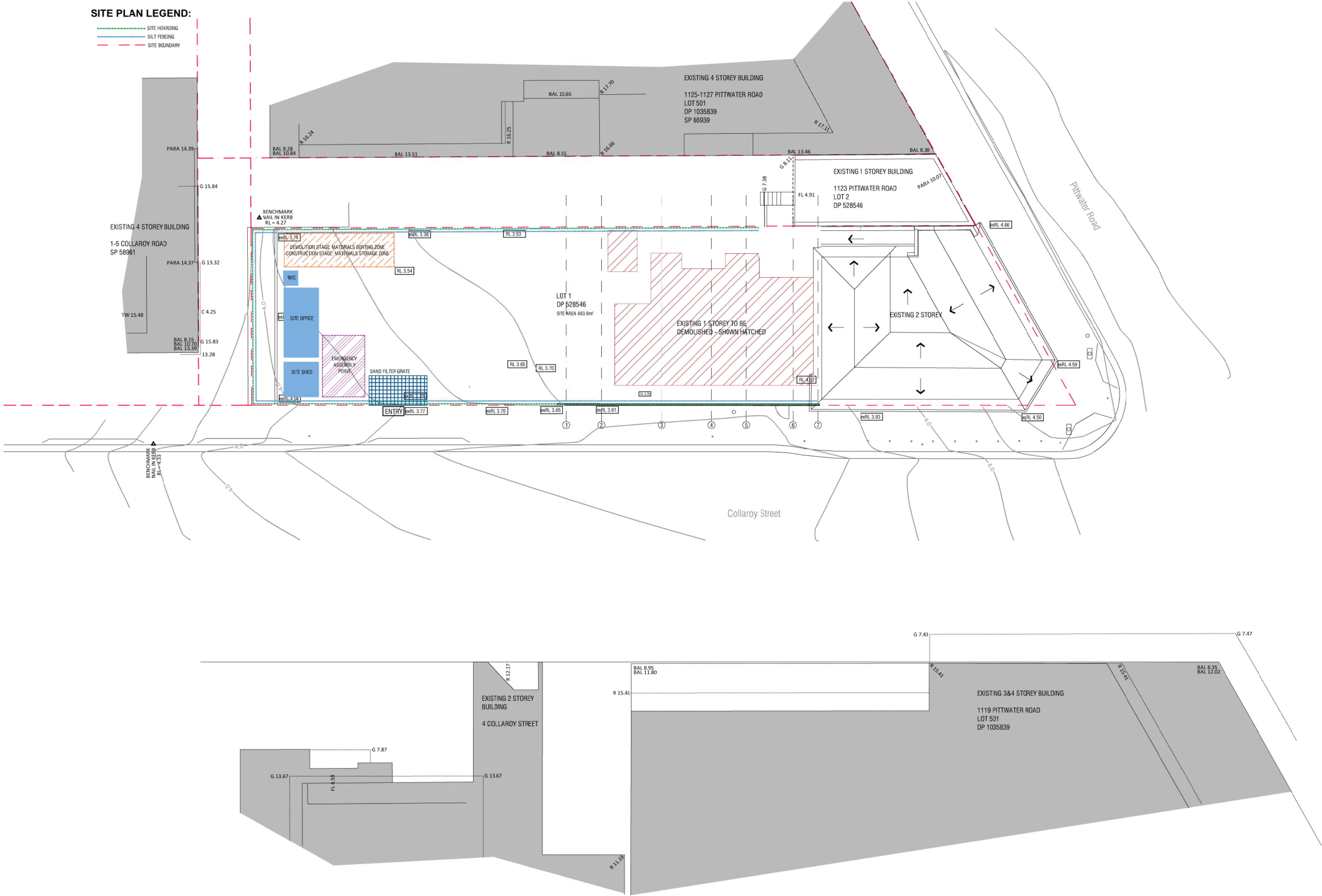

CONTRACTORS MUST VERIFY AND CHECK ALL SITE CONDITIONS, DIMENSIONS AND CEILING HEIGHTS BEFORE COMMENCING ANY WORK ON SITE OR PREPARING ANY SHOP DRAWINGS. ANY DISCREPANCIES ARE TO BE REFERRED IMMEDIATELY TO THE DESIGNER FOR CO-ORDINATION.

HEAD CONTRACTOR TO ENSURE ALL WORKS COMPLY WITH CURRENT BCA, ALL RELEVANT AS, DDA AND ALL OTHER STATUTORY REQUIREMENTS.

Rev	Description	Date
A	DEVELOPMENT APPLICATION	16.12.20

This document is Copyright.
Copyright in this document vests in and remains the property of BigCity Design Pty Ltd. The information in this document is not to be used, reproduced or circulated without the express written permission of BigCity Design Pty Ltd. The information in this document is not to be used for any project other than the project for which this document has been produced.

Services Engineer:



Structural Engineer:



BigCity Design PO Box 526 Turramurra NSW 2074
P 9943 1036 F 9943 1037
E dimitra@bigcitydesign.com.au

Client:



Project:

COLLAROY VET HOSPITAL
1121 PITTWATER RD
COLLAROY NSW 2097
LOT 1 DP 528546

Drawing Title:

WASTE MANAGEMENT SITE PLAN

Date: 15.12.20	Scale: 1:200@A2	Drawn: CS	North:
Project No: C07-20328	Dwg No: DA-18	Revision: A	