

**NOTE: ALL UPGRADES TO MEET BAL 40 WILL BE NOTED AT CC STAGE**  
 (THE PROPOSED UPGRADES MUST INCLUDE, AS A MINIMUM, EMBER PROOFING OF THE EXISTING DWELLING AND UPGRADE OF THE EXISTING DOORS AND WINDOWS TO BUSH FIRE ATTACK LEVEL (BAL) 40 CONSTRUCTION REQUIREMENTS. OTHER MEASURES ARE NOT DEEMED NECESSARY IN THIS INSTANCE BASED ON THE LOW BUSH FIRE RISK.)

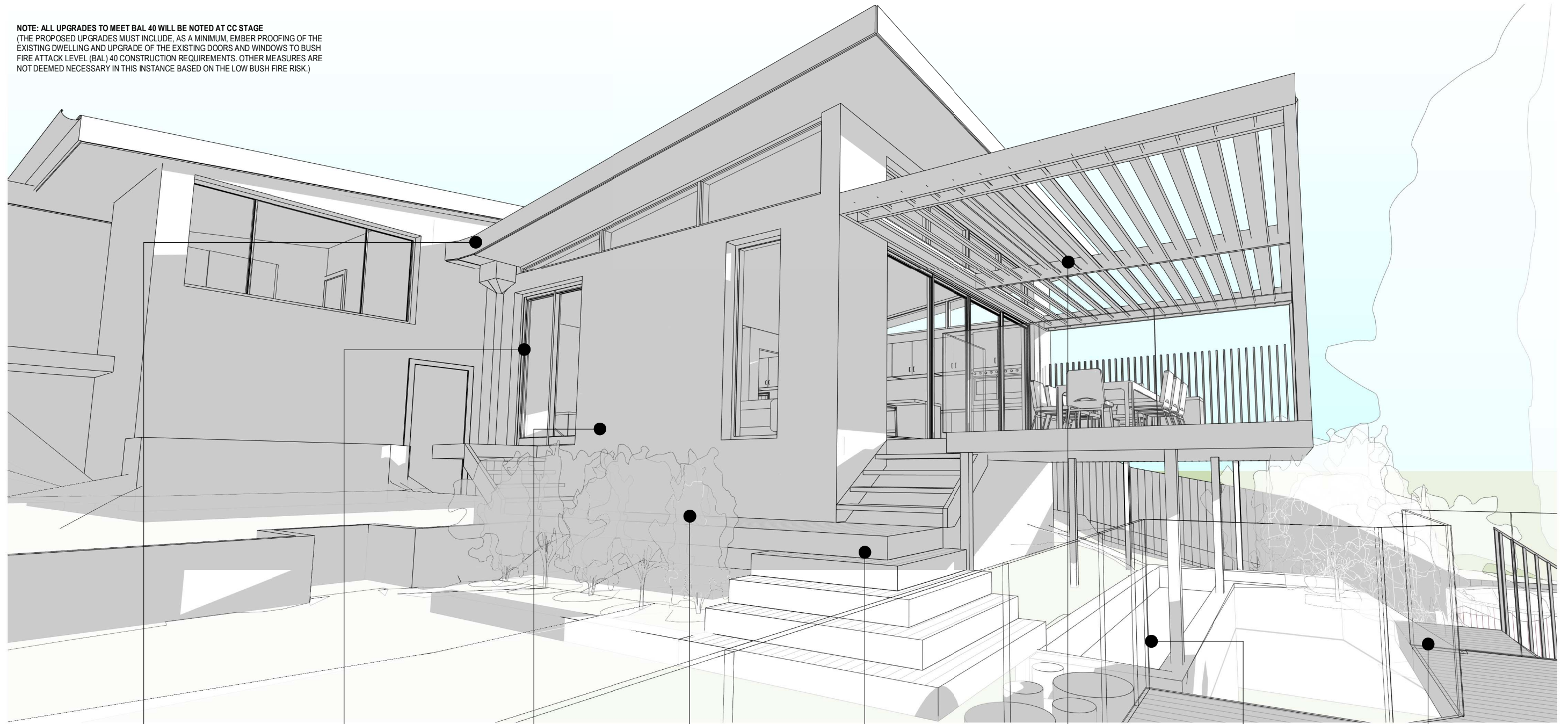

COLORBOND CUSTOMORB ROOF - DEEP OCEAN TO MATCH EXISTING

WHITE ALUMINIUM WINDOWS AND DOORS TO MATCH EXISTING

BRICK WALL WITH RENDERED CONCRETE TO MATCH EXISTING

HARDWOOD DECK

HARDWOOD STAIRS

OPERALE LOUVRE PERGOLA

CAST CONCRETE STAIRS

SS SPIGOT GLASS BALUSTRADE



ENSURE ALL NEW ROOFING MATERIALS, SYSTEMS OR ACCESSORIES SHALL BE NON-COMBUSTIBLE, AND SEALED IN ACCORDANCE WITH AS3959:2018 CLAUSE 3.6



ENSURE WINDOWS AND DOOR SYSTEM TESTED TO CONFORM WITH AS1530.8.1



ENSURE ALL NEW WALLS SHALL BE NON-COMBUSTIBLE (INCLUDING BRICK, CONCRETE, RAMMED EARTH AND MUD BRICK, ETC. AT MIN. THICKNESS OF 90MM), OR CLADDING ON SARKED WALLS THAT IS NON-COMBUSTIBLE, OR MIN 9MM THICK CEMENT SHEET, OR STEEL, OR A SYSTEM CONFORMING WITH AS1530.8.1.



ENSURE ALL NEW DECKING BOARDS, STAIR TREADS, LANDINGS AND RAMPS SHALL BE NON-COMBUSTIBLE, OR CEMENT SHEET, OR A SYSTEM CONFORMING TO AS1530.8.1.  
 ENSURE ALL DECK SUPPORTS AND FRAMING SHALL BE (A) NON-COMBUSTIBLE, OR (B) A SYSTEM CONFORMING TO AS1530.8.1.



ENSURE ALL NEW ROOFING MATERIALS, SYSTEMS OR ACCESSORIES SHALL BE NON-COMBUSTIBLE, AND SEALED IN ACCORDANCE WITH AS3959:2018 CLAUSE 3.6



ENSURE ALL NEW DECK SUPPORTS AND FRAMING SHALL BE NON-COMBUSTIBLE, OR A SYSTEM CONFORMING TO AS1530.8.1.

PRINT DATE: 3/12/2024 11:56:19 AM	PRINT SIZE: A3	ISSUE 01	DESCRIPTION DA Issue	DATE 29/11/24	CLIENT: Hannah Hale	EXTERNAL FINISHES		
NOTES: Builder is to examine the site and verify conditions and dimensions. Any discrepancies must be brought to the architect's attention. Use figured dimensions only. Do not scale drawings. All work shall comply with the Building Code of Australia and relevant Australian Standards.					PROJECT: Alterations and Additions	PROJECT NO. 1099HHA	DA 002	
This drawing is copyright and remains the property of Hot House Architects HOT HOUSE PROJECTS PTY LTD T/A HOT HOUSE ARCHITECTS					ADDRESS: 14 SHERWOOD CRESC, NARRAWEENA	DATE 29 November 2024		
						LOT: 18		DRAWN BY: JG
						DP: 30588	CHECKED BY: WC	SCALE: