

Sandstone rockery/waterfall to edge of pool

Pool Equipment shed and Sauna

Day bed and outdoor fire place

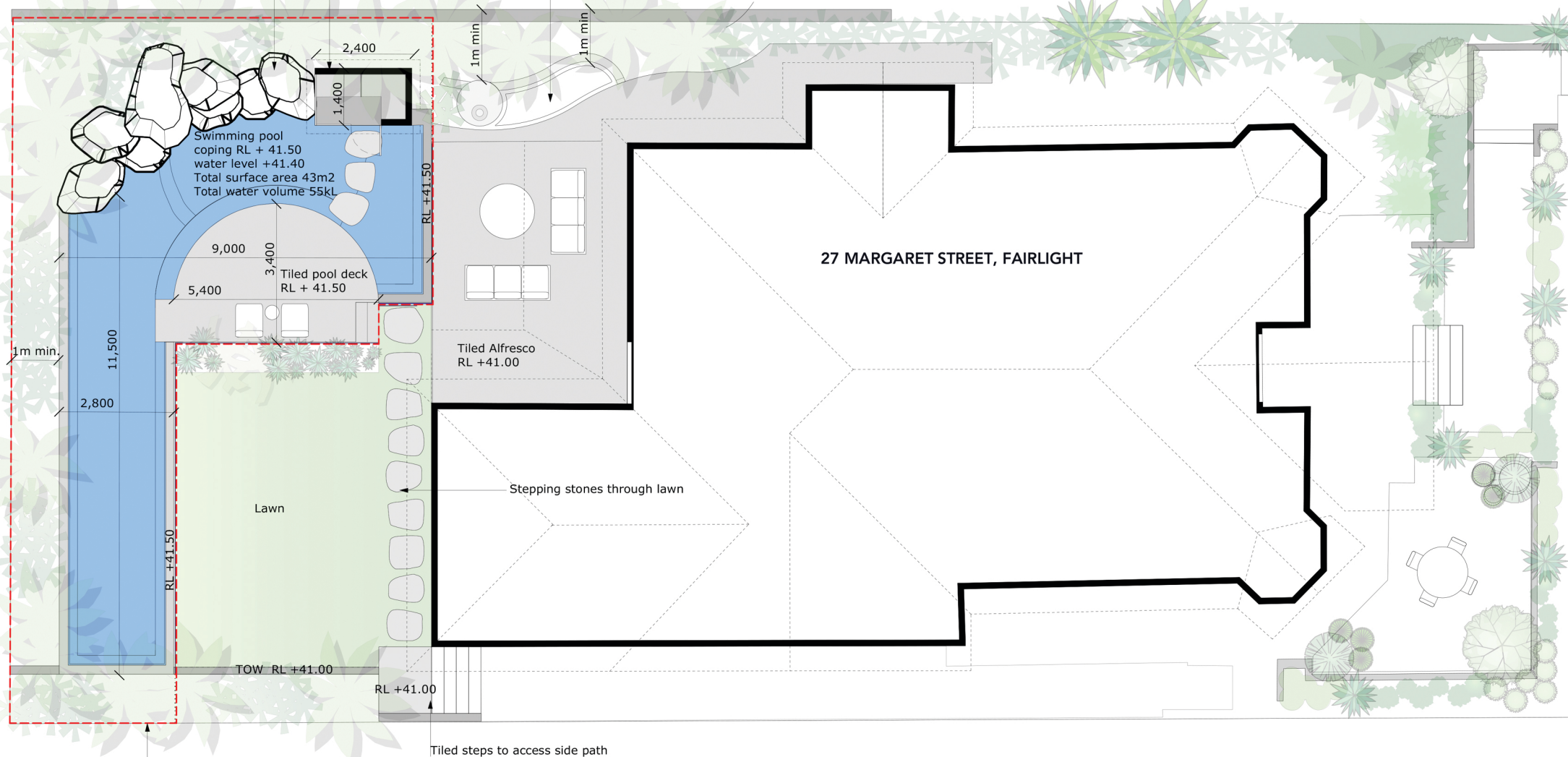

Pool fencing shown red dashed.
Pool barrier to be frameless glass min 1200mm high
Boundary fence pool barrier to be 1800mm high.
All Pool fencing to comply with all non-climbable zones and
conditions as set out in AS19.26 and Swimming Pools Act 1992

Pool Plan

project number. 2094.2/19
date. 08.05.2019
council. Northern Beaches
drawing number. 3.A



scale. 1:100 @ A3

Plans are NOT FOR CONSTRUCTION
All measurements and levels to be confirmed on site
Figured dimensions take precedence over scaled
All discrepancies to be made known to Land Forms before
commencing any construction work onsite
Refer to Architectural / Engineering/ Hydraulic and all other
relevant documents relating to project.
Council conditions, By-Laws and Australian Standards are to
be checked by contractor and certifier and adhered to.

client:
LUCINDA MILLS

address:
27 MARGARET STREET, FAIRLIGHT

LANDFORMS.

Level 1 / 680 Pacific Hwy Killara NSW 2071 Australia
m 0400 935 535 p 02 9138 0644
e design@landforms.com.au w landforms.com.au