

MULLET CREEK

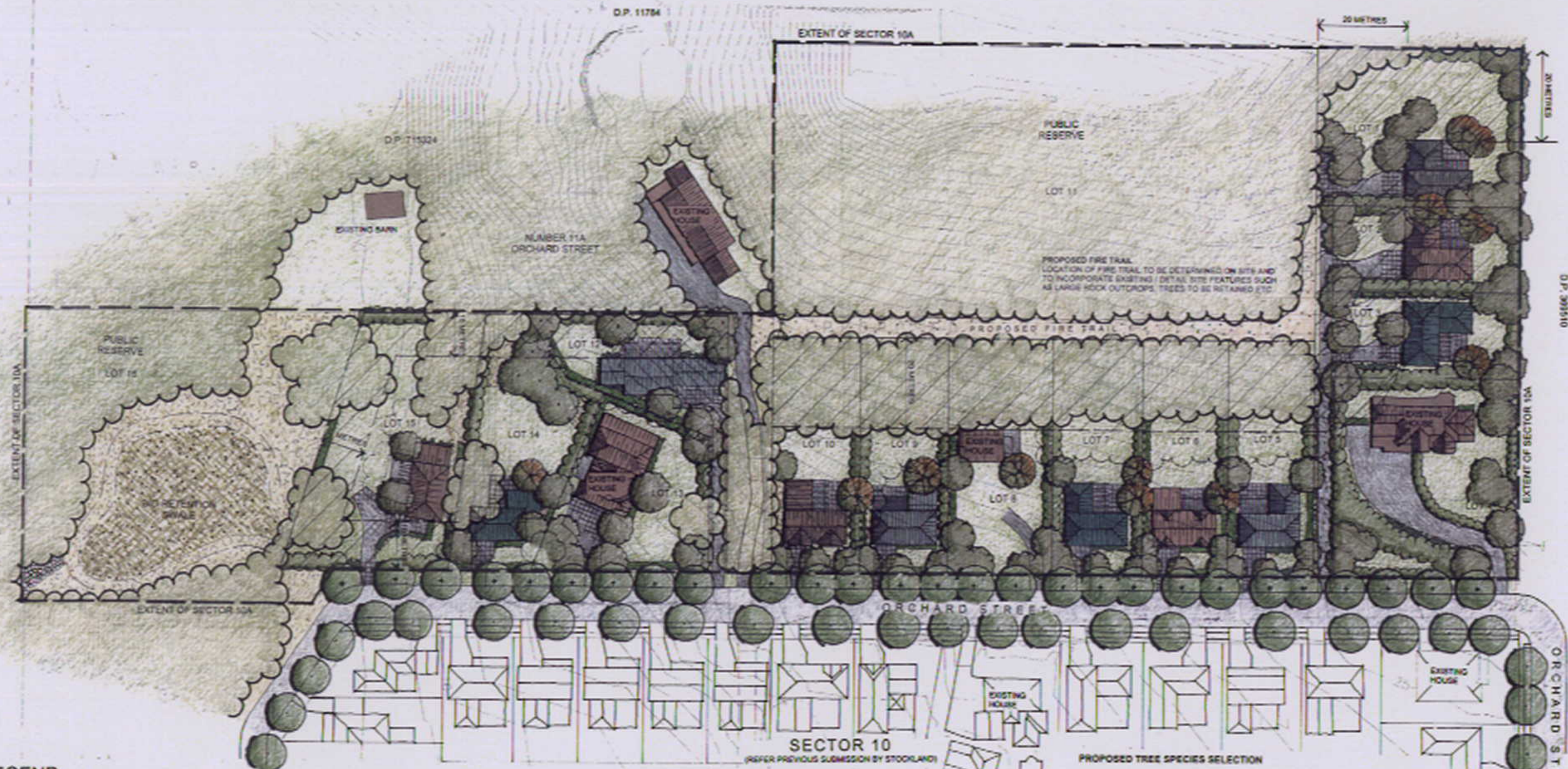

LEGEND

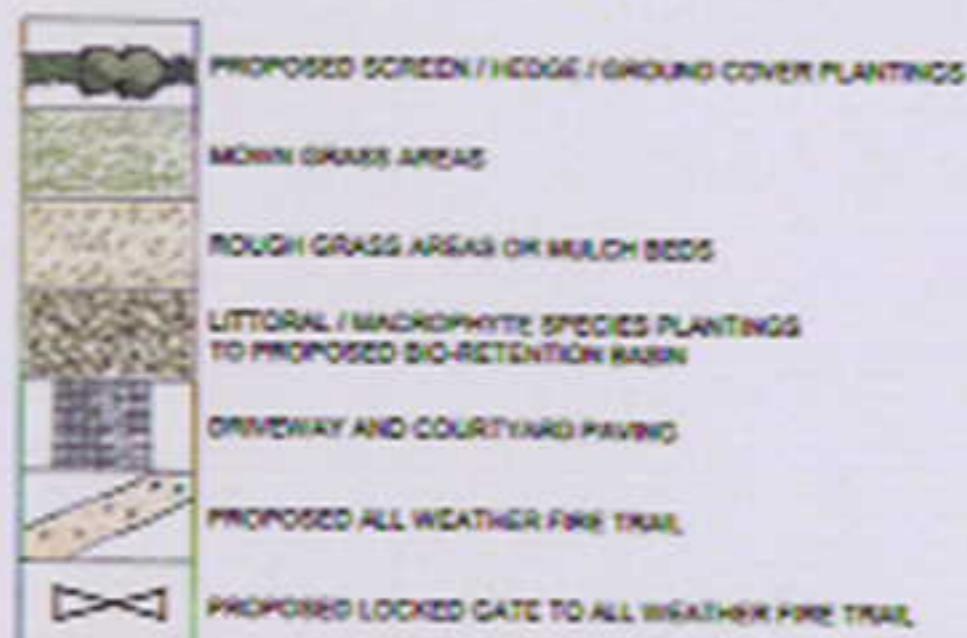
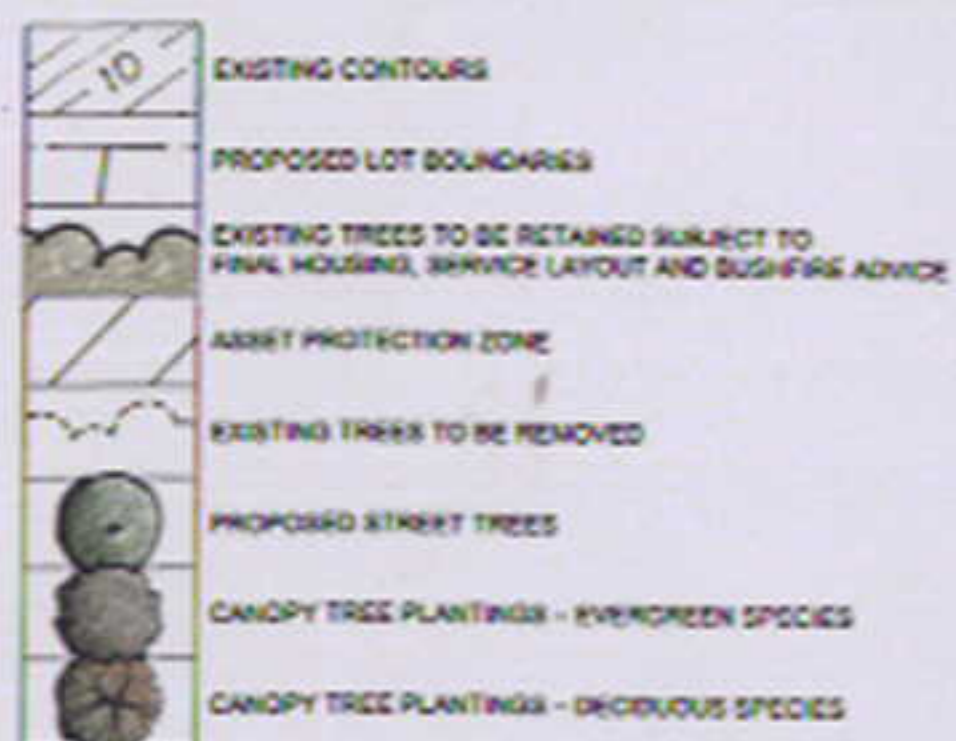

NOTES:

- 1.0 REFER SURVEY PLAN FOR DETAILS OF SERVICES (BYRNE & ASSOCIATES PTY LTD)
- 2.0 HOUSING AND GARDEN LAYOUT IN LOTS 1, 2, 3, 5, 6, 7, 9, 10, 12, 14 AND 15 DIAGRAMMATIC ONLY AND SUBJECT TO FUTURE DEVELOPMENT APPLICATION
- 3.0 GARDEN LAYOUT IN LOTS 4, 8, 13 DIAGRAMMATIC ONLY

PROPOSED TREE SPECIES SELECTION

Location	Species	Common Name	Mature Ht & Spd	
Orchard Street	<i>Eucalyptus haemastoma</i>	Scrubby Gum	12m x 6m	
Canopy trees for larger lots & open space	<i>Acacia white</i>	Lily Pilly	8m x 6m	
	<i>Angophora costata</i>	Smooth-barked Apple	15m x 10m	
	<i>Eucalyptus laurifolia</i>	Bergolly	12m x 6m	
	<i>Eucalyptus haemastoma</i>	Scrubby Gum	12m x 6m	
	<i>Coccoloba punctata</i>	Grey Gum	12m x 6m	
	<i>Eucalyptus melanocarpa</i>	Swamp Mahogany	15m x 10m	
	<i>Ficus macrophylla</i>	Marun Bay Fig	18m x 15m	
	<i>Ficus rubiginosa</i>	Port Jackson Fig	15m x 12m	
	<i>Glochidion latifolium</i>	Chinese Tree	10m x 8m	
	<i>Magnolia grandiflora</i>	Bull Bay Magnolia Giant	12m x 10m	
Evergreen trees for residential lots	<i>Waterhousea torulata</i>	Water Gum	8m x 6m	
	<i>Styphalegium plumifera</i>	Turpentine	15m x 10m	
	<i>Leptosiphon obtusum</i>	Lemon-scented Myrtle	8m x 6m	
	<i>Santalum indigifolium</i>	Coastal Banksie	8m x 6m	
	<i>Eleocharis villosula</i>	Slender Ash	8m x 6m	
	<i>Hymenopappus laevis</i>	Native Frangipani	8m x 6m	
	<i>Melaleuca quinquenervia</i>	Broad Leaf Paperbark	10m x 6m	
	<i>Trochostema laevis</i>	Water Gum	8m x 6m	
	Deciduous & light canopy trees for residential lots	<i>Acer palmatum</i>	Japanese Maple	8m x 6m
		<i>Jacaranda mimosifolia</i>	Jacaranda	8m x 6m
<i>Pistacia chinensis</i>		Chinese Pistachio	8m x 6m	
<i>Ptilerium dilatata</i>		Pine Tree	8m x 6m	
<i>Fraxinus "Raywood"</i>		White Ash	8m x 6m	
	<i>Syringa whiteana</i>	Chinese Tallow	10m x 7m	

**WARRIEWOOD SECTOR 10A
LANDSCAPE MASTERPLAN**

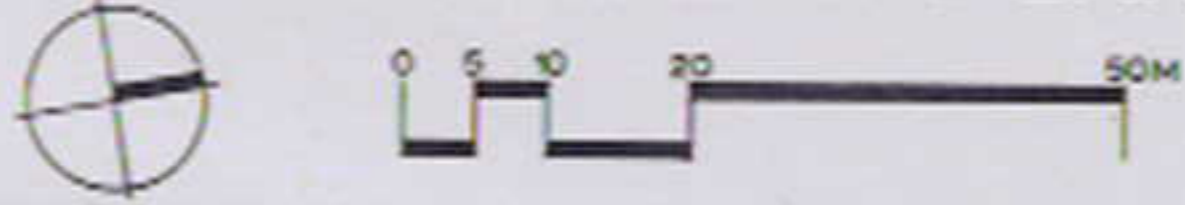

ORCHARD STREET, WARRIEWOOD

LANDSCAPE ARCHITECTS
MATHER & ASSOCIATES
 LANDSCAPE ARCHITECTS
 111 GARDEN STREET
 WARRIEWOOD NSW 2204
 PH: (02) 9439 1111
 FAX: (02) 9439 1112
 WWW: www.mather.com.au

Client: Sealforth Mac Pty Ltd
 Date: February 2004
 Dwg No: 1 of 1
 Scale: 1:500 @ A1
 Issue: A