

# Memorandum

**From:** Howard Moutrie  
**Project:** 53C, Warriewood Road, Warriewood.  
**Re:** Carparking for Adaptable units

**Date:** 29-04-2016  
**Job No:** 214267  
**No of Pages:** 2

|                |  |
|----------------|--|
| <b>To</b>      | <b>Fax No/ Email</b>                       |
| Stephen Bowers | stephen.bowers@stephenbowersarchitects.com |

Dear Stephen,

Council has raised a question regarding the use of the traffic aisle as the “shared area” for the parking provided for the adaptable units.

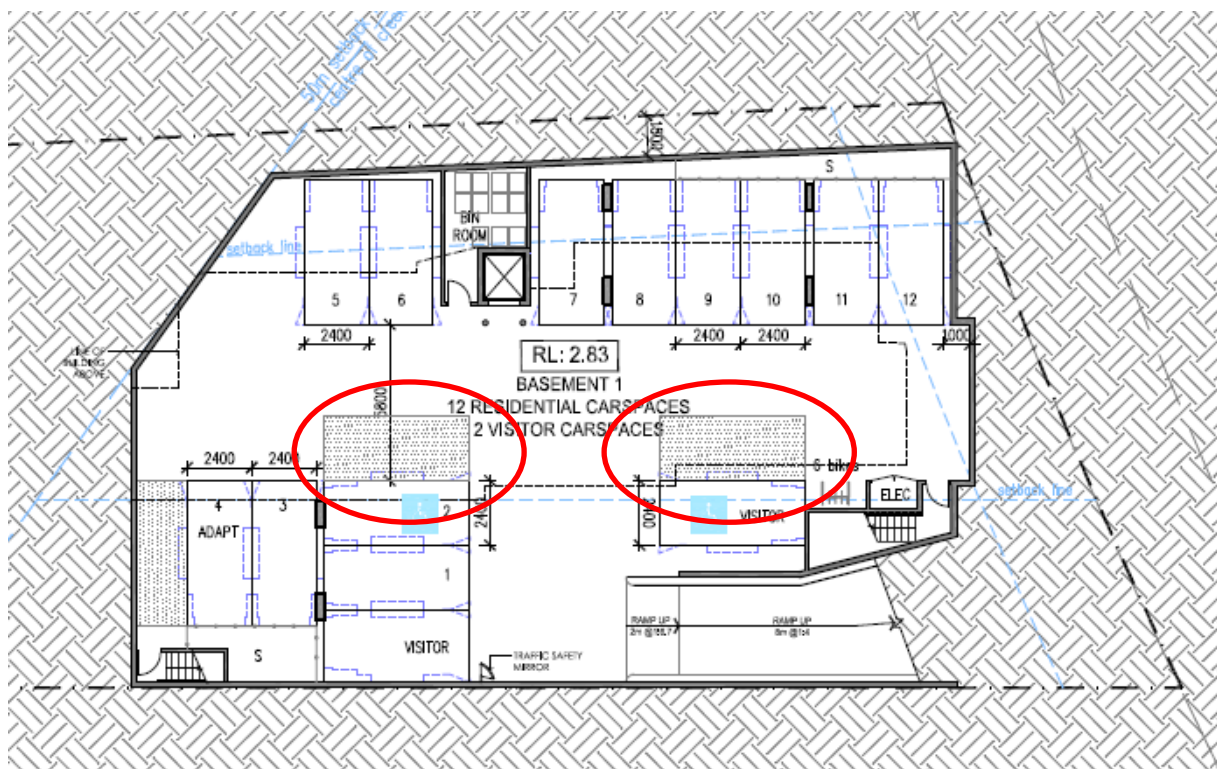

There are 2 issues here.

Firstly, the use of the aisle as the shared area is permitted under AS 2890.6. It is also noted that a shared area is also required at the end of the space which almost always will be within a traffic aisle. The proposed shared area is not on the direct line of travel down the ramp, where view of the shared area may be limited, but in an area where travel speeds will be minimal.

The second issue is that the parking is for adaptable housing which may never be occupied by a person with a disability. Even if the space were used by a person with a mobility disability, it is unlikely that the full width of the shared area would be required. The full width of the area is only required by a side loading ramp, which is not a very common method and will always be used by a carer unloading the person in a wheelchair. The majority of any

unloading will take place at the rear of the vehicle ( in the aisle) using a rear mounted ramp or hoist, or at the side of the vehicle using a roof mounted hoist or a side loading hoist. In either of the side loading techniques, the process can be achieved in a width of 1200mm.

Given, that the shared area being located in the aisle is allowed within the Standard and also given the low likelihood of a person in a wheelchair actually occupying the unit, I consider that the issue of safety is not exacerbated by the proposed layout.



**Howard Moutrie**

ACAA Accredited Access Consultant No 177

## Statement of experience

---

Name: **Howard Moutrie**

Qualifications: B. Arch (Hons)  
Registered Architect ARB Reg. No 4550 Registered 1988  
OHS Induction Training  
OHS – Monitoring a Safe Workplace  
QA Assessor/Auditor  
Registered Assessor of Livable Housing Australia (License no 10054)

Memberships: ACAA Accredited Access Consultant Reg. No. 177  
Past & Current Standards Australia ME/64 Committee (Access Standards)  
Sutherland Council Design Review Panel  
Sutherland Council Access Committee  
City of Sydney Access Panel 2010  
Building Professionals Board Access Advisory Panel  
ACAA NSW Network of Access Consultants Management Committee

Experience: Howard Moutrie is an architect with over 30 years of experience and an accredited Access Consultant with the Association of Consultants in Access Australia (ACAA). Howard has worked both in Australia and internationally.

Howard is an experienced practicing access consultant and has previously spent 10 years on the Standards Australia Disabled Access Committee ME/64, providing input into the AS 1428 suite of Standards and the Adaptable Housing Standard. Howard has provided comment to numerous Councils on their Access Policy and acted as an expert witness in the Land & Environment Court.



Howard specializes in access consultancy services within the built environment. Services include design advice, access auditing of buildings, reports for building and development approval, alternative solutions, expert witness and luminance contrast testing.



Howard maintains a high level of continuing education programs and has presented at numerous seminars and training sessions including:

- ACAA National Conference
- ACAA State Network Seminars
- RAI A Network Seminars
- Building Designers Association Seminars
- Sutherland Council Assessment Staff



**Farah Madon**, is an experienced practicing access consultant and a Sub-Consultant of Accessible Building Solutions. She is a:

- Registered Architect (ARB Reg. No 6940) with 16 years of experience
- ACAA Accredited Access Consultant (Reg. No. 281)
- Registered Assessor of Livable Housing Australia (License no 10032)

Farah has attained Certificate IV in Property (Access Consulting) in Units PRDAC401A/403A/503A and OHS Construction Induction Training Certificate



Farah also participates on the following committees:

- Penrith City Council's Access Committee Member
- National Management Committee member of ACAA
- Management Committee member of ACAA NSW Network of Access Consultants
- Member of the RAI A's National Access Work Group