

- SEDIMENT CONTROL NOTES**
1. ALL EROSION AND SEDIMENTATION CONTROL MEASURES, INCLUDING REVEGETATION & STORAGE OF SOIL AND TOPSOIL, SHALL BE IMPLEMENTED TO THE STANDARDS OF THE SOIL CONSERVATION OF NSW.
  2. ALL DRAINAGE WORKS SHALL BE CONSTRUCTED AND STABILIZED AS EARLY AS POSSIBLE DURING DEVELOPMENT.
  3. SEDIMENT TRAPS SHALL BE CONSTRUCTED AROUND ALL INLET PITS, CONSISTING OF 300mm WIDE X 300mm DEEP TRENCH
  4. ALL SEDIMENT BASINS AND TRAPS SHALL BE CLEANED WHEN THE STRUCTURES ARE A MAXIMUM OF 60% FULL OF SOIL MATERIALS, INCLUDING THE MAINTENANCE PERIOD.
  5. ALL DISTURBED AREAS SHALL BE REVEGETATED AS SOON AS THE RELEVANT WORKS ARE COMPLETED.
  6. SOIL AND TOPSOIL STOCKPILES SHALL BE LOCATED AWAY FROM DRAINAGE LINES AND AREA WHERE WATER MAY CONCENTRATE.
  7. FILTER SHALL BE CONSTRUCTED BY STRETCHING A FILTER FABRIC (PROPEX OR APPROVED EQUIVALENT) FABRIC SHALL BE BURIED 150mm ALONG ITS LOWER EDGE.

<b>TOTAL SITE AREA - m2</b>	<b>694.70</b>	
EXISTING DWELLING	125.00	
EXISTING OTHER STRUCTURES	0.00	
EXISTING DRIVEWAY/PATHS	143.30	
<b>TOTAL EXISTING IMPERVIOUS</b>	<b>268.30</b>	
EXISTING HARD SURFACE BUILT OVER	0.00	
<b>BALANCE IMPERVIOUS AREA</b>	<b>268.30</b>	
<b>PROPOSED ADDITIONS</b>	<b>34.20</b>	
<b>TOTAL PROPOSED IMPERVIOUS AREA</b>	<b>302.50</b>	<b>43.65 %</b>
<b>TOTAL PROPOSED LANDSCAPE AREA</b>	<b>392.20</b>	<b>56.35 %</b>

PROPOSED NEW	
MAIN DWELLING	
PATIO ROOF/SHEDS	
CONCRETE/PAVING	

**NAREEN PARADE**

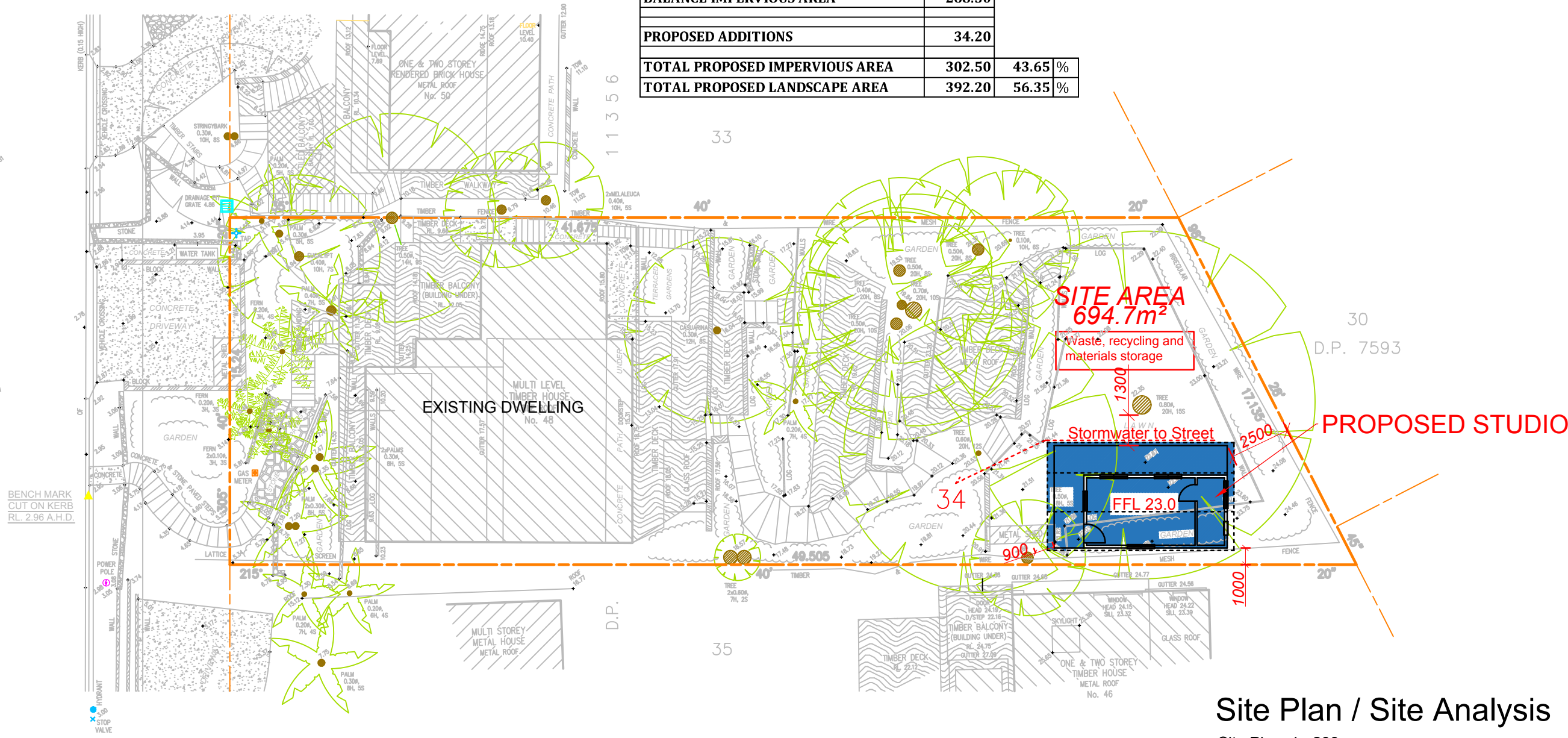

**Site Plan / Site Analysis**  
Site Plan: 1 : 200

Copyright © This Drawing remains the property of Connect Drafting until invoice for these plans are paid in full and may not be used or reproduced until invoice paid in full. DO NOT SCALE from Drawing. All dimensions are in millimeters and are to be verified onsite prior to construction.

AMENDMENT	ISSUE	PROPOSED	FOR
14/04/19	PRELIMINARY ISSUE	A	STUDIO MATT GOOD
AT SITE ADDRESS 48 NAREEN PARADE, NORTH NARRABEEN			
DRAWING		LOT NO	DP
SITE PLAN/SITE ANALYSIS		34	11356
DATE	SCALE	PROJECT NO	DRAWING NO
14/04/19	1 : 200	CD-061/19	CD-061/19-V1
			SHEET NO
			1 OF 2

**CONNECT DRAFTING**

ABN : 44 533 496 441 OFFICE : GLENHAVEN  
Robert Orehek Mob : 0416 931 237 connectdrafting@gmail.com

