

Block Plan 1 : 200

Plan & Elevations 1 : 100

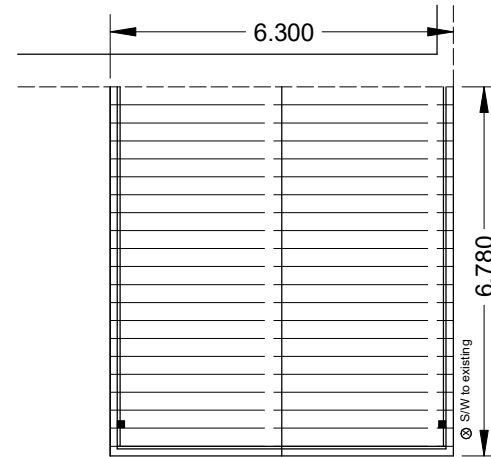
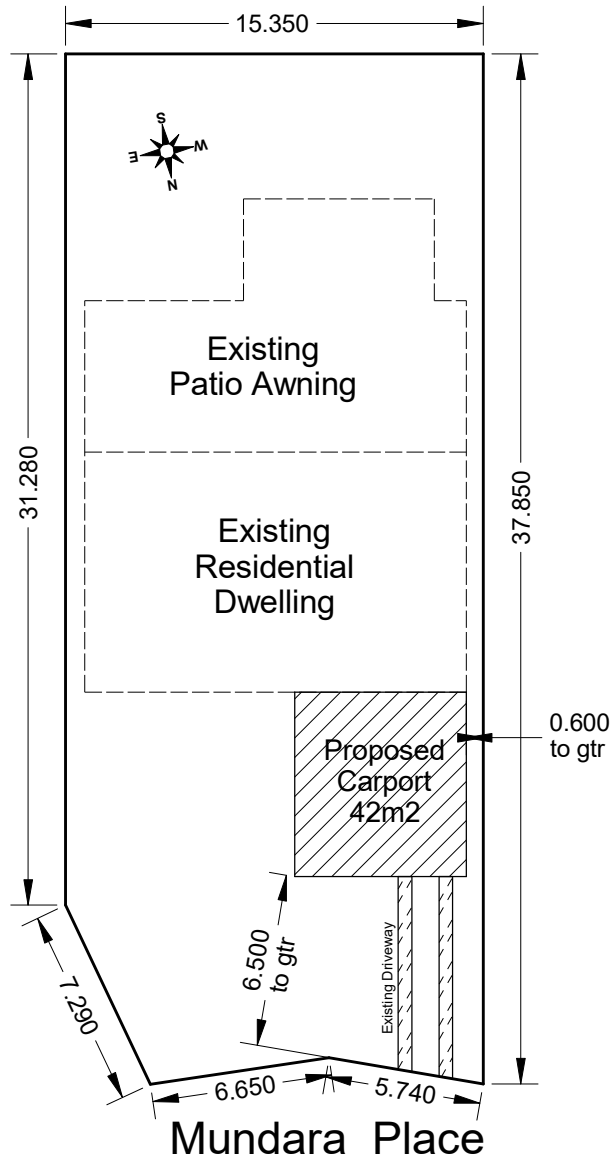

Apollo Additions

19 Chicago Ave.
Blacktown 2148
Lic # 166046C Ph: 96799957

Statement of environmental effects

- * The use is residential & will not generate extra noise
- * The use will not create overshadowing
- * No Earth works or removal of flora
- * No waste created on site
- * This development will comply with Bush Fire requirements where necessary
- * S/W to comply with DCP 165
- * No Sediment Control Req'd
- * The addition will not adversely affect the character of the area

Project Details

G & R Gidley
12 Mundara Place
Naraweena
Lot 14 DP 229969

Proposed Addition of Carport

Drawing No. 1 of 2
Amended 25th November 2019
Drawn by J. Cook 29th July 2019