

1
D.P. 305993

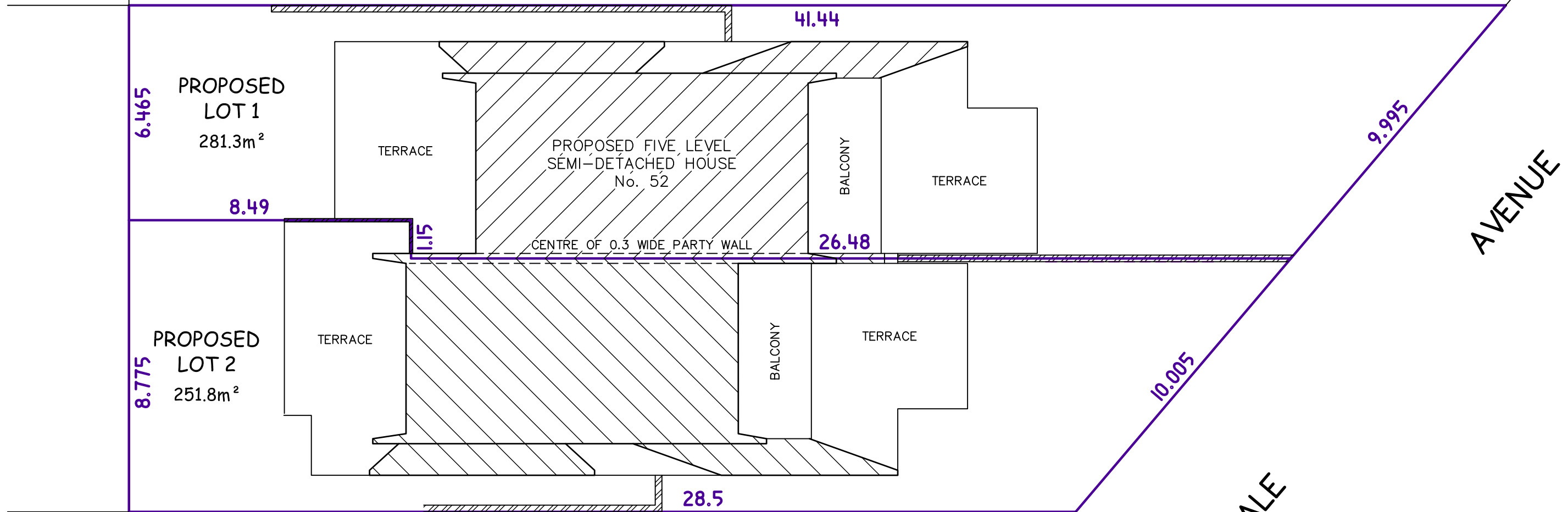

S.P. 78806

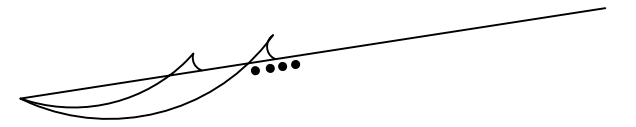

Bee & Lethbridge Pty Ltd
Suite 2, 14 Starkey Street,
PO Box. 330, Forestville, NSW 2087
Phone: 9451 6757 Fax: 9975 3535
Email: survey@beeeth.com.au
ABN: 13 003 194 447
www.beeeth.com.au

PLAN OF PROPOSED SUBDIVISION OF LOT 1 IN D.P. 172127
KNOWN AS No. 52 LAUDERDALE AVENUE, FAIRLIGHT.

L.G.A.: NORTHERN BEACHES

CLIENT DAVID ALLEN			REF No.
PROPERTY No. 52 LAUDERDALE AVENUE, FAIRLIGHT			3250
DATUM -	SCALE 1:125 @ A3	DATE 04/03/2019	SHEET No. 1 of 1
SURVEYED W.B.	DRAWN R.M.	DWG No. 3250	REV No. 00