

WITH COMPLIMENTS



DEAR ANNY,

PLEASE FIND ATTACHED 2 COPIES OF THE  
RETIREMENT PLAN RECEIPTS

A handwritten signature in black ink, appearing to be 'Anny', written over the word 'RECEIPTS'.

MIRVAC HOLDINGS (NSW) PTY LTD ACN 006 522 993 ABN 23 006 522 993 A Member of The Mirvac Group  
Suite 205 Level 2 30 Cooper Street Parramatta NSW 2150 Tel 61 2 9893 8800 Fax 61 2 9893 8844  
www.mirvac.com.au

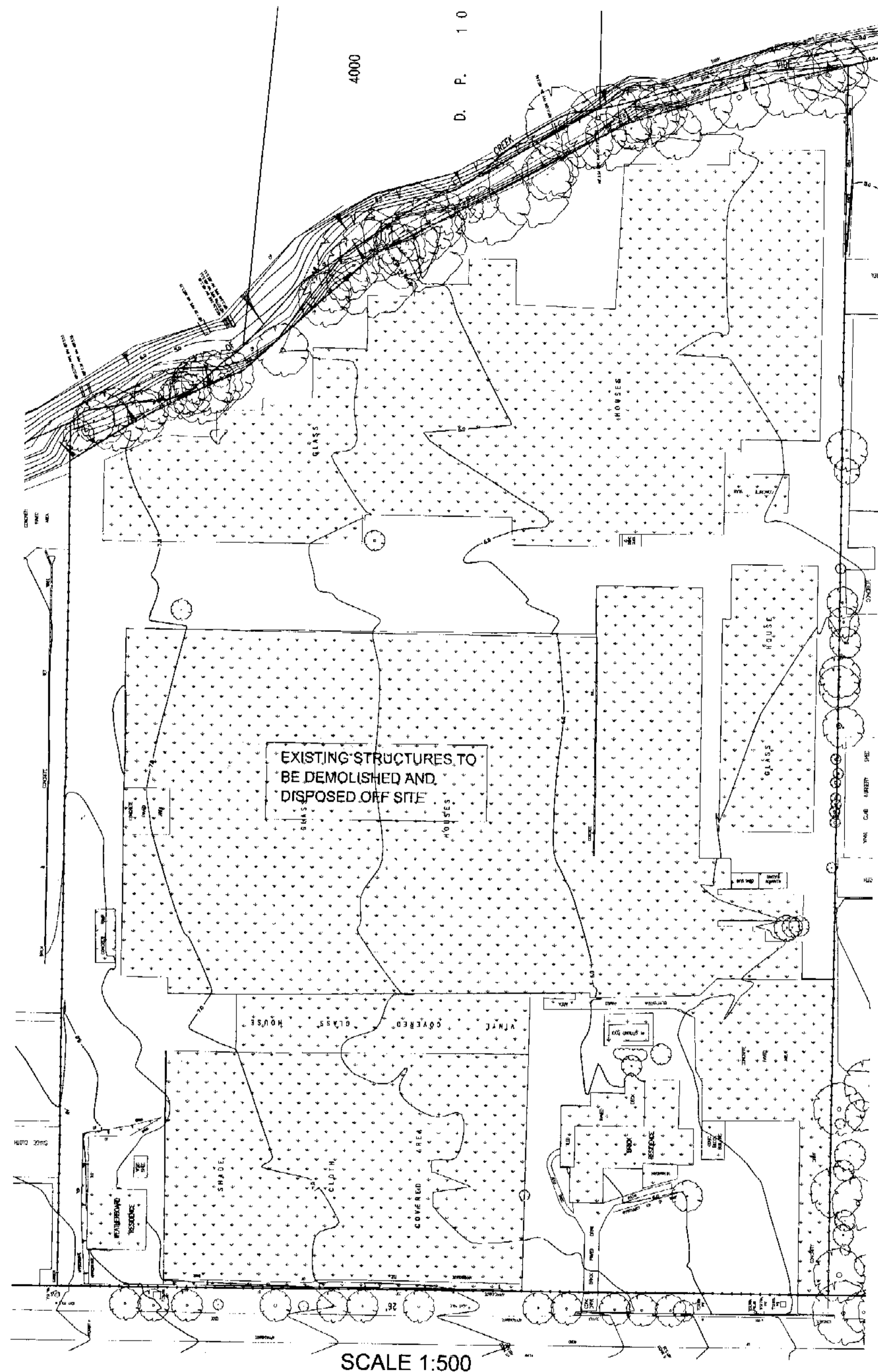

# PROPOSED RESIDENTIAL DEVELOPMENT Macpherson Street Warriewood

## SEDIMENT AND EROSION CONTROL

1. THE CONTRACTOR SHALL IMPLEMENT ALL SOIL AND SEDIMENT CONTROL MEASURES PRIOR TO DISTURBANCE OF THE RELATED CATCHMENT AREA AND TO THE STANDARDS OF N.S.W DEPARTMENT OF HOUSING MANAGING STORMWATER "SOILS AND CONSTRUCTION 3rd EDITION AUGUST 1998"
2. THE CONTRACTOR SHALL REGULARLY MAINTAIN ALL SEDIMENT AND EROSION CONTROL DEVICES BEFORE NO MORE THAN 80% OF THEIR CAPACITY IS LOST. ALL THE SILT REMOVED SHALL BE DISPOSED OF AS DIRECTED BY THE SUPERINTENDENT. NO SILT IS TO BE PLACED OUTSIDE THE LIMIT OF WORKS. THE PERIOD FOR MAINTAINING THESE DEVICES SHALL BE AT LEAST UNTIL ALL DISTURBED AREAS ARE REVEGETATED AND FURTHER AS MAY BE DIRECTED BY THE SUPERINTENDENT OR COUNCIL.

3. THE CONTRACTOR SHALL PROVIDE SAND BAGS OR SEDIMENT TRAPS AT 20m CTS ACROSS EACH ROAD GUTTERS AT COMPLETION OF FOOTPATH FORMATION. TO AVOID SEDIMENT LOSS FROM THE ROAD AND FOOTPATH AREAS.

## GENERAL NOTES

1. PEDESTRIAN ACCESS SHALL BE CONTROLLED DURING CONSTRUCTION CONFINING ACCESS FOOTWAYS EXTERNAL TO THE SITE BOUNDARY.
2. VEHICULAR TRAFFIC SHALL BE CONTROLLED DURING CONSTRUCTION CONFINING ACCESS WHERE POSSIBLE TO PROPOSED OR EXISTING ROAD ALIGNMENTS.

## WASTE CONTROL

1. THE CONTRACTOR TO BE RESPONSIBLE FOR WASTE DISPOSAL OFF SITE.
2. ALL BUILDING PRODUCTS AND CLEARED VEGETATION TO BE REMOVED OFF SITE IN AN APPROVED MANNER TO LICENCED LAND FILL SITE.
3. EQUIPMENT MAINTAINANCE AND REFUELLING OF CONSTRUCTION VEHICLES TO BE DONE IN A DESIGNATED AREA USING BUNDING AND BEST PRACTICE MANAGEMENT CONTROLS FOR REFUELLING.
4. ALL SPILLS TO BE CONTAINED AND CLEARED UP IMMEDIATELY.

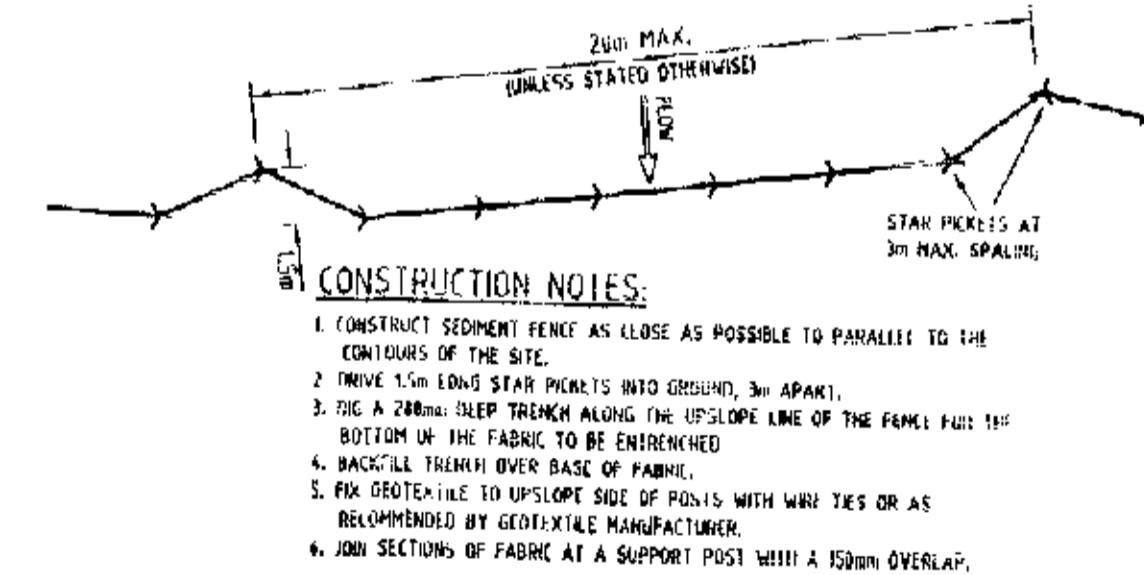
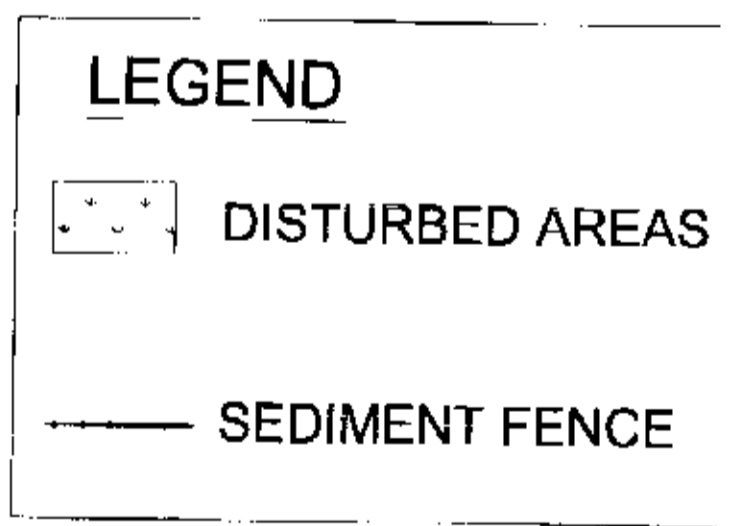
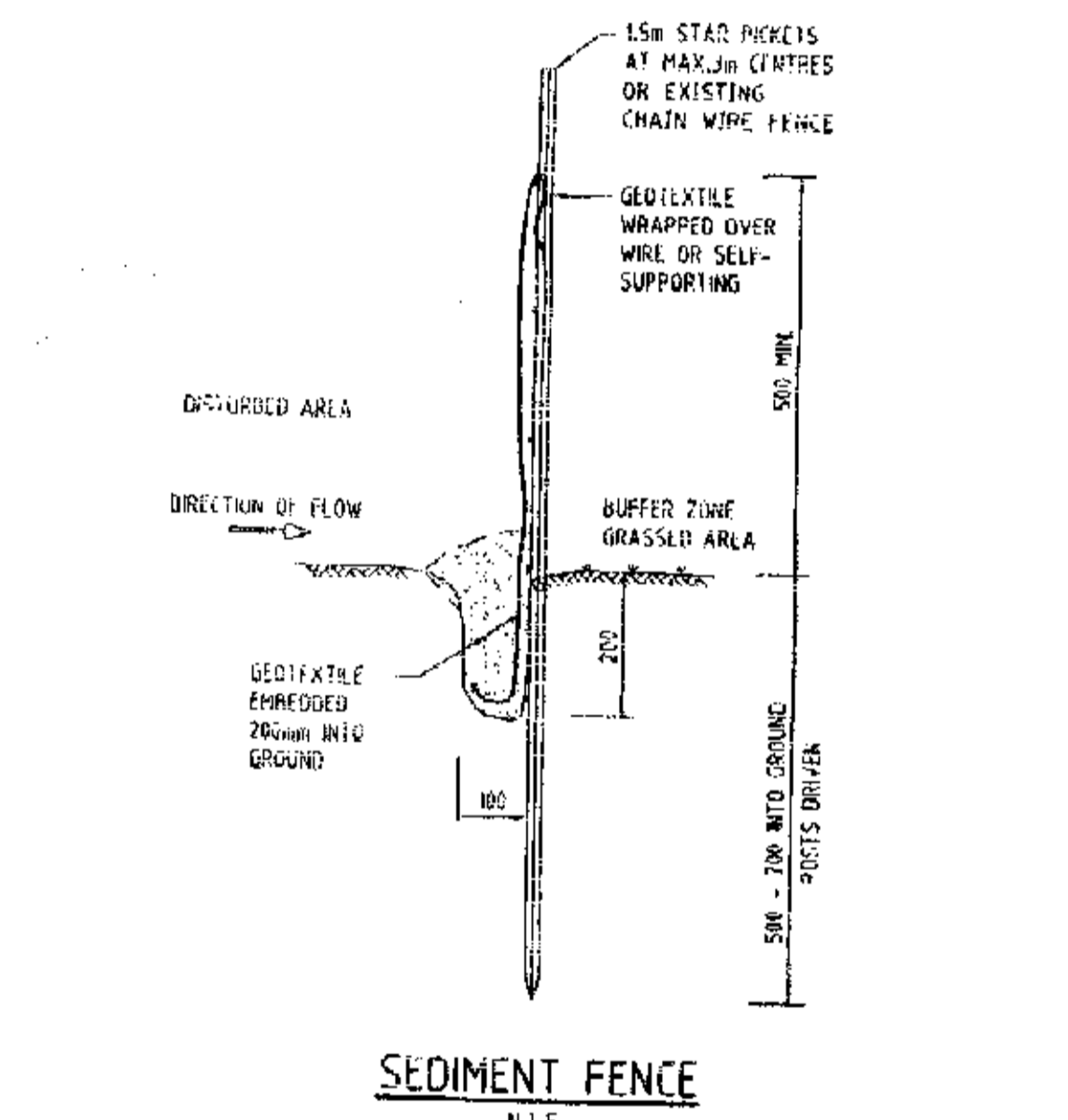

- CONSTRUCTION NOTES:**
1. CONSTRUCT SEDIMENT FENCE AS CLOSE AS POSSIBLE TO PARALLEL TO THE BOUNDARIES OF THE SITE.
  2. MOVE 1.5m LONG STAR PICKETS INTO GROUND, 3m APART.
  3. USE A 200mm DEEP TRENCH ALONG THE UPSLOPE LINE OF THE FENCE AND THE BOTTOM OF THE TRENCH TO BE ENDEMICATED.
  4. BACKFILL TRENCH OVER BASE OF FABRIC.
  5. FOR GEO-TEXTILE TO UPSLOPE SIDE OF PICKETS WITH WIRE TIES OR AS RECOMMENDED BY GEO-TEXTILE MANUFACTURER.
  6. JOIN SECTIONS OF FABRIC AT A SUPPORT POST WITH A 150mm OVERLAP.

SCANNED  
10 OCT 2005  
PITTSWATER COUNCIL

NO.	DATE	ISSUE FOR DA	REVISION	A
18.05.02				

Level 2, 30 Cooper Street Parramatta  
N.S.W. 2060 Australia  
Tel: 9933-8800  
Fax: 9933-8844  
HWA Pty Ltd - Sydney, Melbourne  
Victoria, Perth  
a member of the HWA Group  
ACN 933 301 153



Demolition Plan  
Showing building and structures to be demolished  
SCALE: varies DATE: JUN 05 DRAWN: NW  
JOB No.: XXX DRG No.: 002 ISSUE: A