

SITE PLAN

12 GOODWIN RD, NEWPORT

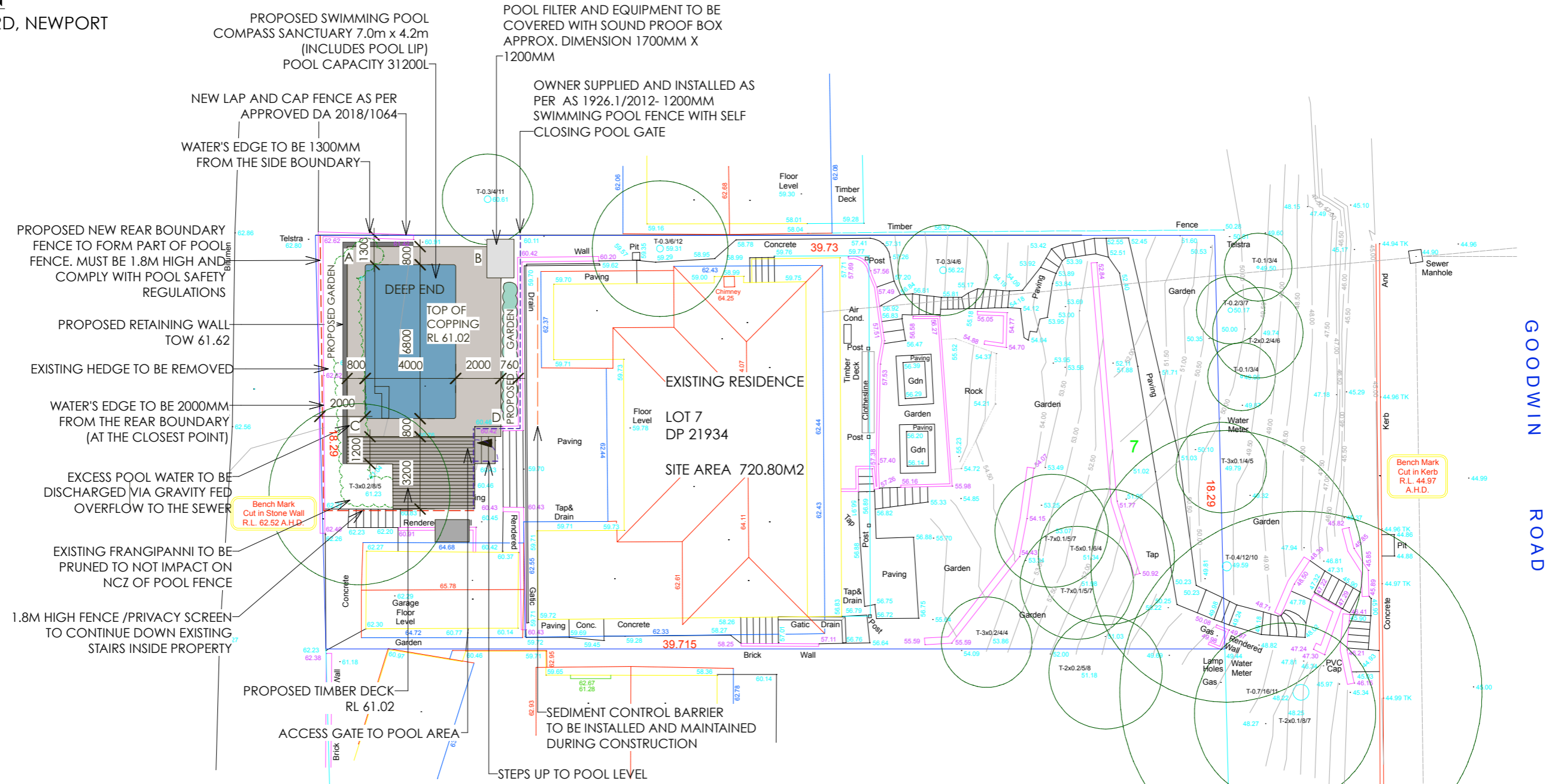

SITE CALCULATIONS

Total site area= 720.80m²
 (Landscape requirement- 60% of lot size=432.50m²)
 (minus 6% (43.25m²) as permitted for variations for impervious landscape treatments)= 389.25m²
 Total existing hard space =254m²
 (includes house, driveway, deck, garage paths.)
 Percentage (%) of existing hard space= 35.20%
 Existing hard surface to be removed= nil
 Proposed new (hard surface) works=70m²
 (including pool, surrounds and area less than 1.0m wide)
 Total new hard space
 (including proposed works)=324m²
 Total landscape area=396.80m² (required= 389.25m²)

NOTES AND SPECIFICATIONS

POOL AND POOL FENCING
 Installation of pool shell and surrounds to be done in accordance with manufacturers specifications and details
 Installation of pool fencing to be in accordance with The Swimming Pools Act 1992 and AS 1926- the pool fence shall be not less than 1.2m all the way around with a self closing gate.
 No ancillary structures not immediately associated with the swimming pool, must be kept within the pool fenced area
 It is the property owner's responsibility to ensure the fence is maintained and the self closing pool gate is in good working order

SITE NOTES

DIMENSIONS AND LEVELS- UNLESS A CURRENT FULL SITE SURVEY HAS BEEN PROVIDED, DIMENSIONS AND MEASUREMENTS ARE INDICATIVE ONLY, AND MUST BE CONFIRMED ON SITE. MINOR ALTERATIONS MAY BE REQUIRED DEPENDING ON SITE VARIATIONS

POOL FILTER EQUIPMENT- MUST BE LOCATED WITHIN SIX (6) METRES OF THE SWIMMING POOL AND MUST BE COVERED IN A SOUND PROOF BOX

EXISTING GROUND LEVELS

A- EGL-61.40
 B- EGL- 60.50
 C-EGL- 61.30
 D-EGL- 60.42

DETAIL 1 OF 1- SEDIMENT AND EROSION CONTROL BARRIER SCALE 1:25

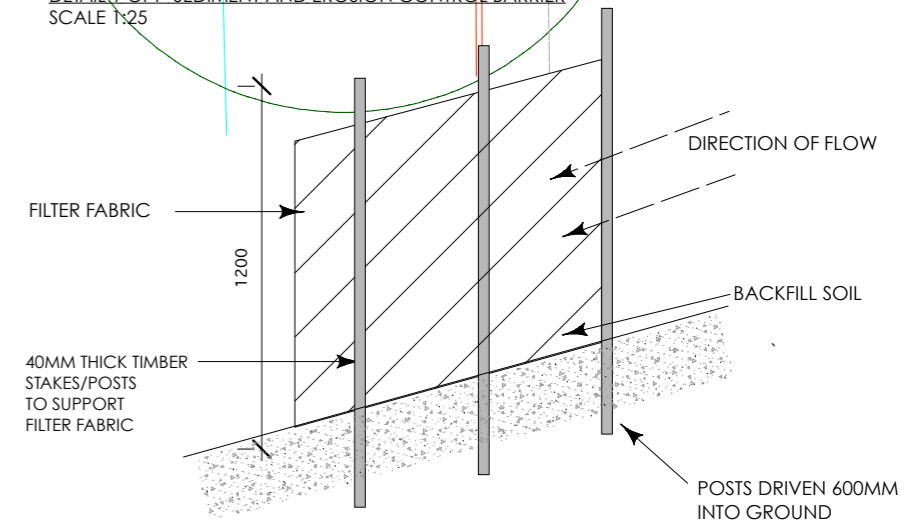

LANDSCAPER DESIGNER
LANDSCAPE DESIGN BY JACQUI RAY
 PO Box 844, ST IVES, 2075
 M: 0417680228 F: 43771433 E: jacqui@jacquiray.com.au



NOTES
 1. Drawing not suitable for construction purposes.
 2. Do not scale from drawings- use written dimensions only.
 3. Contractor to verify location of all pipes and services prior to starting Works.
 4. All Works to be carried out in accordance with the BCA.
 5. DA approved plans are required to be constructed as approved to obtain occupancy certificate.
 6. Plans are protected by Copyright Laws. No plan or part thereof may be used, copied or reproduced in any way without the prior written permission of Dig This

PROJECT
 SWIMMING POOL AND SURROUNDS
LOCATION
 MAY RESIDENCE
 12 GOODWIN RD
 NEWPORT

DRAWN
 JR
TITLE
 SITE PLAN

SCALE
 1:200@A3

DATE
 7/2/20

DWG NO
 1 of 2

REV
 D

SECTION/ELEVATION PLAN

12 GOODWIN RD, NEWPORT

SOUTHERN SECTION/ELEVATION

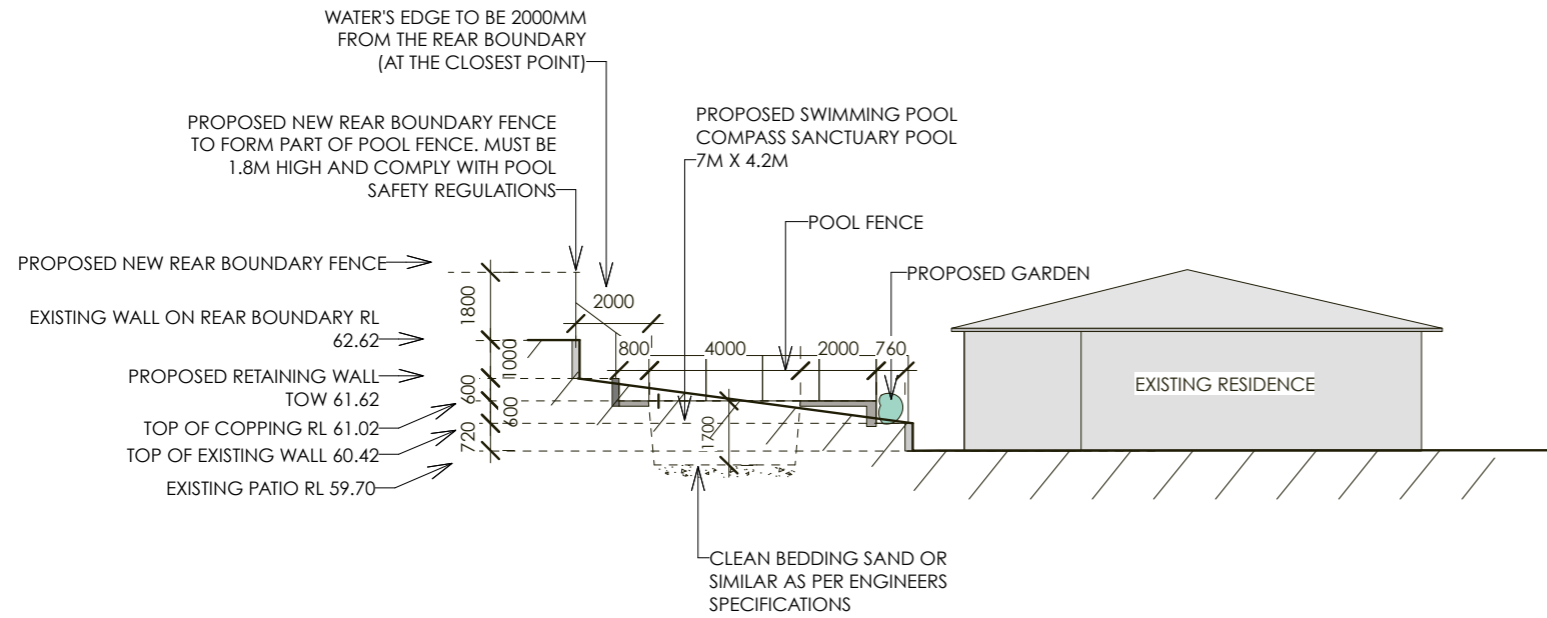

NORTHERN SECTION/ELEVATION

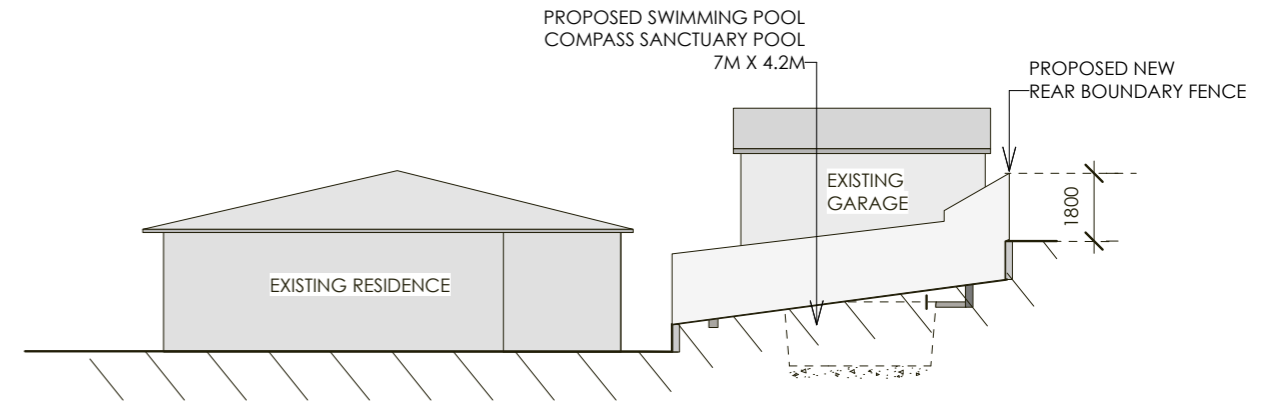

EASTERN SECTION/ELEVATION

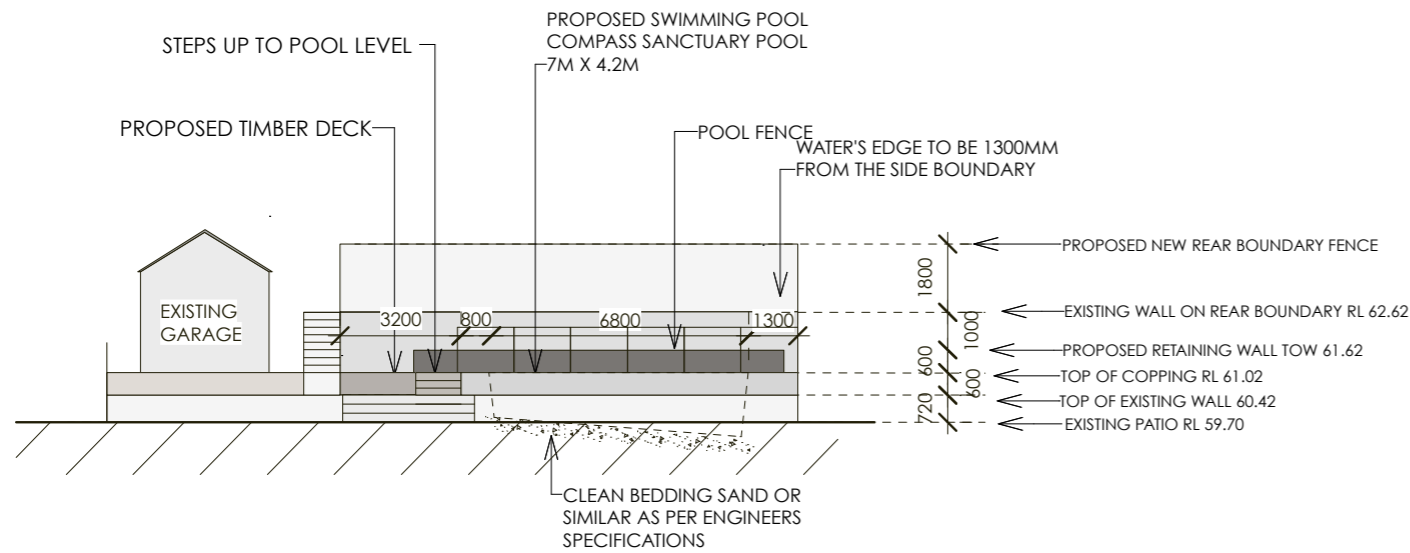

WESTERN SECTION/ELEVATION

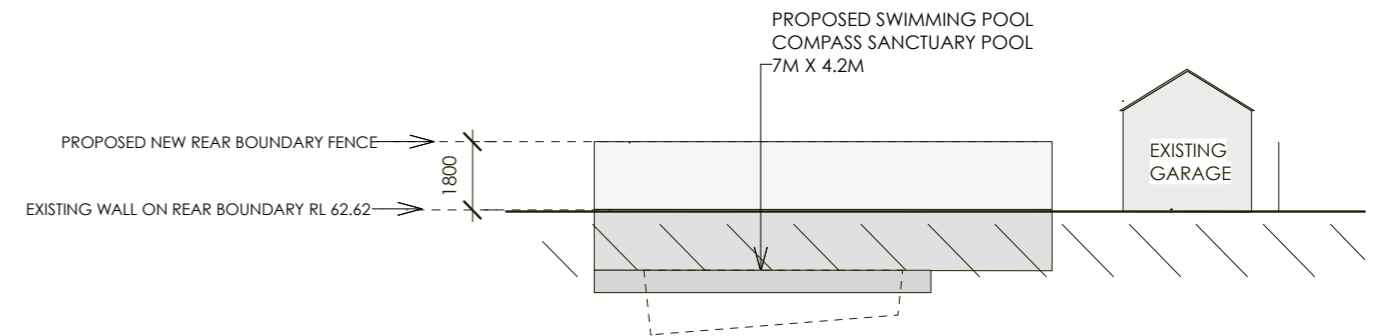

LANDSCAPER DESIGNER LANDSCAPE DESIGN BY JACQUI RAY PO Box 844, ST IVES, 2075 M: 0417680228 F: 43771433 E: jacqui@jacquiray.com.au	NOTES 1. Drawing not suitable for construction purposes. 2. Do not scale from drawings- use written dimensions only. 3. Contractor to verify location of all pipes and services prior to starting Works. 4. All Works to be carried out in accordance with the BCA. 5. DA approved plans are required to be constructed as approved to obtain occupancy certificate. 6. Plans are protected by Copyright Laws. No plan or part thereof may be used, copied or reproduced in any way without the prior written permission of Dig This	PROJECT SWIMMING POOL AND SURROUNDS LOCATION MAY RESIDENCE 12 GOODWIN RD NEWPORT	DRAWN JR	SCALE 1:200@A3	DATE 7/2/20	DWG NO 2 OF 2	REV D
			TITLE SITE PLAN				