

DuPlessis Architects - Feb 2019 - drawing instruction for DA Compliant Massing Envelope

CERTIFIED PHOTOMONTAGE
No : PMC156603- Refer to attached Certificate.

Certifier: Cameron McFadzean B Arch BA (Arch) IES ABSA AAAI

NOTE:

Photomontage perspective based on camera data, Laser Survey position and survey photomatch - Existing.

Camera Data:

Daylight: 7/09/18 NOON

Lens: (35mm efl) 24mm lens, Level Target.

No.10 CLIFFORD AV

P 01 Level 4 MASTER BED

P02 LEVEL 3 KITCHEN / LIVING

P02.1 REAR of BALCONY

P02.2 FRONT of BALCONY

P02.3 LIVING - Standing

P02.4 LIVING - Seated

P03 LEVEL 2 FAMILY

P03.1 FAMILY BALCONY

P03.2 FAMILY ROOM - Standing

P04 Level 1 BEDROOM

No.12 CLIFFORD AV

P 05 BALCONY

NOTE 2: MASSING ENVELOPE

DA Compliant Massing Envelope model (RED) has been shown in overlay with the Proposed DA Design as per DuPlessis Architects drawing set.

TITLE
PHOTOMONTAGE VIEW ANALYSIS
WITH DA MASSING ENVELOPE

DA COMPLIANT MASSING

PROJECT

PROPOSED ALTERATIONS AND ADDITIONS
CLIFFORD AVE
FAIRLIGHT NSW

CLIENT: George & Tatiana Opadchy

DESIGNER

DU PLESSIS
DU PLESSIS ARCHITECTS

h@droom.com.au
0433408368
www.droom.com.au

DATA SOURCE (In order of precedence)

- Registered Survey - [True North Surveys, Ref 8732, 23/11/17.](#)
- Architectural Plans - (3D Data) [DuPlessis Ref 07.11.18, \(Ver B NOV.18\)](#)

PAGE : P 01
DATE : 27.02.19
VERSION : 03
REF : 1566

dj
denebdesign

3D SHADOW DIAGRAMS /
VISUALISATION + ANALYSIS
DENEB DESIGN
02 9997 7480
info@denebdesign.com.au
www.denebdesign.com.au

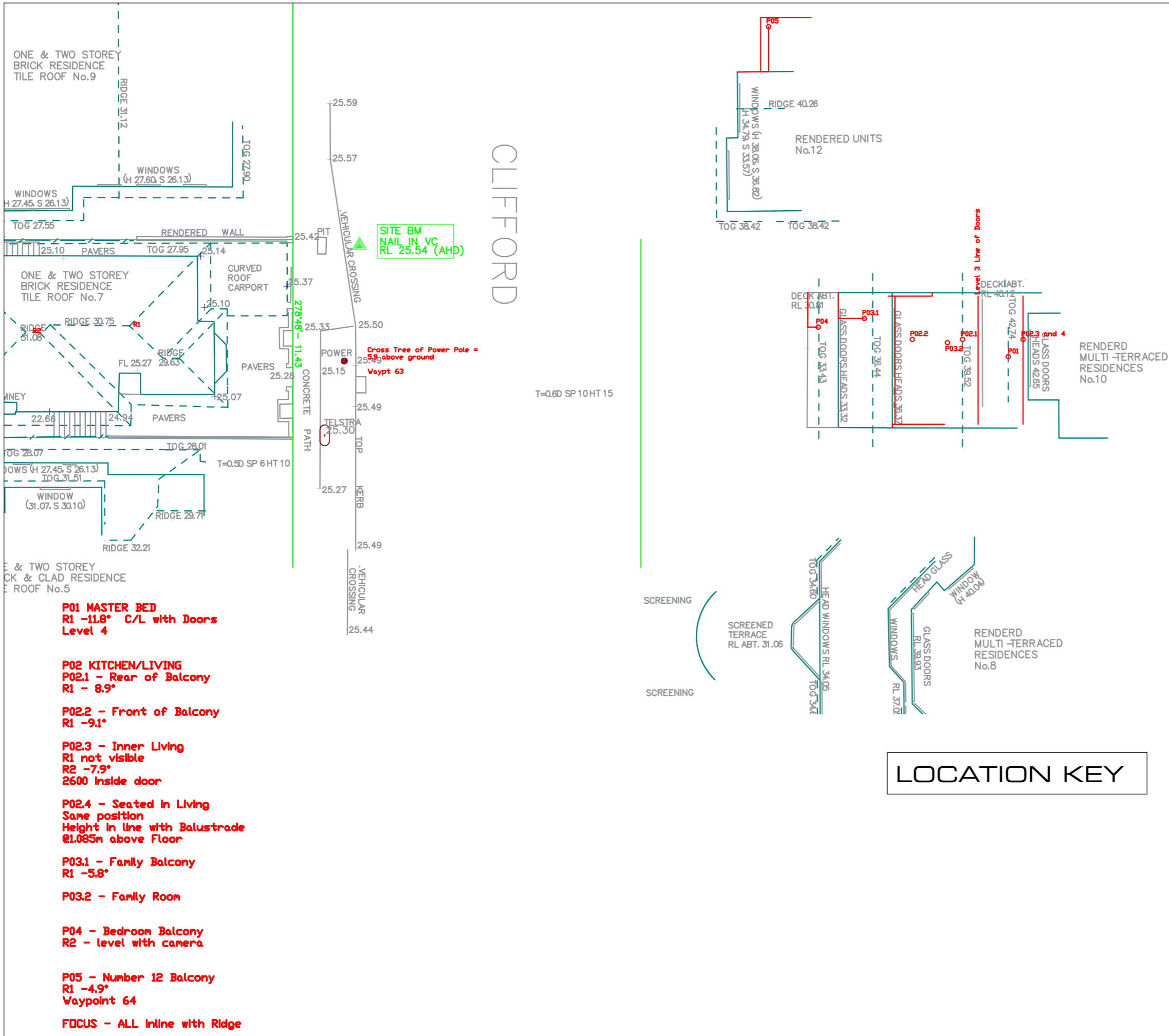

CERTIFIED PHOTOMONTAGE No : PMC156603- Refer to attached Certificate. Certifier: Cameron McFadzean B Arch BA (Arch) IES ABSA AAAI	
NOTE: Photomontage perspective based on camera data, Laser Survey position and survey photomatch - Existing. Camera Data: Daylight: 7/09/18 NOON Lens: (35mm efl) 24mm lens, Level Target.	
No.10 CLIFFORD AV P 01 Level 4 MASTER BED P02 LEVEL 3 KITCHEN / LIVING P02.1 REAR of BALCONY P02.2 FRONT of BALCONY P02.3 LIVING - Standing P02.4 LIVING - Seated P03 LEVEL 2 FAMILY P03.1 FAMILY BALCONY P03.2 FAMILY ROOM - Standing P04 Level 1 BEDROOM	
No.12 CLIFFORD AV P 05 BALCONY	
TITLE PHOTOMONTAGE VIEW ANALYSIS WITH DA MASSING ENVELOPE	
CAMERA POSITION KEY	
PROJECT PROPOSED ALTERATIONS AND ADDITIONS CLIFFORD AVE FAIRLIGHT NSW	
CLIENT: George & Tatiana Opadchy	
DESIGNER DU PLESSIS ARCHITECTS h@droom.com.au 0433408368 www.droom.com.au	
DATA SOURCE (In order of precedence) • Registered Survey - True North Surveys, Ref 8732, 23/11/17. • Architectural Plans - (3D Data) DuPlessis Ref 07.11.18, (Ver B NOV.18)	
PAGE : P 02 DATE : 27.02.19 VERSION : 03 REF : 1566	3D SHADOW DIAGRAMS / VISUALISATION + ANALYSIS DENEB DESIGN 02 9997 7480 info@denebdesign.com.au www.denebdesign.com.au



CERTIFIED PHOTOMONTAGE
No : PMC156603- Refer to attached Certificate.
Certifier: Cameron McFadzean B Arch BA (Arch) IES ABSA AAAI

NOTE:
Photomontage perspective based on camera data, Laser Survey position and survey photomatch - Existing.
Camera Data:
Daylight: 7/09/18 NOON
Lens: (35mm efl) 24mm lens, Level Target.

No. 10 CLIFFORD AVE
LEVEL 4 MASTER BED

3D PROOF

CAMERA LOCATION

TITLE
PHOTOMONTAGE VIEW ANALYSIS
WITH DA MASSING ENVELOPE

PO3.2 - Level 2 FAMILY ROOM
No. 10 CLIFFORD AVE

PROJECT
PROPOSED ALTERATIONS AND ADDITIONS
CLIFFORD AVE
FAIRLIGHT NSW
CLIENT: George & Tatiana Opadchy

DESIGNER

+

DU PLESSIS
DU PLESSIS ARCHITECTS

h@droom.com.au
0433408368
www.droom.com.au

DATA SOURCE (In order of precedence)

- Registered Survey - [True North Surveys, Ref 8732, 23/11/17.](#)
- Architectural Plans - (3D Data) [DuPlessis Ref 07.11.18, \(Ver B NOV.18\)](#)

PAGE : P 06
DATE : 27.02.19
VERSION : 03
REF : 1566

dj

denebdesign

3D SHADOW DIAGRAMS /
VISUALISATION + ANALYSIS
DENEB DESIGN
02 9997 7480
info@denebdesign.com.au
www.denebdesign.com.au



<div>CERTIFIED PHOTOMONTAGE No : PMC156603- Refer to attached Certificate. Certifier: Cameron McFadzean B Arch BA (Arch) IES ABSA AAAI</div>	
<div>NOTE: Photomontage perspective based on camera data, Laser Survey position and survey photomatch - Existing. Camera Data: Daylight: 7/09/18 NOON Lens: (35mm efl) 24mm lens, Level Target.</div>	
<div>No.10 CLIFFORD AV P 01 Level 4 MASTER BED P02 LEVEL 3 KITCHEN / LIVING P02.1 REAR of BALCONY P02.2 FRONT of BALCONY P02.3 LIVING - Standing P02.4 LIVING - Seated P03 LEVEL 2 FAMILY P03.1 FAMILY BALCONY P03.2 FAMILY ROOM - Standing P04 Level 1 BEDROOM</div>	
<div>No.12 CLIFFORD AV P 05 BALCONY</div>	
<div>3D PROOF</div> <div></div>	
<div>TITLE PHOTOMONTAGE VIEW ANALYSIS WITH DA MASSING ENVELOPE</div>	
<div>P04 - Level 1 BEDROOM No. 10 CLIFFORD AVE</div>	
<div>PROJECT PROPOSED ALTERATIONS AND ADDITIONS CLIFFORD AVE FAIRLIGHT NSW CLIENT: <u>George & Tatiana Opadchy</u></div>	
<div>DESIGNER <div><div><div><div></div></div><div><div>DU PLESSIS</div><div>DU PLESSIS ARCHITECTS</div></div></div><div><div>h@droom.com.au</div><div>0433408368</div><div>www.droom.com.au</div></div></div></div>	
<div>DATA SOURCE (In order of precedence) • Registered Survey - <u>True North Surveys, Ref 8732, 23/11/17.</u> • Architectural Plans - (3D Data) <u>DuPlessis Ref 07.11.18, (Ver B NOV.18)</u></div>	
<div>PAGE : P 07 DATE : 27.02.19 VERSION : 03 REF : 1566</div>	<div><div><div><div></div></div><div><div>dj</div><div>denebdesign</div></div></div><div><div>3D SHADOW DIAGRAMS / VISUALISATION + ANALYSIS</div><div>DENEB DESIGN</div><div>02 9997 7480</div><div>info@denebdesign.com.au</div><div>www.denebdesign.com.au</div></div></div>



CERTIFIED PHOTOMONTAGE
No : PMC156603- Refer to attached Certificate.
Certifier: Cameron McFadzean B Arch BA (Arch) IES ABSA AAAI

NOTE:
Photomontage perspective based on camera data, Laser Survey position and survey photomatch - Existing.
Camera Data:
Daylight: 7/09/18 NOON
Lens: (35mm efl) 24mm lens, Level Target.

No. 10 CLIFFORD AVE
P05
LEVEL 4 MASTER BED

3D PROOF

CAMERA LOCATION

TITLE
PHOTOMONTAGE VIEW ANALYSIS
WITH DA MASSING ENVELOPE

P05 - BALCONY
No. 12 CLIFFORD AVE

PROJECT
PROPOSED ALTERATIONS AND ADDITIONS
CLIFFORD AVE
FAIRLIGHT NSW

CLIENT: George & Tatiana Opadchy

DESIGNER

+

DU PLESSIS

DU PLESSIS ARCHITECTS

h@droom.com.au
0433408368
www.droom.com.au

DATA SOURCE (In order of precedence)

- Registered Survey - True North Surveys, Ref 8732, 23/11/17.
- Architectural Plans - (3D Data) DuPlessis Ref 07.11.18, (Ver B NOV.18)

PAGE : P 08
DATE : 27.02.19
VERSION : 03
REF : 1566

dj

denebdesign

3D SHADOW DIAGRAMS /
VISUALISATION + ANALYSIS
DENEB DESIGN
02 9997 7480
info@denebdesign.com.au
www.denebdesign.com.au