

BUENAVISTA
home designs

Living the dream.

NO.	HEIGHT	NAME
1	136.00	
2	136.00	
3	136.00	
4	136.00	
5	136.00	
6	136.00	
7	136.00	
8	136.00	
9	136.00	
10	136.00	
11	136.00	
12	136.00	
13	136.00	
14	136.00	
15	136.00	
16	136.00	
17	136.00	
18	136.00	
19	136.00	
20	136.00	

- LEGEND**
- Symbol for boundary
 - Symbol for fence
 - Symbol for sewer
 - Symbol for water
 - Symbol for earth & grass
 - Symbol for concrete
 - Symbol for paving
 - Symbol for landscaping
 - Symbol for pool
 - Symbol for platform level



DETAIL 1: BUILDING MATERIAL STOCKPILES
 MUST BE PROTECTED BY PERIMETER FENCE AND GROUND SHOULD NEVER BE PLACED IN OFFER

DETAIL 2: SEDIMENT FENCES
 TO FILTER AND POOL SEDIMENT-LADEN WATER TO BE USED ON THE LOW SIDE OF THE SITE TO STOP SOIL FROM ENTERING ADJACENT PLOTS WILL BE PROVIDED OFF-SITE AND OFFERED OUT

DETAIL 3: GEOTEXTILE SAUSAGE
 IS USED ON ROAD SURFACES FOR SOIL FILTRATION AND POOLING OF RUN-OFF MUST BE TO BE CORRECTLY POSITIONED AND IN GOOD CONDITION



LOT B
 D.P.327134

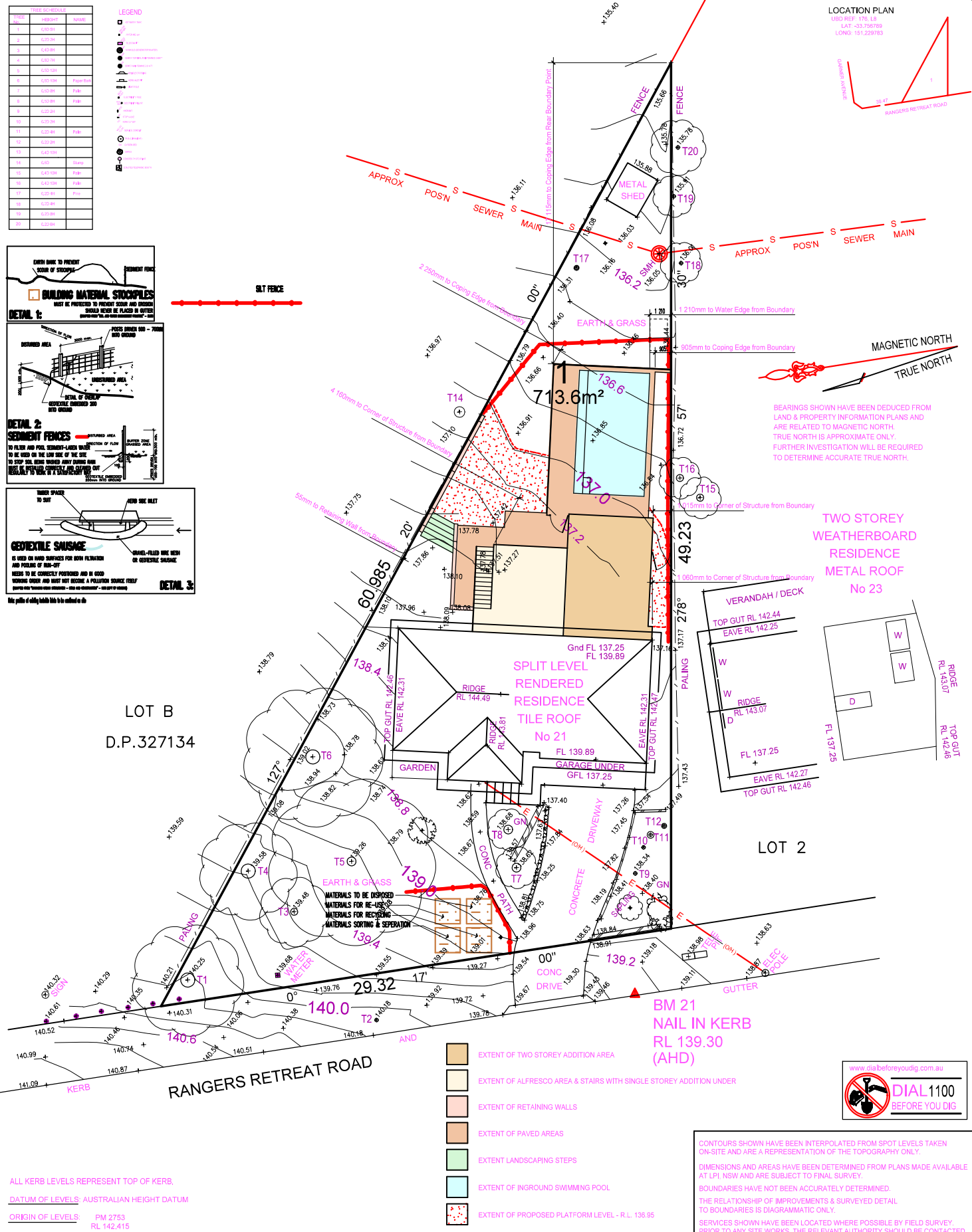

- EXTENT OF TWO STOREY ADDITION AREA
- EXTENT OF ALFRESCO AREA & STAIRS WITH SINGLE STOREY ADDITION UNDER
- EXTENT OF RETAINING WALLS
- EXTENT OF PAVED AREAS
- EXTENT LANDSCAPING STEPS
- EXTENT OF INGROUND SWIMMING POOL
- EXTENT OF PROPOSED PLATFORM LEVEL - R.L. 136.95

ALL KERB LEVELS REPRESENT TOP OF KERB.
 DATUM OF LEVELS: AUSTRALIAN HEIGHT DATUM
 ORIGIN OF LEVELS: PM 2753 RL 142.415
 SOURCE OF LEVELS: SCIMS

PROPOSED SITE PLAN

CONTOURS SHOWN HAVE BEEN INTERPOLATED FROM SPOT LEVELS TAKEN ON-SITE AND ARE A REPRESENTATION OF THE TOPOGRAPHY ONLY.
 DIMENSIONS AND AREAS HAVE BEEN DETERMINED FROM PLANS MADE AVAILABLE AT LPI, NSW AND ARE SUBJECT TO FINAL SURVEY.
 BOUNDARIES HAVE NOT BEEN ACCURATELY DETERMINED. THE RELATIONSHIP OF IMPROVEMENTS & SURVEYED DETAIL TO BOUNDARIES IS DIAGRAMMATIC ONLY.
 SERVICES SHOWN HAVE BEEN LOCATED WHERE POSSIBLE BY FIELD SURVEY. PRIOR TO ANY SITE WORKS, THE RELEVANT AUTHORITY SHOULD BE CONTACTED TO ESTABLISH ACCURATE POSITION AND DEPTH OF ANY SERVICES.
 DIMENSIONS OF ANY TREES SHOWN ON THE PLAN ARE APPROXIMATE.



PROPOSED SITE PLAN

Living the dream.

BUENA VISTA HOME DESIGNS / R/H DESIGN
 35 BRISBANE AVENUE, MT KIRING-GAI NSW 2080
 PH 9457 9303 MOB: 0411 758 479
 email: rod_buenvista@optusnet.com.au

ISSUE REVISION	ISSUE DATE	ISSUED FOR	ISSUED BY
A	2/5/19	Concept Drawings	RH
B	23/6/19	Development Application Drawings	RH

STRUCTERRE consulting
 REGISTERED SURVEYORS & LAND INFORMATION CONSULTANTS

Suite 1, Level 2, 42 Birnie Avenue Lidcombe, NSW 2141
 Phone: 9548 5811, Fax: 9548 2311
 Email: nswsurveying@structerre.com.au
 www.structerre.com.au

DRAWN: C.H JOB: 1778/324535 DATE: 27.03.2019
 CHECKED: GD FILE NAME: 324535 DATUM: AHD

PROPOSED ALTERATIONS AND ADDITIONS TO RESIDENCE AT:
 21 RANGERS RETREAT ROAD
 FRENCHS FOREST NSW 2086

FOR:
 MR & MRS MILES

Scale: 1:100 @ A Date: APRIL 2019
 Drawn by: Rodney Hill Drawing/Job No.: 0687/19 Revision Issue: B
 Sheet No: DA - 02

LOT 1 DP 205274

COPYRIGHT
 This plan is the exclusive property of Buena Vista Home Design and must not be used, reproduced or copied in any way of form without written permission.

BUENA VISTA
 home designs

Finished ground levels on the plan are subject to the site conditions. Do not scale from drawings. Paved dimensions are to be given preference over all figured dimensions are to be checked on site.