



**LEGEND**

-  LIMIT OF WORKS BOUNDARY
-  EXISTING TREES TO BE REMOVED AT DIRECTION OF SUPERINTENDENT
-  EXISTING TREES TO BE RETAINED

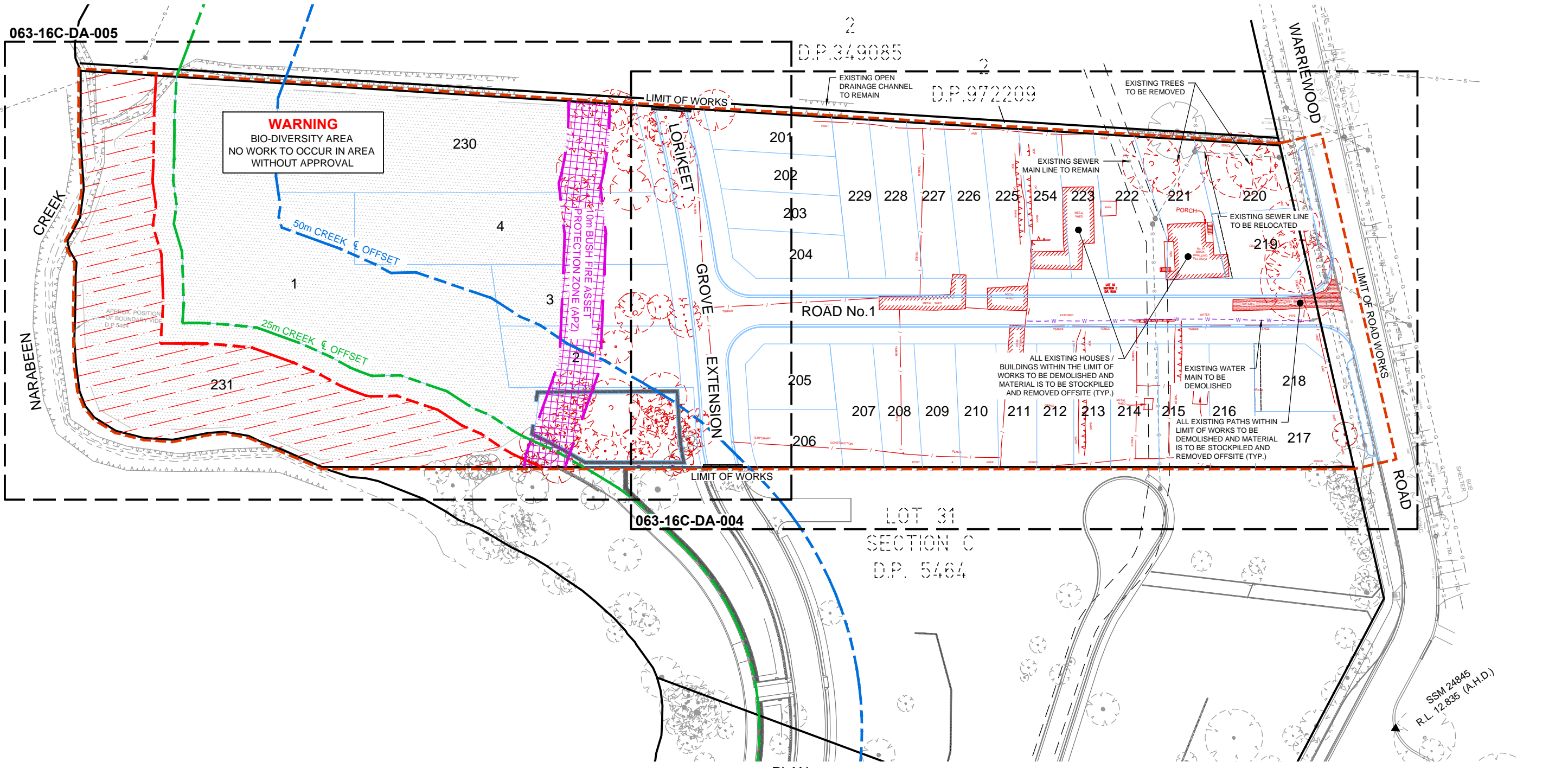

PLAN  
1:500

DEVELOPMENT APPLICATION

REV	DATE	AMENDMENT DESCRIPTION
A	20.10.16	ISSUED FOR DEVELOPMENT APPLICATION



Project: **PROPOSED SUBDIVISION OF LOT 32 SECTION C D.P.5464 CIVIL AND SUBDIVISION WORKS**

Principal: <b>WOOLWICH PTY. LTD.</b>	
Scale: 1:500	Date: 20.10.16
Datum: AHD	Council Ref: D.P.5464
L.G.A. NORTHERN BEACHES	
Calc's: D.Y.	Drawn: E.F.
Proj.Man: A.M.	Client Ref:



ABN 77 050 209 991  
Level 4, Suite 400  
16-18 Cambridge St  
EPPING NSW 2121  
PO Box 233  
EPPING NSW 1710

ACN 050 209 991  
DX 4408 EPPING  
Tel. 9969-1855  
Fax. 9969-2341  
reception@craigandrhodes.com.au  
www.craigandrhodes.com.au  
© Craig & Rhodes



Drawing Title: <b>SITE PLAN AND DEMOLITION PLAN</b>	Revision: <b>A</b>
C&R Ref: 063-16	Drawing Ref: 063-16C-DA-003