

NOTES AND SPECIFICATIONS
POOL AND POOL FENCING
 Installation of pool shell and surrounds to be done in accordance with manufacturers specifications and details.
 Installation of pool fencing to be in accordance with The Swimming Pools Act 1992 and AS 1926- the pool fence shall be not less than 1.2m all the way around with a self closing gate.
 No ancillary structures not immediately associated with the swimming pool, must be kept within the pool/fenced area.
 It is the property owner's responsibility to ensure the fence is maintained and the self closing pool gate is in good working order.

BASIC REQUIREMENTS
SWIMMING POOL
 - MUST HAVE A POOL COVER
 - MUST INSTALL A POOL PUMP TIMER FOR THE SWIMMING POOL
 - MUST INSTALL A WATER TANK WITH A MINIMUM CAPACITY OF 130 LITRES
 - MUST INSTALL THE FOLLOWING HEATING SYSTEM FOR THE SWIMMING POOL THAT IS PART OF THIS DEVELOPMENT- GAS

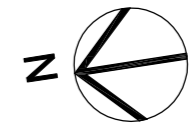

MACTIER STREET

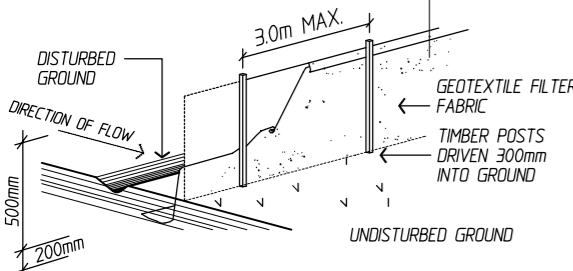
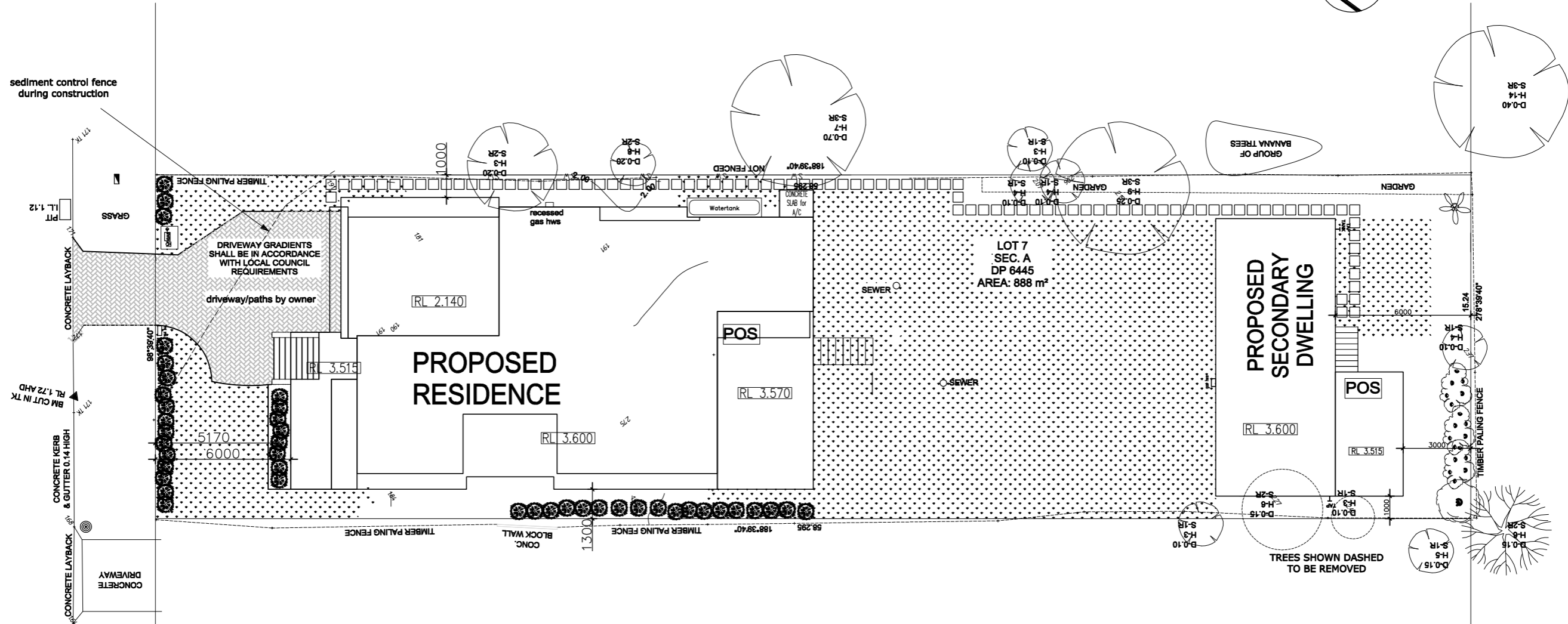

SEDIMENT FENCE
N.T.S

- SEDIMENT CONTROL NOTES**
1. ALL EROSION AND SEDIMENTATION CONTROL MEASURES, INCLUDING REVEGETATION AND STORAGE OF SOIL AND TOPSOIL, SHALL BE IMPLEMENTED TO THE STANDARDS OF THE SOIL CONSERVATION OF NSW.
 2. ALL DRAINAGE WORKS SHALL BE CONSTRUCTED AND STABILISED AS EARLY AS POSSIBLE DURING DEVELOPMENT.
 3. SEDIMENT TRAPS SHALL BE CONSTRUCTED AROUND ALL INLET PITS, CONSISTING OF 300mm WIDE X 300mm DEEP TRENCH.
 4. ALL SEDIMENT BASINS AND TRAPS SHALL BE CLEANED WHEN THE STRUCTURES ARE A 60% FULL OF SOIL MATERIALS, INCLUDING THE MAINTENANCE PERIOD.
 5. ALL DISTURBED AREAS SHALL BE REVEGETATED AS SOON AS THE RELEVANT WORKS ARE COMPLETED.
 6. SOIL AND TOPSOIL STOCKPILES SHALL BE LOCATED AWAY FROM DRAINAGE LINES AND AREA WHERE WATER MAY CONCENTRATE.
 7. FILTER SHALL BE CONSTRUCTED BY STRETCHING A FILTER FABRIC (PROPEX OR APPROVED EQUIVALENT BETWEEN POST AT 3.0m CENTRES. FABRIC SHALL BE BURIED 150mm ALONG ITS LOWER EDGE.

NOTES

WEEDS
 REMOVE ALL WEEDS PRIOR TO PLANTING WITH NON-RESIDUAL GLYPHOSATE HERBICIDE OR HAND REMOVAL.

SUBSOIL
 CULTIVATE 100MM DEPTH. DO NOT DISTURB SERVICES. IF NECESSARY CULTIVATE THESE AREAS BY HAND. REMOVE RUBBISH AND TRIM TO LEVELS.

SOIL
 INSTALL IMPORTED TOPSOIL TO DEPTH OF 300MM IN PREPARED GARDEN BEDS FREE OF DELETERIOUS MATERIALS, BUILDERS RUBBLE OR OTHER MATERIAL TOXIC TO PLANTS.

ORGANIC MULCH
 INSTALL FOREST MULCH FLUSH WITH SURROUNDING LEVELS 75MM THICK TO ALL PLANTED AREAS EXCEPT WHERE GRAVEL MULCH SPECIFIED.

GRAVEL MULCH
 INSTALL SELECTED GRAVEL MULCH OR PEBBLES FLUSH WITH SURROUNDING LEVELS 50MM THICK WHERE SPECIFIED.

FERTILISER
 INCORPORATE 9 MONTH SLOW RELEASE FERTILISER TO ALL PLANTED AREAS AFTER PLANTING AT MANUFACTURERS RECOMMENDED RATES.

TURF
 CSR WALTER BUFFALO

PLANT MATERIAL
 PLANTS SHALL BE VIGOROUS, HARDENED OFF, WELL ESTABLISHED AND FREE FROM DISEASE AND PESTS WITH HEALTHY ROOT SYSTEM.

GARDEN FENCING
 3 X 100MM GALVANISED STEEL EDGE SECURED AT 1M INTERVALS

PAVING
 SELECTED PAVERS INSTALLED ONTO PREPARED SUB-BASE.

DRIVEWAY & PATHS
 CONCRETE & INSTALLED BY OTHERS

MAINTENANCE
 12 WEEDS
 WATER DEEPLY AT PLANTING AND WEEKLY FOR SIX WEEKS AND THEN AS WEATHER DICTATES.

LEGEND

- Larustus Viburnum (Tinus)
- Crepe Myrtle (Lagerstroemia indica)
- Frangipani
- Star Jasmine (Jasminum polyanthum)
- SELECTED PAVING
- TURF
- STEPPING STONE PAVER

STORMWATER DESIGN
REFER SEPERATE
DETAIL DRAWINGS

LANDSCAPING PLAN
 SCALE 1:200

NO.	DATE	REVISION
00/00/00	#	REVISION

CAUTION:

1. UTILITY SERVICES SHOWN HEREON HAVE BEEN LOCATED WHERE POSSIBLE BY FIELD SURVEY. IF NOT ABLE TO BE LOCATED, SERVICES HAVE BEEN PLOTTED FROM THE RECORDS OF RELEVANT AUTHORITIES WHERE AVAILABLE. PRIOR TO EXCAVATION OR CONSTRUCTION ON THE SITE, THE RELEVANT AUTHORITY SHOULD BE CONTACTED FOR CONFIRMATION OF LOCATION OF SERVICES. **** DIAL BEFORE YOU DIG (CALL 1100) ****
2. THE BOUNDARIES SHOWN HEREON ARE APPROXIMATE ONLY. FOR ANY CONSTRUCTION ACTIVITIES PROPOSED IN CLOSE PROXIMITY TO THE BOUNDARIES, IT IS RECOMMENDED THAT THOSE BOUNDARIES BE MARKED TO AVOID POSSIBILITY OF ENCROACHMENT.



CLIENT **A & M POPOVSKI**

JOB **PROPOSED RESIDENCE**

LOCATION **62 Mactier St
Narrabeen**

plan prepared by **TULLIPAN HOMES**

— BUILDER TO CHECK ALL DETAILS AND DIMENSIONS PRIOR TO CONSTRUCTION.
 — FIGURED DIMENSIONS TAKE PREFERENCE OVER SCALE.

SHEET **Landscaping** DATE **23/03/2020** DWG No. **7292-wd8**

Lic. No. 131446C

TULLIPAN HOMES PTY LTD

Mariners Building
 Level 4, Suite 410
 1 Bryant Drive
 Tuggerah NSW 2259
 PO Box 5148
 CHITTAWAY BAY NSW 2261

PH 02 4353 8644
 FAX 02 4353 8655
 www.tullipanhomes.com.au
 www.splitlevelhomes.com.au