



northern
beaches
council

NORTHERN BEACHES COUNCIL

BAYVIEW SEAWALL UPGRADE

12542425

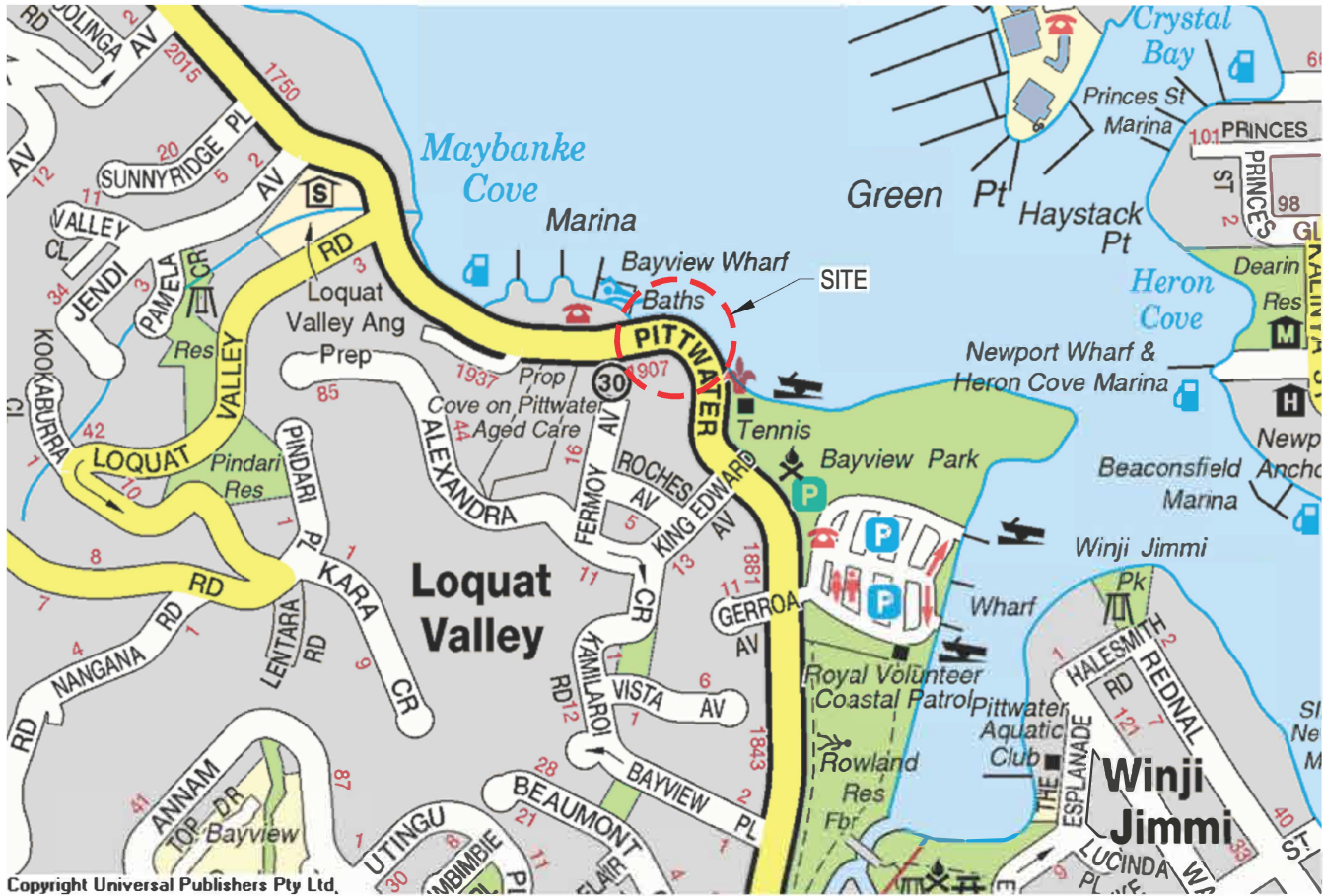
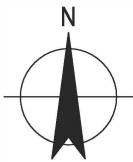

Copyright Universal Publishers Pty Ltd.

LOCALITY PLAN

NTS

DRAWING LIST

DRG No.	DRAWING TITLE
12542425-G001	COVER SHEET, LOCALITY PLAN AND DRAWING LIST
12542425-G003	GENERAL ARRANGEMENT PLAN
12542425-K001	TYPICAL SECTIONS

C	ISSUED FOR CLIENT REVIEW	CD	SH	07.10.22
B	ISSUED FOR CLIENT REVIEW	CA	SH	05.10.22
A	ISSUED FOR INFORMATION	CD	CA	17.12.21
Rev	Description	Checked	Approved	Date
Author	W. CRISOLOGO	Drafting Check	R. DAM	
Designer	F. LI	Design Check	C. DENGATE	

Plot Date: 7 October 2022 - 11:09 AM Plotted by: Ezer Chaim Te-ale

File Name: \\ghdnet\ghd\PH\Manila\Projects\21\12542425\CADD\Drawings\12542425-G001.dwg



Level 15, 133 Castlereagh Street,
Sydney NSW 2000 Australia
T 61 2 9239 7100 F 61 2 9239 7199
E sydmail@ghd.com W www.ghd.com

Conditions of Use. This document may only be used by GHD's client (and any other person who GHD has agreed can use this document) for the purpose for which it was prepared and must not be used by any other person for any other purpose.



Project No.
12542425

Client	NORTHERN BEACHES COUNCIL
Project	BAYVIEW SEAWALL UPGRADE
Status	PRELIMINARY

Drawing Title
COVER SHEET, LOCALITY PLAN
AND DRAWING LIST

Status
S2

Drawing No.
12542425-G001

Size
A3

Rev
C

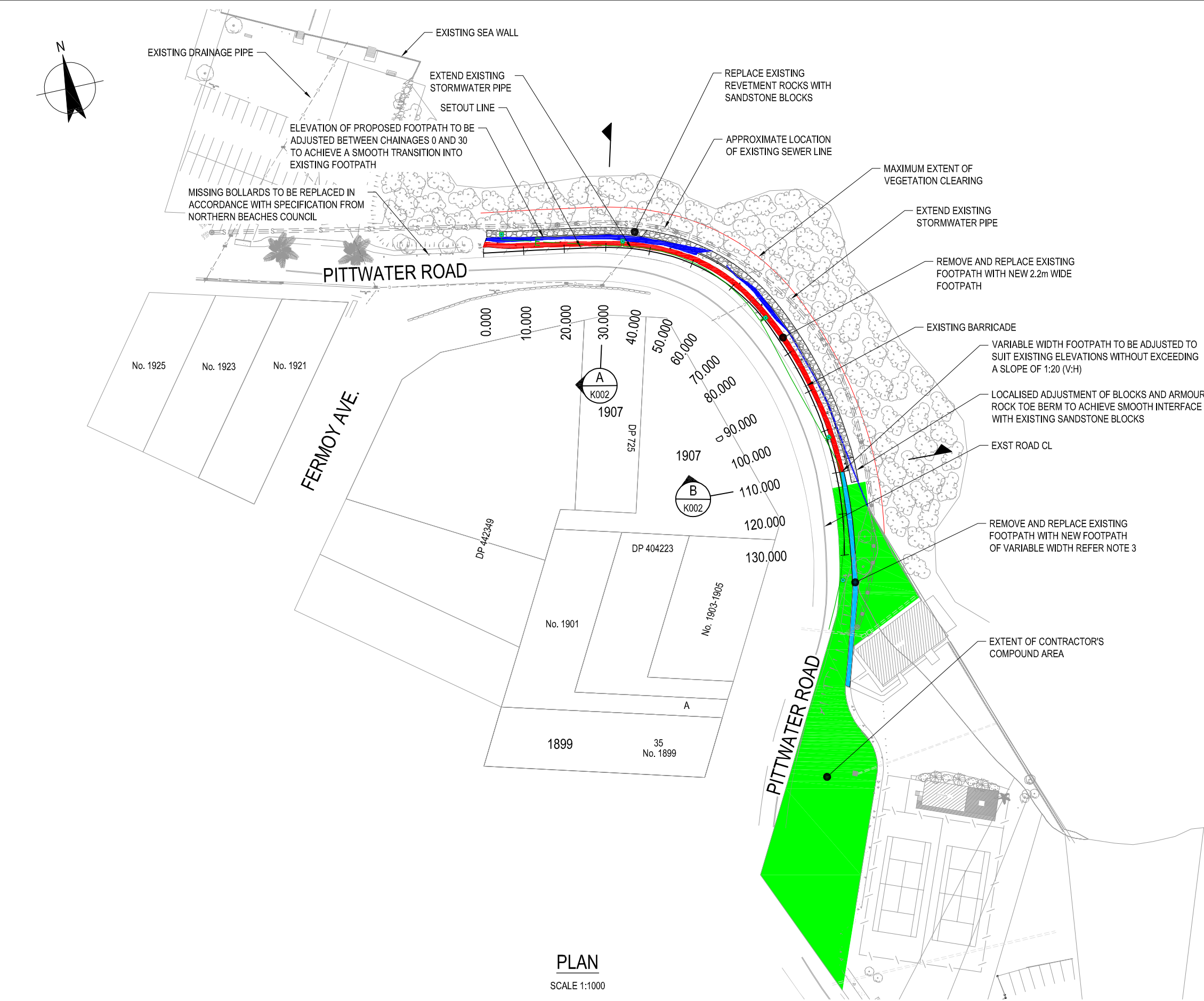

PLAN

SCALE 1:1000

LEGEND

EXISTING

- BOUNDARY LINE
- EXISTING DRAINAGE PIPE
- EXISTING FOOTPATH
- EXISTING SEAWALL TO BE REMOVED
- EXISTING FOOTPATH TO BE REMOVED
- EXISTING SEWER LINE
- EXISTING BARICADE
- EXISTING POWER LINE

DESIGN

- NEW FOOTPATH (2.2m WIDTH)
- NEW SANDSTONE BLOCKS
- NEW FOOTPATH OF VARIABLE WIDTH
- EXTENT OF CONTRACTOR'S COMPOUND AREA
- NEW DRAINAGE PIPE
- MAXIMUM EXTENT OF VEGETATION CLEARING

NOTES:

- TOPOGRAPHY SURVEY COMPLETED IN 2018 AND PROVIDED BY COUNCIL.
- VERTICAL DATUM METRES AUSTRALIAN HEIGHT DATUM.
- NEW FOOTPATH OF VARIABLE WIDTH TO BE CONSTRUCTED TO COUNCIL SPECIFICATION. ALIGNMENT AND EARTHWORKS TO BE AGREED ONSITE WITH REPRESENTATIVES OF NORTHERN BEACHES COUNCIL.
- CONTRACTOR SHALL UNDERTAKE ALL NECESSARY ASSESSMENT TO ENSURE SLOPE STABILITY UNDER ANY CONSTRUCTION LOADS.

PITTWATER TIDAL PLANES

DESCRIPTION	mAHD
HHWSS	1.048
MHWS	0.704
MHWN	0.447
MSL	0.074
MLWN	-0.299
MLWS	-0.556
ISLW	-0.801

(Lawson and Treloar, 2002)

Rev	Description	Checked	Approved	Date
C	ISSUED FOR CLIENT REVIEW	CD	SH	07.10.22
B	ISSUED FOR CLIENT REVIEW	CD	CD	25.05.22
A	ISSUED FOR INFORMATION	CD	CD	17.12.21
Author	W.CRISOLOGO	Drafting Check	R. DAM	
Designer	F. LI	Design Check	C. DENGATE	



Project No.
12542425

Client	NORTHERN BEACHES COUNCIL
Project	BAYVIEW SEAWALL UPGRADE
Status	PRELIMINARY

Drawing Title
GENERAL ARRANGMENT PLAN

Status Code
S2

Drawing No.
12542425-K001

Size
A3

Rev
C

NOTES:

1. TOPOGRAPHY SURVEY COMPLETED IN 2018 AND PROVIDED BY COUNCIL.
2. VERTICAL DATUM METRES AUSTRALIAN HEIGHT DATUM.
3. CONCRETE FOOTPATH CROSS FALL TO AWAY FROM ROAD AS DEPARTURE FROM COUNCIL'S STANDARD SPECIFICATION.
4. CONCRETE FOOTPATH SHALL BE LAID ON A MINIMUM 200mm THICK ROAD BASE DGB20 (COMPACTED TO MINIMUM 98% MAXIMUM DRY DENSITY) AS DEPARTURE FROM COUNCIL'S STANDARD SPECIFICATION.
5. EXCAVATED MATERIAL MAY BE TEMPORARILY STOCKPILED OVER THE EXISTING SEWER LINE HOWEVER NO ROCK MATERIAL IS TO BE PLACED DIRECTLY ON THE PIPELINE.
6. CROSSING OF THE SEWER LINE BY TRACKED OR WHEELED EQUIPMENT IS NOT PERMITTED.
7. CARE IS TO BE TAKEN DURING EXCAVATION TO AVOID DAMAGE TO STREETLIGHT POWER SUPPLY AND ENSURE THAT EXISTING STRUCTURES SUCH AS LIGHTPOST AND GUARDRAIL FOOTINGS ARE NOT UNDERMINED OR DESTABILISED IN ANY WAY.
8. BLOCKS ARE TO BE PLACED IN A BRICKWORK PATTERN SO EACH BLOCK COVERAGE OF BLOCK BELOW SHALL BE 30% OF ITS LENGTH.
9. CONTRACTOR TO CONSIDER THE CURVATURE OF THE FOOTPATH WHEN ORDERING BLOCKS TO BE CUT. BLOCK SIZES ARE APPROXIMATE. MAXIMUM LATERAL GAP BETWEEN TWO BLOCKS AT EXPOSED FACE SHALL BE 50mm.
10. MAXIMUM GAP BETWEEN THE BLOCKS AT THE BACK OF THE BLOCKS SHALL NOT EXCEED D15 OF THE RAILWAY BALLAST USED.
11. BLOCK PLACEMENT TOLERANCE SHALL BE ±50mm. AND FINAL CREST LAYER OF THE BLOCKS SHALL BE 0 TO +50mm.
12. CONTRACTOR TO CONSIDER HOW THE HARDWOOD BEAM CONNECTS TO THE SANDSTONE BLOCK WHEN PLACING THE HARDWOOD BEAM.
13. IF ANY CREVICES OR GAPS IN ROCK LARGER THAN 300MM ARE ENCOUNTERED BELOW THE FOUNDATION, GHD IS TO BE CONSULTED FOR FURTHER ADVICE.

PITTWATER TIDAL PLANES

DESCRIPTION	mAHD
HHWSS	1.048
MHWS	0.704
MHWN	0.447
MSL	0.074
MLWN	-0.299
MLWS	-0.556
ISLW	-0.801

(Lawson and Treloar, 2002)

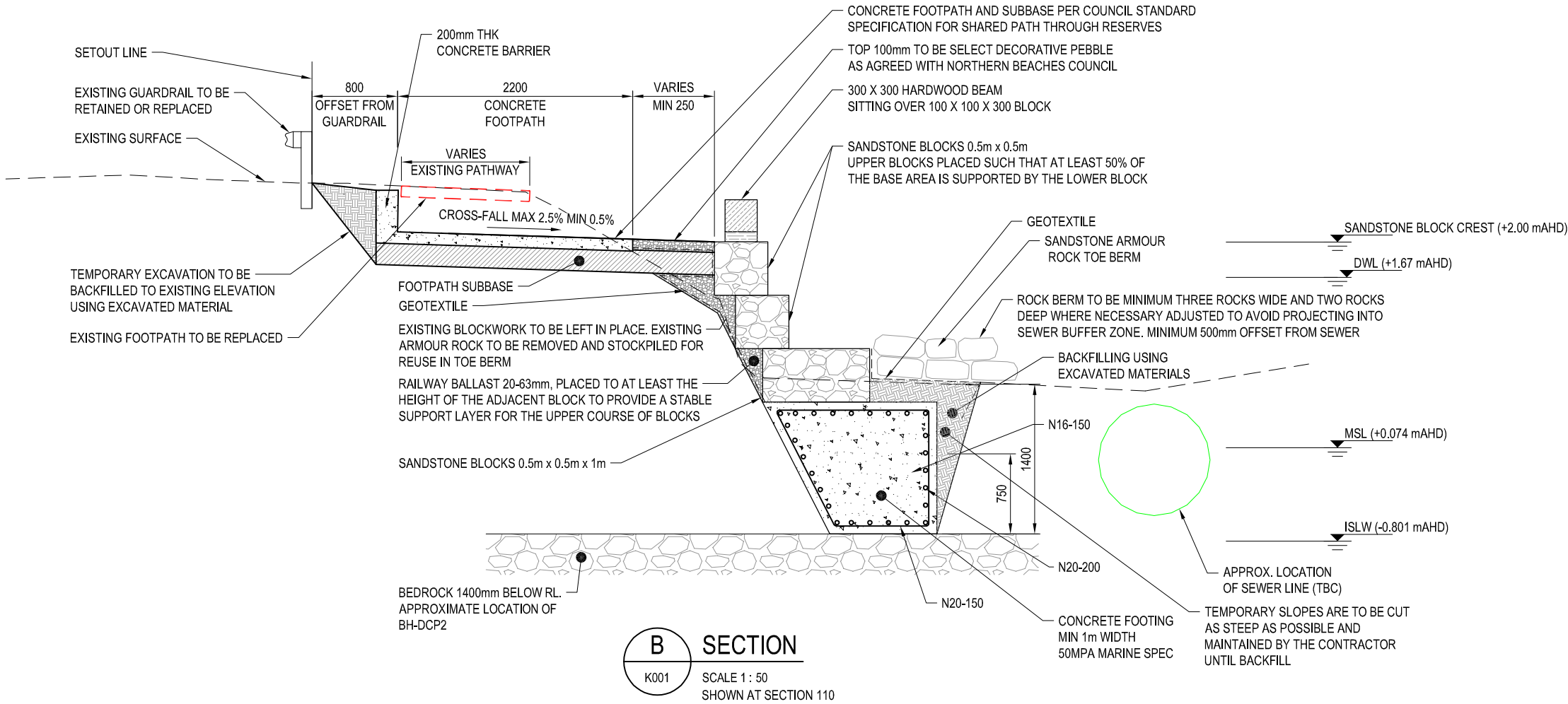
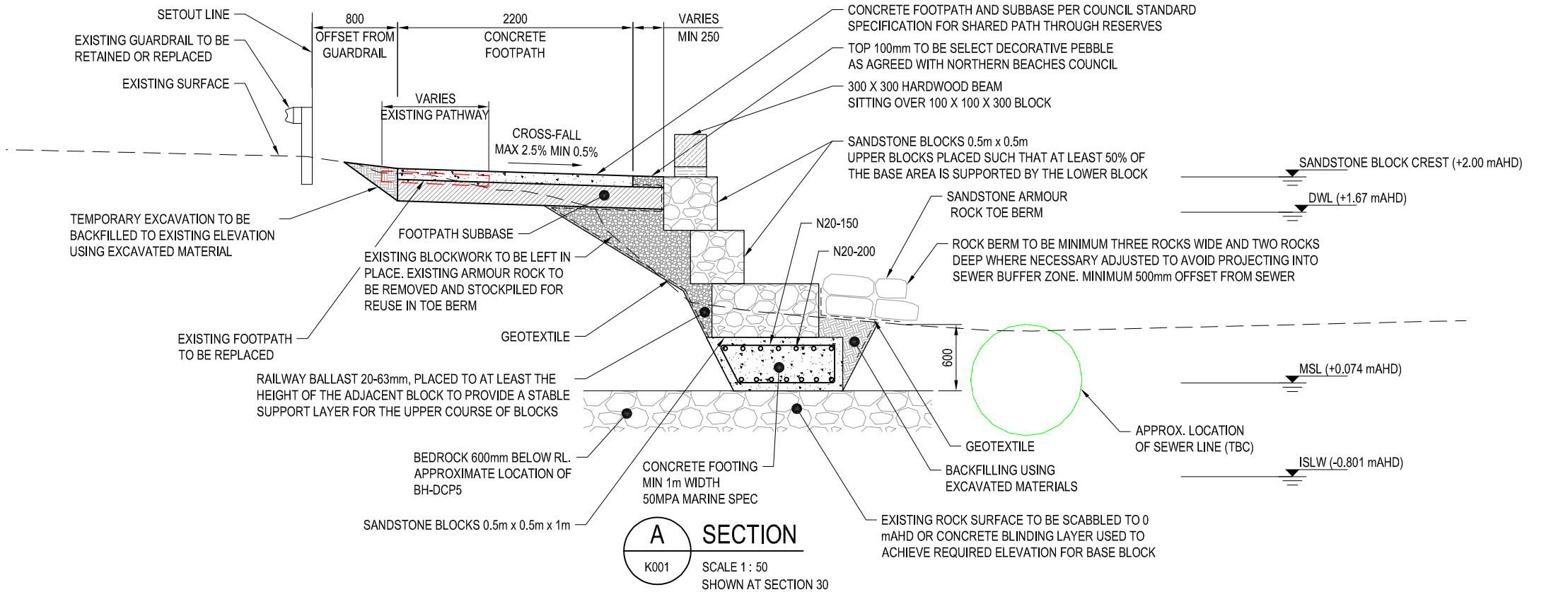

Rev	Description	Checked	Approved	Date
C	ISSUED FOR CLIENT REVIEW	CD	SH	07.10.22
B	ISSUED FOR CLIENT REVIEW	CD	CD	25.05.22
A	ISSUED FOR INFORMATION	CD	CD	17.12.21
Author	W.CRISOLOGO	Drafting Check	R. DAM	
Designer	F. LI	Design Check	C. DENGATE	

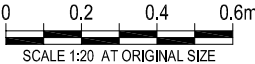

Level 15, 133 Castlereagh Street,
Sydney NSW 2000 Australia
T 61 2 9239 7100 F 61 2 9239 7199
E sydmall@ghd.com W www.ghd.com



Project No.
12542425

Client	NORTHERN BEACHES COUNCIL
Project	BAYVIEW SEAWALL UPGRADE
Status	PRELIMINARY

Drawing Title
TYPICAL SECTIONS

Status Code
S2

Drawing No.
12542425-K002

Size
A3

Rev
C