

**Path prepared using  
Autodesk Vehicle Tracking**

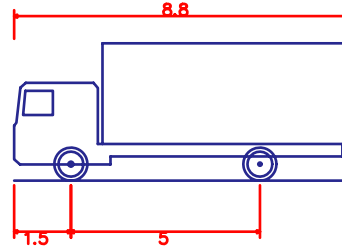

MRV – Medium Rigid Vehicle	
Overall Length	8.800m
Overall Width	2.500m
Overall Body Height	3.633m
Min Body Ground Clearance	0.428m
Track Width	2.500m
Lock-to-lock time	4.00s
Curb to Curb Turning Radius	10.000m

**Manoeuvring Path of Australian  
Standard AS2890.2:2002  
8.8m Medium Rigid Vehicle (MRV)**

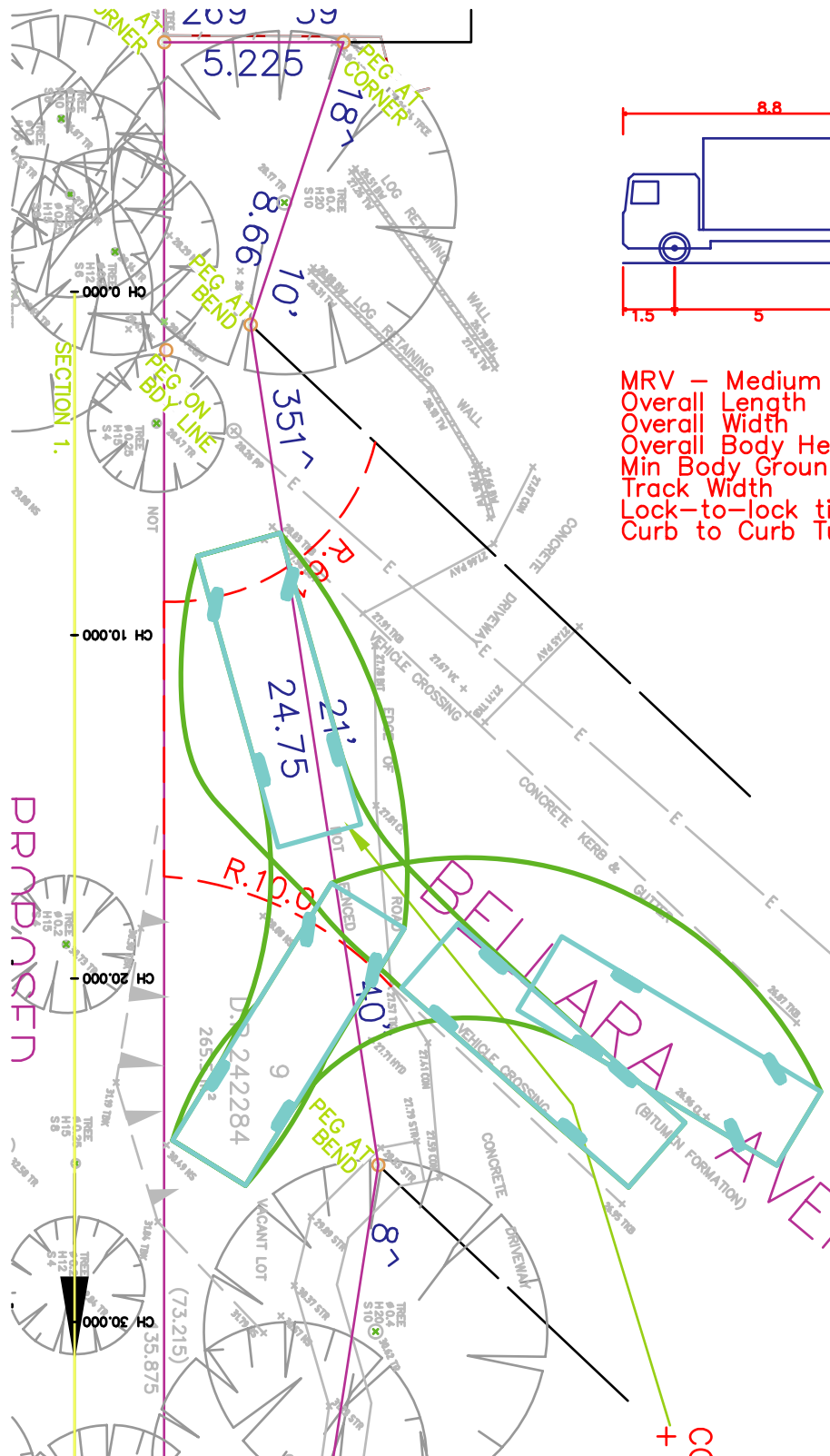
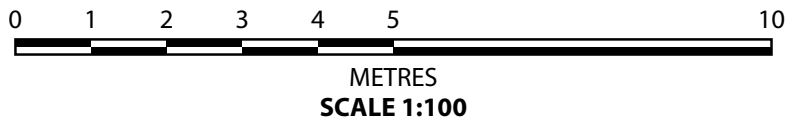

**Terraffic** Pty Ltd  
TRAFFIC & PARKING CONSULTANTS