

A LOCATION PLAN
N.T.S.

**atelier
andy carson**

0403 187 032
"THE STUDIO"
75 Myrtle St. Chippendale
ABN:45 161 798 358

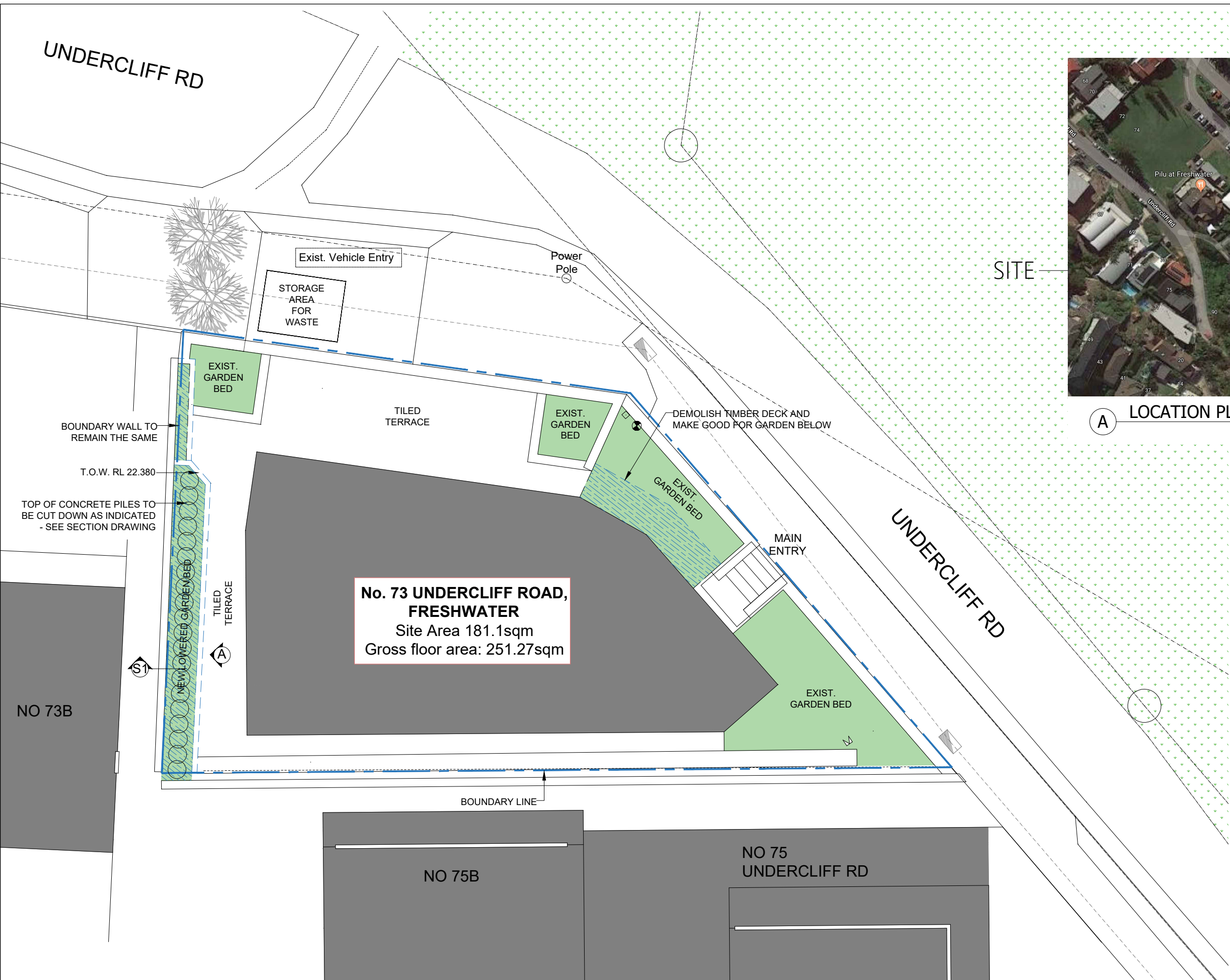

**No. 73 UNDERCLIFF ROAD,
FRESHWATER**
Site Area 181.1sqm
Gross floor area: 251.27sqm

A Site Plan
Scale: 1:100 @ A3

23.04.19	FOR DA	A
DATE	REVISION	No.

TRADE CONTRACTORS TO CHECK ALL DIMENSIONS ON SITE BEFORE COMMENCING ANY WORK OR PREPARING ANY SHOP DRAWINGS.

(C) COPYRIGHT. ATELIER ANDY CARSON. THESE PLANS, DESIGN AND THE COPYRIGHT THEREIN ARE THE PROPERTY OF ATELIER ANDY CARSON AND MUST NOT BE REPRODUCED OR COPIED, WITHOUT THE WRITTEN PERMISSION OF ATELIER ANDY CARSON.

Dr. Judith Neilson, AM

PROJECT:
FRESHWATER HOUSE
LOT 1, DP 984294,
73 UNDERCLIFF ROAD,
FRESHWATER, NSW 2096

Drawn:	Scale:
KL	1:100 @A3

Drawing No.

DA-02 **A**

**PROPOSED
SITE PLAN**





(A) LOCATION PLAN
N.T.S.

**atelier
andy carson**

0403 187 032
'THE STUDIO'
75 Myrtle St. Chippendale
ABN:45 161 798 358

UNDERCLIFF RD

Exist. Vehicle Entry

Power Pole

SITE

EXIST. GARDEN BED

TILED TERRACE

EXIST. GARDEN BED

AREA OF PROPOSED WORK

T.O.W. RL 23.430
TOP OF EXISTING
CONCRETE PILES

EXIST. GARDEN BED

TILED TERRACE

EXIST. GARDEN BED
TIMBER DECK

MAIN ENTRY

UNDERCLIFF RD

**No. 73 UNDERCLIFF ROAD,
FRESHWATER**
Site Area 181.1sqm
Gross floor area: 251.27sqm

EXIST. GARDEN BED

NO 73B

S1

BOUNDARY LINE

AREA OF PROPOSED WORK

NO 75B

NO 75
UNDERCLIFF RD

(A) Site Plan
Scale: 1:100 @ A3



23.04.19	FOR DA	A
DATE	REVISION	No.

TRADE CONTRACTORS TO CHECK ALL DIMENSIONS ON SITE BEFORE COMMENCING ANY WORK OR PREPARING ANY SHOP DRAWINGS.

(C) COPYRIGHT, ATELIER ANDY CARSON. THESE PLANS, DESIGN AND THE COPYRIGHT THEREIN ARE THE PROPERTY OF ATELIER ANDY CARSON AND MUST NOT BE REPRODUCED OR COPIED, WITHOUT THE WRITTEN PERMISSION OF ATELIER ANDY CARSON.

Dr. Judith Neilson, AM

PROJECT:
FRESHWATER HOUSE
LOT 1, DP 984294,
73 UNDERCLIFF ROAD,
FRESHWATER, NSW 2096

Drawn:	Scale:
KL	1:100 @A3

Drawing No.

DA-01

Rev
A

EXIST. SITE
PLAN