



Reference number 2535

Member of the Fire Protection Association of Australia

---

## ***Lot 4, section 158, DP 242868, 28 Borgnis Street, Davidson, NSW 2085.***

***Wednesday, 2 September 2020***

Prepared by:	<b>Matthew Willis</b> <i>BPAD – Level3 Certified Practitioner</i> Certification No: BPD-PA 09337		7/6/2019 02/09/2020
Can this proposal comply with AS3959-2018 (inc section 7.5, 7.5.1, 7.5.2, 7.5.3, 7.5.4 (where applicable) of the Rural Fire Services document Planning for Bushfire Protection 2019)?	Yes		
What is the recommended AS 3959-2018 level of compliance?	BAL-FZ		
Is referral to the RFS required?	Yes		
Can this development comply with the requirements of PBP?	Yes		
Plans by "Newbuild Design and Drafting" (Appendix 1) dated.	June 2020		

© This document is copyright. It is a breach of copyright for this document to be used to support a development application or any other purpose for any persons/entities other than those for whom this document was prepared. Other than for the purpose for which this document has been prepared and subject to conditions prescribed under the Copyright Act no part of this document may in any form nor by any means be reproduced or stored in a retrieval system or transmitted without the prior written permission of the company (Bushfire Planning Services Pty Ltd ACN 115 714 826).



## **Bushfire Planning Services**

15 Parkcrest Place

Kenthurst NSW 2156

02 96543228

0428408577

[mattw@bushfireconsultants.com.au](mailto:mattw@bushfireconsultants.com.au)

---

# **Bushfire Risk Assessment**

***Wednesday, 2 September 2020***

### **Contact**

*Robert Geoghegan*

*Newbuild Design and Drafting*

*17 Jocelyn Street*

*Curl Curl NSW 2096*

*0419907222*

### **Owner**

*Nikki Thompson*

*28 Borgnis Street*

*NSW 2085*

*0422364474*

### **Subject Property**

*Lot 4, section 158, DP 242868*

*28 Borgnis Street*

*Davidson NSW 2085*

## BUSHFIRE RISK ASSESSMENT CERTIFICATE

**THIS FORM IS TO BE COMPLETED BY A RECOGNISED CONSULTANT IN BUSHFIRE RISK ASSESSMENT IN ACCORDANCE WITH SECTION 79BA 1(b) OF THE ENVIRONMENTAL PLANNING AND ASSESSMENT ACT 1979 NO 203**

Property Address	Lot 4, section 158, DP 242868, number 28 Borgnis Street Davidson
Description of the Proposal	Alterations and additions to an existing dwelling
Plan Reference	June 2020
BAL Rating	BAL-FZ
Does the Proposal Rely on Alternate Solutions?	<b>No</b>

**I, Matthew Willis of Bushfire Planning Services Pty Ltd** have carried out a bushfire risk assessment on the above-mentioned proposal and property. A detailed Bushfire Assessment Report is attached which includes the submission requirements set out in Appendix 4 of Planning for Bushfire Protection 2019 together with recommendations as to how the relevant Specifications and requirements are to be achieved.

I hereby certify, in accordance with Section 4.14 of the Environmental Planning and Assessment Act 1979 No 203:

1. That I am a person recognised by the NSW Rural Fire Service as a qualified consultant in bushfire risk assessment; and
2. That subject to the recommendations contained in the attached Bushfire Risk Assessment Report the proposed development conforms to the relevant specifications and requirements\*

\*The relevant specifications and requirements being specifications and requirements of the document entitled Planning for Bush Fire Protection prepared by the NSW Rural Fire Service in co-operation with the Department of Planning and any other document as prescribed by Section 79 BA(1)(a) of the Environmental Planning and Assessment Act 1979 No 203.

I am aware that the Bushfire Assessment Report, prepared for the above-mentioned site is to be submitted in support of a development application for this site and will be relied upon by Northern Beaches Council as the basis for ensuring that the bushfire risk management aspects of the proposed development have been addressed in accordance with Planning for Bushfire Protection 2019.

<b>REPORT REFERENCE</b>	Wednesday, 2 September 2020
<b>REPORT DATE</b>	Wednesday, 2 September 2020
<b>CERTIFICATION NO/ACCREDITED SCHEME</b>	FPAF BPAD A BPD-PA 09337

### Attachments:

- Bushfire Risk Assessment Report
- Recommendations

**SIGNATURE:** ---  ----- **DATE:** -----Wednesday, 2 September 2020

## Contents

1	Executive Summary	5
2	General	6
3	Block Description	6
4	Vegetation	8
5	Known constraints on subject block	10
6	Slope	10
7	Utilities	11
7.1	Water	11
7.2	Electricity	11
7.3	Gas	11
8	Access/Egress	11
9	Compliance with Planning for Bushfire Protection setbacks	12
10	Siting	12
11	Construction and design.	13
12	Utilities	13
12.1	Water	13
12.2	Electricity and Gas	13
13	Asset Protection Zone (APZ)	13
14	Landscaping	14
15	Constraints on the subject block	14
16	Access/Egress	14
17	Compliance or non compliance with the specifications and requirements for bushfire protection measures	15
18	Conclusions	16
19	References	17
20	Appendix 1 - Plans	18

# 1 Executive Summary

Bushfire Planning Services has been requested by Mr Robert Geoghegan of Newbuild Design and Drafting to supply a bushfire compliance report on lot 4, section 158, DP 242868, 28 Borgnis Street, Davidson on behalf of the owner Nikki Thompson.

The works proposed for the subject lot are for the alterations and additions to an existing dwelling, see attached plans for details.

The subject lot is on the western side of Borgnis Street and at its closest point to the hazard the proposed new work has a separation distance to the west of approximately 35m. This separation distance includes an area of off-site managed land within Borgnis Reserve.

The vegetation that is considered to be the hazard to this proposal is situated on land that slopes down slope away from the property at an angle of approximately 19.03° deg.

For the purposes of this assessment this vegetation is considered to be Forest.

The remaining vegetation within the study area is contained within the boundaries of established residential allotments and is managed land and of low threat to this proposal.

The calculations and assumptions outlined in this report show that the development will be required to comply with the construction requirements of AS 3959-2018 BAL-FZ and any additional construction requirements contained within section 7.5, 7.5.1, 7.5.2, 7.5.3, 7.5.4 (where applicable) of the Rural Fire Services document Planning for Bushfire Protection 2019.

The following table is a summary of the relevant findings of this assessment.

Aspect	North	East	South	West
<b>Vegetation type</b>	Managed land	Managed land	Managed land	Managed land/forest
<b>Slope</b>	N/A	N/A	N/A	15-20 degrees downslope
<b>Setback within lot 4, section 158</b>	N/A	N/A	N/A	14m
<b>Setback outside lot 4, section 158</b>	N/A	N/A	N/A	21m
<b>Total setback</b>	N/A	N/A	N/A	35m
<b>Bal level</b>	N/A	N/A	N/A	F/Z

*Note: The above table is a summary of the significant variables used to determine the highest BAL for this proposal. THIS TABLE IS NOT INTENDED FOR CONSTRUCTION! Only the highest BAL level is shown, aspects marked as N/A will still have a BAL. Refer to section 11 for construction requirements for these other aspects.*

## 2 General

---

This proposal relates to the alterations and additions to an existing dwelling on the subject lot and its ability to comply with the rules and regulations for building in a bushfire prone area.

The methodology used on this report is based on Planning for Bushfire Protection 2019 (PBP) as published by the New South Wales Rural Fire Service.

Any wording that appears in *blue italics* is quotes from Planning for Bushfire Protection 2019. Some of the measurements used in this report have been taken from aerial photographs and as such are approximate only.

## 3 Block Description

---

The subject block is situated on the western side of Borgnis Street in an established area of Davidson.

The lot currently contains a single-level class 1a dwelling.

The lands surrounding the proposed site on the subject lot to a distance of at least 35m contain existing residential development and associated gardens or land that is otherwise not considered to be a significant bushfire hazard.

- Lot; 4, section 158
- DP; 242868.
- LGA; Northern Beaches.
- Area; 713m<sup>2</sup>.
- Address; 28 Borgnis Street, Davidson.

*This section has been left blank.*



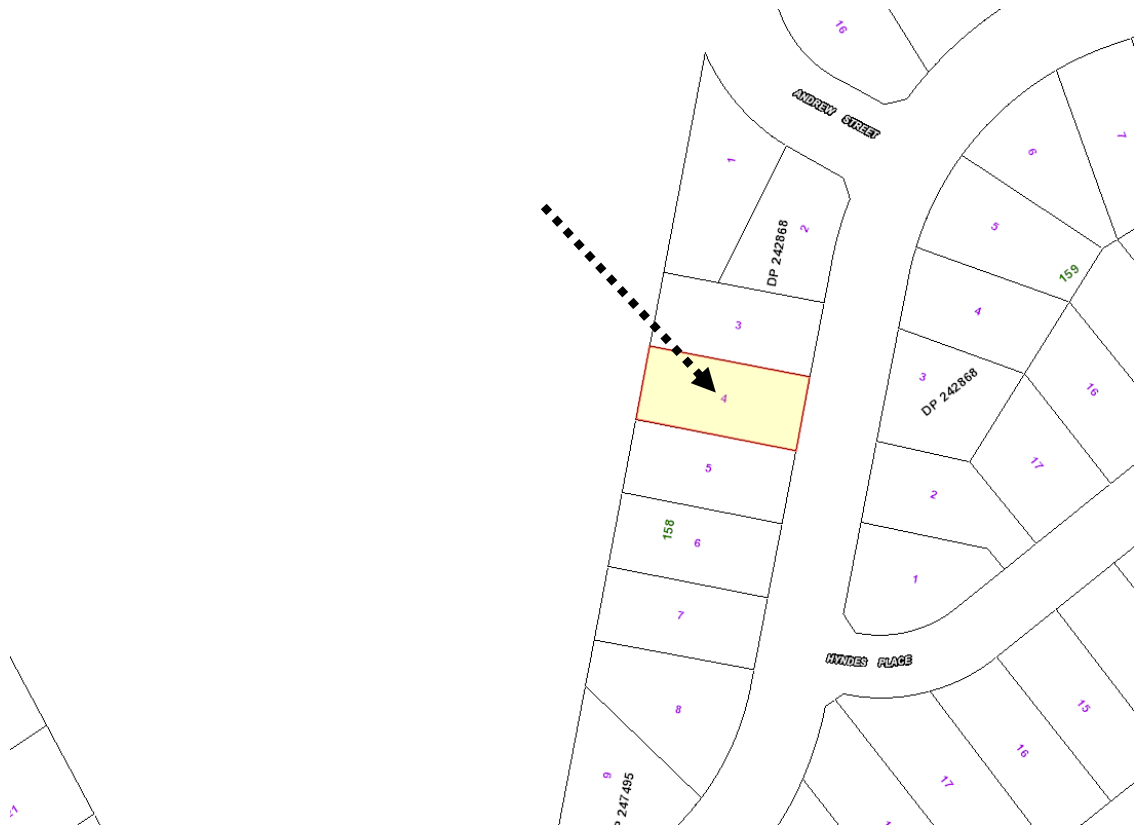

Map 1 shows the cadastral layout around the subject lot.



Map 2 is an extract from the councils' bushfire prone land map. The map shows lot 4, section 158 to be within the buffer zone of category 1 bushfire vegetation.



## 4 Vegetation

---

The study area for the vegetation is 140m surrounding the subject block.

The vegetation within the study area for this development is considered to be largely managed land.

The major potential hazard to this development is the vegetation within an area of undeveloped land to the west.

For the purpose of this assessment and compliance with AS3959 this area of undeveloped land is considered to be Forest and is the hazard to this proposal.



*Photo 1 - An overview of the vegetation within the general area.*

*This area has been left intentionally blank.*





*Photo 2 is a closer view of the vegetation in the area.*

Table 1 outlines the vegetation orientation and distance from the development area.

Aspect	North	East	South	West
<b>Vegetation type</b>	Managed land	Managed land	Managed land	Managed land/forest
<b>Setback within lot 4, section 158</b>	N/A	N/A	N/A	14m
<b>Off-site setback</b>	N/A	N/A	N/A	21m
<b>Total setback</b>	N/A	N/A	N/A	35m

*Table 1 - Any aspect marked with "N/A" in the table above indicates that it is considered there is none or only a secondary hazard in that direction.*

*This area has been left intentionally blank.*

## 5 Known constraints on subject block

I have not been informed or know of any places of cultural or environmental significance within the boundaries of the subject block.

Given the nature of the surrounding land it is considered highly unlikely that anything of significance will be affected by this development.

## 6 Slope

The slope of the land beneath the hazard that is most likely to influence bushfire behaviour has been calculated by topographical map analysis to a distance of 100m from the subject lot.

An extract of the topographical map for the area is shown below and the relevant slope analysis is shown in Table 2.

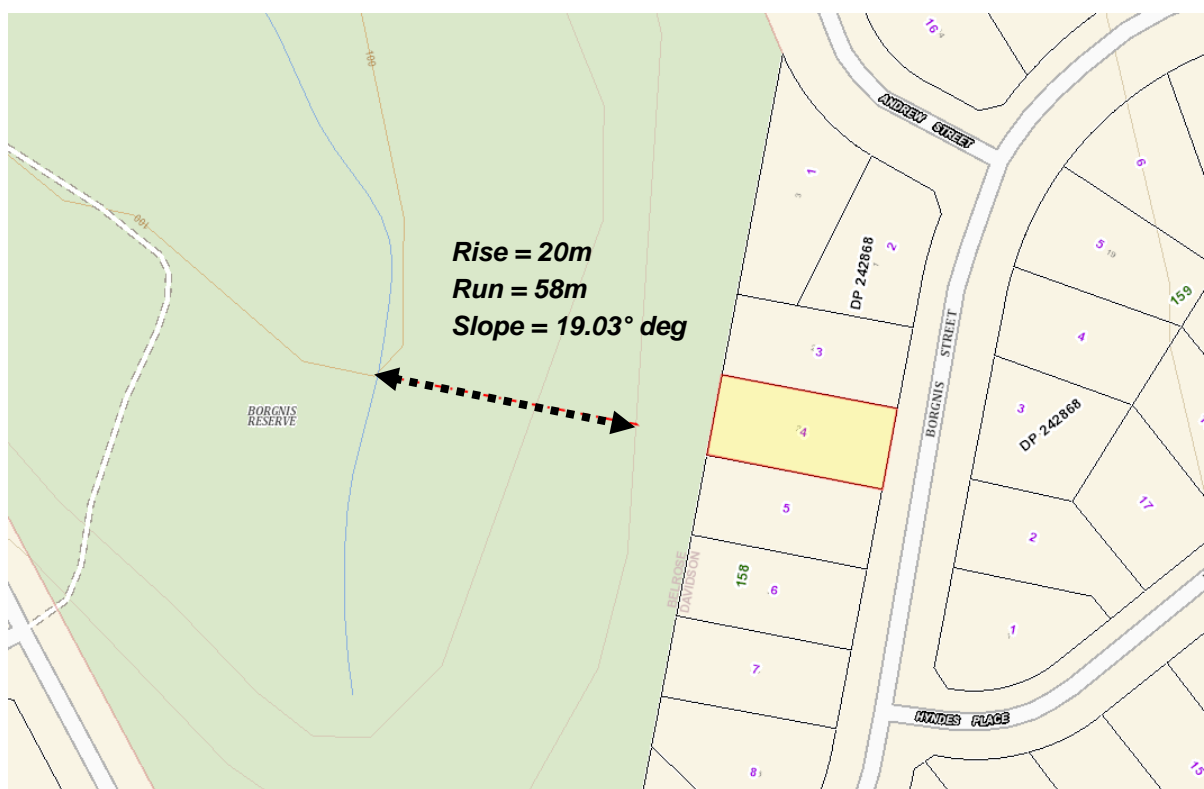

Table 2 shows the slope beneath the hazard.

Aspect	North	East	South	West
Slope	N/A	N/A	N/A	15-20 degrees downslope

*Table 2 - Any aspect marked with "N/A" in the table above indicates that it is considered there is no hazard in that direction.*



## Analysis of development and recommendation.

### 9 Compliance with Planning for Bushfire Protection setbacks

Based on the development design, vegetation classification, effective slope estimates and setback distance already outlined in this report the subject development will be required to comply with the requirements of AS 3959-2018 BAL-FZ and the RFS requirements on all fire prone aspects.

The following table is an extract from table A1.12.5 of Planning for Bushfire Protection 2019. This table is used to calculate the BAL for a proposal in an area with an FDI of 100.

The variables that have already been outlined in this assessment are highlighted in red with the highest BAL highlighted in yellow.

> 15 > 20 DEGREES – DOWNSLOPE	Keith Vegetation Formation	BUSH FIRE ATTACK LEVEL (BAL)				
		BAL-FZ	BAL-40	BAL-29	BAL-19	BAL-12.5
	Rainforest	< 23	23 -< 30	30 -< 42	42 -< 56	56 -< 100
	Forest (wet and dry sclerophyll) including Coastal Swamp Forest, Pine Plantations and Sub-Alpine Woodland	< 46	46 -< 56	56 -< 73	73 -< 92	92 -< 100
	Grassy and Semi-Arid Woodland (including Mallee)	< 24	24 -< 32	32 -< 44	44 -< 59	59 -< 100
	Forested Wetland (excluding Coastal Swamp Forest)	< 19	19 -< 26	26 -< 37	37 -< 50	50 -< 100
	Tall Heath	< 19	19 -< 25	25 -< 36	36 -< 49	49 -< 100
	Short Heath	< 11	11 -< 15	15 -< 23	23 -< 32	32 -< 100
	Arid-Shrublands (acacia and chenopod)	< 7	7 -< 10	10 -< 16	16 -< 23	23 -< 100
	Freshwater Wetlands	< 6	6 -< 8	8 -< 13	13 -< 18	18 -< 100
	Grassland	<13	13 -< 17	17 -< 26	26 -< 36	36 -< 50

For the purpose of this assessment the western aspect has been chosen as the most potentially hazardous aspect due to the effective slope, potential run of fire and the prevailing fire weather of the area.

### 10 Siting

The current site provides adequate separation between the proposed building and surrounding vegetation for a compliant structure to be built.

**Recommendation;**

Nil



## 11 Construction and design.

---

All new work is to be undertaken in accordance with the relevant requirements of the BCA and AS3959 2018. The following recommendations are a minimum level of construction. Constructing the proposal to a higher level than that recommended is allowable under AS3959.

### Recommendation; all new work.

1. New construction shall comply with the requirements of section 3 of Australian Standard AS3959-2018 "Construction of buildings in bush fire-prone areas" and,
2. New construction shall also comply with the requirements of BAL-FZ Australian Standard AS3959-2018 "Construction of buildings in bush fire-prone areas" and section A3.7 Addendum Appendix 3 of "Planning for Bush fire Protection".

### Recommendation; entire building.

3. New roofing valleys and guttering should be fitted with a non-combustible leaf protection to stop the accumulation of debris.

## 12 Utilities

---

### 12.1 Water

The proposed development will have access to a reticulated water supply. There is at least one hydrant indicated within the required distance from the dwelling.

### Recommendation;

Nil

### 12.2 Electricity and Gas

### Recommendation;

4. Any new electricity or gas connections are to comply with the requirements of table 7.4a of Planning for Bushfire Protection.

## 13 Asset Protection Zone (APZ)

---

The Asset Protection Zone is *"An area surrounding a development managed to reduce the bushfire hazard to an acceptable level. The width of an APZ will vary with slope, vegetation and construction level"*.

### Recommendation;

5. At the commencement of building works and in perpetuity the entire property shall be managed as an Asset Protection Zone in accordance with the requirements of

Planning for Bushfire Protection, the RFS document Standards for Asset Protection Zones and in a manner that does not create a bushfire hazard to the property.

## 14 Landscaping

---

### Recommendation;

6. Any new fencing is to be constructed in accordance with section 7.6 of Planning for Bushfire Protection 2019.
7. Any new landscaping to the site is to comply with the principles of Appendix 4 and section 3.7 of Planning for Bush Fire Protection 2019. In this regard the following landscaping principles are, where applicable, to be incorporated into the development<sup>1</sup>:
  - Suitable impervious areas being provided immediately surrounding the building such as courtyards, paths and driveways;
  - Grassed areas/mowed lawns/ or ground cover plantings being provided in close proximity to the building;
  - Restrict planting in the immediate vicinity of the building which may over time and if not properly maintained come in contact with the building;
  - Maximum tree cover should be less than 30%, and maximum shrub cover less than 20%;
  - Planting should not provide a continuous canopy to the building (i.e. trees or shrubs should be isolated or located in small clusters);
  - When considering landscape species consideration needs to be given to estimated size of the plant at maturity;
  - Avoid species with rough fibrous bark, or which retain/shed bark in long strips or retain dead material in their canopies;
  - Use smooth bark species of trees species which generally do not carry a fire up the bark into the crown;

## 15 Constraints on the subject block

---

None known.

### Recommendation;

Nil

## 16 Access/Egress

---

---

<sup>1</sup>Refer to referenced documents for a complete description.

All roads in the area are considered to be capable of handling emergency service vehicles. Access from the roadway onto the property is also considered to be adequate for firefighting purposes.

### Recommendation

Nil

## 17 Compliance or non compliance with the specifications and requirements for bushfire protection measures

<p>APZ</p> <p>A defendable space is provided onsite.</p> <p>An APZ is provided and maintained for the life of the development.</p>	<p>Achievable with the implementation of the recommendations in section 13</p>
<p>SITING AND DESIGN:</p> <p>Buildings are sited and designed to minimise the risk of bush fire attack.</p>	<p>Achievable with the implementation of the recommendations in section 10</p>
<p>CONSTRUCTION STANDARDS:</p> <p>It is demonstrated that the proposed building can withstand bush fire attack in the form of wind, smoke, embers, radiant heat and flame contact.</p>	<p>Achievable with the implementation of the recommendations in section 11</p>
<p>ACCESS</p> <p>Safe, operational access is provided (and maintained) for emergency services personnel in suppressing a bush fire while residents are seeking to relocate, in advance of a bush fire, (satisfying the intent and performance criteria for access roads in sections 4.1.3 and 4.2.7).</p>	<p>Achievable with the implementation of the recommendations in section 16</p>
<p>WATER AND UTILITY SERVICES:</p> <ul style="list-style-type: none"> <li>adequate water and electricity services are provided for firefighting operations</li> <li>Gas and electricity services are located so as not to contribute to the risk of fire to a building.</li> </ul>	<p>Achievable with the implementation of the recommendations in section 12</p>
<p>LANDSCAPING:</p> <ul style="list-style-type: none"> <li>it is designed and managed to minimise flame contact and radiant heat to buildings, and the potential for wind driven embers to cause Ignitions.</li> </ul>	<p>Achievable with the implementation of the recommendations in section 14</p>

## 18 Conclusions

---

Based on the above report and with the implementation of the recommendation contained within this report the consent authority should determine that this development can comply with the requirements of AS 3959-2018 and 'Planning for Bushfire Protection' guidelines.

The recommendations contained within this report are to be implemented in their entirety. Changing one aspect may have an adverse effect on the rest of the recommendations.

Bushfires are affected by many external influences such as climactic conditions, vegetation type, moisture content of the fuel, slope of the land and human intervention to name a few and are difficult to predict.

This report does not intend to provide a guarantee that the subject property will survive if a bushfire should impact the surrounding area. The purpose of this report is to show the developments level of compliance or in some cases non-compliance with the New South Wales legislation regarding building in bushfire prone areas.

Where non-compliance is found measures will be suggested that should make the building less susceptible to the various attack mechanisms of a bushfire and comply with the performance requirements of the Building Code of Australia.

The opinions expressed in this report are based on the writers' experience and interpretation of the relevant guidelines and standards. Notwithstanding the above, these guidelines and standards are open to interpretation. All care has been taken to ensure that the opinions expressed in this report are consistent with past successful outcomes.

Some of the information used in the compilation of this assessment has been provided by the proponent or the proponent's representatives. While we believe this information to be true and have accepted the information in good faith however this company or its representatives will not accept any responsibility if the provided information is determined to be incorrect.

This document is to assist the consenting authorities with their assessment of this proposal. The recommendations contained in this assessment reflect the normal conditions that are typically applied by the consent authority for a proposal such as this however the conditions of consent for the proposal will be supplied by the certifying authority on approval of the development and may not necessarily be the same as the recommendations of this assessment.

The recommendations in this assessment are for planning guidance only, construction details and compliance with all building requirements are the responsibility of the Architect/Designer, Builder and Certifier.

To avoid confusion, unless specifically referenced by the consenting authority, it is strongly recommended that once this proposal has been approved that this document is no longer referenced and that only the official conditions of consent as reflected in documentation by the certifying body are used for construction guidance.



If any further clarification is required for this report, please do not hesitate to contact me using the details above.

Yours Sincerely



**Matthew Willis**

*Grad Dip Planning for Bushfire Prone Areas*

*Bushfire Planning Services Pty Limited*

## 19 References

---

- *Australian Building Codes Board (2019). National Construction Code Volume One - Building Code of Australia. ABCB*
- *Australian Building Codes Board (2019). National Construction Code Volume two - Building Code of Australia. ABCB.*
- *Keith, D.A. (2004). Ocean Shores to Desert Dunes: The Native Vegetation of New South Wales and the ACT. NSW Department of Environment and Conservation.*
- *National Association of Steel Framed Housing (2014). "Steel Framed Construction in Bush Fire Areas. NASH*
- *Ramsay, C and Rudolph, L (2003) "Landscape and Building Design for Bush fire Areas". CSIRO Publishing, Collingwood.*
- *Resources and Energy NSW (2016). ISSC 3 Guide for the Managing Vegetation in the Vicinity of Electrical Assets. NSW Government*
- *Rural Fire Service NSW (2005) "Standards for Asset Protection Zones"*
- *Standards Australia (2018). "AS 3959, Construction of buildings in bush fire prone areas".*
- *Standards Australia (2018). "AS/NZS 1530.8.1 Methods for fire tests on building materials, components and structures - Tests on elements of construction for buildings exposed to simulated bush fire attack - Radiant heat and small flaming sources".*
- *Standards Australia (2018). "AS/NZS 1530.8.2 Methods for fire tests on building materials, components and structures - Tests on elements of construction for buildings exposed to simulated bush fire attack - Large flaming sources".*
- *Standards Australia (2014). "AS/NZS 1596 The storage and handling of LP Gas".*

## 20 Appendix 1 - Plans

