

450  
O/HANG

600  
O/HANG

600  
O/HANG

900  
O/HANG

900  
O/HANG

450  
O/HANG

450  
O/HANG

450  
O/HANG

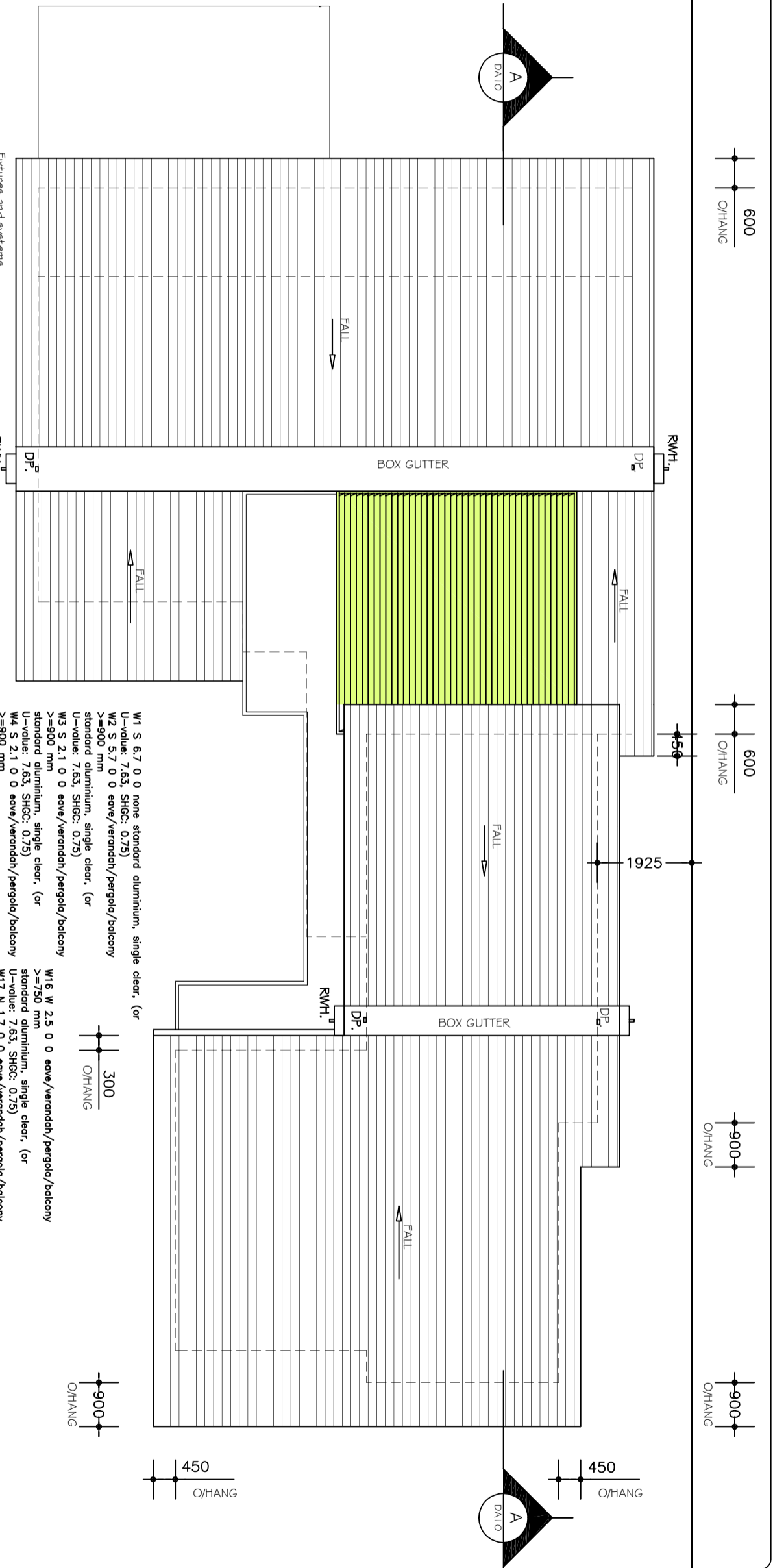

# PROPOSED ROOF PLAN

SCALE 1 : 100

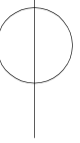

Lighting  
The applicant must ensure a minimum of 40% of new or altered light fixtures are fitted with fluorescent, compact fluorescent, or light-emitting-diode (LED) lamps.  
Fixtures and systems  
The applicant must ensure new or altered showerheads have a flow rate no greater than 9 litres per minute or a 3 star water rating.  
The applicant must ensure new or altered toilets have a flow rate no greater than 4 litres per average flush or a minimum 3 star water rating.  
The applicant must ensure new or altered taps have a flow rate no greater than 9 litres per minute or minimum 3 star water rating.

**Insulation requirements**  
The applicant must construct the new or altered construction (floor(s), walls, and ceilings/roofs) in accordance with the specifications listed in the table below, except that (a) additional insulation is not required where the area of new construction is less than 2m<sup>2</sup>, b) insulation specified is not required for parts of altered construction where insulation already exists.

Construction	Additional insulation required (R-value)	Other specifications
concrete slab on ground floor.	nil	
suspended floor with open subfloor: framed (R0.7).	R0.8 (down) (or R1.50 including construction)	
suspended floor with enclosed subfloor: framed (R0.7).	R0.80 (down) (or R1.30 including construction)	
floor above existing dwelling or building.	nil	
external wall: brick veneer	R1.16 (or R1.70 including construction)	
external wall: framed (weatherboard, fibro, metal clad)	R1.30 (or R1.70 including construction)	
external wall: other/undecided	R1.70 (including construction)	
skated ceiling, pitched/skillion roof: framed	ceiling: R3.00 (up), roof: battarking	medium (solar absorptance 0.475 - 0.70)

- W1 S 6.7 0 0 none standard aluminium, single clear. (or U-value: 7.63, SHGC: 0.75)
- W2 S 5.7 0 0 eave/verandah/pergola/balcony >=900 mm standard aluminium, single clear. (or U-value: 7.63, SHGC: 0.75)
- W3 S 2.1 0 0 eave/verandah/pergola/balcony >=900 mm standard aluminium, single clear. (or U-value: 7.63, SHGC: 0.75)
- W4 S 2.1 0 0 eave/verandah/pergola/balcony >=900 mm standard aluminium, single clear. (or U-value: 7.63, SHGC: 0.75)
- W5 S 2.1 0 0 eave/verandah/pergola/balcony >=900 mm standard aluminium, single clear. (or U-value: 7.63, SHGC: 0.75)
- W6 W 1.3 0 0 eave/verandah/pergola/balcony >=750 mm standard aluminium, single clear. (or U-value: 7.63, SHGC: 0.75)
- W7 E 5.8 0 0 eave/verandah/pergola/balcony >=750 mm standard aluminium, single toned. (or U-value: 7.57, SHGC: 0.57)
- W8 E 5.8 0 0 eave/verandah/pergola/balcony >=750 mm standard aluminium, single toned. (or U-value: 7.57, SHGC: 0.57)
- W9 N 0.765 0 0 eave/verandah/pergola/balcony >=750 mm standard aluminium, single clear. (or U-value: 7.63, SHGC: 0.75)
- W10 E 3.1 0 0 eave/verandah/pergola/balcony >=750 mm standard aluminium, single toned. (or U-value: 7.57, SHGC: 0.57)
- W11 E 0.9 0 0 eave/verandah/pergola/balcony >=450 mm standard aluminium, single pyrolytic low-e. (U-value: 5.7, SHGC: 0.47)
- W12 W 0.35 0 0 eave/verandah/pergola/balcony >=450 mm standard aluminium, single clear. (or U-value: 7.63, SHGC: 0.75)
- W13 W 1.8 0 0 eave/verandah/pergola/balcony >=750 mm standard aluminium, single clear. (or U-value: 7.63, SHGC: 0.75)
- W14 N 0.5 0 0 eave/verandah/pergola/balcony >=900 mm standard aluminium, single clear. (or U-value: 7.63, SHGC: 0.75)
- W15 W 1.1 0 0 eave/verandah/pergola/balcony >=750 mm standard aluminium, single clear. (or U-value: 7.63, SHGC: 0.75)
- W16 W 2.5 0 0 eave/verandah/pergola/balcony >=750 mm standard aluminium, single clear. (or U-value: 7.63, SHGC: 0.75)
- W17 N 1.7 0 0 eave/verandah/pergola/balcony >=900 mm standard aluminium, single clear. (or U-value: 7.63, SHGC: 0.75)
- W18 N 1.8 0 0 eave/verandah/pergola/balcony >=900 mm standard aluminium, single clear. (or U-value: 7.63, SHGC: 0.75)
- W19 E 3.8 0 0 eave/verandah/pergola/balcony >=750 mm standard aluminium, single toned. (or U-value: 7.57, SHGC: 0.57)
- W20 E 3.8 0 0 eave/verandah/pergola/balcony >=750 mm standard aluminium, single toned. (or U-value: 7.57, SHGC: 0.57)
- W21 S 2.3 0 0 eave/verandah/pergola/balcony >=750 mm standard aluminium, single clear. (or U-value: 7.63, SHGC: 0.75)
- W22 E 4.06 0 0 eave/verandah/pergola/balcony >=900 mm standard aluminium, single clear. (or U-value: 7.63, SHGC: 0.75)
- W23 E 2.4 0 0 eave/verandah/pergola/balcony >=750 mm standard aluminium, single toned. (or U-value: 7.57, SHGC: 0.57)
- W24 S 2.2 0 0 awning (adjustable) >=900 mm standard aluminium, single clear. (or U-value: 7.63, SHGC: 0.75)
- W25 S 1.8 0 0 eave/verandah/pergola/balcony >=450 mm standard aluminium, single clear. (or U-value: 7.63, SHGC: 0.75)
- W26 W 4.3 0 0 eave/verandah/pergola/balcony >=750 mm standard aluminium, single clear. (or U-value: 7.63, SHGC: 0.75)
- W27 E 2.85 0 0 eave/verandah/pergola/balcony >=900 mm standard aluminium, single clear. (or U-value: 7.63, SHGC: 0.75)
- W28 E 1.89 0 0 eave/verandah/pergola/balcony >=900 mm standard aluminium, single clear. (or U-value: 7.63, SHGC: 0.75)
- W29 S 6.6 0 0 eave/verandah/pergola/balcony >=750 mm standard aluminium, single clear. (or U-value: 7.63, SHGC: 0.75)
- W30 S 6.9 0 0 eave/verandah/pergola/balcony >=750 mm standard aluminium, single clear. (or U-value: 7.63, SHGC: 0.75)
- W31 S 6.9 0 0 eave/verandah/pergola/balcony >=750 mm standard aluminium, single clear. (or U-value: 7.63, SHGC: 0.75)
- W32 N 5.04 0 0 eave/verandah/pergola/balcony >=900 mm standard aluminium, single clear. (or U-value: 7.63, SHGC: 0.75)
- W33 S 1.8 0 0 pergola (adjustable shade) >=900 mm standard aluminium, single clear. (or U-value: 7.63, SHGC: 0.75)
- W34 N 5.5 0 0 eave/verandah/pergola/balcony >=750 mm standard aluminium, single clear. (or U-value: 7.63, SHGC: 0.75)
- W35 N 6 0 0 eave/verandah/pergola/balcony >=750 mm standard aluminium, single clear. (or U-value: 7.63, SHGC: 0.75)

**Sammy Fedele**  
abn 36 627 664 311

Architectural Drafting  
Services  
0404 037 606  
email:sammyfedele@iprimus.com.au

CLIENT : **Mr & Mrs R. & J. RAINE**  
PROPOSED : ALTERATIONS AND ADDITIONS TO EXISTING RESIDENCE.  
ADDRESS : 56 CENTRAL ROAD, DP 359416 AVALON LOT 33A NSW 2107 LGA PITTWATER COUNCIL

**ROOF PLAN**  
SCALE: 1:100  
DATE: 16.12.2016  
REV: JOB: 24/15  
SHEET No : **S96 04**

**A3**