

FOR S96 MODIFICATION
APPLICATION PURPOSES
ONLY
NOT FOR CONSTRUCTION

Existing Impervious Area 1:200 Notes: Do not scale from drawings

Site area = 836 m²

<div></div> Existing Building & Covered Deck:	= 313.5 m ²
<div></div> Existing Cubby:	= 36.5 m ²
Total impervious area:	= 350 m ² = 41.9 %

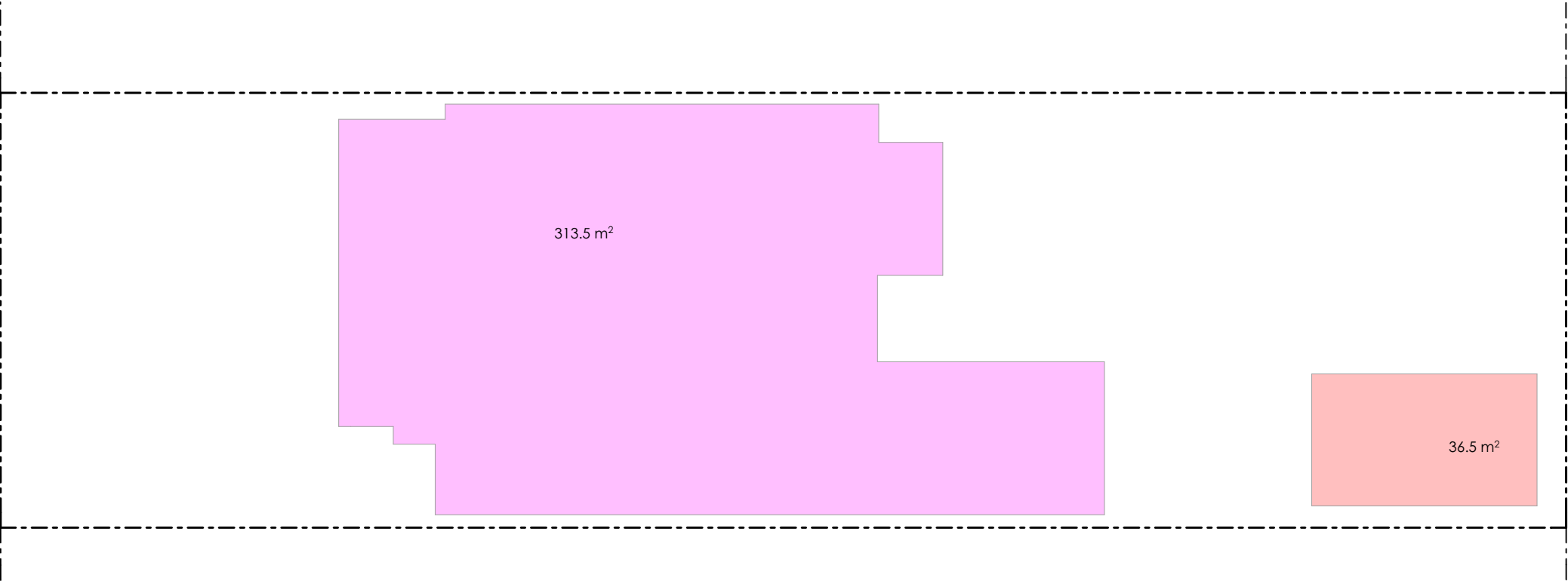

Proposed Impervious Area 1:200

Site area = 836 m²

<div></div> Proposed Building & Covered Deck:	= 324.1 m ²
<div></div> Proposed Cubby:	= 23.3 m ²
<div></div> Proposed pool & coping:	= 35.8 m ²
Total impervious area:	= 383.2 m ² = 45.8 %

