

**TREE PROTECTION ZONE (TPZ)  
FENCING (WHEN POSSIBLE):**

1. CHAIN WIRE MESH PANELS WITH SHADE CLOTH (IF REQUIRED) ATTACHED, HELD IN PLACE WITH CONCRETE FEET.
2. ALTERNATIVE PLYWOOD OR WOODEN PALING FENCE PANELS. THE FENCING MATERIAL ALSO PREVENTS BUILDING MATERIALS OR SOIL ENTERING THE TPZ.
3. MULCH INSTALLATION ACROSS SURFACE OF TPZ (AT THE DISCRETION OF THE PROJECT ARBORIST). NO EXCAVATION, CONSTRUCTION ACTIVITY, GRADE CHANGES, SURFACE TREATMENT OR STORAGE OF MATERIALS OF ANY KIND IS PERMITTED WITHIN THE TPZ.
4. BRACING IS PERMISSIBLE WITHIN THE TPZ. INSTALLATION OF SUPPORTS TO AVOID DAMAGING ROOTS.

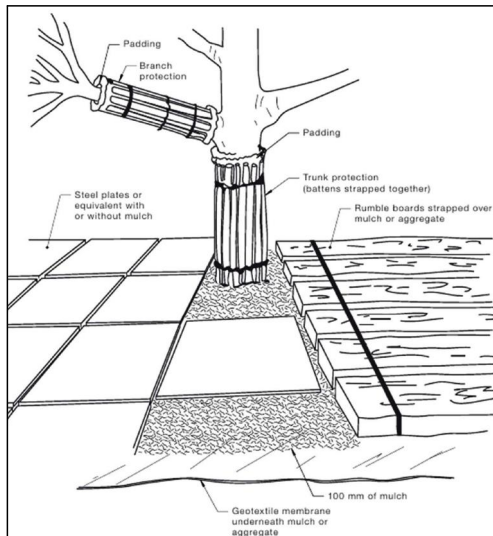

**TREE PROTECTION ZONE (TPZ)  
FENCING (NOT POSSIBLE):**

1. FOR TRUNK AND BRANCH PROTECTION USE BOARDS AND PADDING THAT WILL PREVENT DAMAGE TO BARK. BOARDS ARE TO BE STRAPPED TO TREES, NOT NAILED, OR SCREWED.
2. RUMBLE BOARDS SHOULD BE OF SUITABLE THICKNESS TO PREVENT SOIL COMPACTION AND ROOT DAMAGE.

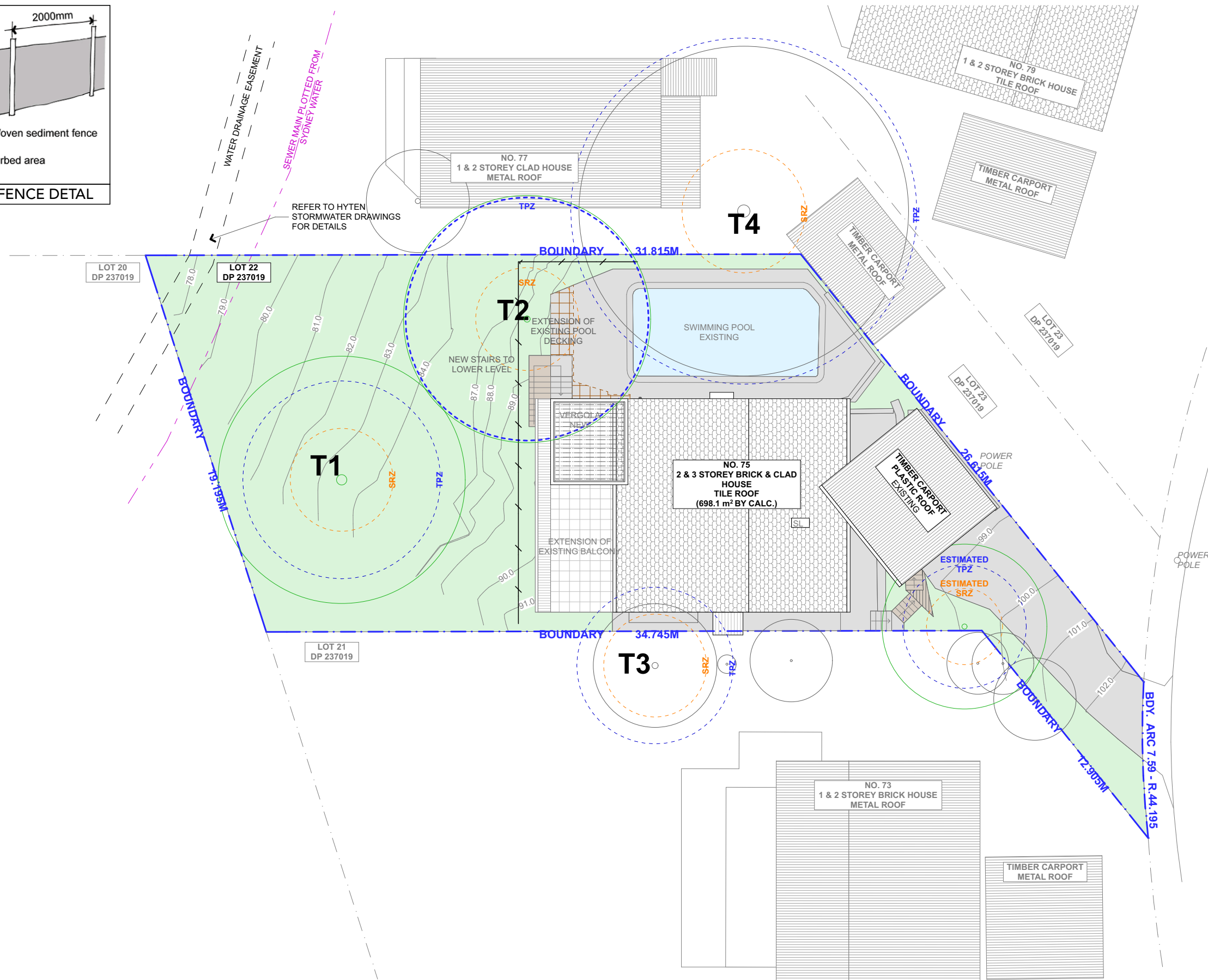
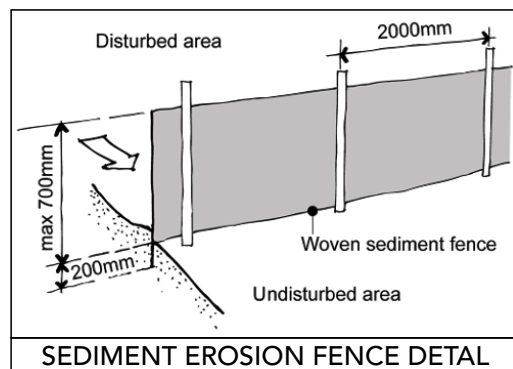

1

## SITE - WASTE - SEDIMENT PLAN

1:200



progressive plans









0400 699 850  
16 BOWLING GREEN LANE  
AVALON BEACH, NSW, 2107  
HELLO@PROGRESSIVEPLANS.COM.AU  
WWW.PROGRESSIVEPLANS.COM.AU

## NOTES

THE BUILDER SHALL CHECK AND VERIFY ALL DIMENSIONS AND VERIFY ALL ERRORS AND OMISSIONS TO THE DRAFTING OFFICE. DO NOT SCALE THE DRAWING. DRAWINGS SHALL NOT BE USED FOR CONSTRUCTION PURPOSES UNTIL ISSUED BY THE DRAFTING OFFICE FOR CONSTRUCTION AND NOTED ON THE TITLE BLOCK. THE WORK MUST BE VERIFIED BY STRUCTURAL ENGINEER BEFORE WORK COMMENCES.

REV.	NOTES.	INITIAL	DATE
A	DA SET	LW	10.02.25

## LEGEND

	EXISTING		LANDSCAPE / GRASS
	DEMOLISHED		CONCRETE / PAVERS
	EXISTING ROOF		TIMBER DECK
	PROPOSED ROOF		POOL / WATER
		SEDIMENT EROSION FENCE	

## ABBREVIATIONS

DP: DEPOSIT PLAN  
RL: REDUCED LEVEL  
SP: STRATA PLAN  
TPZ: TREE  
- PROTECTION ZONE  
- SRZ: STRUCTURAL  
ROOT ZONE

## NORTH POINT

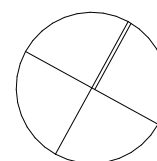

CLIENTS:
----------

ALAN KENT

## SITE ADDRESS:

75 CHERYL CRESCENT  
NEWPORT, NSW, 2106

## DRAWING TITLE:

## SITE - WASTE - SEDIMENT PLAN

SCALE:

1:200 @A3

DATE:

10/2/2025

PROJECT NO:

PROJECT NO: 1010	DRAWING NO: DA04
---------------------	---------------------