

SITE DATA - DA COMPLIANCE	
SITE AREA	450.00M2
DWELLING AREA	162.80M2
OTHER AREAS	88.80M2
PROPOSED POOL AREA	66.70m2
TOTAL B.U.A	318.30M2
SOFT LANDSCAPED ON ENTIRE LOT	131.70M2

SITE POOL PLAN
SCL 1:150



NOTES

1. PROPOSED FIBREGLASS POOL TO COMPLY WITH THE SWIMMING POOL ACT AND LOCAL COUNCIL REGULATIONS
2. PROPOSED FIBREGLASS POOL TO BE INSTALLED TO MEET THE REQUIREMENTS OF AS1839:2021. POOL LEVEL SHOWN IS INDICATIVE ONLY AND TO BE CONFIRMED ON-SITE BY BUILDER TO ENSURE COMPLIANCE WITH AS1839:2021.
3. SWIMMING POOL SAFETY FENCING & SWIMMING POOL SHALL COMPLY WITH;
 - COUNCIL DCP CODES
 - BUILDING CODE OF AUSTRALIA
 - SWIMMING POOLS ACT 1992-NO.49
 - SWIMMING POOL SAFETY AS 1926.1-2007
 - SWIMMING POOL SAFETY AS 1926.2-2007
 - SWIMMING POOL SAFETY AS 1926.1-2012

- LEGEND:**
- SOFT LANDSCAPE
 - DWELLING
 - HARDSPACE (CONCRETE, PAVING, ETC...)
 - CONCRETE & PAVING BY LPS
 - DESIGNATED WASTE AREA
 - SKIMMER (AT DEPTH END)
 - SEDIMENT CONTROL FENCE (SEE DETAIL)
 - VENTURI SPA JETS (X6)
 - POOL LIGHTS (X4)

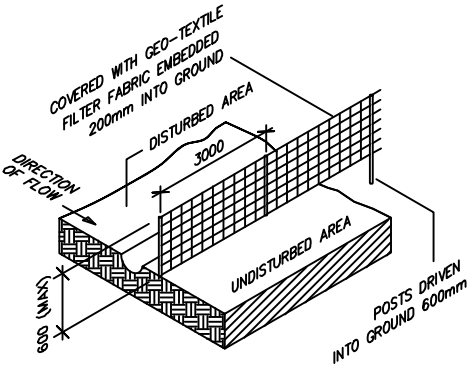

SEDIMENT FENCE DETAIL
NOT TO SCALE

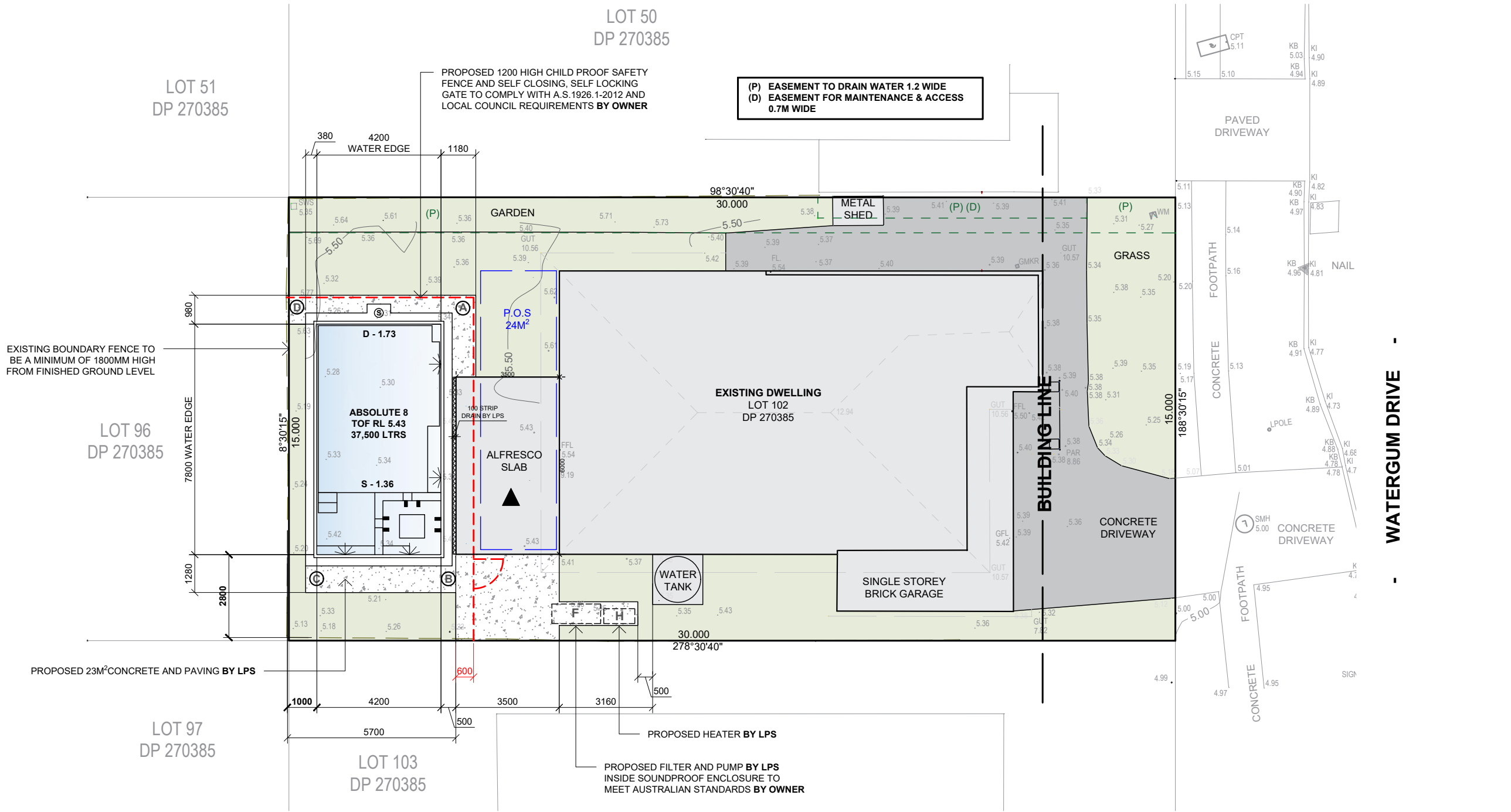

**▲ DATUM IS TOP OF EXISTING CONCRETE SLAB
TOP OF FIBERGLASS TO BE LEVEL WITH DATUM
RL 5.43**

**SITE LEVELS
TOP OF POOL COPING LEVEL +/- FROM EXISTING
NATURAL LEVEL**

- ① +90 FROM NGL RL 5.34
- ② +20 FROM NGL RL 5.41
- ③ +100 FROM NGL RL 5.33
- ④ +100 FROM NGL RL 5.33

GENERAL NOTES:

- MEASUREMENTS TO WATERS EDGE AND ARE INCLUSIVE OF BOND BEAM/ COPING
- UNLESS OTHERWISE STATED ALL DIMENSIONS ARE IN MILLIMETERS
- VERIFY ALL DIMENSIONS ON SITE AND INFORM ANY DISCREPANCIES BEFORE PROCEEDING WITH THE WORKS

DRAWING NAME: SITE POOL PLAN
SCALE: 1:150 A3
WATER FEATURE: N/A
POOL: ABSOLUTE 8
POOL VOLUME: 37,500 LTRS
ISSUE: DA SUBMISSION

JOB NUMBER: Q25032
CLIENT: CHRIS DAVIS & DEANNA SOLARI-DAVIS
ADDRESS: 39 WATERGUM DR, WARRIEWOOD NSW 2102
DATE: 30/05/2025
SHEET NUMBER: 1

VERSION A BY: SA
VERSION B BY: SA - CONCRETE AMENDS
12/06/2025