

NOTES:

- BOUNDARY SURVEY HAS BEEN UNDERTAKEN. SURVEY MARKS SHOULD BE PLACED IF EXCAVATION, CONSTRUCTION OR STRUCTURES ARE TO BE ERECTED ON OR NEAR THE BOUNDARIES.
- NO VISIBLE SERVICES HAVE BEEN SHOWN.
- UNDERGROUND SERVICES HAVE NOT BEEN LOCATED. NOTIFICATION OF ALL RELEVANT AUTHORITIES SHOULD BE UNDERTAKEN BEFORE CARRYING OUT ANY CONSTRUCTION ACTIVITY IN OR NEAR THE SURVEYED AREA. DIAL BEFORE YOU DIG SERVICES (PH1100) SHOULD BE CONTACTED.
- DO NOT SCALE FROM THIS PLAN. DIMENSIONS SHOULD BE USED.
- NO PART OF THIS SURVEY MAY BE REPRODUCED, STORED IN A RETRIEVAL SYSTEM OR TRANSMITTED IN ANY FORM, WITHOUT THE WRITTEN PERMISSION OF THE COPYRIGHT OWNER EXCEPT AS PERMITTED BY THE COPYRIGHT ACT 1988.
- ANY PERMITTED DOWNLOADING, ELECTRONIC STORAGE, DISPLAY, PRINT, COPY OR REPRODUCTION OF THIS SURVEY SHOULD CONTAIN NO ALTERATION OR ADDITION TO THE ORIGINAL SURVEY.
- THIS NOTICE MUST NOT BE ERASED.
- COPYRIGHT © ADAM CLERKE SURVEYORS PTY LTD 2025
- THIS PLAN HAS BEEN PREPARED FOR THE EXCLUSIVE USE OF STEPHEN CROSBY & ASSOCIATES PTY LTD
- PLAN PREPARED BY REGISTERED SURVEYOR FOR DEVELOPMENT APPLICATION PURPOSES ONLY

A Clerk

Adam Clarke

Registered surveyor No: 8490

AREA (m²)

PONTOON	49.5
RAMP	3.2
TIMBER JETTY	48.2
TIMBER DECK	25.1
ROOFED PATIO	16.4
RECLAMATION (REC)	86.3

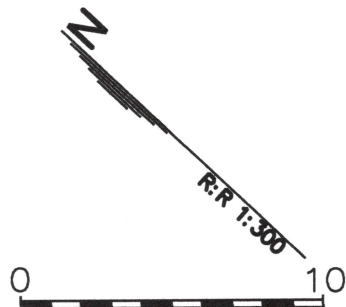
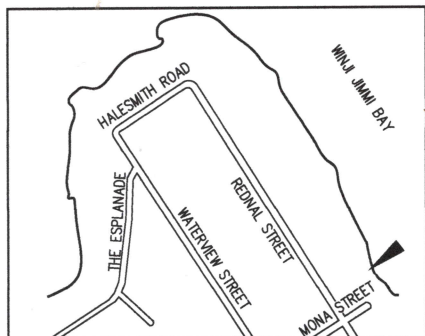
LOCATION PLAN
NOT TO SCALE

PITTWATER

S

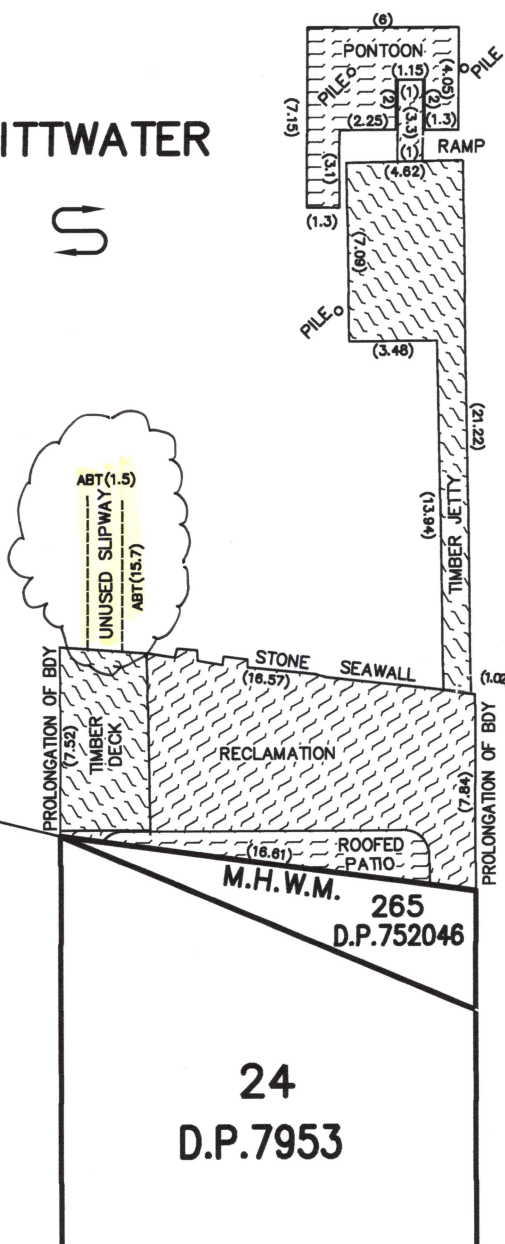
25
D.P.795324
D.P.795323
D.P.7953

PARISH: NARRABEEN
 COUNTY: CUMBERLAND
 LAND DISTRICT: SYDNEY
 DISTRICT OFFICE: METROPOLITAN
 LOCAL GOVERNMENT AREA: NORTHERN BEACHES
 FILE No: 3722

DIAGRAM SHOWING LICENCE
 LOT: 24 SEC: — DP: 7953
 265 752046
 KNOWN AS: — 36 REDNAL STREET,
 MONA VALE.
 NSW. 2103.

REDUCTION RATIO: 1: 300 (A4)

Date: 5/07/2025