

NOTE: ENSURE ALL OFFSETS SHOWN ARE MAINTAINED TO  
ENSURE COMPLIANCE AND CERTIFICATION AND ALLOWANCE IS  
MADE FOR ANY RENDER, CLADDING OR OTHER EXTERNAL COVERING

  
REGISTERED LAND SURVEYOR

ADDRESS: 94 FISHER ROAD,  
DEE WHY  
TITLE: B/409144  
CLIENT: JAMES MARTIN  
DATE: 25/10/2023  
REF: 13143-1

BUILDING DIMENSIONS SETOUT IN ACCORDANCE WITH PLANS PROVIDED  
JOB No.:#4-23 REVISION: V8 DATED: 08/08/2023. BUILDER TO MEASURE  
BETWEEN OUR MARKS PRIOR TO CONSTRUCTION WORKS. ANY  
DISCREPANCIES MUST BE REPORTED IMMEDIATELY TO OUR OFFICE AND ALL  
WORKS ARE TO CEASE UNTIL RESOLVED.  
PAGE 1 OF 1



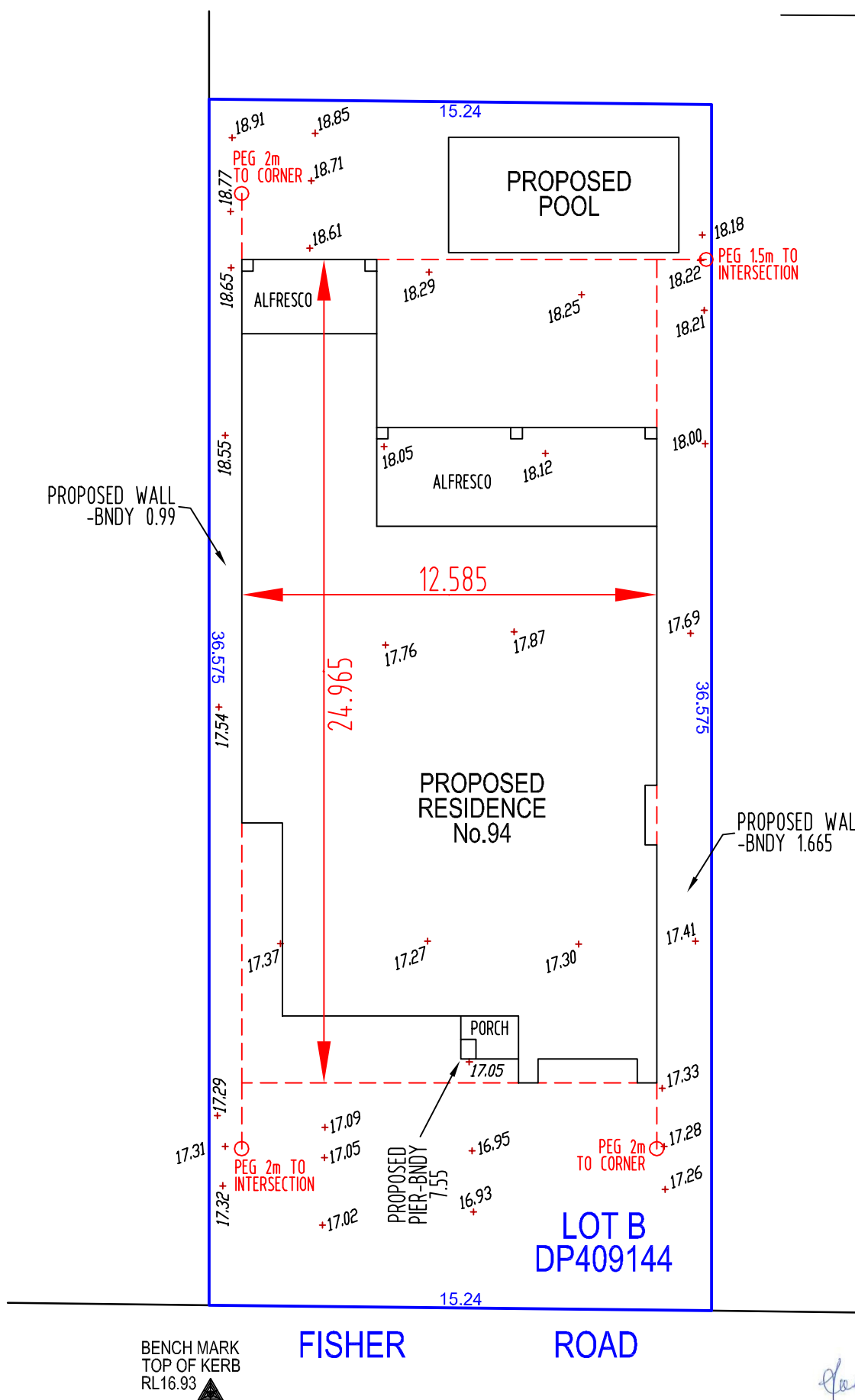

REGISTERED LAND SURVEYOR



**united**  
surveyors

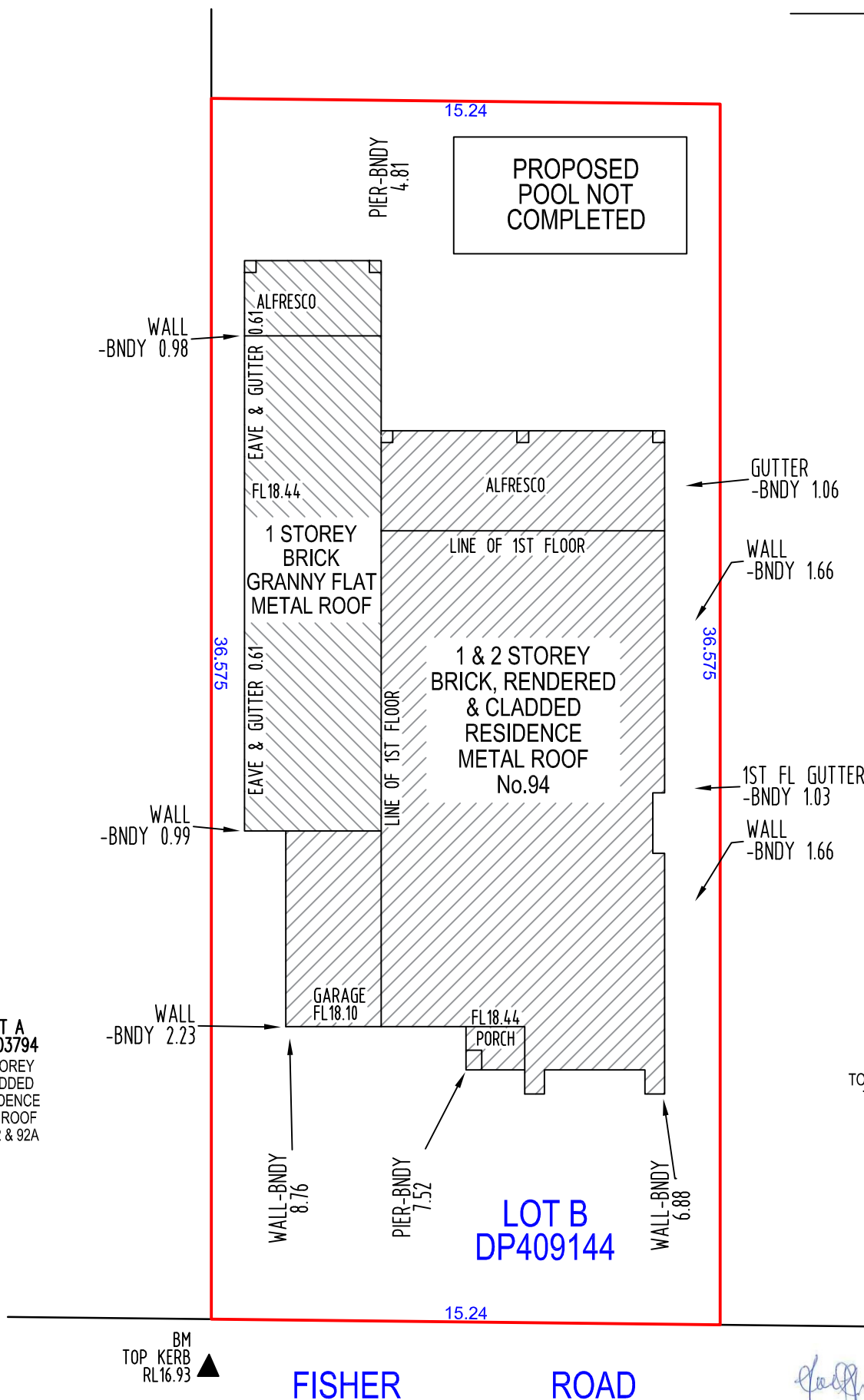

LOT A  
DP303794  
1 STOREY  
CLADDED  
RESIDENCE  
TILE ROOF  
No.92 & 92A

SP7124  
1 STOREY  
BRICK  
TOWN HOUSES  
TILE ROOF  
No.96

*Handwritten signature*

REGISTERED LAND SURVEYOR

ADDRESS: 94 FISHER ROAD,  
DEE WHY  
TITLE: B/409144  
L.G.A: NORTHERN BEACHES  
DATE: 24 MARCH 2025

THIS SKETCH MUST BE READ IN CONJUNCTION WITH REPORT REFERENCE:13143-3  
ENCUMBRANCES HAVE NOT BEEN INVESTIGATED OR REPORTED UPON  
AS PART OF THIS SURVEY. FENCING HAS NOT BEEN LOCATED,  
THIS SKETCH HAS BEEN PREPARED FOR USE ONLY BY MASTERTON HOMES  
AND AS A REQUIREMENT TO OBTAIN AN OCCUPATION CERTIFICATE ONLY.



**united**  
surveyors